

K

(SUBMIT IN TRIPPLICATE)

UNITED STATES
DEPARTMENT OF THE INTERIOR
GEOLOGICAL SURVEY

Land Office **Santa Fe**

Lease No. **079364**

Unit **Rincon Unit**

SUNDRY NOTICES AND REPORTS ON WELLS

| | | | |
|--|-------------------------------------|--|--|
| NOTICE OF INTENTION TO DRILL | <input checked="" type="checkbox"/> | SUBSEQUENT REPORT OF WATER SHUT-OFF | |
| NOTICE OF INTENTION TO CHANGE PLANS | | SUBSEQUENT REPORT OF SHOOTING OR ACIDIZING | |
| NOTICE OF INTENTION TO TEST WATER SHUT-OFF | | SUBSEQUENT REPORT OF ALTERING CASING | |
| NOTICE OF INTENTION TO RE-DRILL OR REPAIR WELL | | SUBSEQUENT REPORT OF RE-DRILLING OR REPAIR | |
| NOTICE OF INTENTION TO SHOOT OR ACIDIZE | | SUBSEQUENT REPORT OF ABANDONMENT | |
| NOTICE OF INTENTION TO PULL OR ALTER CASING | | SUPPLEMENTARY WELL HISTORY | |
| NOTICE OF INTENTION TO ABANDON WELL | | | |

RECEIVED
AUG 28 1962

(INDICATE ABOVE BY CHECK MARK NATURE OF REPORT, NOTICE, OR OTHER DATA) U. S. GEOLOGICAL SURVEY
FARMINGTON, NEW MEXICO

August 27, 1962

Well No. 183 is located 1697 ft. from ~~XXXX~~ S line and 1460 ft. from ~~XXXX~~ W line of sec. 31.

SW/4 Sec. 31
(1/4 Sec. and 1/4 Sec. No.)

27N
(Twp.)

6W
(Range)

N.M.P.M.
(Meridian)

Basin Dakota
(Field)

Rio Arriba
(County or Subdivision)

New Mexico
(State or Territory)

The elevation of the derrick floor above sea level is 6658 ft.

DETAILS OF WORK

(State names of and expected depths to objective sands; show sizes, weights, and lengths of proposed casings; indicate mudding jobs, cementing points, and all other important proposed work)

It is intended to mud drill a well with rotary tools thru the Dakota formation and to perforate and fracture possible producing zones. Est. T. D. 7576'.

Casing Program:

- 9 5/8" @ 300' w/210 sks. cement circulated to surface.
- 4 1/2" @ 7576' w/two & three stage collars. Set 2nd stage collar 50' - 100' below base of Mesa Verde. Third stage 50' - 100' below base of Pictured Cliffs.
- Cement 1st stage w/130 sks. to cover Greenhorn
- 2nd stage w/210 sks. to cover 100' above top of Cliff House
- Third stage w/210 sks. to cover Ojo Alamo.

The S/2 of Section 31 is dedicated to this well.

I understand that this plan of work must receive approval in writing by the Geological Survey before operations may be commenced.

Company El Paso Natural Gas Company

Address Box 990

Farmington, New Mexico

By A. W. Meekins

Title Petroleum Engineer

RECEIVED
AUG 30 1962
OIL CON. COM.
DIST. 3

NEW MEXICO OIL CONSERVATION COMMISSION

Well Location and Acreage Dedication Plat

Section A.

Date AUGUST 1, 1962

Operator EL PASO NATURAL GAS COMPANY Lease RINCON UNIT SF079364
 Well No. 183 Unit Letter K Section 31 Township 27-N Range 6-W NMPM
 Located 1697 Feet From SOUTH Line, 1460 Feet From WEST Line
 County RIO ARriba G. L. Elevation 6648 Dedicated Acreage 336.32 Acres
 Name of Producing Formation DAKOTA Pool BASIN DAKOTA

1. Is the Operator the only owner in the dedicated acreage outlined on the plat below?
 Yes No
2. If the answer to question one is "no", have the interests of all the owners been consolidated by communitization agreement or otherwise? Yes No . If answer is "yes", Type of Consolidation.
3. If the answer to question two is "no", list all the owners and their respective interests below:

Owner Land Description

Section B.

This is to certify that the information in Section A above is true and complete to the best of my knowledge and belief.

El Paso Natural Gas Company

(Operator)

Original Signed D. W. Meehan

(Representative)

Box 990

(Address)

Farmington, New Mexico

Note: All distances must be from outer boundaries of section.

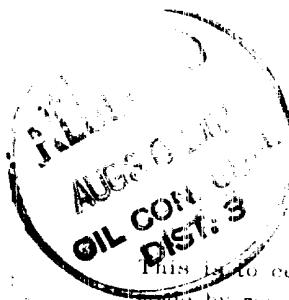
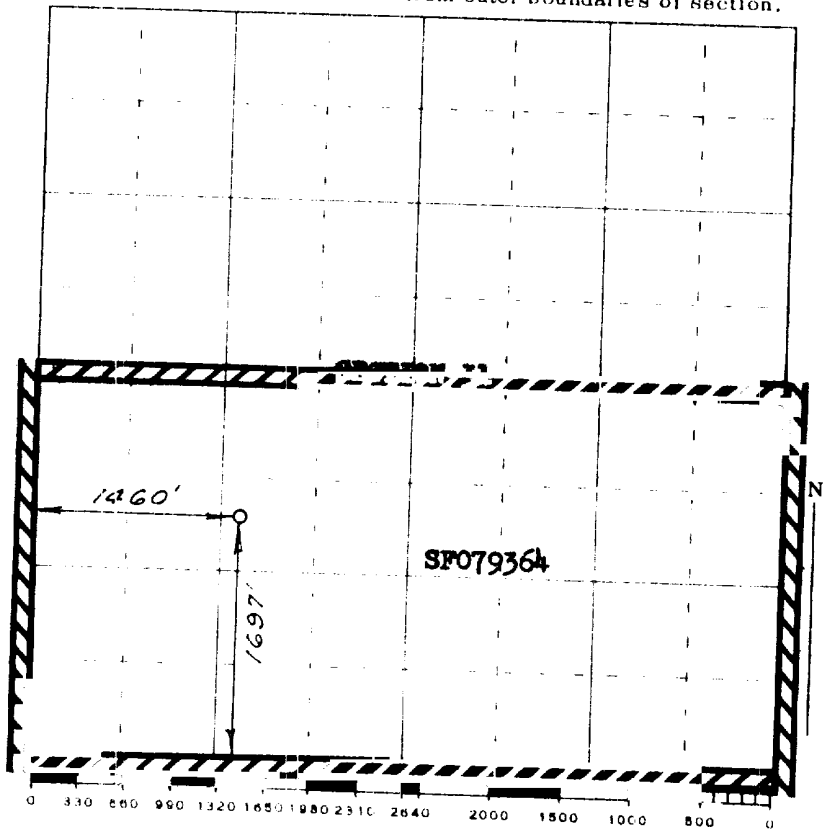

This is to certify that the above plat was prepared from field notes of actual surveys made by me or under my supervision and that the same are true and correct to the best of my knowledge and belief.

(Seal)

Farmington, New Mexico

Date Surveyed JUNE 25, 1962

David C. Kilven
 Registered Professional Engineer and/or Land Surveyor