

DISTRICT I  
1625 N. French Dr., Hobbs, NM 88240  
DISTRICT II  
811 South First St., Artesia, NM 88210  
DISTRICT III  
1000 Rio Brazos Rd, Aztec, NM 87410  
DISTRICT IV  
2040 S. Pacheco, Santa Fe, NM 87505

State of New Mexico  
Energy, Minerals and Natural Resources Department  
**OIL CONSERVATION DIVISION**  
2040 S. Pacheco  
Santa Fe, New Mexico 87505-6429  
**APPLICATION FOR DOWNHOLE COMMINGLING**

Form C-107-A  
Revised March 17, 1999  
APPROVAL PROCESS:  
 Administrative  Hearing  
EXISTING WELLBORE  
 YES  NO

BURLINGTON RESOURCES OIL & GAS COMPANY PO Box 4289, Farmington, NM 87499  
Operator Address

San Juan 27-4 Unit 36 K, Sec 36, T27N, R4W N Rio Arriba  
Lease Well No. Unit Ltr. - Sec - Twp - Rge County

Spacing Unit Lease Types: (check 1 or more)

GRID NO. 14538 Property Code 7452 API NO. 30-039-0681000 Federal  State (and/or) Fee

The following facts are submitted in support of downhole commingling:	Upper Zone	Intermediate Zone	Lower Zone
1. Pool Name and Pool Code	Tapacito Pictured Cliff - 85920		Blanco Mesa Verde - 72319
2. Top and Bottom of Pay Section (Perforations)	4080' - 4134'		5872' - 6244'
3. Type of production (Oil or Gas)	Gas		Gas
4. Method of Production (Flowing or Artificial Lift)	Flowing		Flowing
5. Bottomhole Pressure Oil Zones - Artificial Lift: Estimated Current Gas & Oil - Flowing: Measured Current All Gas Zones: Estimated Or Measured Original	(Current) a. 504 psia @ 4107'	a. 674 psia @ 6058'	a. 674 psia @ 6058'
	(Original) b. 1218 psia @ 4107'	b.	b. 1245 psia @ 6058'
6. Oil Gravity (EAPI) or Gas BTU Content	BTU N/A		BTU N/A
7. Producing or Shut-In?	Shut-In		Shut-In
Production Marginal? (yes or no)	Yes		Yes
* If Shut-In, give date and oil/gas/water rates of last production <small>Note: For new zones with no production history, applicant shall be required to attach production estimates and supporting data</small>	Date: 12/93 Rates: 7 MCFD, 0 BOD, 0 BWD	Date: Rates:	Date: 5/97 Rates: 5 MCFD, 0 BOD, 0 BWD
* If Producing, give date and oil/gas/water rates of recent test (within 60 days)	Date: Rates:	Date: Rates:	Date: Rates:
8. Fixed Percentage Allocation Formula -% for each zone (total of %'s to equal 100%)	Oil: Gas: Will supply for commingling	Oil: % Gas: %	Oil: Gas: Will supply for commingling

9. If allocation formula is based upon something other than current or past production, or is based upon some other method, submit attachments with supporting data and/or explaining method and providing rate projections or other required data.

10. Are all working, overriding, and royalty interests identical in all commingled zones? Yes  No   
If not, have all working, overriding, and royalty interests been notified by certified mail?  Yes  No   
Have all offset operators been given written notice of the proposed downhole commingling?  Yes  No

11. Will cross-flow occur?  Yes  No If yes, are fluids compatible, will the formations not be damaged, will any cross-flowed production be recovered, and will the allocation formula be reliable.  Yes  No (If No, attach explanation)

12. Are all produced fluids from all commingled zones compatible with each other?  Yes  No

13. Will the value of production be decreased by commingling?  Yes  No (If Yes, attach explanation)

14. If this well is on, or communitized with, state or federal lands, either the Commissioner of Public Lands or the United States Bureau of Land Management has been notified in writing of this application.  Yes  No

15. NMOCD Reference Cases for Rule 303(D) Exceptions: ORDER NO(S) \_\_\_\_\_

16. ATTACHMENTS:

- \* C-102 for each zone to be commingled showing its spacing unit and acreage dedication.
- \* Production curve for each zone for at least one year. (If not available, attach explanation.)
- \* For zones with no production history, estimated production rates and supporting data.
- \* Data to support allocation method or formula.
- \* Notification list of all offset operators.
- \* Notification list of working, overriding, and royalty interests for uncommon interest cases.
- \* Any additional statements, data, or documents required to support commingling.

I hereby certify that the information above is true and complete to the best of my knowledge and belief.

SIGNATURE Timothy J. Friesenhahn TITLE Operations Engineer DATE 07-06-99

TYPE OR PRINT NAME Timothy J. Friesenhahn TELEPHONE NO. (505) 326-9700

Date MAY 5, 1964

Section A.

Operator **EL PASO NATURAL GAS COMPANY** Lease **SAN JUAN 27-4 UNIT** SF-079527  
 Well No. **36(PM)** Unit Letter **K** Section **36** Township **27-N** Range **4-W** N.M.P.M. **WEST**  
 Located **1650** Feet From **SOUTH** Line, **1700** Feet From **WEST** Line  
 County **RIO ARRIBA** G. L. Elevation **7269** Dedicated Acreage **160 & 320** Acres  
 Name of Producing Formation **PICTURED CLIFFS & MESA VERDE** Plat **TAPICITO P. C. EXT & BLANCO M. V.**

1. Is the Operator the only owner in the dedicated acreage outlined on the plat below?  
 Yes **XX** No \_\_\_\_\_
2. If the answer to question one is "no", have the interests of all the owners been consolidated by communitization agreement or otherwise? Yes \_\_\_\_\_ No \_\_\_\_\_. If answer is "yes", Type of Consolidation \_\_\_\_\_
3. If the answer to question two is "no", list all the owners and their respective interests below:  

Owner	Land Description

Section B.

This is to certify that the information in Section A above is true and complete to the best of my knowledge and belief.

**El Paso Natural Gas Company**  
 (Operator)  
**OR G'NAL SIGNED E. S. OBERLY**  
 (Representative)  
**Box 990**  
 (Address)  
**Farmington, New Mexico**

**RECEIVED**  
 JUL 13 1999  
**CON. DIV.**  
**DEPT. 3**

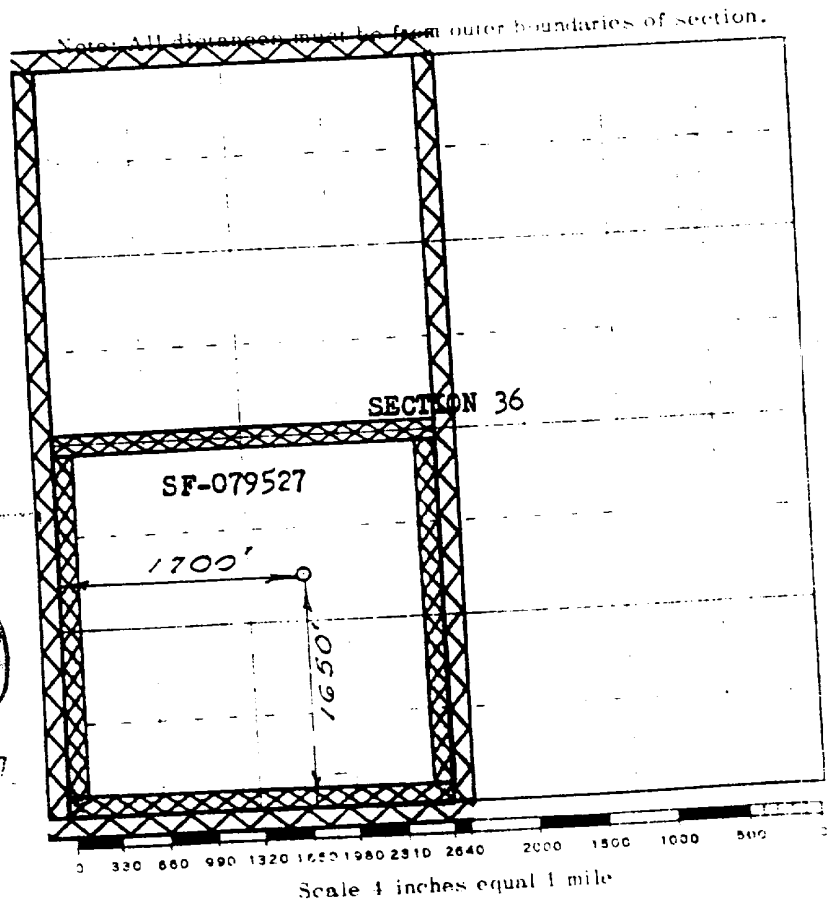

This is to certify that the above plat was prepared from field notes of actual survey made by me or under my supervision and that the same are true and correct to the best of my knowledge and belief.

Date Surveyed **MARCH 23, 1964**

*Russell H. McNease*  
 Registered Professional Engineer and/or Land Surveyor

(Seal)

Farmington, New Mexico

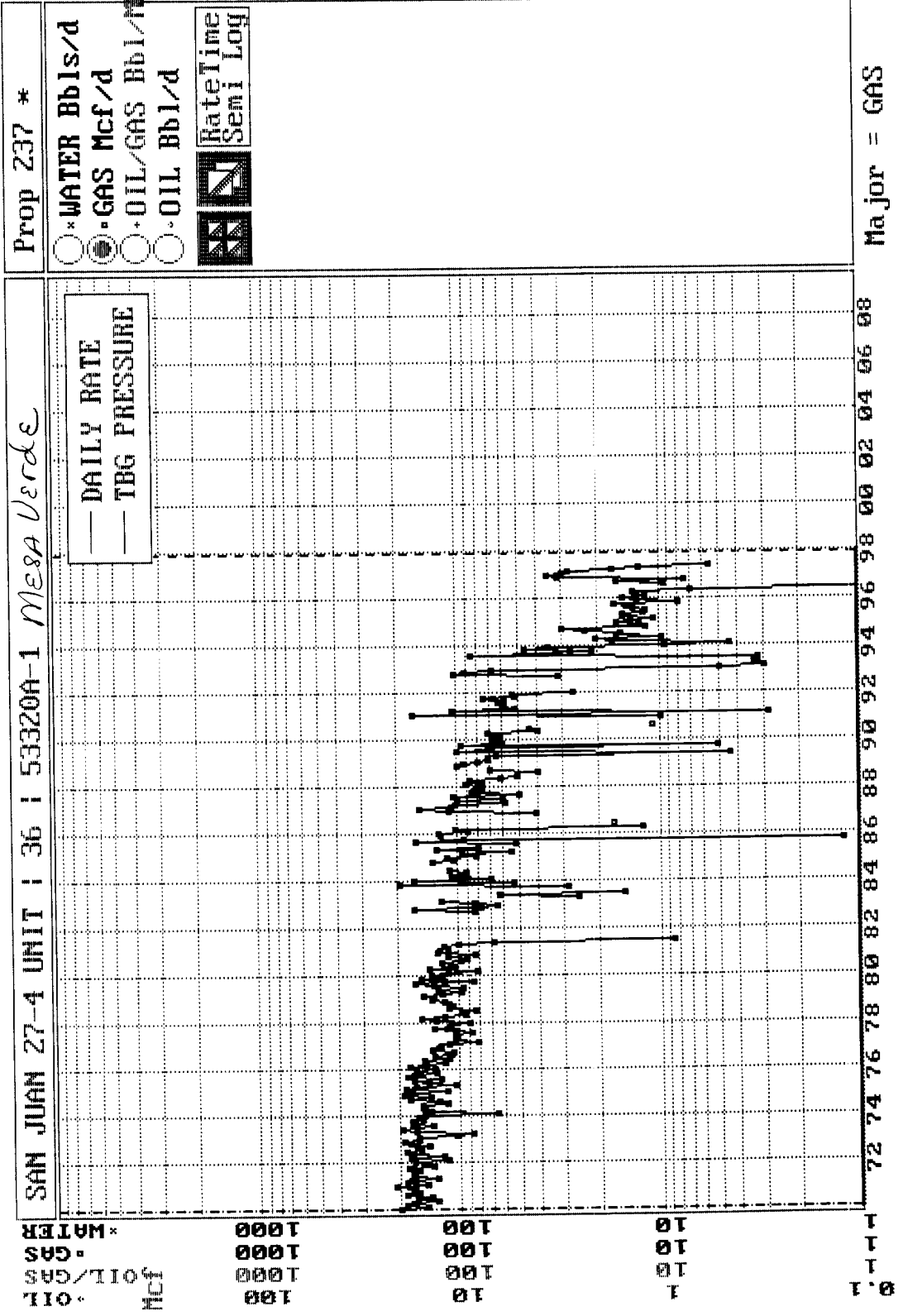



Page No.: 1  
 Print Time: Thu May 27 10:25:45 1999  
 Property ID: 237  
 Property Name: SAN JUAN 27-4 UNIT | 36 | 53320A-1 ; Mesa Verde  
 Table Name: S:\JSMITH\ARIES\99WORK\TEST.DBF

<u>--DATE--</u>	<u>---CUM GAS---</u>	<u>M SIWHP</u>	
	Mcf	Psi	
07/20/64	0	1044.0	<i>Original</i>
07/30/64	0	1043.0	
08/27/65	30000	800.0	
06/03/66	131000	762.0	
05/29/67	228000	673.0	
05/15/68	308000	636.0	
06/03/69	378000	652.0	
05/21/70	443662	594.0	
04/30/71	500274	567.0	
05/02/72	563743	566.0	
07/21/76	794879	443.0	
01/06/78	855427	542.0	
11/06/78	890121	542.0	
04/06/81	991982	490.0	
11/28/81	997379	0.0	
07/09/82	997379	662.0	
11/03/82	1007323	626.0	
07/03/84	1046881	585.0	
04/07/86	1094373	562.0	
05/20/91	1201186	579.0	
09/16/91	1208692	591.0	
5/97	1250517	567	<i>Current</i>

Page No.: 2

Print Time: Fri May 21 09:28:20 1999

*Used as offset well*

Property ID: 192

Property Name: SAN JUAN 27-4 UNIT | 138 | 53342B-1 *PC*

Table Name: S:\JSMITH\ARIES\99WORK\TEST.DBF

DATE      CUM GAS      M SIWHP  
                    Mcf                      Psi

09/24/80	0	1067.0
05/18/81	15042	696.0
11/03/82	45860	571.0
09/13/83	51850	689.0
06/05/84	57972	654.0
11/21/86	89994	551.0
10/04/89	137963	510.0
10/01/91	148488	536.0
11/08/93	173311	597.0

*Original*

3/31/99

232,659 441

*CURRENT  
BASED*

*ON CUM GAS VS PRESSURE CURVE*

**San Juan 27-4 Unit #36**  
**Bottom Hole Pressures**  
**Flowing and Static BHP**  
**Cullender and Smith Method**

Version 1.0 3/13/94

<b>Pictured Cliffs</b>	<b>Mesa Verde</b>																																																
<b><u>PC-Current</u></b>	<b><u>MV-Current</u></b>																																																
<table style="width: 100%; border-collapse: collapse;"> <tr><td style="width: 80%;">GAS GRAVITY</td><td style="text-align: right; border-bottom: 1px solid black;">0.701</td></tr> <tr><td>COND. OR MISC. (C/M)</td><td style="text-align: right; border-bottom: 1px solid black;">M</td></tr> <tr><td>%N2</td><td style="text-align: right; border-bottom: 1px solid black;">0.82</td></tr> <tr><td>%CO2</td><td style="text-align: right; border-bottom: 1px solid black;">0.12</td></tr> <tr><td>%H2S</td><td style="text-align: right; border-bottom: 1px solid black;">0</td></tr> <tr><td>DIAMETER (IN)</td><td style="text-align: right; border-bottom: 1px solid black;">6.456</td></tr> <tr><td>DEPTH (FT)</td><td style="text-align: right; border-bottom: 1px solid black;">4107</td></tr> <tr><td>SURFACE TEMPERATURE (DEG F)</td><td style="text-align: right; border-bottom: 1px solid black;">60</td></tr> <tr><td>BOTTOMHOLE TEMPERATURE (DEG F)</td><td style="text-align: right; border-bottom: 1px solid black;">128</td></tr> <tr><td>FLOWRATE (MCFPD)</td><td style="text-align: right; border-bottom: 1px solid black;">0</td></tr> <tr><td>SURFACE PRESSURE (PSIA)</td><td style="text-align: right; border-bottom: 1px solid black;">453</td></tr> <tr><td> BOTTOMHOLE PRESSURE (PSIA)</td><td style="text-align: right; border-bottom: 1px solid black; border: 1px solid black;"> 503.9</td></tr> </table>	GAS GRAVITY	0.701	COND. OR MISC. (C/M)	M	%N2	0.82	%CO2	0.12	%H2S	0	DIAMETER (IN)	6.456	DEPTH (FT)	4107	SURFACE TEMPERATURE (DEG F)	60	BOTTOMHOLE TEMPERATURE (DEG F)	128	FLOWRATE (MCFPD)	0	SURFACE PRESSURE (PSIA)	453	 BOTTOMHOLE PRESSURE (PSIA)	 503.9	<table style="width: 100%; border-collapse: collapse;"> <tr><td style="width: 80%;">GAS GRAVITY</td><td style="text-align: right; border-bottom: 1px solid black;">0.687</td></tr> <tr><td>COND. OR MISC. (C/M)</td><td style="text-align: right; border-bottom: 1px solid black;">M</td></tr> <tr><td>%N2</td><td style="text-align: right; border-bottom: 1px solid black;">0.30</td></tr> <tr><td>%CO2</td><td style="text-align: right; border-bottom: 1px solid black;">0.43</td></tr> <tr><td>%H2S</td><td style="text-align: right; border-bottom: 1px solid black;">0</td></tr> <tr><td>DIAMETER (IN)</td><td style="text-align: right; border-bottom: 1px solid black;">4.052</td></tr> <tr><td>DEPTH (FT)</td><td style="text-align: right; border-bottom: 1px solid black;">6058</td></tr> <tr><td>SURFACE TEMPERATURE (DEG F)</td><td style="text-align: right; border-bottom: 1px solid black;">60</td></tr> <tr><td>BOTTOMHOLE TEMPERATURE (DEG F)</td><td style="text-align: right; border-bottom: 1px solid black;">160</td></tr> <tr><td>FLOWRATE (MCFPD)</td><td style="text-align: right; border-bottom: 1px solid black;">0</td></tr> <tr><td>SURFACE PRESSURE (PSIA)</td><td style="text-align: right; border-bottom: 1px solid black;">579</td></tr> <tr><td> BOTTOMHOLE PRESSURE (PSIA)</td><td style="text-align: right; border-bottom: 1px solid black; border: 1px solid black;"> 673.9</td></tr> </table>	GAS GRAVITY	0.687	COND. OR MISC. (C/M)	M	%N2	0.30	%CO2	0.43	%H2S	0	DIAMETER (IN)	4.052	DEPTH (FT)	6058	SURFACE TEMPERATURE (DEG F)	60	BOTTOMHOLE TEMPERATURE (DEG F)	160	FLOWRATE (MCFPD)	0	SURFACE PRESSURE (PSIA)	579	 BOTTOMHOLE PRESSURE (PSIA)	 673.9
GAS GRAVITY	0.701																																																
COND. OR MISC. (C/M)	M																																																
%N2	0.82																																																
%CO2	0.12																																																
%H2S	0																																																
DIAMETER (IN)	6.456																																																
DEPTH (FT)	4107																																																
SURFACE TEMPERATURE (DEG F)	60																																																
BOTTOMHOLE TEMPERATURE (DEG F)	128																																																
FLOWRATE (MCFPD)	0																																																
SURFACE PRESSURE (PSIA)	453																																																
 BOTTOMHOLE PRESSURE (PSIA)	 503.9																																																
GAS GRAVITY	0.687																																																
COND. OR MISC. (C/M)	M																																																
%N2	0.30																																																
%CO2	0.43																																																
%H2S	0																																																
DIAMETER (IN)	4.052																																																
DEPTH (FT)	6058																																																
SURFACE TEMPERATURE (DEG F)	60																																																
BOTTOMHOLE TEMPERATURE (DEG F)	160																																																
FLOWRATE (MCFPD)	0																																																
SURFACE PRESSURE (PSIA)	579																																																
 BOTTOMHOLE PRESSURE (PSIA)	 673.9																																																
<b><u>PC-Original</u></b>	<b><u>MV-Original</u></b>																																																
<table style="width: 100%; border-collapse: collapse;"> <tr><td style="width: 80%;">GAS GRAVITY</td><td style="text-align: right; border-bottom: 1px solid black;">0.701</td></tr> <tr><td>COND. OR MISC. (C/M)</td><td style="text-align: right; border-bottom: 1px solid black;">M</td></tr> <tr><td>%N2</td><td style="text-align: right; border-bottom: 1px solid black;">0.82</td></tr> <tr><td>%CO2</td><td style="text-align: right; border-bottom: 1px solid black;">0.12</td></tr> <tr><td>%H2S</td><td style="text-align: right; border-bottom: 1px solid black;">0</td></tr> <tr><td>DIAMETER (IN)</td><td style="text-align: right; border-bottom: 1px solid black;">6.456</td></tr> <tr><td>DEPTH (FT)</td><td style="text-align: right; border-bottom: 1px solid black;">4107</td></tr> <tr><td>SURFACE TEMPERATURE (DEG F)</td><td style="text-align: right; border-bottom: 1px solid black;">60</td></tr> <tr><td>BOTTOMHOLE TEMPERATURE (DEG F)</td><td style="text-align: right; border-bottom: 1px solid black;">128</td></tr> <tr><td>FLOWRATE (MCFPD)</td><td style="text-align: right; border-bottom: 1px solid black;">0</td></tr> <tr><td>SURFACE PRESSURE (PSIA)</td><td style="text-align: right; border-bottom: 1px solid black;">1079</td></tr> <tr><td> BOTTOMHOLE PRESSURE (PSIA)</td><td style="text-align: right; border-bottom: 1px solid black; border: 1px solid black;"> 1217.6</td></tr> </table>	GAS GRAVITY	0.701	COND. OR MISC. (C/M)	M	%N2	0.82	%CO2	0.12	%H2S	0	DIAMETER (IN)	6.456	DEPTH (FT)	4107	SURFACE TEMPERATURE (DEG F)	60	BOTTOMHOLE TEMPERATURE (DEG F)	128	FLOWRATE (MCFPD)	0	SURFACE PRESSURE (PSIA)	1079	 BOTTOMHOLE PRESSURE (PSIA)	 1217.6	<table style="width: 100%; border-collapse: collapse;"> <tr><td style="width: 80%;">GAS GRAVITY</td><td style="text-align: right; border-bottom: 1px solid black;">0.687</td></tr> <tr><td>COND. OR MISC. (C/M)</td><td style="text-align: right; border-bottom: 1px solid black;">M</td></tr> <tr><td>%N2</td><td style="text-align: right; border-bottom: 1px solid black;">0.30</td></tr> <tr><td>%CO2</td><td style="text-align: right; border-bottom: 1px solid black;">0.43</td></tr> <tr><td>%H2S</td><td style="text-align: right; border-bottom: 1px solid black;">0</td></tr> <tr><td>DIAMETER (IN)</td><td style="text-align: right; border-bottom: 1px solid black;">4.052</td></tr> <tr><td>DEPTH (FT)</td><td style="text-align: right; border-bottom: 1px solid black;">6058</td></tr> <tr><td>SURFACE TEMPERATURE (DEG F)</td><td style="text-align: right; border-bottom: 1px solid black;">60</td></tr> <tr><td>BOTTOMHOLE TEMPERATURE (DEG F)</td><td style="text-align: right; border-bottom: 1px solid black;">160</td></tr> <tr><td>FLOWRATE (MCFPD)</td><td style="text-align: right; border-bottom: 1px solid black;">0</td></tr> <tr><td>SURFACE PRESSURE (PSIA)</td><td style="text-align: right; border-bottom: 1px solid black;">1056</td></tr> <tr><td> BOTTOMHOLE PRESSURE (PSIA)</td><td style="text-align: right; border-bottom: 1px solid black; border: 1px solid black;"> 1245.1</td></tr> </table>	GAS GRAVITY	0.687	COND. OR MISC. (C/M)	M	%N2	0.30	%CO2	0.43	%H2S	0	DIAMETER (IN)	4.052	DEPTH (FT)	6058	SURFACE TEMPERATURE (DEG F)	60	BOTTOMHOLE TEMPERATURE (DEG F)	160	FLOWRATE (MCFPD)	0	SURFACE PRESSURE (PSIA)	1056	 BOTTOMHOLE PRESSURE (PSIA)	 1245.1
GAS GRAVITY	0.701																																																
COND. OR MISC. (C/M)	M																																																
%N2	0.82																																																
%CO2	0.12																																																
%H2S	0																																																
DIAMETER (IN)	6.456																																																
DEPTH (FT)	4107																																																
SURFACE TEMPERATURE (DEG F)	60																																																
BOTTOMHOLE TEMPERATURE (DEG F)	128																																																
FLOWRATE (MCFPD)	0																																																
SURFACE PRESSURE (PSIA)	1079																																																
 BOTTOMHOLE PRESSURE (PSIA)	 1217.6																																																
GAS GRAVITY	0.687																																																
COND. OR MISC. (C/M)	M																																																
%N2	0.30																																																
%CO2	0.43																																																
%H2S	0																																																
DIAMETER (IN)	4.052																																																
DEPTH (FT)	6058																																																
SURFACE TEMPERATURE (DEG F)	60																																																
BOTTOMHOLE TEMPERATURE (DEG F)	160																																																
FLOWRATE (MCFPD)	0																																																
SURFACE PRESSURE (PSIA)	1056																																																
 BOTTOMHOLE PRESSURE (PSIA)	 1245.1																																																

FARMINGTON

ANNUAL PRODUCTION FOR 53320B

PHS020M1

SAN JUAN 27-4 UNIT 36

TAPACITO (PICTURED CLIFFS) FIELD

PICTURED CLIFFS ZONE

===== OIL CUM =====

===== GAS CUM =====

===== WATER CUM =====

PC DATE

BBLs

PC DATE

MCF

DATE

BBLs

02 6912

01 6912

174296

=====

YEAR	OIL	OIL CUM	GAS	GAS CUM	WATER	WATER CUM
1980			2540	382489		
1989				382489		
1990				382489		
1991				382489		
1992				382489		
1993			2676	385165		
1994				385165		
1995				385165		
1996				385165		
1997				385165		

POSITION CURSOR BY YEAR AND PRESS ENTER TO DISPLAY MONTHLY PRODUCTION

ENTER - CONTINUES ANNUAL DISPLAY

PF3 - TRANSFER TO UPDATE

PF6 - RETURN TO WELL-INFO DISPLAY

PF9 - ANNUAL INJECTION DISPLAY

PF10 - HELP INFORMATION

00/00/00 00:00:00:0 D03 09/02/89





**BURLINGTON RESOURCES OIL AND GAS COMPANY**

**San Juan 27-4 Unit #36**

**OFFSET OPERATOR/OWNER PLAT**

**Pictured Cliffs (SW/4) & Mesaverde (W/2) Formations**

**Commingle well**

**Township 27 North, Range 4 West**

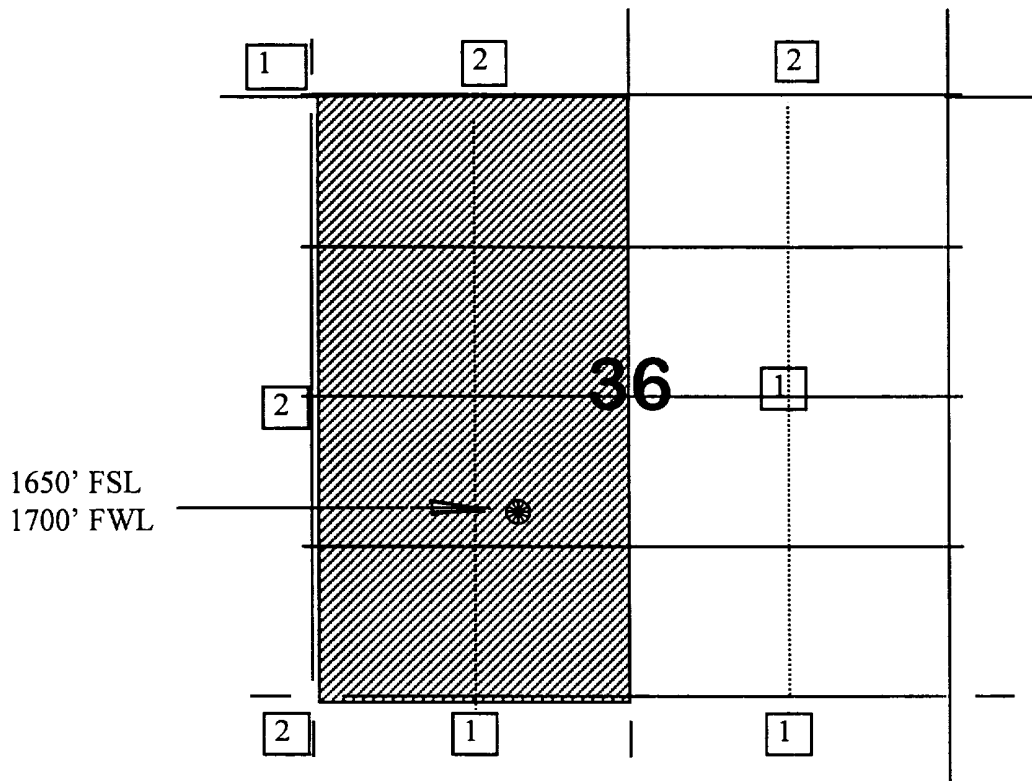

1) Burlington Resources

2) Greystone Resources, Inc.  
5802 Highway 64  
Farmington, NM 87401

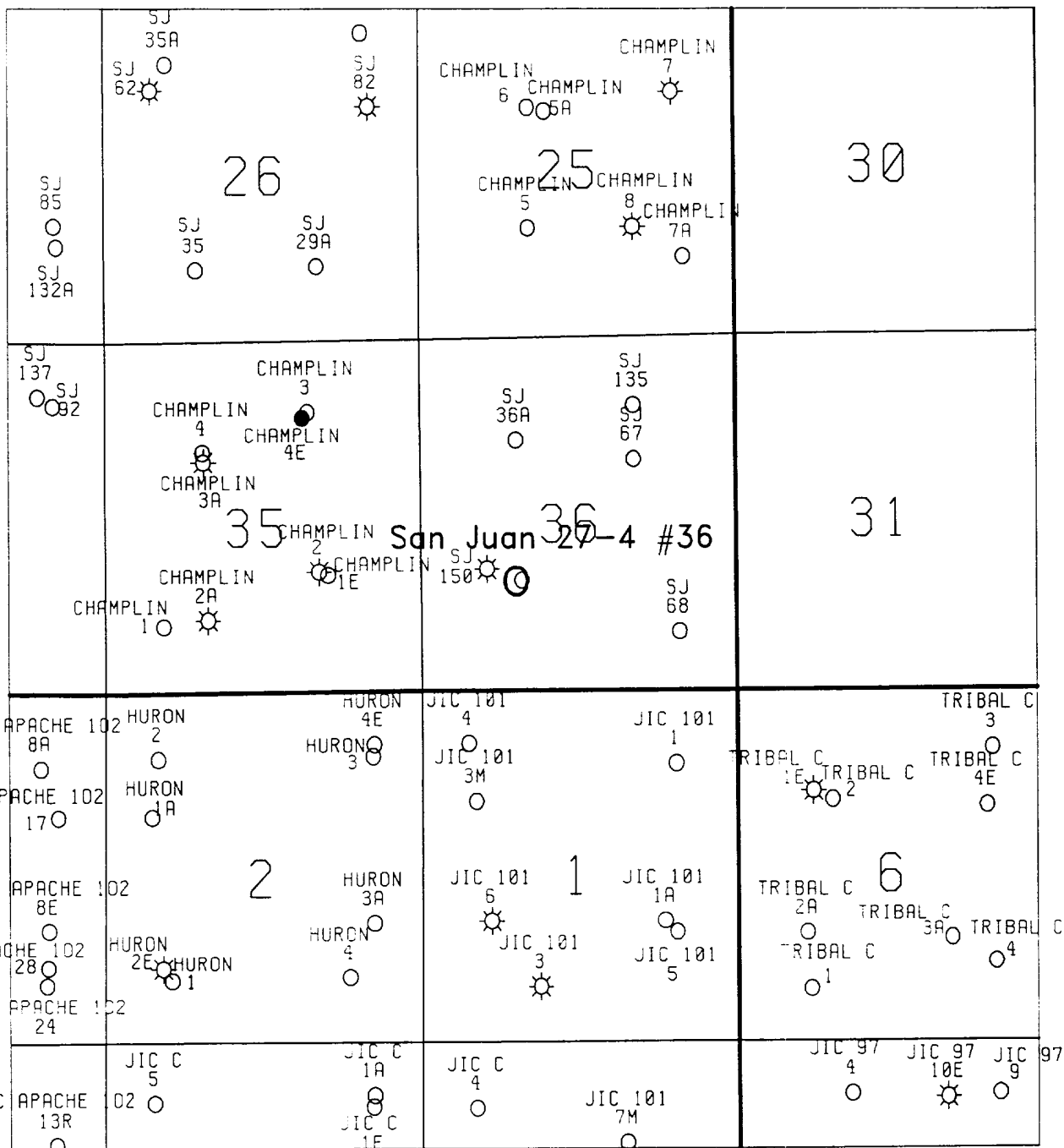

*San Juan 27-4 #36*

*Sec 36, T27N, R4W*

*Pictured Cliffs/Mesa Verde*