

NEW MEXICO OIL CONSERVATION COMMISSION

Well Location and Acreage Dedication Plat

Section A.

Date January 24, 1963

Operator CONSOLIDATED OIL & GAS, INC. Lease CHAMPLIN
 Well No. 4 Unit Letter F Section 35 Township 27 NORTH Range 4 WEST NMPM
 Located 1650 Feet From the NORTH Line, 1650 Feet From the WEST Line
 County RIO ARriba G. L. Elevation 7068.0 Dedicated Acreage 320 Acres
 Name of Producing Formation DAKOTA Pool BASIN

1. Is the Operator the only owner in the dedicated acreage outlined on the plat below?
 Yes X No _____
2. If the answer to question one is "no", have the interests of all the owners been consolidated by communitization agreement or otherwise? Yes _____ No _____. If answer is "yes", Type of Consolidation.
3. If the answer to question two is "no", list all the owners and their respective interests below:

Owner

Land Description

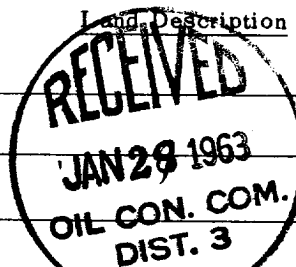

RECEIVED
 JAN 28 1963

U. S. GEOLOGICAL SURVEY
 WASHINGTON, D. C.

Section B.

Note: All distances must be from outer boundaries of section.

This is to certify that the information in Section A above is true and complete to the best of my knowledge and belief.

Consolidated Oil & Gas, Inc.

(Operator)

W. H. Williams *W. H. Williams*

(Representative)

4150 E. Mexico Avenue

(Address)

Denver 22, Colorado

Ref. GLO Plat Dated 8 Feb. 1884

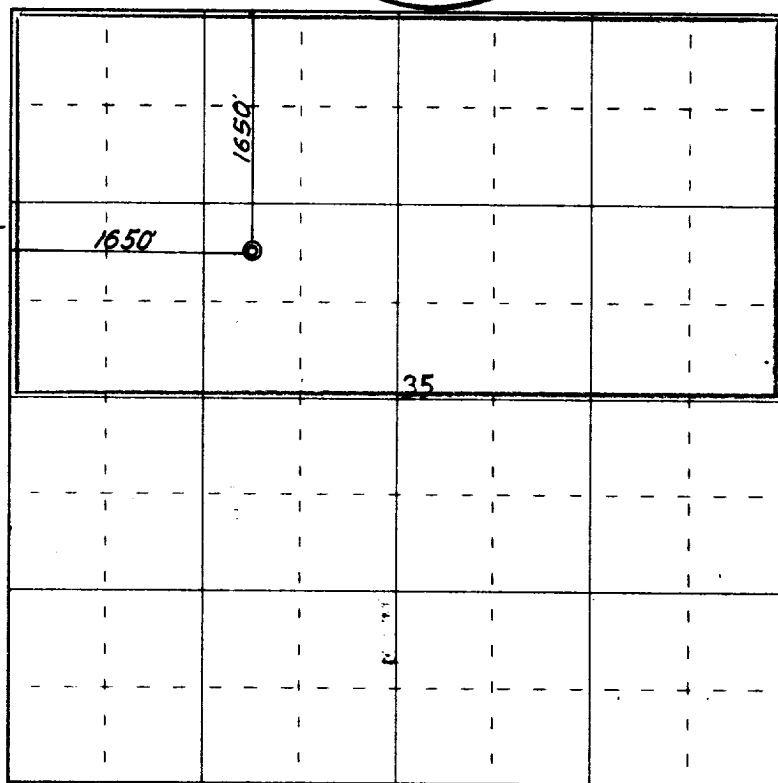

0 330 660 990 1320 1650 1980 2310 2640 2000 1500 1000 500 0

Scale 4 inches equal 1 mile

This is to certify that the above plat was prepared from field notes of actual surveys made by me or under my supervision and that the same are true and correct to the best of my knowledge and belief.

Date Surveyed 31 July 1962

James P. Leese
 Registered Professional Engineer and/or Land Surveyor
 James P. Leese N. Mex. Reg. No. 1463
 San Juan Engineering Company

Farmington, New Mexico

