

(SUBMIT IN TRIPLICATE)

UNITED STATES  
DEPARTMENT OF THE INTERIOR  
GEOLOGICAL SURVEY

Land Office Santa Fe  
Lease No. 079364  
Unit Rincon Unit

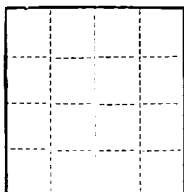

SUNDRY NOTICES AND REPORTS ON WELLS

NOTICE OF INTENTION TO DRILL.....	SUBSEQUENT REPORT OF WATER SHUT-OFF.....
NOTICE OF INTENTION TO CHANGE PLANS.....	SUBSEQUENT REPORT OF SHOOTING OR ACIDIZING.....
NOTICE OF INTENTION TO TEST WATER SHUT-OFF.....	SUBSEQUENT REPORT OF ALTERING CASING.....
NOTICE OF INTENTION TO RE-DRILL OR REPAIR WELL.....	SUBSEQUENT REPORT OF RE-DRILLING OR REPAIR.....
NOTICE OF INTENTION TO SHOOT OR ACIDIZE.....	SUBSEQUENT REPORT OF ABANDONMENT.....
NOTICE OF INTENTION TO PULL OR ALTER CASING.....	SUPPLEMENTARY WELL HISTORY.....
NOTICE OF INTENTION TO ABANDON WELL.....	

(INDICATE ABOVE BY CHECK MARK NATURE OF REPORT, NOTICE, OR OTHER DATA)

January 20, 1959

Well No. 40 is located 940 ft. from N line and 1496 ft. from W line of sec. 30  
30 Sec. 30 27N 6W N.M.P.M.  
(1/4 Sec. and Sec. No.) (Twp.) (Range) (Meridian)  
X. Blanco P. C. Rio Arriba New Mexico  
(Field) (County or Subdivision) (State or Territory)

The elevation of the derrick floor above sea level is 6614 ft.

DETAILS OF WORK

(State names of and expected depths to objective sands; show sizes, weights, and lengths of proposed casings; indicate mudding jobs, cementing points, and all other important proposed work)

This report is re-issued to show correct location from recent United States Cadastral Survey. This is a completed well.

I understand that this plan of work must receive approval in writing by the Geological Survey before operations may be commenced.

Company El Paso Natural Gas Company  
Address Box 997  
Farmington, New Mexico  
By Original Signed R. G. MILLER  
Title Petroleum Engineer

## NEW MEXICO OIL CONSERVATION COMMISSION

## Well Location and Acreage Dedication Plat

Section A.

Date **JANUARY 9, 1959**

Operator **EL PASO NATURAL GAS COMPANY** Lease **RINCON** SF **079364**  
 Well No. **48** Unit Letter **N** Section **30** Township **27-N** Range **6-W** NMPM  
 Located **940** Feet From **SOUTH** Line, **1496** Feet From **WEST** Line  
 County **RIO ARriba** G. L. Elevation **6614** Dedicated Acreage **159.52** Acres  
 Name of Producing Formation **PICTURED CLIFF** Pool **SOUTH BLANCO PICTURED CLIFF**

1. Is the Operator the only owner in the dedicated acreage outlined on the plat below?  
 Yes ☒ No ☐
2. If the answer to question one is "no", have the interests of all the owners been consolidated by communitization agreement or otherwise? Yes ☐ No ☐ If answer is "yes", Type of Consolidation.
3. If the answer to question two is "no", list all the owners and their respective interests below:

Owner

Land Description

Section B.

This is to certify that the information in Section A above is true and complete to the best of my knowledge and belief.

**El Paso Natural Gas Company**

(Operator)

Original Signed **R. G. MILLER****Box 997**

(Address)

**Farmington, New Mexico**

**NOTE:** THIS PLAT IS RE-ISSUED TO SHOW CORRECT LOCATION FROM RECENT UNITED STATES CADASTRAL SURVEY. THIS IS A COMPLETED WELL. 1 9 59

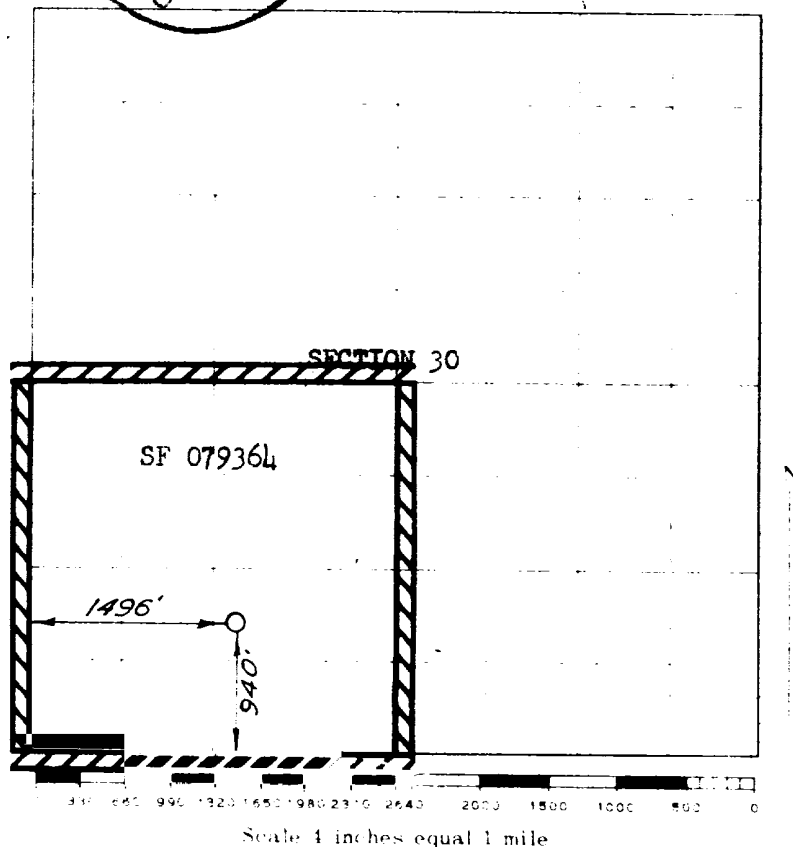

Scale 4 inches equal 1 mile

This is to certify that the above plat was prepared from field notes of actual surveys made by me or under my supervision and that the same are true and correct to the best of my knowledge and belief.

(Seal)

Date Surveyed **JANUARY 2, 1959**

*David A. Kilmer*  
 Registered Professional Engineer and/or Land Surveyor

Farmington, New Mexico