

(SUBMIT IN TRIPLICATE)

UNITED STATES
DEPARTMENT OF THE INTERIOR
GEOLOGICAL SURVEY

Land Office Santa Fe
Lease No. 079364
Unit Alcon Unit

SUNDRY NOTICES AND REPORTS ON WELLS

NOTICE OF INTENTION TO DRILL	<input type="checkbox"/>	SUBSEQUENT REPORT OF WATER SHUT-OFF	<input type="checkbox"/>
NOTICE OF INTENTION TO CHANGE PLANS	<input type="checkbox"/>	SUBSEQUENT REPORT OF SHOOTING OR ACIDIZING	<input type="checkbox"/>
NOTICE OF INTENTION TO TEST WATER SHUT-OFF	<input type="checkbox"/>	SUBSEQUENT REPORT OF ALTERING CASING	<input type="checkbox"/>
NOTICE OF INTENTION TO RE-DRILL OR REPAIR WELL	<input type="checkbox"/>	SUBSEQUENT REPORT OF RE-DRILLING OR REPAIR	<input type="checkbox"/>
NOTICE OF INTENTION TO SHOOT OR ACIDIZE	<input type="checkbox"/>	SUBSEQUENT REPORT OF ABANDONMENT	<input type="checkbox"/>
NOTICE OF INTENTION TO PULL OR ALTER CASING	<input type="checkbox"/>	SUPPLEMENTARY WELL HISTORY	<input type="checkbox"/>
NOTICE OF INTENTION TO ABANDON WELL	<input type="checkbox"/>		

RECEIVED
DEC 9 1959
U. S. GEOLOGICAL SURVEY
FARMINGTON, NEW MEXICO

(INDICATE ABOVE BY CHECK MARK NATURE OF REPORT, NOTICE, OR OTHER DATA)

December 2, 1959

Well No. 145 is located 77 ft. from S line and 1650 ft. from E line of sec. 29
Sec. 29 (1/4 Sec. and Sec. No.)
Co. Blanco P.C. (Field)
27N (Twp.)
On (Range)
N.M.L.M. (Meridian)
Rio Arriba (County or Subdivision)
New Mexico (State or Territory)

The elevation of the derrick floor above sea level is 6700 ft.

DETAILS OF WORK

(State names of and expected depths to objective sands; show sizes, weights, and lengths of proposed casings; indicate mudlogging jobs, cementing points, and all other important proposed work)

It is intended to drill a well thru the pictured Cliff formation using rotary tools and to perforate and water fracture possible producing zones. Est. T. D. 3300'.

Casing Program:

- 6 5/8" at 120' with 125 sacks regular cement circulated to surf ce.
- 5 1/2" at 3355' with 75 sacks regular cement, 75 sacks foamix.

The 31/4 of Section 29 is dedicated to this well.

I understand that this plan of work must receive approval in writing by the Geological Survey before operations may be commenced.

Company El Paso Natural Gas Company

Address Box 507

Farmington, New Mexico

By Original Signed E. H. V. COB

Title Petroleum Engineer

NEW MEXICO OIL CONSERVATION COMMISSION

Well Location and Acreage Dedication Plat

Date **DECEMBER 3, 1959**

Section A.

Operator **EL PASO NATURAL GAS COMPANY** Lease **RINCON UNIT** SF **079364**
 Well No. **115** Unit Letter **0** Section **29** Township **27-N** Range **6-W** NMPM
 Located **990** Feet From **SOUTH** Line, **1650** Feet From **EAST** Line
 County **RIO ARriba** G. L. Elevation **6695** Dedicated Acreage **160** Acres
 Name of Producing Formation **PICTURED CLIFF** Pool **SOUTH BLANCO PICTURED CLIFF**

1. Is the Operator the only owner in the dedicated acreage outlined on the plat below?
 Yes ☒ No ☐
2. If the answer to question one is "no", have the interests of all the owners been consolidated by communitization agreement or otherwise? Yes ☐ No ☐ If answer is "yes", Type of Consolidation.
3. If the answer to question two is "no", list all the owners and their respective interests below:

Owner

Land Description



Section B.

Note: All distances must be from outer boundaries of section.

This is to certify that the information in Section A above is true and complete to the best of my knowledge and belief.

El Paso Natural Gas Company

(Operator)

Original Signed **F. H. WOOD**

(Representative)

Box 997

(Address)

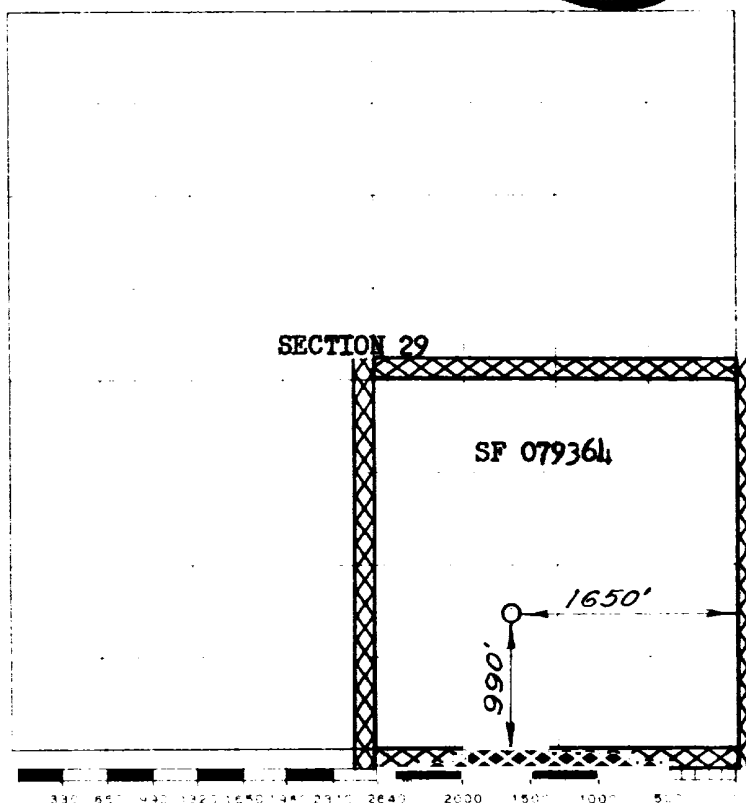
Farmington, New Mexico

Scale 1 inch equals 1 mile

This is to certify that the above plat was prepared from field notes of actual surveys made by me or under my supervision and that the same are true and correct to the best of my knowledge and belief.

(Seal)

Date Surveyed

NOVEMBER 3, 1959

Farmington, New Mexico

Ernest O. Nielsen
 Registered Professional Engineer and/or Land Surveyor