

(SUBMIT IN TRIPLICATE)

UNITED STATES
DEPARTMENT OF THE INTERIOR
GEOLOGICAL SURVEY

Land Office Santa Fe
Lease No. 58770
Unit San Juan 27-4- Unit
16-03-001-1054

SUNDRY NOTICES AND REPORTS ON WELLS

NOTICE OF INTENTION TO DRILL.....	<input checked="" type="checkbox"/>	SUBSEQUENT REPORT OF WATER SHUT-OFF.....	
NOTICE OF INTENTION TO CHANGE PLANS.....		SUBSEQUENT REPORT OF SHOOTING OR ACIDIZING.....	
NOTICE OF INTENTION TO TEST WATER SHUT-OFF.....		SUBSEQUENT REPORT OF ALTERING CASING.....	
NOTICE OF INTENTION TO RE-DRILL OR REPAIR WELL.....		SUBSEQUENT REPORT OF RE-DRILLING OR REPAIR.....	
NOTICE OF INTENTION TO SHOOT OR ACIDIZE.....		SUBSEQUENT REPORT OF ABANDONMENT.....	
NOTICE OF INTENTION TO PULL OR ALTER CASING.....		SUPPLEMENTARY WELL HISTORY.....	
NOTICE OF INTENTION TO ABANDON WELL.....			

(INDICATE ABOVE BY CHECK MARK NATURE OF REPORT, NOTICE, OR OTHER DATA)

May 20

1960

Well No. 25 is located 890 ft. from S line and 1180 ft. from W line of sec. 30
S.W. Sec. 30 27 N 4 W N.M.P.M.
(1/4 Sec. and Sec. No.) (Twp.) (Range) (Meridian)
Blanco Mesa Verde Rio Arriba New Mexico
(Field) (County or Subdivision) (State or Territory)

The elevation of the derrick floor above sea level is 5759 ft.

DETAILS OF WORK

(State names of and expected depths to objective sands; show sizes, weights, and lengths of proposed casings; indicate mudding jobs, cementing points, and all other important proposed work)

It is intended to drill a well with rotary tools thru the Mesa Verde formation. Mud circulation will be used thru the Pictured Cliffs and set intermediate casing. Gas circulation will be used thru the Mesa Verde and production liner will be set. Possible productive intervals will be perforated and fractured. Estimated T. D. 5950'

Casing Program:

10 3/4" at 170' with 350 sacks cement circulated to the surface.
7 5/8" at 3750' with 250 sacks cement.
5 1/2" liner at 5950' with 300 sacks cement.

The W/2 of Section 30 is dedicated to this well.
W/2 OF 000670

I understand that this plan of work must receive approval in writing by the Geological Survey before operations may be commenced.

Company El Paso Natural Gas Company
Address Box 997
Farmington, New Mexico

By ORIGINAL SIGNED J.J. TILLERSON
Title Petroleum Engineer

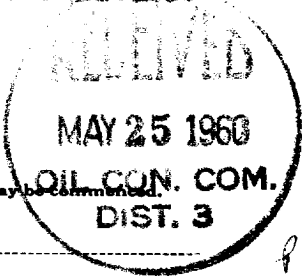

Well Location and Acreage Dedication Plat

Section A.

Date **MAY 10, 1960**

Operator **EL PASO NATURAL GAS COMPANY** Lease **SAN JUAN 27-4 UNIT** SF **080670**
 Well No. **25** Unit Letter **M** Section **30** Township **27-N** Range **4-W** NMPM
 Located **890** Feet From **SOUTH** Line, **1180** Feet From **WEST** Line
 County **RIO ARriba** G. L. Elevation **6759** Dedicated Acreage **321.56** Acres
 Name of Producing Formation **MESA VERDE** Pool **BLANCO MESA VERDE**

1. Is the Operator the only owner in the dedicated acreage outlined on the plat below?

Yes _____ No **X**2. If the answer to question one is "no", have the interests of all the owners been consolidated by communitization agreement or otherwise? Yes **X** No _____. If answer is "yes", Type of Consolidation.

Unit Agreement

3. If the answer to question two is "no", list all the owners and their respective interests below:

Owner

Land Description

Section B.

This is to certify that the information in Section A above is true and complete to the best of my knowledge and belief.

El Paso Natural Gas CompanyORIGINAL SIGNED **J.J. TILLERSON**

(Representative)

Box 997

(Address)

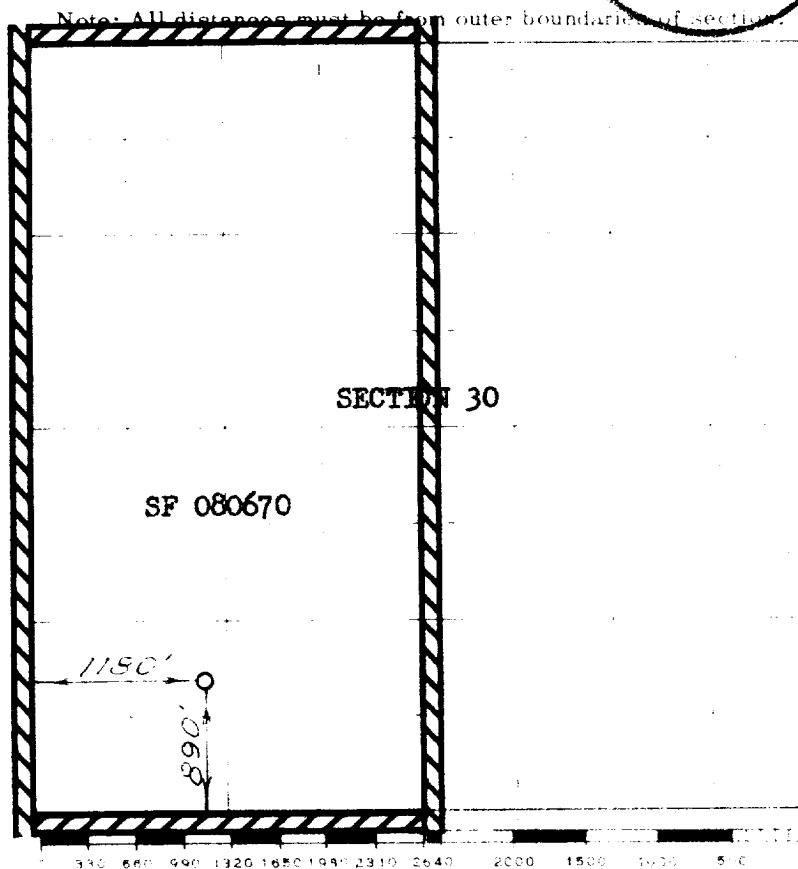
Farmington, New Mexico

Scale 4 inches equal 1 mile

This is to certify that the above plat was prepared from field notes of actual surveys made by me or under my supervision and that the same are true and correct to the best of my knowledge and belief.

(Seal)

Date Surveyed **APRIL 5, 1960**

David O. Kilburn
 Registered Professional Engineer and/or Land Surveyor

Farmington, New Mexico