

NEW MEXICO OIL CONSERVATION COMMISSION

Well Location and Acreage Dedication Plat

Section A.

Date November 4, 1963

Operator BENSON MONTIN GEESE DRILLING CO. P. Lease JICARILLA
 Well No. H-19 Unit Letter H Section 19 Township 27N Range 1E NMPM
 Located 1980 Feet From North Line, 660 Feet From East Line
 County RIO ARriba G. L. Elevation 7064.0 Dedicated Acreage 160 Acres
 Name of Producing Formation Gallup Pool Puerto Chiquito

1. Is the Operator the only owner in the dedicated acreage outlined on the plat below?
 Yes X No _____
2. If the answer to question one is "no", have the interests of all the owners been consolidated by communitization agreement or otherwise? Yes _____ No _____. If answer is "yes", Type of Consolidation.

2. If the answer to question two is "no", list all the owners and their respective interests below:

Owner

Land Description

Section B.

This is to certify that the information in Section A above is true and complete to the best of my knowledge and belief.

BENSON-MONTIN-GEESE DRILLING
 (Operator) Albert K. Geese **CORP.**

(Representative)
158 Petroleum Center Building

(Address)
Farmington, New Mexico

Note: All distances must be from outer boundaries of section.

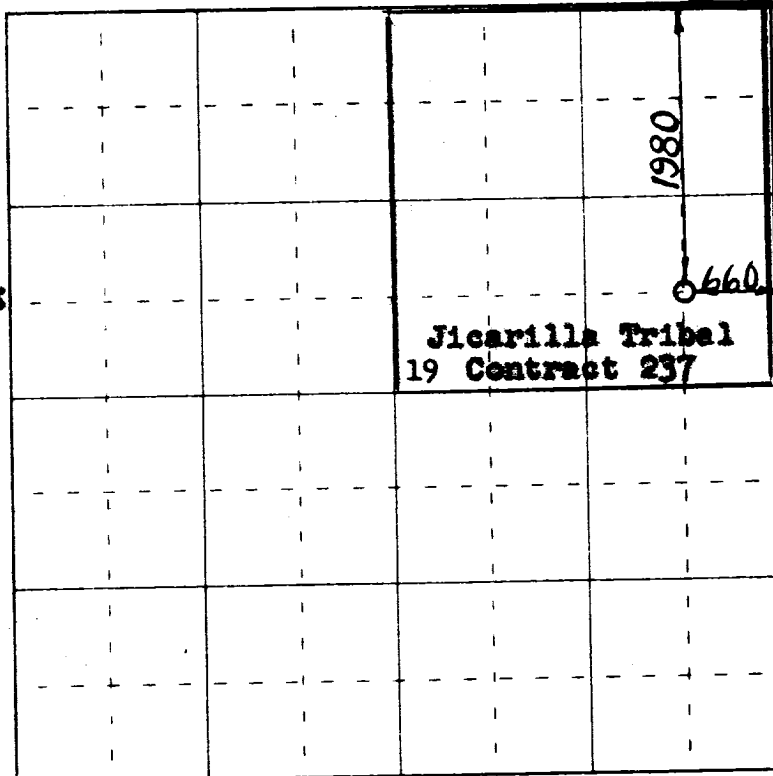

0 330 660 990 1320 1650 1980 2310 2640 2000 1500 1000 500 0

Scale 4 inches equal 1 mile

This is to certify that the above plat was prepared from field notes of actual surveys made by me or under my supervision and that the same are true and correct to the best of my knowledge and belief.

(Seal)

Farmington, New Mexico

Date Surveyed 1 October 1963

James P. Geese
 Registered Professional Engineer and/or Land Surveyor
 James P. Geese N. Mex Reg. No. 1463