

(SUBMIT IN TRIPLICATE)

UNITED STATES
DEPARTMENT OF THE INTERIOR
GEOLOGICAL SURVEY

Land Office Santa Fe
Lease No. 079394
Unit San Juan 27-5 Unit
14-08-001-950

SUNDRY NOTICES AND REPORTS ON WELLS

NOTICE OF INTENTION TO DRILL.....	<input checked="" type="checkbox"/>	SUBSEQUENT REPORT OF WATER SHUT-OFF.....
NOTICE OF INTENTION TO CHANGE PLANS.....	<input type="checkbox"/>	SUBSEQUENT REPORT OF SHOOTING OR ACIDIZING.....
NOTICE OF INTENTION TO TEST WATER SHUT-OFF.....	<input type="checkbox"/>	SUBSEQUENT REPORT OF ALTERING CASING.....
NOTICE OF INTENTION TO RE-DRILL OR REPAIR WELL.....	<input type="checkbox"/>	SUBSEQUENT REPORT OF RE-DRILLING OR REPAIR.....
NOTICE OF INTENTION TO SHOOT OR ACIDIZE.....	<input type="checkbox"/>	SUBSEQUENT REPORT OF ABANDONMENT.....
NOTICE OF INTENTION TO PULL OR ALTER CASING.....	<input type="checkbox"/>	SUPPLEMENTARY WELL HISTORY.....
NOTICE OF INTENTION TO ABANDON WELL.....	<input type="checkbox"/>	

(INDICATE ABOVE BY CHECK MARK NATURE OF REPORT, NOTICE, OR OTHER DATA)

May 19 19 61

Well No. 66 (PM) is located 1090 ft. from N line and 990 ft. from W line of sec. 27

S.W. Section 27 27-N 5-W N.M.P.M.
(1/4 Sec. and Sec. No.) (Twp.) (Range) (Meridian)

So. Blanco P.E. Ext. & Blanco Mesa Verde Rio Arriba New Mexico
(Field) (County or Subdivision) (State or Territory)

The elevation of the derrick floor above sea level is 5485 ft.

DETAILS OF WORK

(State names of and expected depths to objective sands; show sizes, weights, and lengths of proposed casings; indicate mudding jobs, cementing points, and all other important proposed work)

It is intended to drill and dual complete a well in the Pictured Cliffs formation & Mesa Verde formation. Mud circulation will be used thru the Pictured Cliffs formation & thru the Mesa Verde. 2 strings of 2 7/8" casing will be set. Possible productive intervals will be perforated and fractured. Est. T.D. 5565'.

Casing Program:

- 10 3/4" @ 120' with 170 sacks cement circulated to surface.
- 2 7/8" @ 3465' with 240 sacks cement - 150% to cover Ojo Alamo.
- 2 7/8" @ 5565' with 160 sacks cement - 150% to cover 500' above Cliff House top.

The W/2 of Section 27 is dedicated to the Mesa Verde formation.
The SW/4 of Section 27 is dedicated to the Pictured Cliffs formation.

I understand that this plan of work must receive approval in writing by the Geological Survey before operations may be commenced.

Company El Paso Natural Gas Company

Address Box 990

Farmington, New Mexico

By

Title Petroleum Engineer

Original Signed D. W. Meehan

NEW MEXICO OIL CONSERVATION COMMISSION

Well Location and Acreage Dedication Plat

Date May 2, 1961

Section A.

Operator EL PASO NATURAL GAS COMPANY Lease SAN JUAN 27-5 UNIT SF 079394
 Well No. 66 (PM) Unit Letter M Section 27 Township 27-N Range 5-W NMPM
 Located 1090 Feet From SOUTH Line, 990 Feet From WEST Line
 County RIO ARriba G. L. Elevation 6475 Dedicated Acreage 160 & 320 Acres
 Name of Producing Formation PICTURED CLIFFS & MESA VERDE Pool SO. BLANCO P.C. EXT. &

1. Is the Operator the only owner in the dedicated acreage outlined on the plat below? BLANCO M.V.
 Yes No X

2. If the answer to question one is "no", have the interests of all the owners been consolidated by communitization agreement or otherwise? Yes X No . If answer is "yes", Type of Consolidation.

Unit Agreement

3. If the answer to question two is "no", list all the owners and their respective interests below:

Owner

Land Description

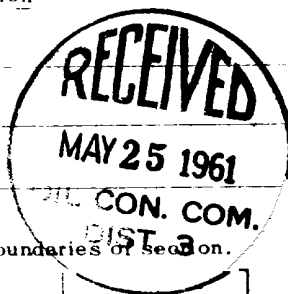
EY
100

Section B.

This is to certify that the information in Section A above is true and complete to the best of my knowledge and belief.

El Paso Natural Gas Company
 (Operator)
 Original Signed D. W. Meehan
 (Representative)

Box 990

(Address)

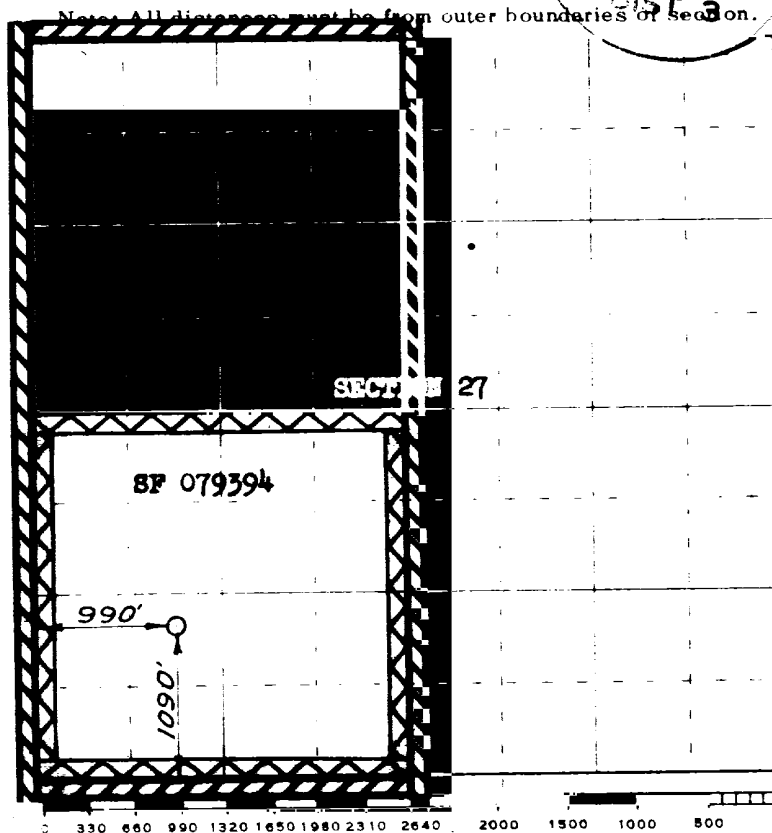
Farmington, New Mexico

Scale 4 inches equal 1 mile

This is to certify that the above plat was prepared from field notes of actual surveys made by me or under my supervision and that the same are true and correct to the best of my knowledge and belief.

(Seal)

Date Surveyed December 31, 1958E. D. M. D. 7