

NEW MEXICO OIL CONSERVATION COMMISSION

Well Location and Acreage Dedication Plat

Section A.

Date Nov. 12, 1957

Operator MAGNOLIA PETROLEUM COMPANY Lease JICARILLA "G"  
Well No. 4 Unit Letter Section 26 Township 27N Range 3W NMPM  
Located 990 Feet From South Line, 990 Feet From West Line  
County Rio Arriba G. L. Elevation 7284 Dedicated Acreage 160 Acres  
Name of Producing Formation Pictured Cliffs Pool Undesignated Pictured Cliffs Gas

1. Is the Operator the only owner\* in the dedicated acreage outlined on the plat below?  
Yes XX No       .
2. If the answer to question one is "no," have the interests of all the owners been consolidated by communitization agreement or otherwise? Yes        No       . If answer is "yes," Type of Consolidation
3. If the answer to question two is "no," list all the owners and their respective interests below:

Owner

Land Description

Section B.

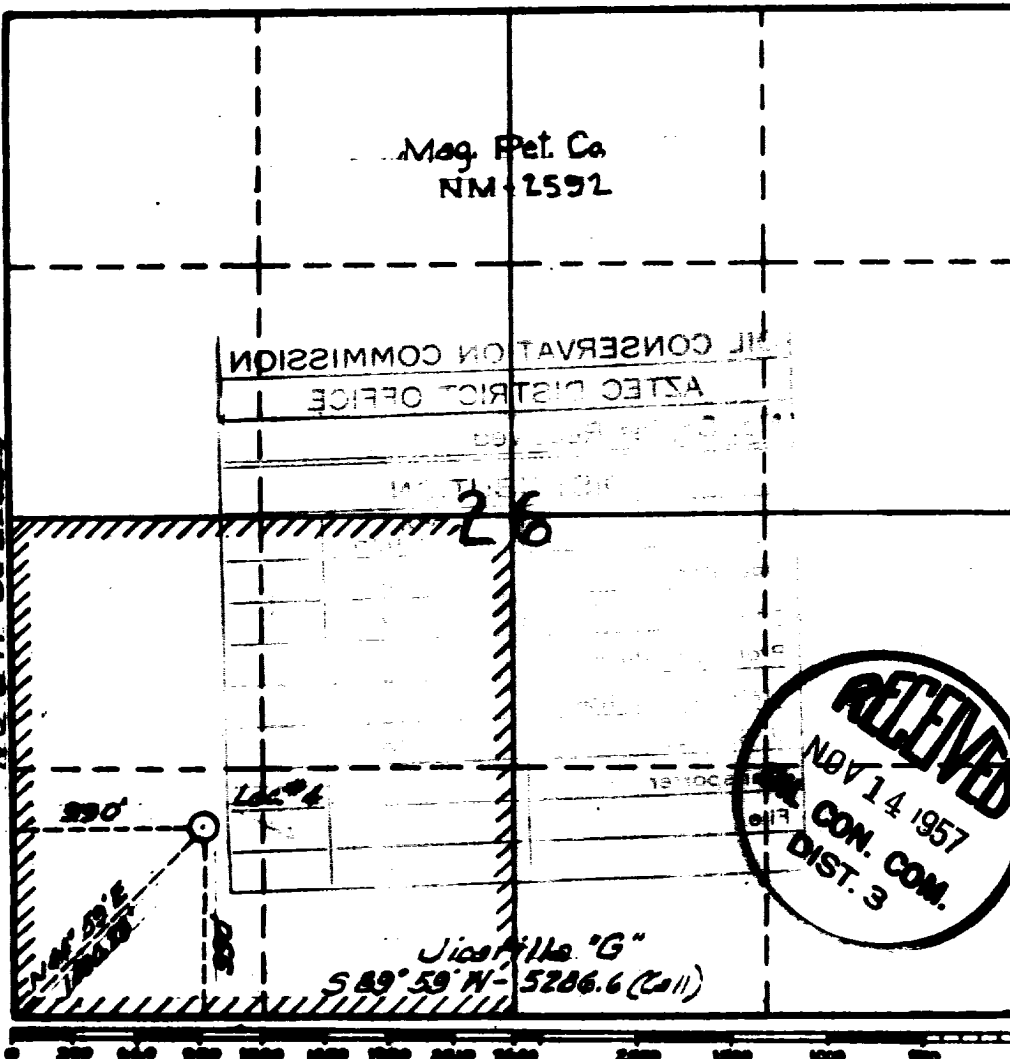

This is to certify that the information in Section A above is true and complete to the best of my knowledge and belief.

Magnolia Petroleum Company

(Operator)

(Representative)

Box 2406, Hobbs, New Mexico

Address

This is to certify that the well location shown on the plat in Section B was plotted from field notes of actual surveys made by me or under my supervision and that the same is true and correct to the best of my knowledge and belief.

Date Surveyed July 25, 1957

Carl E. Turner  
Registered Professional  
Engineer and/or Land Surveyor.

Certificate No. 2453

11/11/68

11/11/68

11/11/68

11/11/68

11/11/68

11/11/68

11/11/68

11/11/68

11/11/68

11/11/68

11/11/68

11/11/68

11/11/68

11/11/68

11/11/68

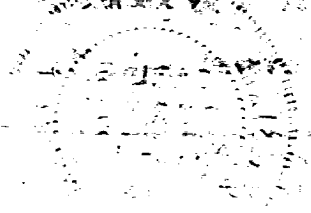

OIL CONSERVATION COMMISSION		
AZTEC DISTRICT OFFICE		
No. Copies Received	6	
DISTRIBUTION		
Director	2	
Assistant	1	
Secretary		
Steno		
S.S.	2	
Transporter		
File	1	✓