

(SUBMIT IN TRIPLICATE)

UNITED STATES
DEPARTMENT OF THE INTERIOR
GEOLOGICAL SURVEY

Land Office Santa Fe
Lease No. 000325
Unit Lincoln Unit

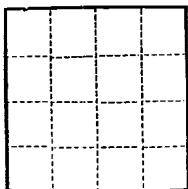

SUNDRY NOTICES AND REPORTS ON WELLS

NOTICE OF INTENTION TO DRILL.....	SUBSEQUENT REPORT OF WATER SHUT-OFF.....	
NOTICE OF INTENTION TO CHANGE PLANS.....	SUBSEQUENT REPORT OF SHOOTING OR ACIDIZING.....	
NOTICE OF INTENTION TO TEST WATER SHUT-OFF.....	SUBSEQUENT REPORT OF ALTERING CASING.....	
NOTICE OF INTENTION TO RE-DRILL OR REPAIR WELL.....	SUBSEQUENT REPORT OF RE-DRILLING OR REPAIR.....	
NOTICE OF INTENTION TO SHOOT OR ACIDIZE.....	SUBSEQUENT REPORT OF ABANDONMENT.....	
NOTICE OF INTENTION TO PULL OR ALTER CASING.....	SUPPLEMENTARY WELL HISTORY.....	
NOTICE OF INTENTION TO ABANDON WELL.....		

(INDICATE ABOVE BY CHECK MARK NATURE OF REPORT, NOTICE, OR OTHER DATA)

August 20, 1958

Well No. 37 is located 172 ft. from N line and 142 ft. from W line of sec. 26

37 Sec. 26 215 75 N.M.P.M.
(1/4 Sec. and Sec. No.) (Twp.) (Range) (Meridian)
So. Blanco P.G. Pio Arriba New Mexico
(Field) (County or Subdivision) (State or Territory)

The elevation of the derrick floor above sea level is 6723 ft.

DETAILS OF WORK

(State names of and expected depths to objective sands; show sizes, weights, and lengths of proposed casings; indicate mudding jobs, cementing points, and all other important proposed work)

This plat is reissued to show correct location from recent United States Cadastral Survey. This is a completed well.

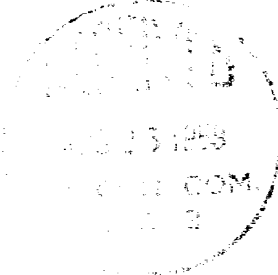

I understand that this plan of work must receive approval in writing by the Geological Survey before operations may be commenced.

Company El Paso Natural Gas Company
Address Box 907
Farmington, New Mexico
By Original Signed C. D. COX
Title Petroleum Engineer

Well Location and Acreage Dedication Plat

Section A.

Date **JULY 30, 1958**

Operator **EL PASO NATURAL GAS COMPANY** Lease **RINCON UNIT** SF **080385**
 Well No. **37** Unit Letter **K** Section **26** Township **27-N** Range **7-W** NMPM
 Located **1784** Feet From **SOUTH** Line **1649** Feet From **WEST** Line
 County **RIO ARriba** G. L. Elevation **6703** Dedicated Acreage **160** Acres
 Name of Producing Formation **PICTURED CLIFF** Pool **SOUTH BLANCO PICTURED CLIFF**

1. Is the Operator the only owner in the dedicated acreage outlined on the plat below?

Yes **XX** No

2. If the answer to question one is "no", have the interests of all the owners been consolidated by communitization agreement or otherwise? Yes No If answer is "yes", Type of Consolidation.

3. If the answer to question two is "no", list all the owners and their respective interests below:

Owner

Land Description

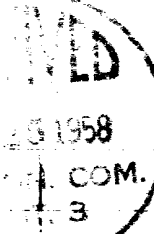

RECEIVED
AUG 22 1958
 U. S. Geological Survey
 FARMINGTON, NEW MEXICO

Section B.

Note: All distances must be from outer boundaries of section.

This is to certify that the information
 in Section A above is true and complete
 to the best of my knowledge and belief.

El Paso Natural Gas Company

(Operator)

Original Signed **C. D. COX**

(Representative)

Box **997**

(Address)

Farmington, New Mexico

**NOTE: THIS PLAT REISSUED TO SHOW
 CORRECT LOCATION FROM RECENT
 UNITED STATES CADASTRAL
 SURVEY. THIS IS A COMPLETED
 WELL. 7 30 58**

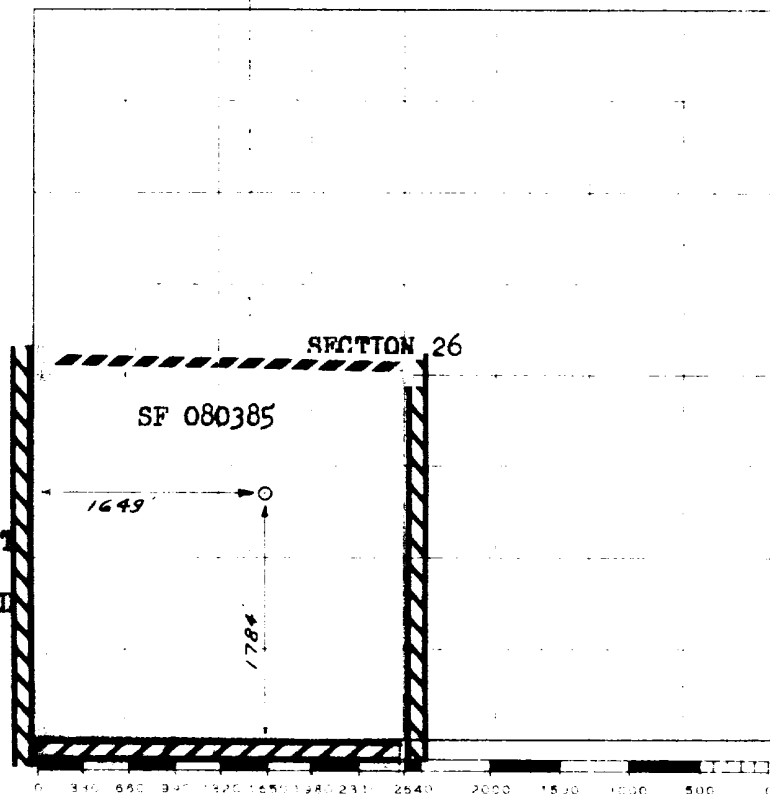

Scale 4 inches equal 1 mile

This is to certify that the above plat was prepared from field notes of actual surveys
 made by me or under my supervision and that the same are true and correct to the best
 of my knowledge and belief.

(Seal)

Date Surveyed **FEBRUARY 5, 1955***David O. Vilnen*

Registered Professional Engineer and/or Land Surveyor

Farmington, New Mexico