

(SUBMIT IN TRIPLICATE)

UNITED STATES
DEPARTMENT OF THE INTERIOR
GEOLOGICAL SURVEY

Land Office **Santa Fe**
Lease No. **079321**
Unit **Rincon Unit**

SUNDRY NOTICES AND REPORTS ON WELLS

NOTICE OF INTENTION TO DRILL	XX SUBSEQUENT REPORT OF WATER SHUT OFF
NOTICE OF INTENTION TO CHANGE PLAN	SUBSEQUENT REPORT OF SHOOTING OR ABLADING
NOTICE OF INTENTION TO TEST WATER SHUT OFF	SUBSEQUENT REPORT OF ALTERING CASING
NOTICE OF INTENTION TO REPAIR OR REPAIR WELL	SUBSEQUENT REPORT OF REPAIRING OR REPAIR
NOTICE OF INTENTION TO SHUT OFF WELL	SUBSEQUENT REPORT OF ABANDONMENT
NOTICE OF INTENTION TO TEST WATER SHUT OFF	SUPPLEMENTARY WELL LOG
NOTICE OF INTENTION TO ABANDON WELL	

RECEIVED

AUG 29 1962

U.S. GEOLOGICAL SURVEY
SANTA FE, N.M.
1962

August 24,

Well No. 139 is located 1650 ft. from ~~XXX~~ line and 1650 ft. from ~~XXX~~ sec. 25

SW/4 Section 25

27-N 7-W

N.M.P.M.

Basin Dakota

Rio Arriba

New Mexico

The elevation of the derrick floor above sea level is 6657 ft.

DETAILS OF WORK

State names and extent of lands, and the names of the owners, and the names of proposed casings; indicate the following jobs: cementing, perforating, and all other work.

It is intended to mud drill a well with rotary tools thru the Dakota formation, and to perforate and fracture possible producing zones. Est. T.D. 7617'.

Casing Program:

9 5/8" @ 300' w/210 sacks cement circulated to surface.
4 1/2" @ 7617' w/two & three stage collars. Set 2nd stage collar 50-100' below base of Mesa Verde, 3rd stage 50-100' below base of Pictured Cliffs. Cement 1st stage w/135 sacks to cover 200' above Greenhorn, 2nd stage w/200 sacks to cover 100' above Cliff House, 3rd stage w/210 sacks cement to cover Ojo Alamo.

The S/2 of Section 25 is dedicated to this well.

Company El Paso Natural Gas Company

Address Box 990

Farmington, New Mexico

W. V. Meekins

Petroleum Engineer

NEW MEXICO OIL CONSERVATION COMMISSION

Well Location and Acreage Dedication Plat

Section A.

Date **AUGUST 7, 1962**

Operator **EL PASO NATURAL GAS COMPANY** Lease **RINCON UNIT** **SF079321**
 Well No. **139** Unit Letter **K** Section **25** Township **27-N** Range **7-W** NMPM
 Located **1650** Feet From **SOUTH** Line, **1650** Feet From **WEST** Line
 County **RIO ARriba** G. L. Elevation **6647** Dedicated Acreage **328.45** Acres
 Name of Producing Formation **DAKOTA** Pool **BASIN DAKOTA**

1. Is the Operator the only owner in the dedicated acreage outlined on the plat below?

Yes ☒ No ☐2. If the answer to question one is "no", have the interests of all the owners been consolidated by communitization agreement or otherwise? Yes ☐ No ☐ If answer is "yes", Type of Consolidation.

3. If the answer to question two is "no", list all the owners and their respective interests below:

Owner

Land Description

Section B.

Note: All distances must be from outer boundaries of section.

This is to certify that the information
 in Section A above is true and complete
 to the best of my knowledge and belief.

El Paso Natural Gas Company

(Operator)

Original Signed **D. W. Meehan**

(Representative)

Box 990

(Address)

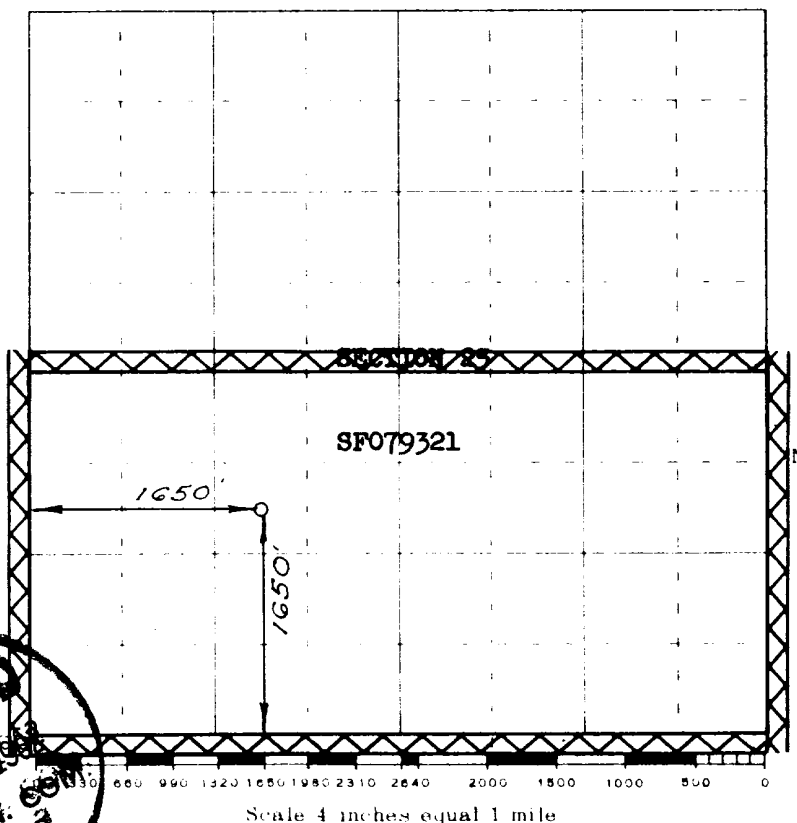
Farmington, New Mexico

Scale 4 inches equal 1 mile

This is to certify that the above plat was prepared from field notes of actual surveys made by me or under my supervision and that the same are true and correct to the best of my knowledge and belief.

(Seal)

Date Surveyed **NOVEMBER 20, 1958**

Farmington, New Mexico

Registered Professional Engineer and/or Land Surveyor