

(SUBMIT IN TRIPLICATE)

UNITED STATES  
DEPARTMENT OF THE INTERIOR  
GEOLOGICAL SURVEY

Budget Bureau No. 42-R-359.3.  
Approval expires 12-31-65.

Indian Agency Jicarilla Agency

Allottee \_\_\_\_\_

Lease No. Jicarilla Cont. #92

J. carilla

SUNDRY NOTICES AND REPORTS ON WELLS

NOTICE OF INTENTION TO DRILL	<input checked="" type="checkbox"/>	SUBSEQUENT REPORT OF WATER SHUT-OFF	<input type="checkbox"/>
NOTICE OF INTENTION TO CHANGE PLANS	<input type="checkbox"/>	SUBSEQUENT REPORT OF SHOOTING OR ACIDIZING	<input type="checkbox"/>
NOTICE OF INTENTION TO TEST WATER SHUT-OFF	<input type="checkbox"/>	SUBSEQUENT REPORT OF ALTERING CASING	<input type="checkbox"/>
NOTICE OF INTENTION TO REDRILL OR REPAIR WELL	<input type="checkbox"/>	SUBSEQUENT REPORT OF REDRILLING OR REPAIR	<input type="checkbox"/>
NOTICE OF INTENTION TO SHOOT OR ACIDIZE	<input type="checkbox"/>	SUBSEQUENT REPORT OF ABANDONMENT	<input type="checkbox"/>
NOTICE OF INTENTION TO PULL OR ALTER CASING	<input type="checkbox"/>	SUPPLEMENTARY WELL HISTORY	<input type="checkbox"/>
NOTICE OF INTENTION TO ABANDON WELL	<input type="checkbox"/>		

(INDICATE ABOVE BY CHECK MARK NATURE OF REPORT, NOTICE, OR OTHER DATA)

August 9, 1960

Well No. 92-2 is located 1650 ft. from S line and 1460 ft. from W line of sec. 29

SW 1/4 Sec. 29

(1/4 Sec. and Sec. No.)

27N

(Twp.)

3W

(Range)

N.M.P.M.

(Meridian)

Wildcat Dakota

(Field)

Rio Arriba

(County or Subdivision)

New Mexico

(State or Territory)

The elevation of the derrick floor above sea level is 7168 ft.

DETAILS OF WORK

(State names of and expected depths to objective sands; show sizes, weights, and lengths of proposed casings; indicate mudding jobs, cementing points, and all other important proposed work)

It is intended to drill and complete this well in the Dakota formation. Mud circulation will be used from surface to total depth and production casing will be set. Possible productive intervals will be perforated and fractured.

Est. T. D. 8474'.

10 3/4" at 300' w/300 sacks cement circulated to surface.

5 1/2" at 8474' w/250 sacks cement & two stage tool at 6300' w/400 sacks cement.

The W/2 of Section 29 is dedicated to the Dakota formation.



I understand that this plan of work must receive approval in writing by the Geological Survey before operations may be commenced.

Company El Paso Natural Gas Company

Address Box 990

Farmington, New Mexico

By Original Signed R. G. MILLER

Title Petroleum Engineer



## NEW MEXICO OIL CONSERVATION COMMISSION

## Well Location and Acreage Dedication Plat

Section A.

Date **AUGUST 3, 1960**

Operator **EL PASO NATURAL GAS COMPANY** Lease **JICARILLA** **JICARILLA APACHE CONT. 92**  
 Well No. **92-2** Unit Letter **K** Section **29** Township **27-N** Range **3-W** NMPM  
 Located **1650** Feet From **SOUTH** Line, **1160** Feet From **WEST** Line  
 County **RIO ARriba** G. L. Elevation **7178** Dedicated Acreage **320** Acres  
 Name of Producing Formation **DAKOTA** Pool **WILDCAT DAKOTA**

1. Is the Operator the only owner in the dedicated acreage outlined on the plat below?  
 Yes \_\_\_\_\_ No **X** \_\_\_\_\_
2. If the answer to question one is "no", have the interests of all the owners been consolidated by communization agreement or otherwise? Yes **X** No \_\_\_\_\_. If answer is "yes", Type of Consolidation.  
**Operating Agreement.**
3. If the answer to question two is "no", list all the owners and their respective interests below:

Owner

Land Description



Section B.

This is to certify that the information in Section A above is true and complete to the best of my knowledge and belief.

**El Paso Natural Gas Company**

(Operator)

Original Signed **R. G. MILLER**

(Representative)

**Box 990**

(Address)

**Farmington, New Mexico**

Note: All distances must be from outer boundaries of section.

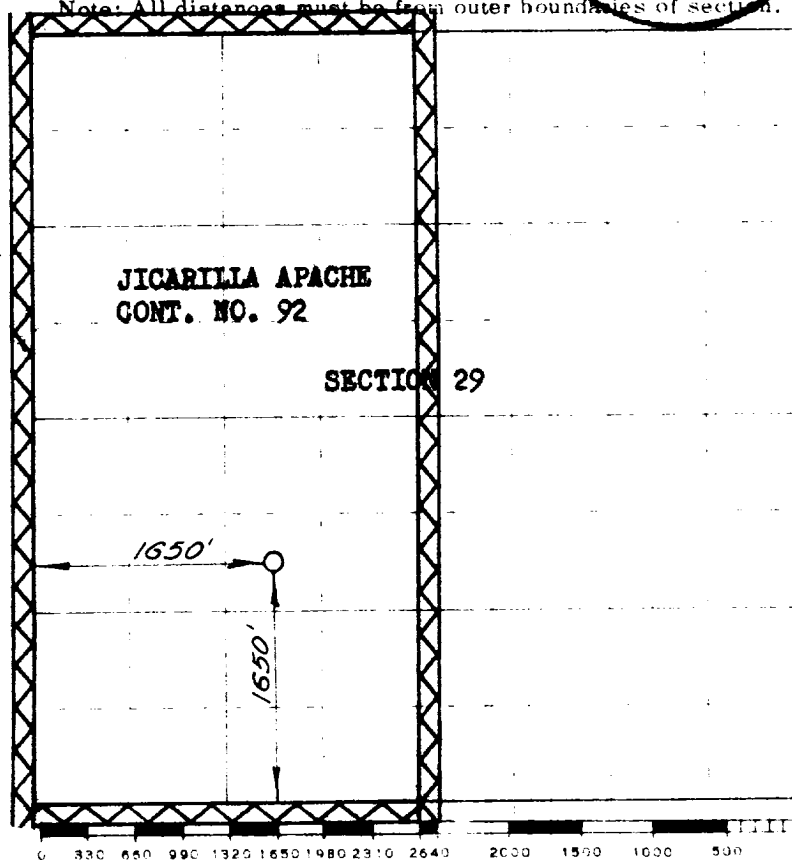

Scale 1 inch equal 1 mile

This is to certify that the above plat was prepared from field notes of actual surveys made by me or under my supervision and that the same are true and correct to the best of my knowledge and belief.

(Seal)

Date Surveyed **JULY 26, 1960**

*David O. Kilburn*  
 Registered Professional Engineer and/or Land Surveyor

Farmington, New Mexico

## NEW MEXICO OIL CONSERVATION COMMISSION

Well Location and Acreage Dedication Plat

Section A.

Date **AUGUST 3, 1960**

Operator **EL PASO NATURAL GAS COMPANY** Lease **JICARILLA** **JICARILLA APACHE CONT. 92**  
 Well No. **92-2** Unit Letter **K** Section **29** Township **27-N** Range **3-W** NMPM  
 Located **1650** Feet From **SOUTH** Line, **1160** Feet From **WEST** Line  
 County **RIO ARriba** G. L. Elevation **7178** Dedicated Acreage **320** Acres  
 Name of Producing Formation **DAKOTA** Pool **WILDCAT DAKOTA**

1. Is the Operator the only owner in the dedicated acreage outlined on the plat below?  
 Yes \_\_\_\_\_ No **X** \_\_\_\_\_
2. If the answer to question one is "no", have the interests of all the owners been consolidated by communization agreement or otherwise? Yes **X** No \_\_\_\_\_. If answer is "yes", Type of Consolidation.  
**Operating Agreement.**
3. If the answer to question two is "no", list all the owners and their respective interests below:

OwnerLand Description

Section B.

This is to certify that the information in Section A above is true and complete to the best of my knowledge and belief.

**El Paso Natural Gas Company**

(Operator)

Original Signed **R. G. MILLER**

(Representative)

**Box 990**

(Address)

**Farmington, New Mexico**

Note: All distances must be from outer boundaries of section.

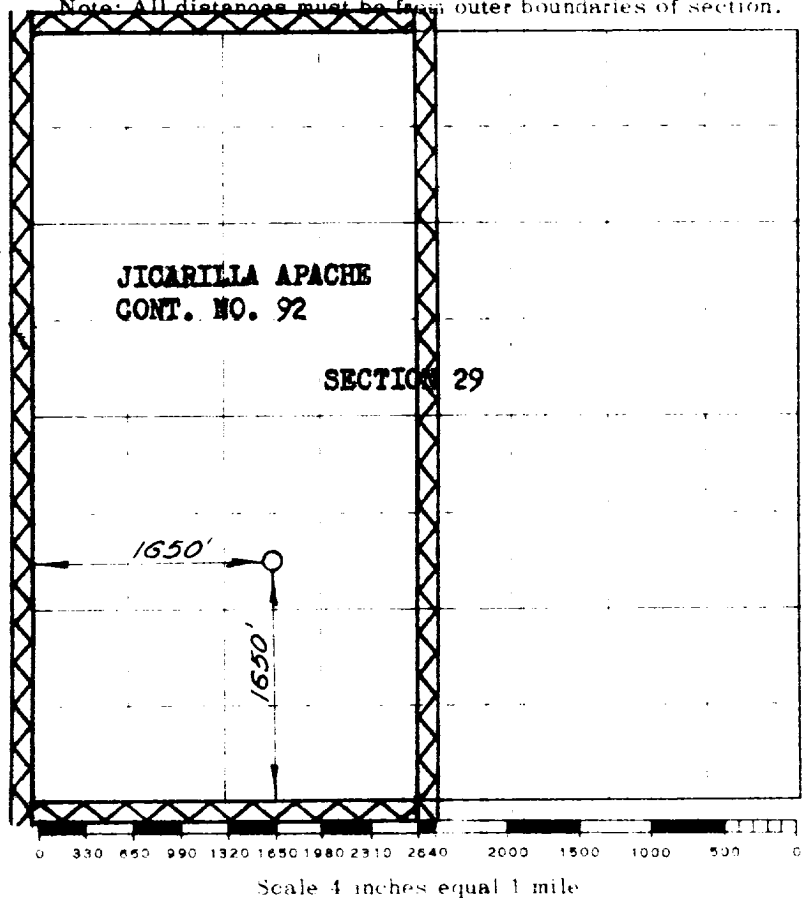

This is to certify that the above plat was prepared from field notes of actual surveys made by me or under my supervision and that the same are true and correct to the best of my knowledge and belief.

(Seal)

Date Surveyed **JULY 26, 1960**

*David O. Kilbuck*  
 Registered Professional Engineer and/or Land Surveyor

Farmington, New Mexico

## NEW MEXICO OIL CONSERVATION COMMISSION

## Well Location and Acreage Dedication Plat

Section A.

Date **AUGUST 3, 1960**

Operator **EL PASO NATURAL GAS COMPANY** Lease **JICARILLA** **JICARILLA APACHE CONT. 92**  
 Well No. **92-2** Unit Letter **K** Section **29** Township **27-N** Range **3-W** NMPM  
 Located **1650** Feet From **SOUTH** Line, **1460** Feet From **WEST** Line  
 County **RIO ARriba** G. L. Elevation **7178** Dedicated Acreage **320** Acres  
 Name of Producing Formation **DAKOTA** Pool **WILDCAT DAKOTA**

1. Is the Operator the only owner in the dedicated acreage outlined on the plat below?  
 Yes \_\_\_\_\_ No **X**
2. If the answer to question one is "no", have the interests of all the owners been consolidated by communitization agreement or otherwise? Yes **X** No \_\_\_\_\_. If answer is "yes", Type of Consolidation.

## Operating Agreement

3. If the answer to question two is "no", list all the owners and their respective interests below:

Owner

Land Description

Section B.

This is to certify that the information in Section A above is true and complete to the best of my knowledge and belief.

**El Paso Natural Gas Company**  
 (Operator)

**ORIGINAL SIGNED H.E. McANALLY**  
 (Representative)

**Box 990**  
 (Address)

**Farmington, New Mexico**

**NOTE: THIS PLAT IS RE-ISSUED TO SHOW CORRECTED LOCATION. 1 13 61**

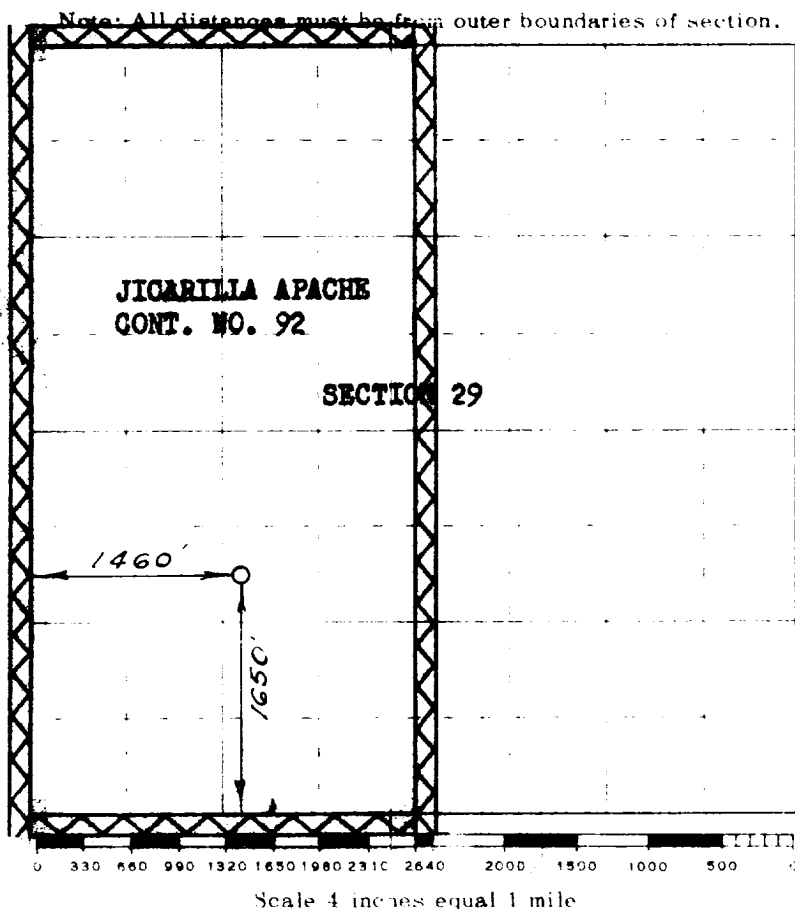

(Seal)

Farmington, New Mexico

This is to certify that the above plat was prepared from field notes of actual surveys made by me or under my supervision and that the same are true and correct to the best of my knowledge and belief.

Date Surveyed **JULY 26, 1960**

*David O. Kilnen*  
 Registered Professional Engineer and/or Land Surveyor