

(SUBMIT IN TRIPLICATE)

UNITED STATES
DEPARTMENT OF THE INTERIOR
GEOLOGICAL SURVEY

Land Office New Mexico
Lease No. 03560
Unit San Juan 28-7 Unit
14-08-001-459

SUNDRY NOTICES AND REPORTS ON WELLS

NOTICE OF INTENTION TO DRILL	<input checked="" type="checkbox"/>	SUBSEQUENT REPORT OF WATER SHUT-OFF	
NOTICE OF INTENTION TO CHANGE PLANS		SUBSEQUENT REPORT OF SHOOTING OR ACIDIZING	
NOTICE OF INTENTION TO TEST WATER SHUT-OFF		SUBSEQUENT REPORT OF ALTERING CASING	
NOTICE OF INTENTION TO RE-DRILL OR REPAIR WELL		SUBSEQUENT REPORT OF RE-DRILLING OR REPAIR	
NOTICE OF INTENTION TO SHOOT OR ACIDIZE		SUBSEQUENT REPORT OF ABANDONMENT	
NOTICE OF INTENTION TO PULL OR ALTER CASING		SUPPLEMENTARY WELL HISTORY	
NOTICE OF INTENTION TO ABANDON WELL			

(INDICATE ABOVE BY CHECK MARK NATURE OF REPORT, NOTICE, OR OTHER DATA)

June 1, 19 61

Well No. 123 is located 1720 ft. from N line and 1665 ft. from W line of sec. 30

NW/4 Sec. 30 27 N 7W N.M.P.M.
(1/4 Sec. and Sec. No.) (Twp.) (Range) (Meridian)

South Blanco Pictured Cliffs Bio Arriba New Mexico
(Field) (County or Subdivision) (State or Territory)

The elevation of the derrick floor above sea level is 6030 ft.

DETAILS OF WORK

(State names of and expected depths to objective sands; show sizes, weights, and lengths of proposed casings; indicate mudding jobs, cementing points, and all other important proposed work)

It is intended to drill a well with rotary tools through the Pictured Cliffs formation and to perforate and fracture possible productive zones. Est. T. D. 2377'.

Casing Program:

9 5/8" set at 100' with 140 sacks of cement circulated to the surface.
2 7/8" set at 2377' with 240 sacks of cement - 150% to cover Ojo Alamo.

The NW/4 of Section 30 is dedicated to this well.

I understand that this plan of work must receive approval in writing by the Geological Survey before operations may be commenced.

Company El Paso Natural Gas Company

Address Box 990

Farmington, New Mexico

By ORIGINAL SIGNED A.M. SMITH

Title Petroleum Engineer

Well Location and Acreage Dedication Plat

Section A.

Date May 8, 1961

Operator EL PASO NATURAL GAS COMPANY Lease SAN JUAN 28-7 UNIT NM 03560
 Well No. 123 Unit Letter F Section 30 Township 27-N Range 7-W NMPM
 Located 1720 Feet From NORTH Line 1665 Feet From WEST Line
 County RIO ARriba G. L. Elevation 6020 Dedicated Acreage 160.88 Acres
 Name of Producing Formation PICTURED CLIFFS Pool SO. BLANCO P.C.

1. Is the Operator the only owner in the dedicated acreage outlined on the plat below?
 Yes X No
2. If the answer to question one is "no", have the interests of all the owners been consolidated by communitization agreement or otherwise? Yes No . If answer is "yes", Type of Consolidation.
3. If the answer to question two is "no", list all the owners and their respective interests below:

Owner

Land Description



Section B.

This is to certify that the information in Section A above is true and complete to the best of my knowledge and belief.

~~EL PASO NATURAL GAS COMPANY~~

(Operator)

ORIGINAL SIGNED A.M. SMITH

(Representative)

~~Box 500~~

(Address)

~~Farmington, New Mexico~~

NOTE: This Plat Reissued to Show Corrected Location

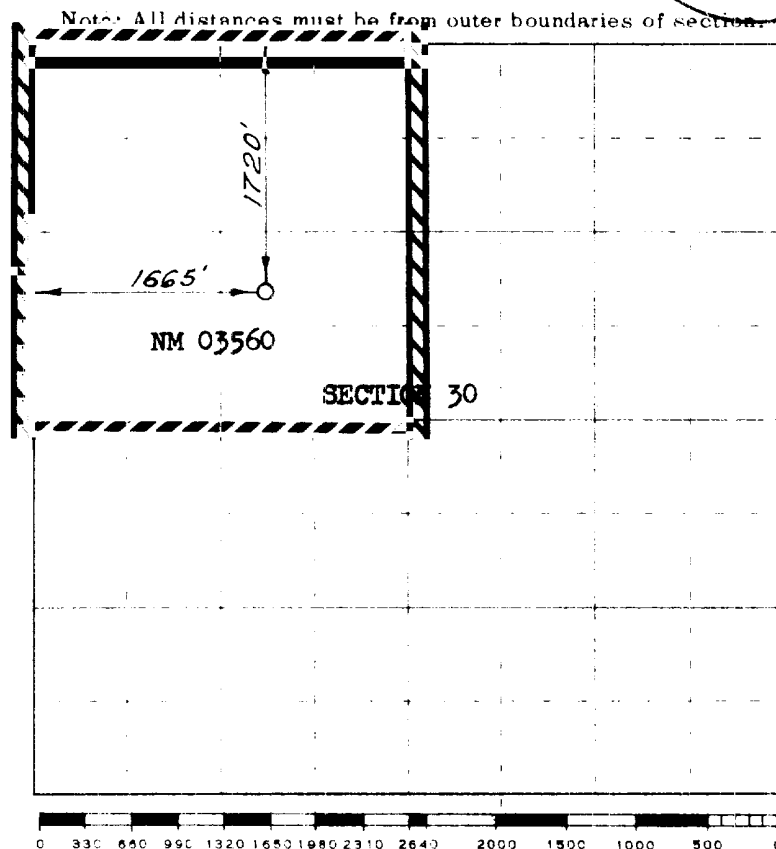

This is to certify that the above plat was prepared from field notes of actual surveys made by me or under my supervision and that the same are true and correct to the best of my knowledge and belief.

(Seal)

Date Surveyed May 5, 1961

Farmington, New Mexico

David O. Kilmer
 Registered Professional Engineer and/or Land Surveyor