

(SUBMIT IN TRIPLICATE)

UNITED STATES
DEPARTMENT OF THE INTERIOR
GEOLOGICAL SURVEY

Land Office Santa Fe
Lease No. 131335
Unit Alamosa Unit

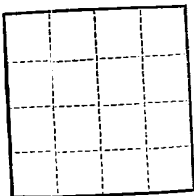

SUNDRY NOTICES AND REPORTS ON WELLS

NOTICE OF INTENTION TO DRILL		SUBSEQUENT REPORT OF WATER SHUT-OFF	
NOTICE OF INTENTION TO CHANGE PLANS		SUBSEQUENT REPORT OF SHOOTING OR ACIDIZING	
NOTICE OF INTENTION TO TEST WATER SHUT-OFF		SUBSEQUENT REPORT OF ALTERING CASING	
NOTICE OF INTENTION TO RE-DRILL OR REPAIR WELL		SUBSEQUENT REPORT OF RE-DRILLING OR REPAIR	
NOTICE OF INTENTION TO SHOOT OR ACIDIZE		SUBSEQUENT REPORT OF ABANDONMENT	
NOTICE OF INTENTION TO PULL OR ALTER CASING		SUPPLEMENTARY WELL HISTORY	<u>1</u>
NOTICE OF INTENTION TO ABANDON WELL			

(INDICATE ABOVE BY CHECK MARK NATURE OF REPORT, NOTICE, OR OTHER DATA)

August 20, 1953

Well No. 32 is located 2247 ft. from N line and 3001 ft. from E line of sec. 25

1M (1/4 Sec. and Sec. No.) 25 (Twp.) 7N (Range) 4N (Meridian)
100 (Field) Rio Arriba (County or Subdivision) New Mexico (State or Territory)

The elevation of the derrick floor above sea level is 5574 ft.

DETAILS OF WORK

(State names of and expected depths to objective sands; show sizes, weights, and lengths of proposed casings; indicate mudding jobs, cementing points, and all other important proposed work)

This plan is returned to show correct location from recent United States Geological Survey. This is a completed well.

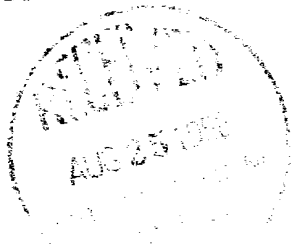

I understand that this plan of work must receive approval in writing by the Geological Survey before operations may be commenced.

Company El Paso Natural Gas Company
Address Box 307
Farmington, New Mexico
By Original Signed C. D. COX
Title Geological Engineer

NEW MEXICO OIL CONSERVATION COMMISSION

Well Location and Acreage Dedication Plat

Section A.

Date **AUGUST 5, 1958**

Operator **EL PASO NATURAL GAS COMPANY** Lease **RINCON UNIT** SF **080385**
 Well No. **39** Unit Letter **F** Section **26** Township **27-N** Range **7-W** NMPM
 Located **1647** Feet From **NORTH** Line, **1516** Feet From **WEST** Line
 County **RIO ARriba** G. L. Elevation **6674** Dedicated Acreage **160** Acres
 Name of Producing Formation **PICTURED CLIFF** Pool **SOUTH BLANCO PICTURED CLIFF**

1. Is the Operator the only owner in the dedicated acreage outlined on the plat below?

Yes **XX** No

2. If the answer to question one is "no", have the interests of all the owners been consolidated by communitization agreement or otherwise? Yes No If answer is "yes", Type of Consolidation.

3. If the answer to question two is "no", list all the owners and their respective interests below:

Owner

Land Description

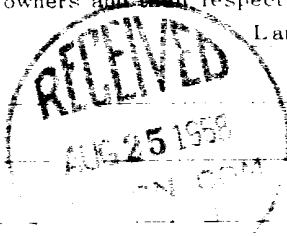

RECEIVED

AUG 22 1958

U. S. GEOLOGICAL SURVEY
FARMINGTON, NEW MEXICO

Section B.

This is to certify that the information
in Section A above is true and complete
to the best of my knowledge and belief.

El Paso Natural Gas Company

(Operator)
Original Signed **C. D. COX**
(Representative)

Box 997

(Address)

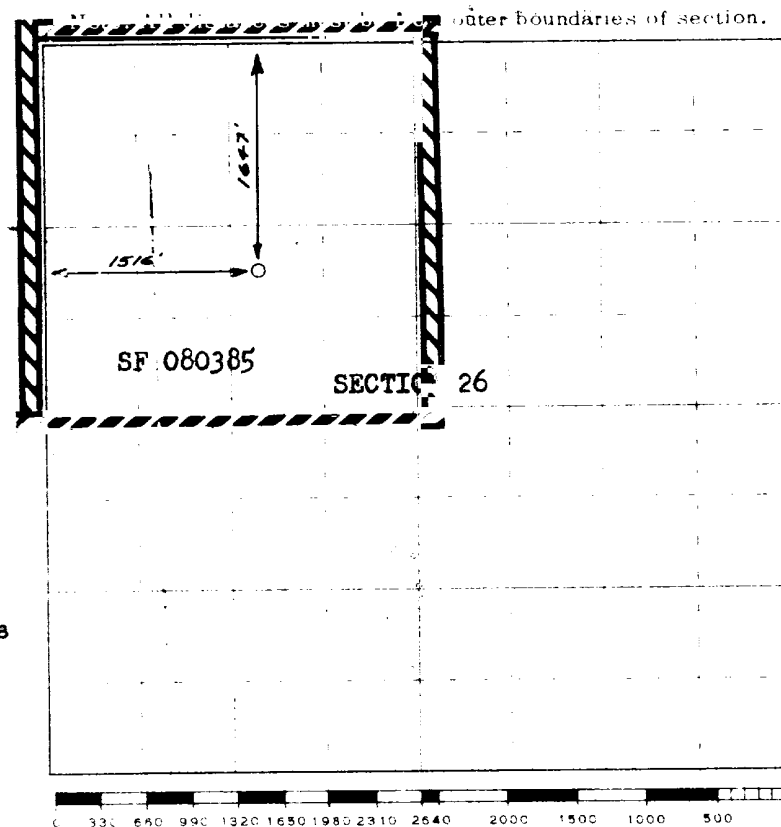
Farmington, New Mexico

Scale 4 inches equal 1 mile

NOTE: THIS PLAT IS REISSUED TO SHOW
CORRECT LOCATION FROM RECENT
UNITED STATES CADASTRAL SURVEY.
THIS IS A COMPLETED WELL. 8 5 58

This is to certify that the above plat was prepared from field notes of actual surveys
made by me or under my supervision and that the same are true and correct to the best
of my knowledge and belief.

(Seal)

Date Surveyed **FEBRUARY 5, 1955**

David A. Kilburn
Registered Professional Engineer and/or Land Surveyor

Farmington, New Mexico