

(SUBMIT IN TRIPLICATE)

UNITED STATES
DEPARTMENT OF THE INTERIOR
GEOLOGICAL SURVEY

Land Office Santa Fe
Lease No. 079366
Unit Rincon Unit

SUNDRY NOTICES AND REPORTS ON WELLS

| | |
|---|---|
| NOTICE OF INTENTION TO DRILL..... | SUBSEQUENT REPORT OF WATER SHUT-OFF..... |
| NOTICE OF INTENTION TO CHANGE PLANS..... | SUBSEQUENT REPORT OF SHOOTING OR ACIDIZING..... |
| NOTICE OF INTENTION TO TEST WATER SHUT-OFF..... | SUBSEQUENT REPORT OF ALTERING CASING..... |
| NOTICE OF INTENTION TO RE-DRILL OR REPAIR WELL..... | SUBSEQUENT REPORT OF RE-DRILLING OR REPAIR..... |
| NOTICE OF INTENTION TO SHOOT OR ACIDIZE..... | SUBSEQUENT REPORT OF ABANDONMENT..... |
| NOTICE OF INTENTION TO PULL OR ALTER CASING..... | SUPPLEMENTARY WELL HISTORY..... |
| NOTICE OF INTENTION TO ABANDON WELL..... | |

(INDICATE ABOVE BY CHECK MARK NATURE OF REPORT, NOTICE, OR OTHER DATA)

March 15, 1957

Well No. 99 (FM) is located 1025 ft. from N line and 1025 ft. from E line of sec. 27
NE Section 27 27N 6W N.M.P.M.
($\frac{1}{4}$ Sec. and Sec. No.) (Twp.) (Range) (Meridian)
So. Blanco Ext. & Blanco Rio Arriba New Mexico
(Field) (County or Subdivision) (State or Territory)

The elevation of the derrick floor above sea level is 6538 ft.

DETAILS OF WORK

(State names of and expected depths to objective sands; show sizes, weights, and lengths of proposed casings; indicate mudding jobs, cementing points, and all other important proposed work)

This plat is re-issued to show corrected footages.



I understand that this plan of work must receive approval in writing by the Geological Survey before operations may be commenced.

Company El Paso Natural Gas Company

Address Box 997

Farmington, N.M.

By ORIGINAL SIGNED F. W. SOYD

Title Petroleum Engineer

NEW MEXICO
OIL CONSERVATION COMMISSION

Form O-128

WELL LOCATION AND/OR GAS PRORATION PLAT

DATE FEBRUARY 14, 1957

OPERATOR EL PASO NATURAL GAS COMPANY LEASE RINCON UNIT SF 079366

WELL NO. 99 (PM) SECTION 27 TOWNSHIP 27-N RANGE 6-W NADPM

LOCATED 1025 FEET FROM NORTH LINE 1025 FEET FROM EAST LINE

RIO ARriba

COUNTY, NEW MEXICO SO. BLANCO EXTEN. P.C. G.T. ELEVATION 6528

NAME P.C. & M.V. SO. BLANCO EXTEN. P.C. 160 AC. P.C.
POOL BLANCO M.V. DEDICATED ACREAGE 320 AC. M.V.
(1882 PLAT)

Note: All distances must be from outer boundaries of section.

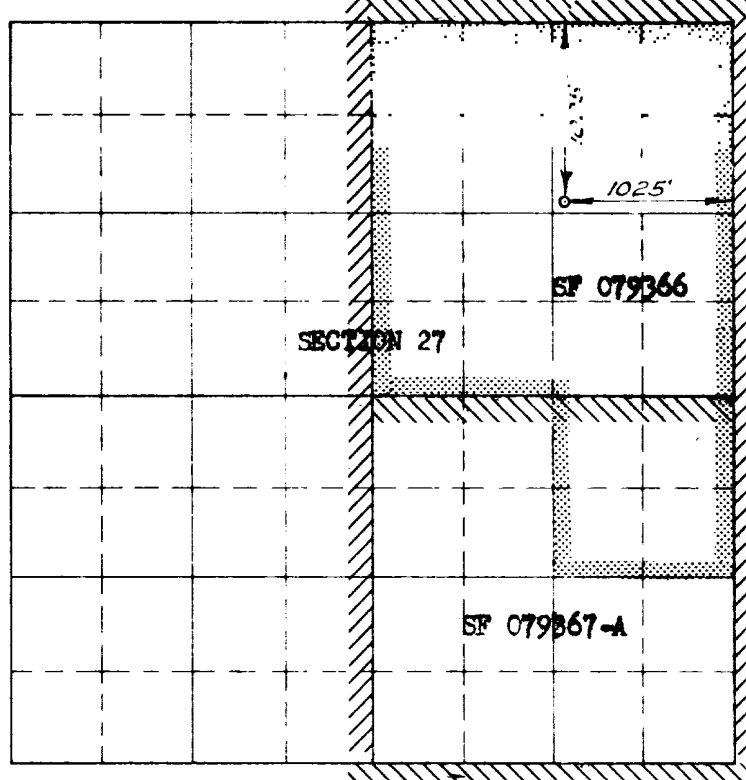

This section of
form is to be used
for gas wells only

This is to certify that the above plat was prepared from
field notes of actual surveys made by me or under my
supervision and that the same are true and correct to the
best of my knowledge and belief.

Date Surveyed JANUARY 28, 1957

E. O. Walker
Registered Professional Engineer and/or Land Surveyor

1. Is this well a Dual Comp.
Yes X No _____
2. If the answer to Question 1
is yes, are there any other dually
completed wells within the
dedicated acreage.
Yes _____ No X

Name ORIGINAL SIGNED F. W. BOYD
Position Petroleum Engineer
Representing El Paso Natural Gas Co.
Address Box 997 - Farmington, N.M.

(Seal)

NOTE: THIS PLAT IS RE-ISSUED TO SHOW CORRECTED LEASE INFORMATION. 2 10 57

NOTE: THIS PLAT IS RE-ISSUED TO SHOW CORRECTED FOOTAGES. 3 12 57

Farmington, New Mexico