

(SUBMIT IN TRIPLICATE)

Land Office Santa Fe  
Lease No. 080385  
Unit Rincon Unit

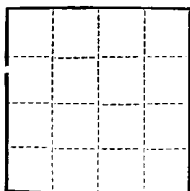

UNITED STATES  
DEPARTMENT OF THE INTERIOR  
GEOLOGICAL SURVEY

RECEIVED

SUNDRY NOTICES AND REPORTS ON WELLS

NOTICE OF INTENTION TO DRILL.....	<input checked="" type="checkbox"/>	SUBSEQUENT REPORT OF WATER SHUT-OFF.....	
NOTICE OF INTENTION TO CHANGE PLANS.....		SUBSEQUENT REPORT OF SHOOTING OR ACIDIZING.....	
NOTICE OF INTENTION TO TEST WATER SHUT-OFF.....		SUBSEQUENT REPORT OF ALTERING CASING.....	
NOTICE OF INTENTION TO RE-DRILL OR REPAIR WELL.....		SUBSEQUENT REPORT OF RE-DRILLING OR REPAIR.....	
NOTICE OF INTENTION TO SHOOT OR ACIDIZE.....		SUBSEQUENT REPORT OF ABANDONMENT.....	
NOTICE OF INTENTION TO PULL OR ALTER CASING.....		SUPPLEMENTARY WELL HISTORY.....	
NOTICE OF INTENTION TO ABANDON WELL.....			

(INDICATE ABOVE BY CHECK MARK NATURE OF REPORT, NOTICE, OR OTHER DATA)

July 3, 1962

Well No. 172 is located 950 ft. from N line and 1650 ft. from E line of sec. 26  
NE/4 Section 26 27-N 7-W N.M.P.M.  
(1/4 Sec. and Sec. No.) (Twp.) (Range) (Meridian)  
Basin Dakota Rio Arriba New Mexico  
(Field) (County or Subdivision) (State or Territory)

The elevation of the derrick floor above sea level is 5731 ft.

DETAILS OF WORK

(State names of and expected depths to objective sands; show sizes, weights, and lengths of proposed casings; indicate reudding jobs, cementing points, and all other important proposed work)

It is intended to mud drill a well with rotary tools thru the Dakota formation. Possible producing zones will be perforated and fractured. Est. T.D. 7720'.

Casing Program:

2 5/8" set at 300' with 210 sacks cement circulated to surface.  
4 1/2" set at 7720' with 3 stage tool, set 2nd stage collar 50' 100' below base of Mesa Verde & 3rd stage 50-100 below base of Pictured Cliffs, Cement 1st stage w/135 sacks to cover 200' above Greenhorn, 2nd stage w/200 sks. to cover 100' above Cliff House, 3rd stage w/210 sks. to cover Ojo Alamo.

The N/2 of Section 26 is dedicated to this well.

I understand that this plan of work must receive approval in writing by the Geological Survey before operations may be commenced.

Company El Paso Natural Gas Company

Address Box 990  
Farmington, New Mexico

By Original Signed by W. Meenan

Title Petroleum Engineer

## NEW MEXICO OIL CONSERVATION COMMISSION

## Well Location and Acreage Dedication Plat

Section A.

Date **JUNE 12, 1962**

Operator **EL PASO NATURAL GAS COMPANY** Lease **RINCON UNIT** SF080385  
 Well No. **172** Unit Letter **B** Section **26** Township **27-N** Range **7-W** NMPM  
 Located **950** Feet From **NORTH** Line, **1650** Feet From **EAST** Line  
 County **RIO ARriba** G. L. Elevation **6721** Dedicated Acreage **339.08** Acres  
 Name of Producing Formation **DAKOTA** Pool **BASIN DAKOTA**

1. Is the Operator the only owner in the dedicated acreage outlined on the plat below?  
 Yes ☒ No ☐

2. If the answer to question one is "no", have the interests of all the owners been consolidated by communitization, agreement or otherwise? Yes ☐ No ☐ If answer is "yes", Type of Consolidation.

3. If the answer to question two is "no", list all the owners and their respective interests below:

Owner

Land Description



Section B.

This is to certify that the information in Section A above is true and complete to the best of my knowledge and belief.

El Paso Natural Gas Company

(Operator)  
Original Signed **D. W. Meehan**

(Representative)

Box 990

(Address)

Farmington, New Mexico

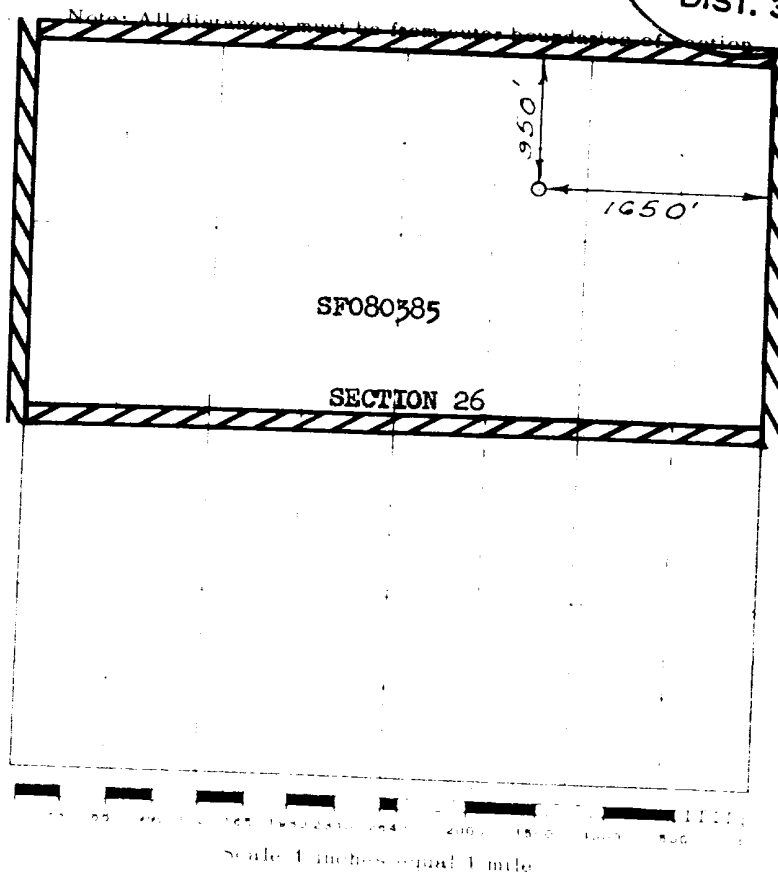

This is to certify that the above plat was prepared from field notes of actual surveys made by me or under my supervision and that the same are true and correct to the best of my knowledge and belief.

Date Surveyed

**JUNE 11, 1962**

*David L. Kline*  
 Registered Professional Engineer and/or Land Surveyor

State:

Farmington, New Mexico