

(SUBMIT IN TRIPLICATE)

Indian Agency Alamogordo TribalCenter, 495, East 21st

Allottee _____

Lease No. Alamogordo 99UNITED STATES
DEPARTMENT OF THE INTERIOR
GEOLOGICAL SURVEY

SUNDRY NOTICES AND REPORTS ON WELLS

NOTICE OF INTENTION TO DRILL.....	<input checked="" type="checkbox"/>	SUBSEQUENT REPORT OF WATER SHUT-OFF.....	
NOTICE OF INTENTION TO CHANGE PLANS.....		SUBSEQUENT REPORT OF SHOOTING OR ACIDIZING.....	
NOTICE OF INTENTION TO TEST WATER SHUT-OFF.....		SUBSEQUENT REPORT OF ALTERING CASING.....	
NOTICE OF INTENTION TO REDRILL OR REPAIR WELL.....		SUBSEQUENT REPORT OF REDRILLING OR REPAIR.....	
NOTICE OF INTENTION TO SHOOT OR ACIDIZE.....		SUBSEQUENT REPORT OF ABANDONMENT.....	
NOTICE OF INTENTION TO PULL OR ALTER CASING.....		SUPPLEMENTARY WELL HISTORY.....	
NOTICE OF INTENTION TO ABANDON WELL.....			

(INDICATE ABOVE BY CHECK MARK NATURE OF REPORT, NOTICE, OR OTHER DATA)

RECEIVED
AUG 3 1958
U. S. GEOLOGICAL SURVEY
FARMINGTON, NEW MEXICO

August 6, 1958

Well No. 8 is located 990 ft. from N line and 990 ft. from E line of sec. 26

14 Sec. and Sec. No.
Alamogordo 99
(Field)

27N 3N
(Twp.) (Range)
Alamogordo
(County or Subdivision)

U.S.P.M.
(Meridian)
New Mexico
(State or Territory)

The elevation of the derrick floor above sea level is 7214 ft. MSL.

DETAILS OF WORK

(State names of and expected depths to objective sands; show sizes, weights, and lengths of proposed casings; indicate mudding jobs, cementing points, and all other important proposed work)

We propose to drill the above well to a total depth of 6450' with Rotary Tools. We expect to test the following zones at the following approximate depths if indicative of oil or gas show.

300'
Pictured Cliffs
New Verde

300'
300'
300'

We expect to test any other zones that appear productive of oil or gas.
Casing Program: To set approx. 300' of 10-3/4" Surface Cas. w/approx. 300 lbs. cement. Set approx. 400' of 7-5/8" Intermediate Cas. w/approx 150 lbs. cement. Set approx. 2500' of 5" liner on bottom @ 6450', cemented w/approx 225 lbs. cement. We propose to perforate and sand-enter-free productive zones in the Pictured Cliffs and New Verde zones for completion.

I understand that this plan of work must receive approval in writing by the Geological Survey before operations may be commenced.

Company Alamogordo Petroleum CompanyAddress P. O. Box 2106Alamogordo, New MexicoBy G. Young, Jr.Title District Superintendent

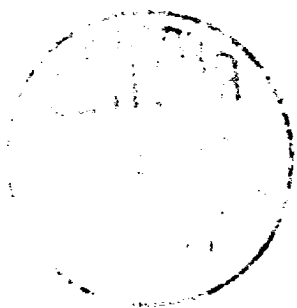

1954
1955
1956
1957
1958
1959
1960
1961
1962
1963
1964
1965
1966
1967
1968
1969
1970
1971
1972
1973
1974
1975
1976
1977
1978
1979
1980
1981
1982
1983
1984
1985
1986
1987
1988
1989
1990
1991
1992
1993
1994
1995
1996
1997
1998
1999
2000
2001
2002
2003
2004
2005
2006
2007
2008
2009
2010
2011
2012
2013
2014
2015
2016
2017
2018
2019
2020
2021
2022
2023
2024
2025

NEW MEXICO OIL CONSERVATION COMMISSION

Well Location and Acreage Dedication Plot

Section A.

Date August 5, 1958

Operator MAGNOLIA PETROLEUM COMPANY Lease JICARILLA "6"
Well No. 8 Unit Letter Section 26 Township 27N Range 3W NMPN
Located 990 Feet From North Line, 990 Feet From East Line
County Rio Arriba G. L. Elevation 7204 Dedicated Acreage 360 Acres
Name of Producing Formation Platoned Chiffs Pool Undesignated

1. Is the Operator the only owner in the dedicated acreage outlined on the plat below?
Yes X No
2. If the answer to question one is "no," have the interests of all the owners been consolidated by communitization agreement or otherwise? Yes No . If answer is "yes," Type of Consolidation
3. If the answer to question two is "no," list all the owners and their respective interests below:

Owner

Land Description

RECEIVED
AUG 8 1958
U.S. GEOLOGICAL SURVEY
FARMINGTON, NEW MEXICO

Section B.

N89° 51' W (Call) 80.14 Ch

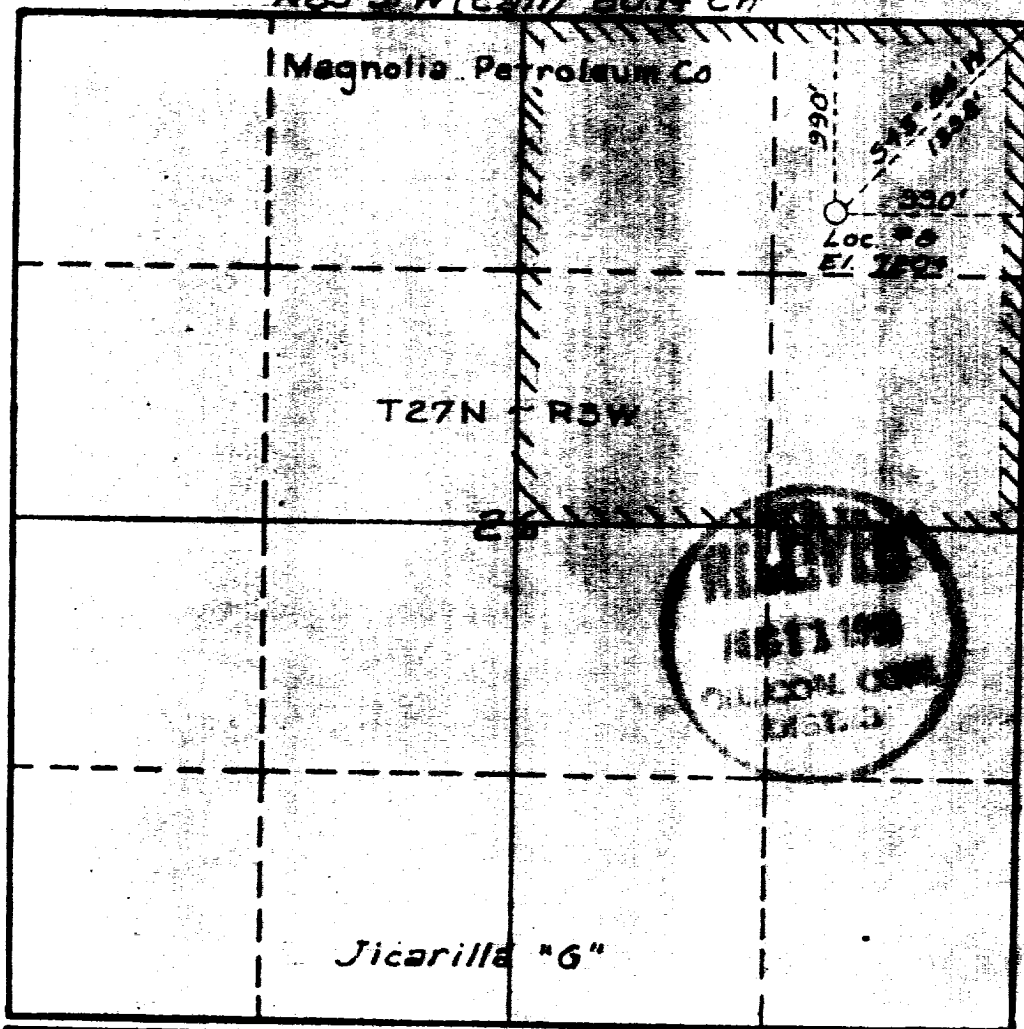

This is to certify that the information in Section A above is true and complete to the best of my knowledge and belief.

MAGNOLIA PETROLEUM COMPANY
(Operator)

[Signature]
(Representative)

Don M. Hahn, New Mexico
Admission

This is to certify that the well location shown on the plat in Section B was plotted from field notes of actual surveys made by me or under my supervision and that the same is true and correct to the best of my knowledge and belief.

Date Surveyed August 2, 1958

Carl E. Turner
Registered Professional
Engineer and/or Land Surveyor.

NEW MEXICO OIL CONSERVATION COMMISSION
Well Location and Acreage Dedication Plat

Section A.

Date August 5, 1958

Operator MAGNOLIA PETROLEUM COMPANY Lease JICARILLA "G"
Well No. 8 Unit Letter Section 26 Township 27N Range 3W NMPN
Located 990 Feet From North Line, 990 Feet From East Line
County Rio Arriba G. L. Elevation 7204 Dedicated Acreage 320 Acres
Name of Producing Formation Mesa Verde Pool Elmoro

1. Is the Operator the only owner* in the dedicated acreage outlined on the plat below?
Yes X No .
2. If the answer to question one is "no," have the interests of all the owners been consolidated by communitization agreement or otherwise? Yes No . If answer is "yes," Type of Consolidation
3. If the answer to question two is "no," list all the owners and their respective interests below:

Owner

Land Description

RECEIVED
AUG 9 1958
U. S. GEOLOGICAL SURVEY
FARMINGTON, NEW MEXICO

Section B.

N 89° 51' W (Call) 80.14 CH

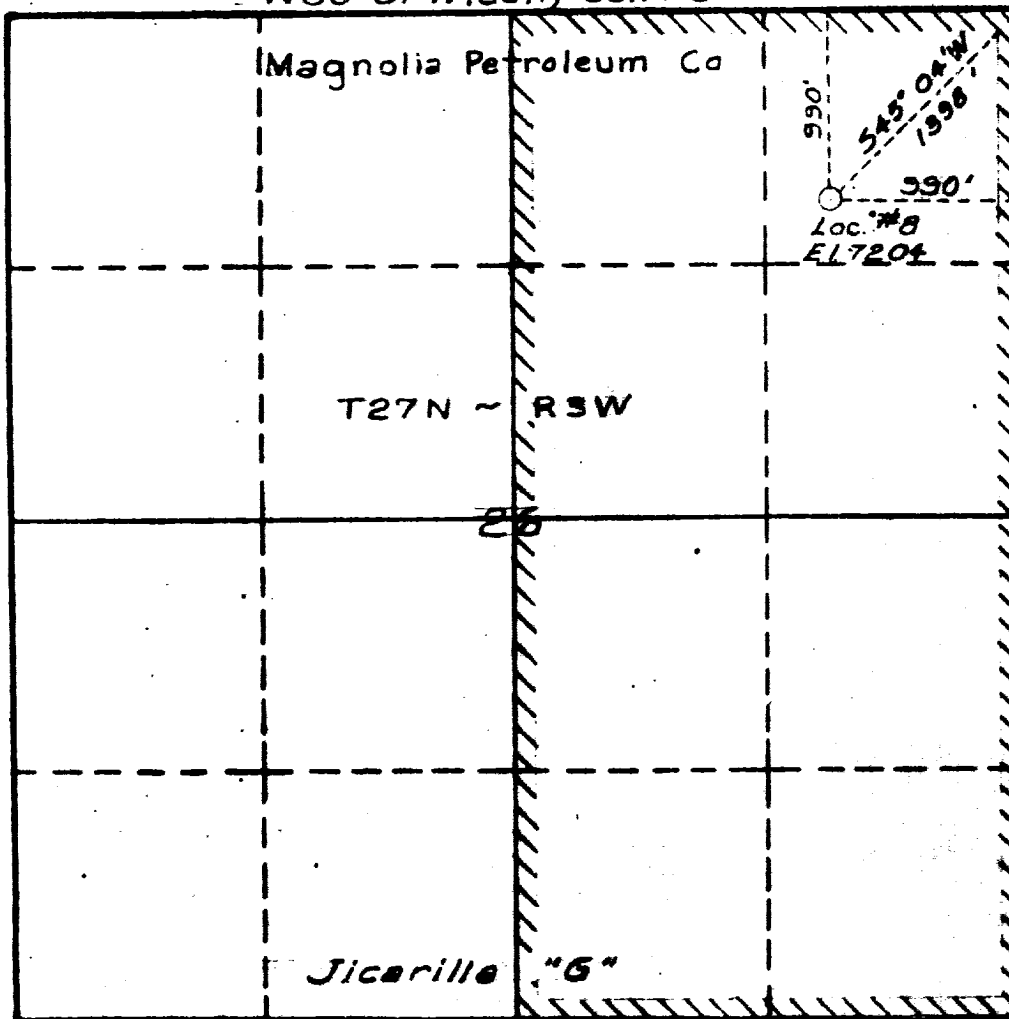

This is to certify that the information in Section A above is true and complete to the best of my knowledge and belief.

MAGNOLIA PETROLEUM COMPANY
(Operator)

G. J. Young, Jr.
(Representative)

Box 2806, Hobbs, New Mexico
Address

This is to certify that the well location shown on the plat in Section B was plotted from field notes of actual surveys made by me or under my supervision and that the same is true and correct to the best of my knowledge and belief.

Date Surveyed August 2, 1958

Carl E. Jernigan
Registered Professional
Engineer and/or Land Surveyor.

Certificate No. 2590