

Okayed 8-11-59
al

NEW MEXICO OIL CONSERVATION COMMISSION

SANTA FE, NEW MEXICO

7-3-58

APPLICATION FOR DUAL COMPLETION

Field Name Blanco M. V. & Wildcat Pictured Cliffs		County Rio Arriba	Date August 3, 1959
Operator El Paso Natural Gas Company		Lease San Juan 27-5 Unit	Well No. 42 (FM)
Location of Well M	Unit 22	Township 27N	Range 5W

1. Has the New Mexico Oil Conservation Commission heretofore authorized the dual completion of a well in these same pools or in the same zones within one mile of the subject well? YES NO
2. If answer is yes, identify one such instance: Order No. **DC-576**; Operator, Lease, and Well No.:

El Paso Natural Gas Co. San Juan 27-5 Unit No. 30 (FM)

3. The following facts are submitted:	Upper Zone	Lower Zone
a. Name of reservoir	Pictured Cliffs	Mesa Verde
b. Top and Bottom of Pay Section (Perforations)	3296-3366	5426-5546 (Point Lookout)
c. Type of production (Oil or Gas)	Gas	Gas
d. Method of Production (Flowing or Artificial Lift)	Flowing	Flowing

4. The following are attached. (Please mark YES or NO)

- Yes** a. Diagrammatic Sketch of the Dual Completion, showing all casing strings, including size and setting, top of cement, perforated intervals, tubing strings, including diameters and setting depth, location and type of packers and side door chokes, and such other information as may be pertinent.
- Yes** b. Plat showing the location of all wells on applicant's lease, all offset wells on offset leases, and the names and addresses of operators of all leases offsetting applicant's lease.
- No** c. Waivers consenting to such dual completion from each offset operator, or in lieu thereof, evidence that said offset operators have been furnished copies of the application.*
- No** d. Electrical log of the well or other acceptable log with tops and bottoms of producing zones and intervals of perforation indicated thereon. (If such log is not available at the time application is filed, it shall be submitted as provided by Rule 112-A.)

5. List all offset operators to the lease on which this well is located together with their correct mailing address.

El Paso Natural Gas Co. is San Juan 27-5 Unit Operator.

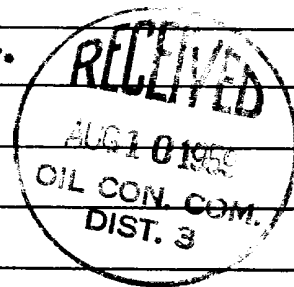

6. Were all operators listed in Item 5 above notified and furnished a copy of this application? YES NO . If answer is yes, give date of such notification _____.

CERTIFICATE: I, the undersigned, state that I am the **Division Petroleum Engr.** of the **El Paso Natural Gas Co.** (company), and that I am authorized by said company to make this report; and that this report was prepared under my supervision and direction and that the facts stated therein are true, correct and complete to the best of my knowledge.

ORIGINAL SIGNED E. S. OBERLY

Signature

* Should waivers from all offset operators not accompany an application for administrative approval, the New Mexico Oil Conservation Commission will hold the application for a period of twenty (20) days from date of receipt by the Commission's Santa Fe office. If, after said twenty-day period, no protest nor request for hearing is received by the Santa Fe office, the application will then be processed.

NOTE: If the proposed dual completion will result in an unorthodox well location and/or a non-standard proration unit in either or both of the producing zones, then separate application for approval of the same should be filed simultaneously with this application.

PLAT SHOWING LOCATION OF DUALY COMPLETED
 El Paso Natural Gas Co. San Juan 27-5 Unit No. 42 (PM)
 and Offset Acreage

T-27-N
 R-5-W

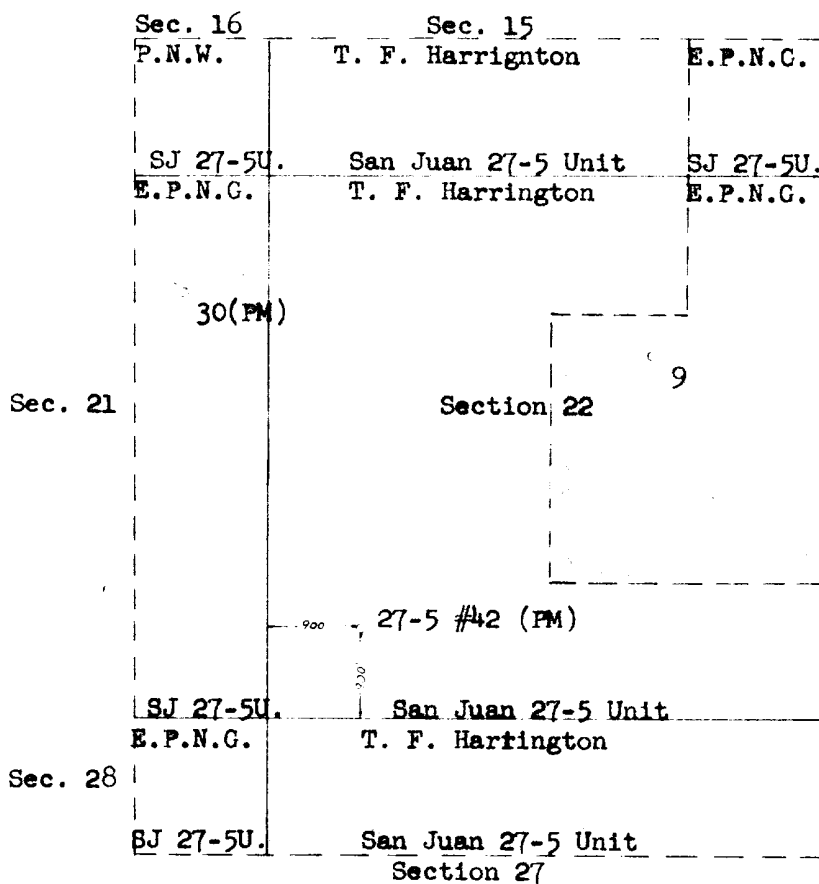

EL PASO NATURAL GAS COMPANY
 EL PASO, TEXAS

SCALE	DATE	No.
DRAWN BY	CHECKED BY	

SCHEMATIC DIAGRAM OF DUAL COMPLETION
El Paso Natural Gas Co. San Juan 27-5 Unit No. 42 (PM)
SW/4 Section 22, T-27-N, R-5-W

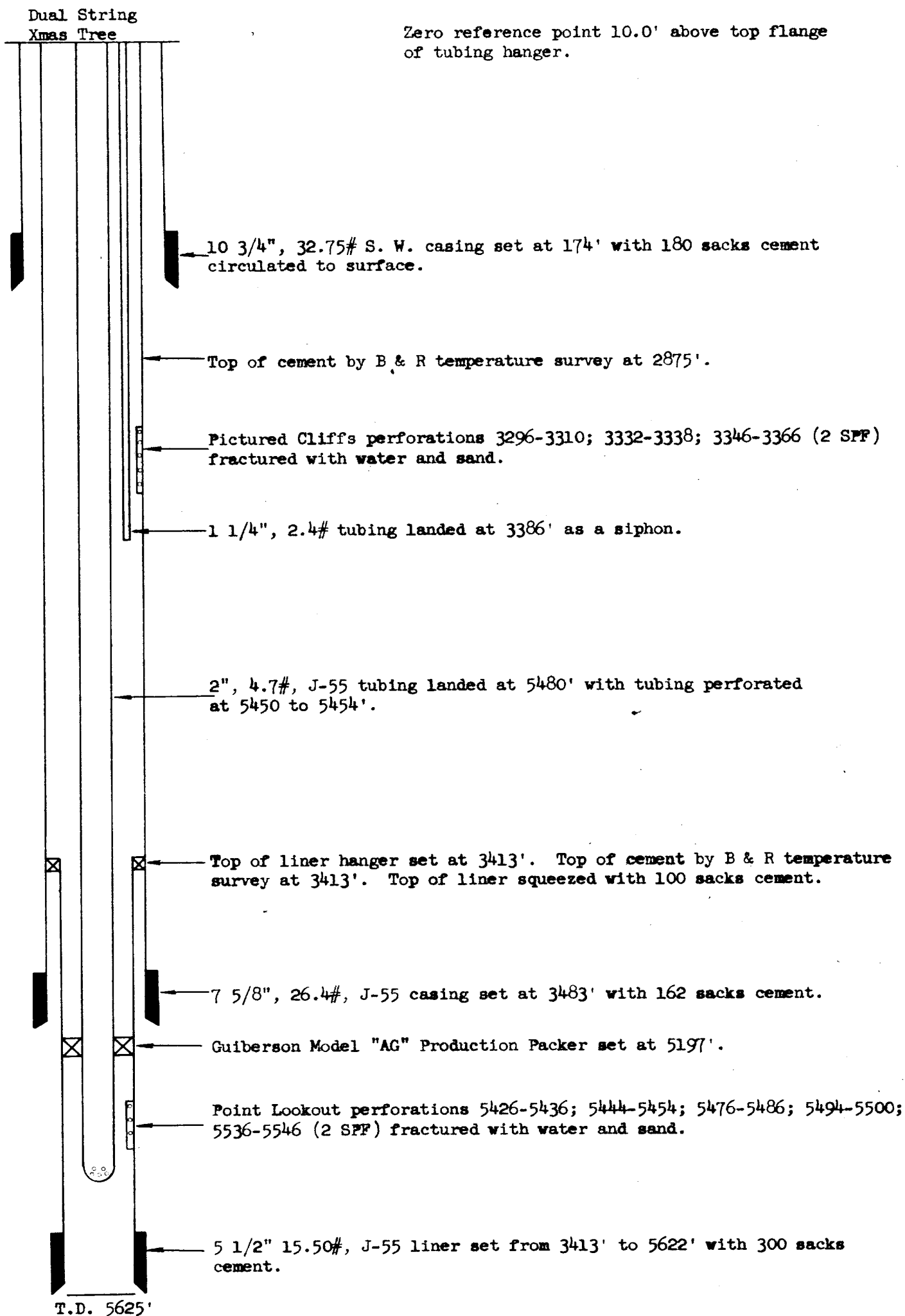

STATE OF NEW MEXICO)
)
COUNTY OF SAN JUAN)

I, A. T. Fry, being first duly sworn upon my oath depose and say as follows:

I am an employee of Guiberson Corporation, and that on June 19, 1959, I was called to the location of the El Paso Natural Gas Company San Juan 27-5 Unit No. 42 (PM) Well located in the SWSW/4 of Section 22, Township 27 North, Range 5 West, N.M.P.M., for advisory service in connection with installation of a production packer. In my presence, a Guiberson Model "AG" Production Packer was set in this well at 5197 feet in accordance with the usual practices and customs of the industry.

A. T. Fry

Subscribed and sworn to before me this 4th day of August, 1959.

Paul A. Beland
Notary Public in and for San Juan
County, New Mexico

My commission expires February 24, 1960.

