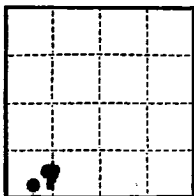

(SUBMIT IN TRIPLICATE)

Indian Agency Navajo TribalCenter, P.M. - Trust #103

Allottee _____

Lease No. Navajo 7UNITED STATES
DEPARTMENT OF THE INTERIOR
GEOLOGICAL SURVEY

SUNDRY NOTICES AND REPORTS ON WELLS

NOTICE OF INTENTION TO DRILL	<input checked="" type="checkbox"/>	SUBSEQUENT REPORT OF WATER SHUT-OFF	RECEIVED SEP 12 1958 U. S. GEOLOGICAL SURVEY FARMINGTON, N.M.
NOTICE OF INTENTION TO CHANGE PLANS	<input type="checkbox"/>	SUBSEQUENT REPORT OF SHOOTING OR ACIDIZING	
NOTICE OF INTENTION TO TEST WATER SHUT-OFF	<input type="checkbox"/>	SUBSEQUENT REPORT OF ALTERING CASING	
NOTICE OF INTENTION TO REDRILL OR REPAIR WELL	<input type="checkbox"/>	SUBSEQUENT REPORT OF REDRILLING OR REPAIR	
NOTICE OF INTENTION TO SHOOT OR ACIDIZE	<input type="checkbox"/>	SUBSEQUENT REPORT OF ABANDONMENT	
NOTICE OF INTENTION TO PULL OR ALTER CASING	<input type="checkbox"/>	SUPPLEMENTARY WELL HISTORY	
NOTICE OF INTENTION TO ABANDON WELL	<input type="checkbox"/>		

(INDICATE ABOVE BY CHECK MARK NATURE OF REPORT, NOTICE, OR OTHER DATA)

September 10, 1958

Well No. 7 is located 990 ft. from S line and 990 ft. from W line of sec. 24SW 1/4 Sec. 24
(1/4 Sec. and Sec. No.)27N
(Twp.)3W
(Range)N.M.P.M.
(Meridian)Blanco NV & Wadsworth, PG
(Field)Big Arriba
(County or Subdivision)New Mexico
(State or Territory)The elevation of the derrick floor above sea level is 7105 ft. MSL.

DETAILS OF WORK

(State names of and expected depths to objective sands; show sizes, weights, and lengths of proposed casings; indicate mudding jobs, cementing points, and all other important proposed work)

We propose to drill the above well to a total depth of 5200' with rotary tools. We expect to test the following zones at the following approximate depths if indicative of oil or gas show.

5200'
Pictured Cliffs
Man Verde

5100'
5000'

We expect to test any other zones which appear productive of oil or gas.
CASING PROGRAM To set approx. 370' of 10-3/4" Surface Cas. w/approx. 300 lbs. cement. To set approx. 4100' of 7-1/8" Intermediate Cas. w/approx. 170 lbs. cement. To set approx. 5000' of 5" liner on bottom of 5200', cemented w/approx. 225 lbs. cement. We propose to perforate and sand-water-free productive zones in the Pictured Cliffs and Man Verde zones for completion.

I understand that this plan of work must receive approval in writing by the Geological Survey before operations may be commenced.

Company Navajo Petroleum CompanyAddress P. O. Box 2406Alto, New MexicoBy G. YoungTitle District Superintendent

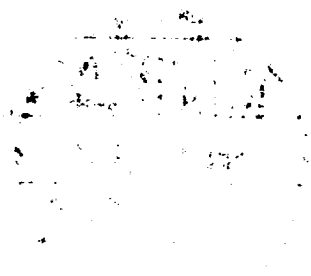
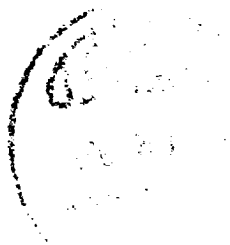

NEW MEXICO OIL CONSERVATION COMMISSION

Well Location and Acreage Dedication Plat

Section A.

Date Sept. 10, 1958

Operator MAGNOLIA PETROLEUM COMPANY Lease JICARILLA "F"
Well No. 7 Unit Letter _____ Section 24 Township 27N Range 3W NMPM
Located 990 Feet From South Line, 990 Feet From West Line
County Rio Arriba G. L. Elevation _____ Dedicated Acreage 160 Acres
Name of Producing Formation Pictured Cliffs Pool Undesignated

1. Is the Operator the only owner* in the dedicated acreage outlined on the plat below?
Yes X No _____.
2. If the answer to question one is "no," have the interests of all the owners been consolidated by communitization agreement or otherwise? Yes _____ No _____. If answer is "yes," Type of Consolidation _____
3. If the answer to question two is "no," list all the owners and their respective interests below:

Owner

Land Description

Section B.

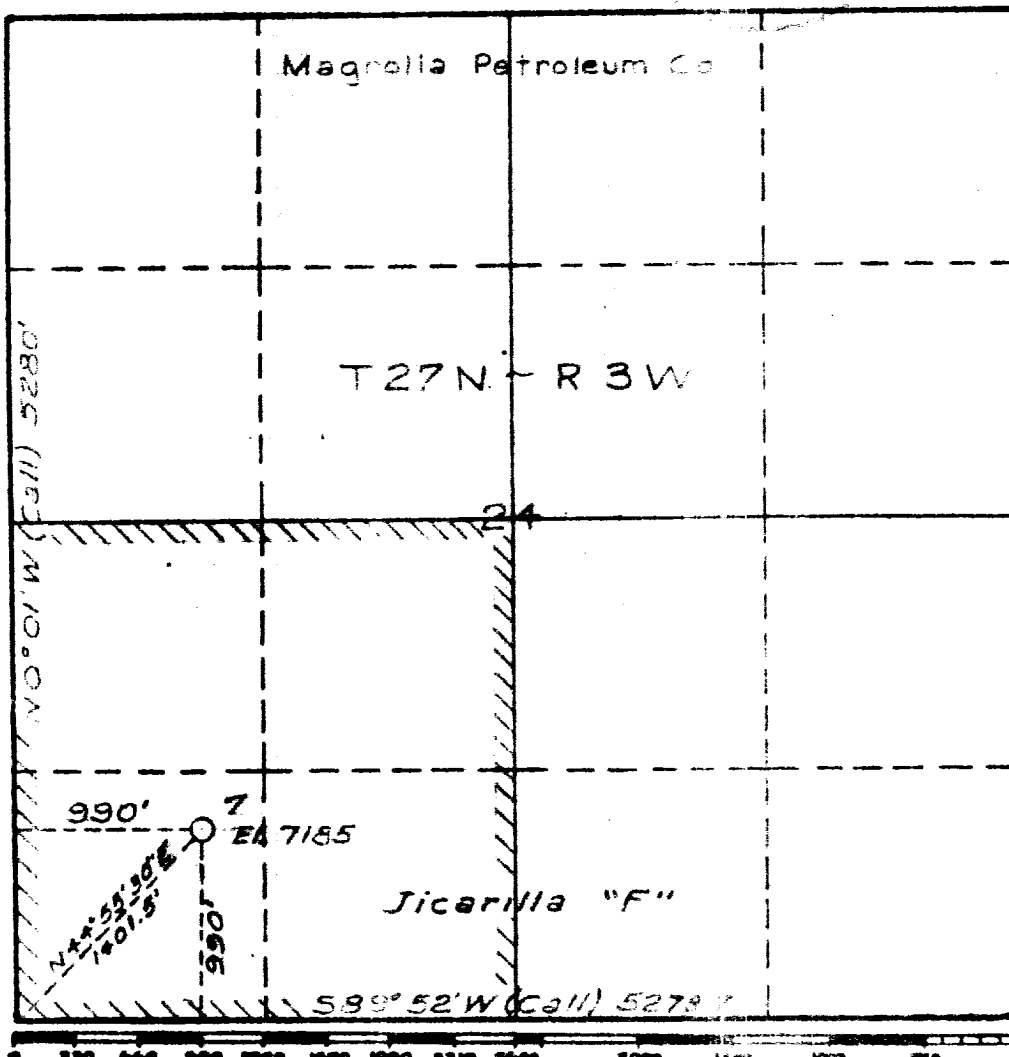

This is to certify that the information in Section A above is true and complete to the best of my knowledge and belief.

MAGNOLIA PETROLEUM COMPANY

(Operator)

Representative

Box 2406, Hobbs, New Mexico
Address

This is to certify that the well location shown on the plat in Section B was plotted from field notes of actual surveys made by me or under my supervision and that the same is true and correct to the best of my knowledge and belief.

Date Surveyed Sept. 9, 1958

Charles E. Turner
Registered Professional
Engineer and/or Land Surveyor.

Certificate No. 5278

