

(SUBMIT IN TRIPLICATE)

UNITED STATES
DEPARTMENT OF THE INTERIOR
GEOLOGICAL SURVEY

Budget Bureau No. 42-R-1584
Form Approved

Land Office **Santa Fe**
Lease No. **080385**
Unit **Rincon Unit**

SUNDRY NOTICES AND REPORTS ON WELLS

NOTICE OF INTENTION TO DRILL	<input checked="" type="checkbox"/> X	SUBSEQUENT REPORT OF WATER SHUT-OFF
NOTICE OF INTENTION TO CHANGE PLANS		SUBSEQUENT REPORT OF SHOOTING OR ACIDIZING
NOTICE OF INTENTION TO TEST WATER SHUT-OFF		SUBSEQUENT REPORT OF ALTERING CASING
NOTICE OF INTENTION TO RE DRILL OR REPAIR WELL		SUBSEQUENT REPORT OF RE DRILLING OR REPAIR
NOTICE OF INTENTION TO SHOOT OR ACIDIZE		SUBSEQUENT REPORT OF ABANDONMENT
NOTICE OF INTENTION TO PULL OR ALTER CASING		SUPPLEMENTARY WELL HISTORY
NOTICE OF INTENTION TO ABANDON WELL		

INDICATE ABOVE BY CHECK MARK NATURE OF REPORT, NOTICE OR OTHER DATA

August 24, 1962

Well No. 178 located 1450 ft from ~~XXX~~ line and 1850 ft from ~~XXX~~ W line of sec. 23

SW/4 Section 23

27-N

7-W

N.M.P.M.

Basin Dakota

Rio Arriba

New Mexico

The well is located about 5600 ft from the corner of Section 23

DETAILS OF WORK

State of New Mexico, County of Santa Fe, City of Santa Fe, New Mexico, August 24, 1962. (Indicate by check mark the nature of the work proposed or completed.)

It is intended to mud drill a well with rotary tools thru the Dakota formation and to perforate and fracture possible producing zones. Est. T. D. 7600'.

Casing Program:

9 5/8" @ 300' w/210 sacks cement circulated to surface.
4 1/2" @ 7600' w/two stage & three stage collars. Set 2nd stage collar 50-100' below base of Mesa Verde, 3rd stage 50-100' below base of Pictured Cliffs. Cement 1st stage w/135 sacks to cover 200' above Greenhorn, 2nd stage w/200 sacks to cover 100' above Cliff House, 3rd stage w/210 sacks to cover Ojo Alamo.

The S/2 of Section 23 is dedicated to this well.

Company: El Paso Natural Gas Company

Address: Box 990

Farmington, New Mexico

H. E. McAnally
Petroroleum Engineer



NEW MEXICO OIL CONSERVATION COMMISSION

Well Location and Acreage Dedication Plat

Section A.

Date **AUGUST 7, 1962**

Operator **EL PASO NATURAL GAS COMPANY** Lease **RINCON UNIT** **SF080385**
 Well No. **178** Unit Letter **K** Section **23** Township **27-N** Range **7-W** NMPM
 Located **1450** Feet From **SOUTH** Line, **1850** Feet From **WEST** Line
 County **RIO ARriba** G. L. Elevation **6598** Dedicated Acreage **327.70** Acres
 Name of Producing Formation **DAKOTA** Pool **BASIN DAKOTA**

1. Is the Operator the only owner in the dedicated acreage outlined on the plat below?

Yes ☒ No ☐2. If the answer to question one is "no", have the interests of all the owners been consolidated by communitization agreement or otherwise? Yes ☐ No ☐ If answer is "yes", Type of Consolidation.

3. If the answer to question two is "no", list all the owners and their respective interests below:

Owner

Land Description

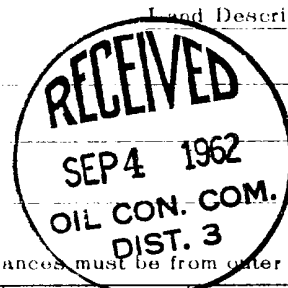

RECEIVED
AUG 21 1962

U.S. GEOLOGICAL SURVEY
NEW MEXICO

Section B.

Note: All distances must be from outer boundaries of section.

This is to certify that the information in Section A above is true and complete to the best of my knowledge and belief.

El Paso Natural Gas Company

(Operator)

ORIGINAL SIGNED H.E. McANALLY

(Representative)

Box 970

(Address)

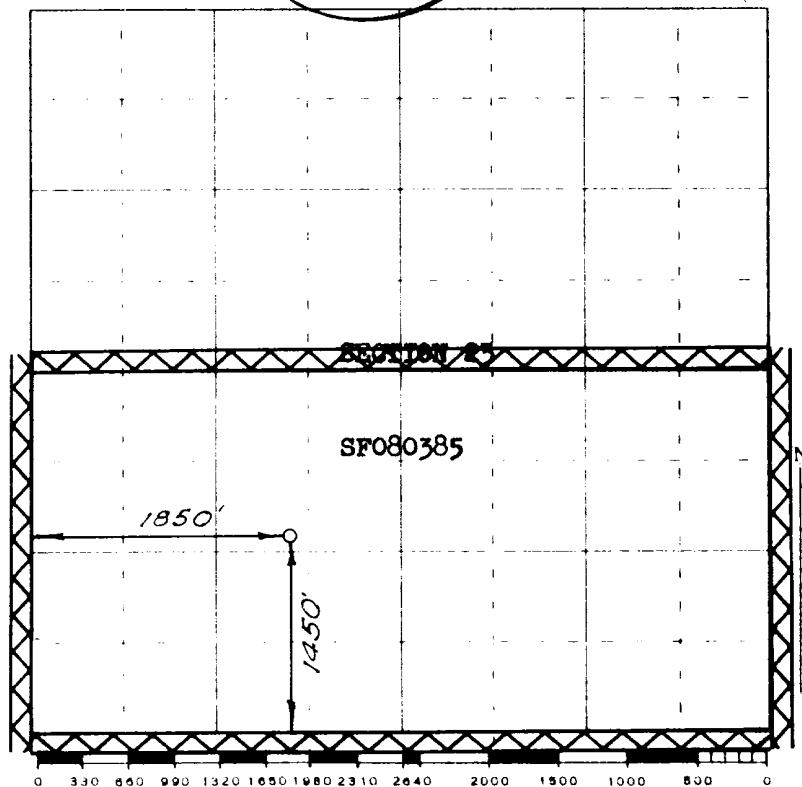
Farmington, New Mexico

Scale 4 inches equal 1 mile

This is to certify that the above plat was prepared from field notes of actual surveys made by me or under my supervision and that the same are true and correct to the best of my knowledge and belief.

(Seal)

Date Surveyed **JUNE 25, 1962**

David J. Filmer
 Registered Professional Engineer and/or Land Surveyor

Farmington, New Mexico

OPEN FLOW TEST DATA

DATE January 8, 1963

El Paso Natural Gas Company		Rincon Unit No. 178	
1450'S, 1850'W, Sec. 23-27-7		County	State
Dakota		Rio Arriba	New Mexico
4-1/2" 7629		Basin	
7322 7492		Casing Diameter	Set At Feet
Sand/Water Frac.		2.375	7460
		To Depth	
		7620 c/o 7585	12-31-62
		Flow Through Casing	Flow Through Tubing
			X

.75	12.365				
2455	2467	8	2435		2447
468	480		1203		1215
67	.9933	.75	1.054	.680	.9393

(12.365)(480)(.9933)(.9393)(1.054)

5838

MCF/D

6,086,089
4,609,864

$$(5838)(1.3202)^{.75} = (5838)(1.2320)$$

NOTE: Blew heavy fog of water and distillate.

7192

C. R. Wagner

Calculated by
~~xxxxxxxxxxxx~~

W. D. Dawson

Checked by

T. B. Grant, Jr.

