

(SUBMIT IN TRIPLICATE)

UNITED STATES
DEPARTMENT OF THE INTERIOR
GEOLOGICAL SURVEY

Land Office **Santa Fe**
Lease No. **079366**
Unit **Rincon Unit**

SUNDRY NOTICES AND REPORTS ON WELLS

NOTICE OF INTENTION TO DRILL

NOTICE OF INTENTION TO CHANGE PLANS

NOTICE OF INTENTION TO TEST WATER SHUT-OFF

NOTICE OF INTENTION TO RE-DRILL OR REPAIR WELL

NOTICE OF INTENTION TO SHOOT OR ACIDIZE

NOTICE OF INTENTION TO PULL OR ALTER CASING

NOTICE OF INTENTION TO ABANDON WELL

XX SUBSEQUENT REPORT OF WATER SHUT-OFF
SUBSEQUENT REPORT OF SHOOTING OR ACIDIZING
SUBSEQUENT REPORT OF ALTERING CASING
SUBSEQUENT REPORT OF RE-DRILLING OR REPAIR
SUBSEQUENT REPORT OF ABANDONMENT
SUPPLEMENTARY WELL HISTORY

RECEIVED

AUG 29 1962

U. S. GEOLOGICAL SURVEY
WASHINGTON, D. C.

INDICATE BY CHECK MARK NATURE OF REPORT

August 24, 1962

Well No. **175** is located **1840** ft. from **N** line and **1760** line of sec. **20**

NE/4 Section 20

27-N 6-W

N.M.P.M.

Basin Dakota

Rio Arriba

New Mexico

The elevation of the derrick floor above sea level is **6482** ft.

DETAILS OF WORK

State names of and extent of formations, show sizes, weights, and lengths of proposed casings; indicate mudding jobs, cementing points, and all other important proposed work.

It is intended to mud drill a well with rotary tools thru the Dakota formation and to perforate & fracture possible producing zones. Est. T.D. 7546'.

Casing Program:

9 5/8" @ 300' w/210 sacks cement circulated to surface.
4 1/2" @ 7546' w/two & three stage collars. Set 2nd stage collar 50-100' below base of Mesa Verde, 3rd stage 50-100' below base of Pictured Cliffs. Cement 1st stage w/130 sacks to cover 200' above Greenhorn., 2nd stage w/210 sacks to cover 100' above Cliff House. 3rd stage w/200 sacks to cover Ojo Alamo.

The N/2 of Section 20 is dedicated to this well.

I understand that this plan of work must receive approval in writing by the Geological Survey before operations may be commenced.

Company **El Paso Natural Gas Company**

Address **Box 990**

Farmington, New Mexico

By **N. W. Meacham**

Title **Petroleum Engineer**

NEW MEXICO OIL CONSERVATION COMMISSION

Well Location and Acreage Dedication Plat

Section A.

Date **JULY 12, 1962**

Operator **EL PASO NATURAL GAS COMPANY** Lease **RINCON UNIT** **SF079366**
 Well No. **175** Unit Letter **G** Section **20** Township **27-N** Range **6-W** NMPM
 Located **1840** Feet From **NORTH** Line **1760** Feet From **EAST** Line
 County **RIO ARriba** G. L. Elevation **6472** Dedicated Acreage **320** Acres
 Name of Producing Formation **DAKOTA** Pool **BASIN DAKOTA**

1. Is the Operator the only owner in the dedicated acreage outlined on the plat below?
 Yes ☒ No ☐
2. If the answer to question one is "no", have the interests of all the owners been consolidated by communitization agreement or otherwise? Yes ☐ No ☐ . If answer is "yes", Type of Consolidation.
3. If the answer to question two is "no", list all the owners and their respective interests below:

Owner

Land Description

Section B.

This is to certify that the information in Section A above is true and complete to the best of my knowledge and belief.

El Paso Natural Gas Company
 Original Signer **D. W. Meehan**

(Representative)

Box 990

(Address)

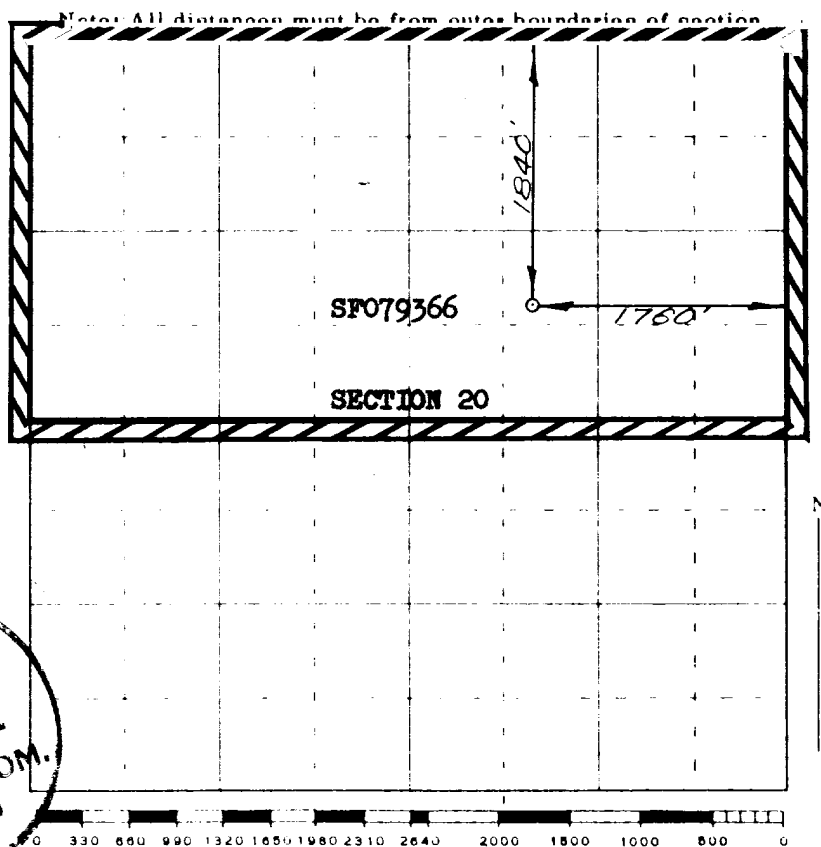
Farmington, New Mexico

Scale 4 inches equal 1 mile

This is to certify that the above plat was prepared from field notes of actual surveys made by me or under my supervision and that the same are true and correct to the best of my knowledge and belief.

(Seal)

Date Surveyed **JUNE 25, 1962**

Farmington, New Mexico

Russell H. McKeane
 Registered Professional Engineer and/or Land Surveyor