

(SUBMIT IN TRIPLICATE)

UNITED STATES  
DEPARTMENT OF THE INTERIOR  
GEOLOGICAL SURVEY

Land Office Santa Fe  
Lease No. 079366  
Unit Rincon Unit

SUNDRY NOTICES AND REPORTS ON WELLS

NOTICE OF INTENTION TO DRILL	<input checked="" type="checkbox"/>	SUBSEQUENT REPORT OF WATER SHUT-OFF	
NOTICE OF INTENTION TO CHANGE PLANS		SUBSEQUENT REPORT OF SHOOTING OR ACIDIZING	
NOTICE OF INTENTION TO TEST WATER SHUT-OFF		SUBSEQUENT REPORT OF ALTERING CASING	
NOTICE OF INTENTION TO RE-DRILL OR REPAIR WELL		SUBSEQUENT REPORT OF RE-DRILLING OR REPAIR	
NOTICE OF INTENTION TO SHOOT OR ACIDIZE		SUBSEQUENT REPORT OF ABANDONMENT	
NOTICE OF INTENTION TO PULL OR ALTER CASING		SUPPLEMENTARY WELL HISTORY	
NOTICE OF INTENTION TO ABANDON WELL			

(INDICATE ABOVE BY CHECK MARK NATURE OF REPORT, NOTICE, OR OTHER DATA)

March 19, 1958

Well No. 111 is located 1650 ft. from N line and 1165 ft. from W line of sec. 20

NW Sec. 20 27N 6W N.M.P.M.  
( $\frac{1}{4}$  Sec. and Sec. No.) (Twp.) (Range) (Meridian)  
So. Blanco Rio Arriba New Mexico  
(Field) (County or Subdivision) (State or Territory)

The elevation of the derrick floor above sea level is 6500 ft.

DETAILS OF WORK

(State names of and expected depths to objective sands; show sizes, weights, and lengths of proposed casings; indicate mudding jobs, cementing points, and all other important proposed work)

It is intended to drill a well thru the Pictured Cliff formation using rotary tools and to perforate and water fracture possible producing zones. Est. T. D. 3169'.

Casing Program:

8 5/8" at 120' with 125 sacks regular cement circulated to surface.  
5 1/2" at 3169' with 75 sacks regular cement, 75 sacks mud.

The NW/4 of Section 20 is dedicated to this well.

NW/4: SF 079366

I understand that this plan of work must receive approval in writing by the Geological Survey before operations may be commenced.

Company El Paso Natural Gas Company  
Address Box 997  
Farmington, New Mexico  
By Original Signed D. C. Johnston  
Title Petroleum Engineer

## NEW MEXICO OIL CONSERVATION COMMISSION

## Well Location and Acreage Dedication Plat

Section A.

Date **MARCH 17, 1958**

Operator **EL PASO NATURAL GAS COMPANY** Lease **RINCON** SF **079366**  
 Well No. **111** Unit Letter **E** Section **20** Township **27-N** Range **6-N** NMPM  
 Located **1650** Feet From **NORTH** Line **1165** Feet From **WEST** Line  
 County **RIO ARriba** G. L. Elevation **6490** Dedicated Acreage **160** Acres  
 Name of Producing Formation **PICTURED CLIFF** Pool **SOUTH BLANCO PICTURED CLIFF**

1. Is the Operator the only owner in the dedicated acreage outlined on the plat below?  
 Yes ☒ No ☐
2. If the answer to question one is "no", have the interests of all the owners been consolidated by communization agreement or otherwise? Yes ☐ No ☐ If answer is "yes", Type of Consolidation.
3. If the answer to question two is "no", list all the owners and their respective interests below.

Owner

Land Description

**RECEIVED****MAR 19 1958****U. S. GEOLOGICAL SURVEY  
FARMINGTON, NEW MEXICO**

Section B.

This is to certify that the information in Section A above is true and complete to the best of my knowledge and belief.

**El Paso Natural Gas Company**  
 (Operator)  
**Original Signed D. C. Johnston**  
 (Representative)

**Box 997**  
 (Address)

**Farmington, New Mexico**

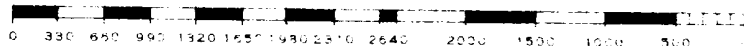
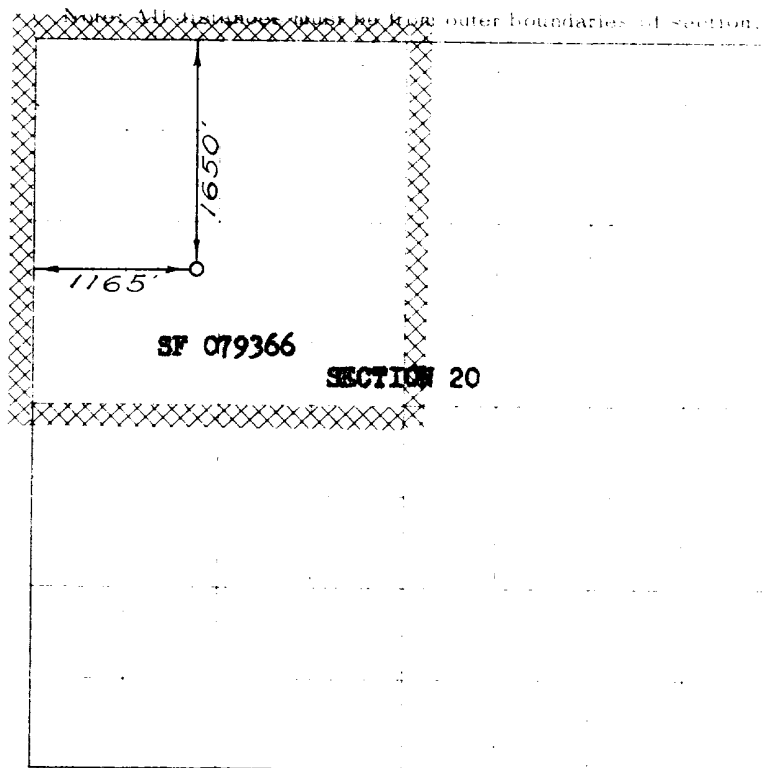

Scale 4 inches equal 1 mile

This is to certify that the above plat was prepared from field notes of actual surveys made by me or under my supervision and that the same are true and correct to the best of my knowledge and belief.

(Seal)

Farmington, New Mexico

Date Surveyed **MARCH 11, 1958**

*David O. Wilson*  
 Registered Professional Engineer and/or Land Surveyor