

(SUBMIT IN TRIPLICATE)

UNITED STATES
DEPARTMENT OF THE INTERIOR
GEOLOGICAL SURVEYLand Office Santa Fe
Lease No. 079366
Unit Rincon Unit

RECEIVED

SUNDRY NOTICES AND REPORTS ON WELLS AUG 1 1962

| | | | |
|--|----|--|-------------------------|
| NOTICE OF INTENTION TO DRILL | XX | SUBSEQUENT REPORT OF WATER SHUT-OFF | U. S. GEOLOGICAL SURVEY |
| NOTICE OF INTENTION TO CHANGE PLANS | | SUBSEQUENT REPORT OF SHOOTING OR ACIDIZING | FARMINGTON, NEW MEXICO |
| NOTICE OF INTENTION TO TEST WATER SHUT-OFF | | SUBSEQUENT REPORT OF ALTERING CASING | |
| NOTICE OF INTENTION TO RE-DRILL OR REPAIR WELL | | SUBSEQUENT REPORT OF RE-DRILLING OR REPAIR | |
| NOTICE OF INTENTION TO SHOOT OR ACIDIZE | | SUBSEQUENT REPORT OF ABANDONMENT | |
| NOTICE OF INTENTION TO PULL OR ALTER CASING | | SUPPLEMENTARY WELL HISTORY | |
| NOTICE OF INTENTION TO ABANDON WELL | | | |

(INDICATE ABOVE BY CHECK MARK NATURE OF REPORT, NOTICE, OR OTHER DATA)

August 1, 1962

Well No. 180 is located 1550 ft. from N line and 1650 ft. from E line of sec. 21NW/4 Sec. 21
(1/4 Sec. and Sec. No.)27N
(Twp.)6W
(Range)N.M.P.M.
(Meridian)Basin Dakota
(Field)Rio Arriba
(County or Subdivision)New Mexico
(State or Territory)

The elevation of the derrick floor above sea level is 6559 ft.

DETAILS OF WORK

(State names of and expected depths to objective sands; show sizes, weights, and lengths of proposed casings; indicate mudding jobs, cementing points, and all other important proposed work)

It is intended to mud drill a well with rotary tools through the Dakota formation and to perforate and fracture possible producing zones. Est. T. D. 7675'.

Casing Program:

9 5/8" @ 300' with 200 sacks cement circulated to surface.
4 1/2" @ 7675' w/2 and 3 stage collars. Set 2nd stage collar 50' - 100' below base of Mesa Verde and 3rd stage 50' - 100' below base of Pictured Cliffs.
Cement first stage w/130 sks. to cover 200' above Greenhorn.
Second stage w/190 sacks to cover 100' above Cliff House.
Third stage w/190 sacks to cover Ojo Alamo.

The N/2 of Section 21 is dedicated to this well.

I understand that this plan of work must receive approval in writing by the Geological Survey before operations may be commenced.

Company El Paso Natural Gas CompanyAddress Box 990Farmington, New MexicoBy N. W. NathanTitle Petroleum Engineer

Well Location and Acreage Dedication Plat

Section A.

Date JULY 30, 1962

Operator **EL PASO NATURAL GAS COMPANY** Lease **RINCON UNIT** **SF079366**
Well No. **180** Unit Letter **G** Section **21** Township **27-N** Range **6-W** NMPM
Located **1550** Feet From **NORTH** Line, **1650** Feet From **EAST** Line
County **RIO ARriba** G. L. Elevation **6549** Dedicated Acreage **320** Acres
Name of Producing Formation **DAKOTA** Pool **BASIN DAKOTA**

1. Is the Operator the only owner in the dedicated acreage outlined on the plat below?
Yes ☒ No ☐
2. If the answer to question one is "no", have the interests of all the owners been consolidated by communitization agreement or otherwise? Yes ☐ No ☐ If answer is "yes", Type of Consolidation.
3. If the answer to question two is "no", list all the owners and their respective interests below:

Owner Land Description



Section B.

This is to certify that the information in Section A above is true and complete to the best of my knowledge and belief.

El Paso Natural Gas Company
(Operator)
Original Signed **D. W. Meehan**
(Representative)
Box 990
(Address)
Farmington, New Mexico

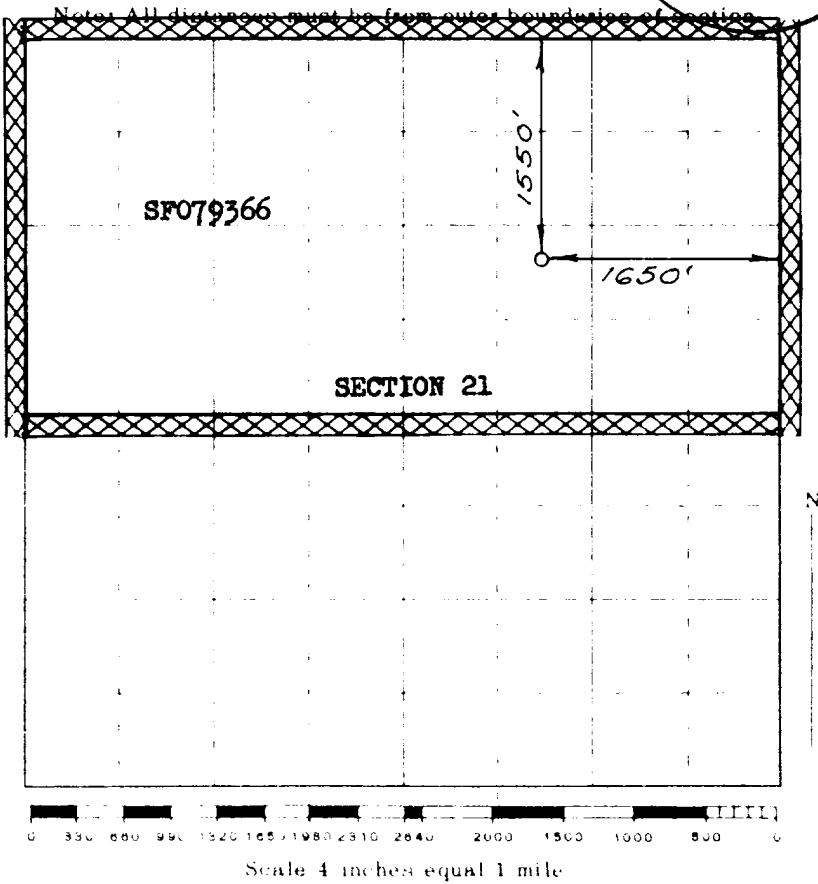

This is to certify that the above plat was prepared from field notes of actual surveys made by me or under my supervision and that the same are true and correct to the best of my knowledge and belief.

(Seal)

Farmington, New Mexico

Date Surveyed **JUNE 26, 1962**

David O. Kilmer
Registered Professional Engineer and/or Land Surveyor