

IN REPLY REFER TO:



COPY TO O.C.C.

UNITED STATES
DEPARTMENT OF THE INTERIOR
GEOLOGICAL SURVEY
P. O. Box 965
Farmington, New Mexico

April 11, 1956

El Paso Natural Gas Company
Box 997
Farmington, New Mexico

Re: Santa Fe 079360

Gentlemen:

Receipt is acknowledged of your "Notice of Intention to Drill" dated April 9, 1956 covering your well No. 63 Rincon Unit in NW¹ sec. 23, T. 27 N., R. 7 W., N. M. P. M., Rio Arriba County, New Mexico, So. Blanco P.C.

Your proposed work is hereby approved subject to compliance with the provisions of the "Oil and Gas Operating Regulations" revised May 25, 1942, a copy of which will be sent to you on request, and subject to the following conditions:

1. Drilling operations so authorized are subject to the attached sheet for general conditions of approval.
2. Furnish copies of all logs.

Very truly yours,

(Orig. Sgd.) P. T. McGrath

P. T. McGrath
District Engineer

PTMcGrath:ac

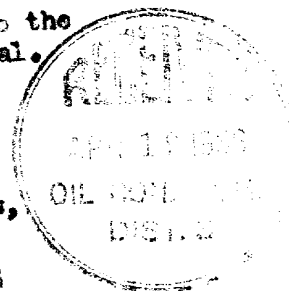

UNITED STATES
DEPARTMENT OF THE INTERIOR
GEOLOGICAL SURVEY



100-100000

(Orig 284) F. I. McCLINTOCK

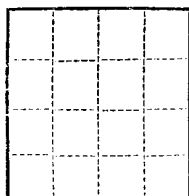

(SUBMIT IN TRIPLICATE)

UNITED STATES
DEPARTMENT OF THE INTERIOR
GEOLOGICAL SURVEY

Land Office Santa Fe
Lease No. 079360
Unit Rincon Unit

SUNDRY NOTICES AND REPORTS ON WELLS

NOTICE OF INTENTION TO DRILL.....	<input checked="" type="checkbox"/>	SUBSEQUENT REPORT OF WATER SHUT-OFF.....	
NOTICE OF INTENTION TO CHANGE PLANS.....		SUBSEQUENT REPORT OF SHOOTING OR ACIDIZING.....	
NOTICE OF INTENTION TO TEST WATER SHUT-OFF.....		SUBSEQUENT REPORT OF ALTERING CASING.....	
NOTICE OF INTENTION TO RE-DRILL OR REPAIR WELL.....		SUBSEQUENT REPORT OF RE-DRILLING OR REPAIR.....	
NOTICE OF INTENTION TO SHOOT OR ACIDIZE.....		SUBSEQUENT REPORT OF ABANDONMENT.....	
NOTICE OF INTENTION TO PULL OR ALTER CASING.....		SUPPLEMENTARY WELL HISTORY.....	
NOTICE OF INTENTION TO ABANDON WELL.....			

(INDICATE ABOVE BY CHECK MARK NATURE OF REPORT, NOTICE, OR OTHER DATA)

Well No. 63 is located 990 ft. from N line and 890 ft. from E line of sec. 23
Section 23 27N 7W DEM
(1/4 Sec. and Sec. No.) (Twp.) (Range) (Meridian)
So. Blanco P.C. San Arriba New Mexico
(Field) (County or Subdivision) (State or Territory)

The elevation of the derrick floor above sea level is 6735 ft.

DETAILS OF WORK

(State names of and expected depths to objective sands; show sizes, weights, and lengths of proposed casings; indicate mudding jobs, cementing points, and all other important proposed work)

It is intended to drill a well thru the Pictured Cliff formation using rotary tools to the casing point and to drill the pay section with cable tools and to water fracture the entire pay section. Est. T.D. 3260'.

Casing Program:

9 5/8" at 120' with 125 sacks regular cement circulated to surface.
5 1/2" at 3210' with 75 sacks regular cement, 75 sacks Pozalix.

The NW/4 of Section 23 is dedicated to this well.
(NW/4) of 079360.

I understand that this plan of work must receive approval in writing by the Geological Survey before operations may be commenced.

Company El Paso Natural Gas Company
Address Box 997
Farmington, New Mexico
By C. Well
Title Petroleum Engineer

OIL CONSERVATION COMMISSION
WELL LOCATION AND/OR GAS PRODUCTION PLAT

DATE MARCH 16, 1956OPERATOR EL PASO NATURAL GAS COMPANY LEASE RINCON SF 079360ACRES 63 SECTION 23 TOWNSHIP 27-N RANGE 7-W NORTHLOCATED 990 FEET FROM NORTH LINE 890 FEET FROM WEST LINERIO ARriba COUNTY, NEW MEXICO G. L. ELEVATION 6725¹²NAME OF PRODUCING FORMATION PICTURED CLIFF SO. BLANCO 160
(1882 PLAT)

Note: All distances must be from outer boundaries of section.

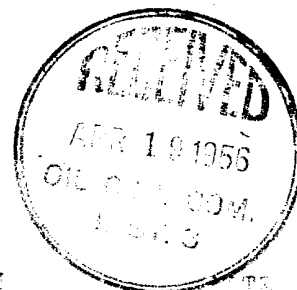
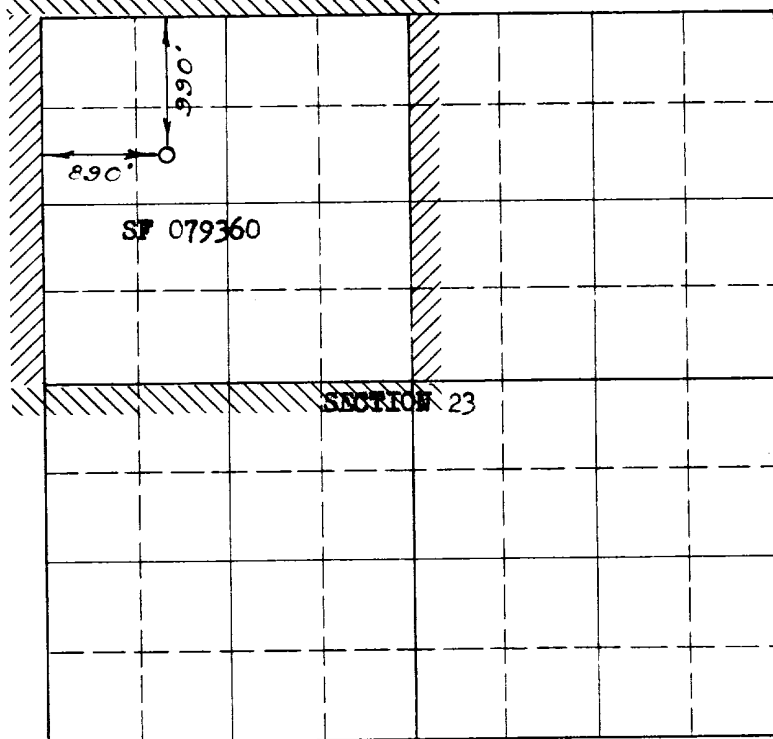

This section of
is to be used
for the well only

Scale 1/4 inches equal 1 mile

This is to certify that the above plat was
prepared from field notes of a land survey
made by me or under my supervision and that
the same are true and correct to the best of
my knowledge and belief.

Date Surveyed MARCH 8, 1956

C. O. MacLean
Registered Professional Engineer and/or
Land Surveyor

1. Is this well a fuel well?
Yes _____ No X2. If the answer to question 1
is yes, are there any other
shallow completed wells within
the decimeter survey?
Yes _____ No _____Name Carroll U. DeLoePosition Petroleum EngineerRepresenting El Paso Natural GasAddress Box 997, Farmington, N.M.

(Seal)

Farmington, New Mexico