

(SUBMIT IN TRIPLICATE)

UNITED STATES
DEPARTMENT OF THE INTERIOR
GEOLOGICAL SURVEY

Budget Bureau No. 42-R388.4.
Approval expires 12-31-60.

Land Office Santa Fe
Lease No. 079260
Unit Rincon Unit

SUNDRY NOTICES AND REPORTS ON WELLS

NOTICE OF INTENTION TO DRILL	SUBSEQUENT REPORT OF WATER SHUT-OFF	
NOTICE OF INTENTION TO CHANGE PLANS	SUBSEQUENT REPORT OF SHOOTING OR ACIDIZING	
NOTICE OF INTENTION TO TEST WATER SHUT-OFF	SUBSEQUENT REPORT OF ALTERING CASING	
NOTICE OF INTENTION TO RE-DRILL OR REPAIR WELL	SUBSEQUENT REPORT OF RE-DRILLING OR REPAIR	
NOTICE OF INTENTION TO SHOOT OR ACIDIZE	SUBSEQUENT REPORT OF ABANDONMENT	X
NOTICE OF INTENTION TO PULL OR ALTER CASING	SUPPLEMENTARY WELL HISTORY	
NOTICE OF INTENTION TO ABANDON WELL		

(INDICATE ABOVE BY CHECK MARK NATURE OF REPORT, NOTICE, OR OTHER DATA)

April 19, 1956

Well No. 63 is located 390 ft. from N line and 390 ft. from W line of sec. 23
Section 23 27N 7W RMPM
 (1/4 Sec. and Sec. No.) (Twp.) (Range) (Meridian)
So. Blanco L.C. Rio Arriba New Mexico
 (Field) (County or Subdivision) (State or Territory)

The elevation of the derrick floor above sea level is 6429 ft.

DETAILS OF WORK

(State names of and expected depths to objective sands; show sizes, weights, and lengths of proposed casings; indicate mudding jobs, cementing points, and all other important proposed work)

This plat is re-issued to show corrected elevation.

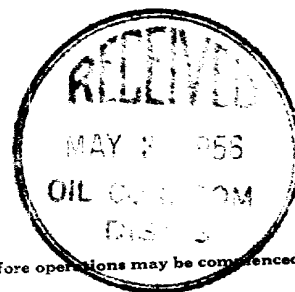

I understand that this plan of work must receive approval in writing by the Geological Survey before operations may be commenced.

Company El Paso Natural Gas Company

Address Box 271

Parlington, New Mexico

By Emell H. [Signature]

Title Petroleum Engineer

OIL CONSERVATION COMMISSION

WELL LOCATION AND/OR GAS PRODUCTION PLAT

DATE MARCH 16, 1956OPERATOR EL PASO NATURAL GAS COMPANY LEASE RINCON SF 079360WELL NO. 63 SECTION 23 TOWNSHIP 27-N RANGE 7-W NORTHLOCATED 990 FEET FROM NORTH LINE 890 FEET FROM WEST LINERIO ARriba COUNTY, NEW MEXICOG. L. ELEVATION 6619NAME OF PRODUCING FORMATION PICTURED CLIFF POOL SO. BLANCO DEDICATED ACREAGE 160
(1882 PLAT)

Note: All distances must be from outer boundaries of section.

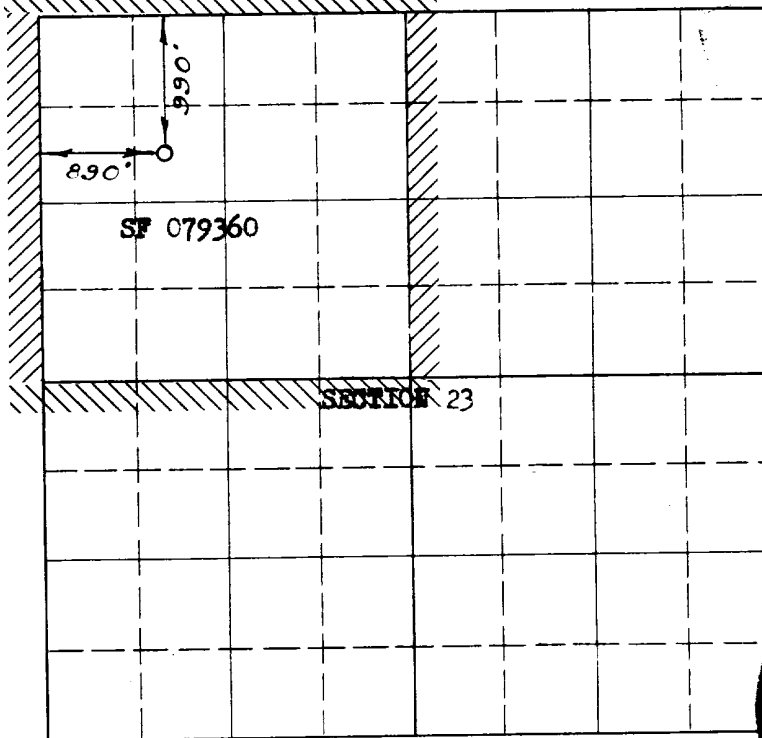

Scale 1/4 inches equal 1 mile

This is to certify that the above plat was prepared from field notes of actual surveys made by me or under my supervision and that the same are true and correct to the best of my knowledge and belief.

Date Surveyed MARCH 8, 1956

C. O. MacChesney
Registered Professional Engineer and/or
Land Surveyor

(Seal)

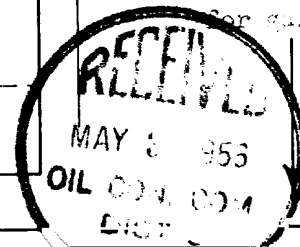

1. Is this well a dedicated well?
Yes X
2. If the answer to question 1 is yes, are there any other dedicated wells within the dedicated acreage?
Yes No

Name C. O. MacChesney
Position Petroleum Engineer
Representing El Paso Natural Gas
Address Box 997, Farmington, N.M.