

Section 22

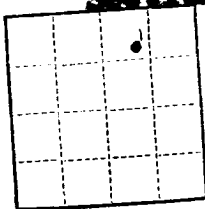

(SUBMIT IN TRIPLICATE)

**UNITED STATES
DEPARTMENT OF THE INTERIOR
GEOLOGICAL SURVEY**

Budget Bureau 42-R358.3.
Approval expires 12-31-55.

Land Office Jic. Trib.
Lease No. Cont. #94, Tr. #183
Unit Jicarilla "F"

SUNDRY NOTICES AND REPORTS ON WELLS

NOTICE OF INTENTION TO DRILL	<input checked="" type="checkbox"/>	SUBSEQUENT REPORT OF WATER SHUT-OFF
NOTICE OF INTENTION TO CHANGE PLANS	<input type="checkbox"/>	SUBSEQUENT REPORT OF SHOOTING OR ACIDIZING
NOTICE OF INTENTION TO TEST WATER SHUT-OFF	<input type="checkbox"/>	SUBSEQUENT REPORT OF ALTERING CASING
NOTICE OF INTENTION TO RE-DRILL OR REPAIR WELL	<input type="checkbox"/>	SUBSEQUENT REPORT OF RE-DRILLING OR REPAIR
NOTICE OF INTENTION TO SHOOT OR ACIDIZE	<input type="checkbox"/>	SUBSEQUENT REPORT OF ABANDONMENT
NOTICE OF INTENTION TO PULL OR ALTER CASING	<input type="checkbox"/>	SUPPLEMENTARY WELL HISTORY
NOTICE OF INTENTION TO ABANDON WELL	<input type="checkbox"/>	

(INDICATE ABOVE BY CHECK MARK NATURE OF REPORT, NOTICE, OR OTHER DATA)

Midland, Texas April 6, 1956

Jicarilla "F"
Well No. 1 is located 990 ft. from [N] line and 1650 ft. from [E] line of sec. 22

NW 1/4, NE 1/4, Sec. 22
(1/4 Sec. and Sec. No.)

27-N
(Twp.)

3-E
(Range)

N.M.P.M.
(Meridian)

Blanco
(Field)

Rio Arriba
(County or Subdivision)

New Mexico
(State or Territory)

The elevation of the derrick floor above sea level is 7159 ft.

DETAILS OF WORK

(State names of and expected depths to objective sands; show sizes, weights, and lengths of proposed casings; indicate mudding jobs, cementing points, and all other important proposed work)

We propose to drill the above well to a total depth of approx. 6500' with Rotary Tools. We expect to test the following zones at the following approx. depths:

SAND
Pictured Cliff
Mesa Verde

EXPECTED TOP
3630'
6350'

We expect to test any other zones that appear productive of Oil or Gas. Casing Program: Approx. 300' of 10-3/4" Csg w/Approx. 300 Sx Cement, Approx. 4000' of 7-5/8" Csg w/Approx. 150 Sx Cement, Approx. 2500' of 5-1/2" Liner w/Approx 200 Sx Cement on bottom & will squeeze top of 5-1/2" Liner w/Approx. 200 Sx Cement. We propose to perforate productive zones in Mesa Verde & Fracture Formation w/Approx. 40,000 gal water using 1/4 sand per gal at injection rate of not less than 40 bbl per min. We also propose to perforate Pictured Cliff zone and fracture in same method as the Mesa Verde.

I understand that this plan of work must receive approval in writing by the Geological Survey before operations may be commenced.

Company Magnolia Petroleum Company

Address P. O. Box 633
Midland, Texas

By R. T. GERMAN,
Title Division Superintendent

NEW MEXICO
OIL CONSERVATION COMMISSION

Form C-128

Well Location and/or Gas Proration Plat

Date April 2, 1956

Operator Magnolia Petroleum Company Lease Jicarilla #7

Well No. One (1) Section 22 Township 27 N Range 3 W NMPM

Located 990 Feet From North Line, 1650 Feet From East Line,

El Arriba County, New Mexico. G. L. Elevation 7147

Name of Producing Formation Pictured Cliffs Extension of Blanco
Name of Producing Formation Blanco Verde Pool Blanco Dedicated Acreage 320

(Note: All distances must be from outer boundaries of Section)

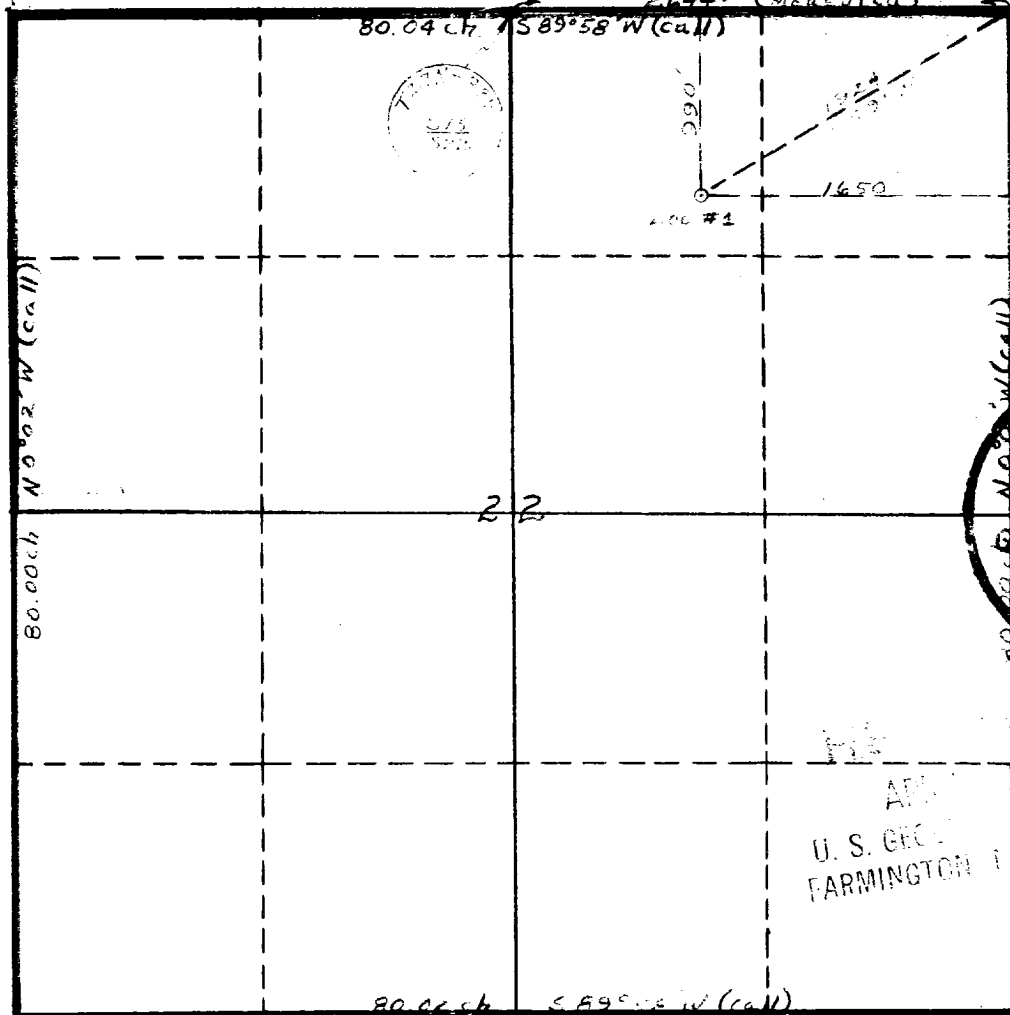

SCALE: 1"=1000'

1. Is this Well a Dual Comp.? Yes ☒ No ☐.
2. If the answer to Question 1 is yes, are there any other dually completed wells within the dedicated acreage? Yes ☐ No ☒.

This is to certify that the above plat was prepared from field notes of actual surveys made by me or under my supervision and that the same are true and correct to the best of my knowledge and belief.

Name R. T. Gorman
Position Div. Producing Supt.
Representing Magnolia Petroleum Company
Address Box 633, Midland, Texas

Date Surveyed March 25, 1956
W. B. Bill
Registered Professional Engineer and/or
Land Surveyor 1415