

(SUBMIT IN TRIPLICATE)

Land Office Santa Fe

Lease No. 079392

Unit San Juan 27-5 Unit

14-08-001-950

UNITED STATES
DEPARTMENT OF THE INTERIOR
GEOLOGICAL SURVEY

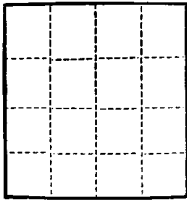

SUNDRY NOTICES AND REPORTS ON WELLS

NOTICE OF INTENTION TO DRILL.....	<input checked="" type="checkbox"/>	SUBSEQUENT REPORT OF WATER SHUT-OFF.....	
NOTICE OF INTENTION TO CHANGE PLANS.....		SUBSEQUENT REPORT OF SHOOTING OR ACIDIZING.....	
NOTICE OF INTENTION TO TEST WATER SHUT-OFF.....		SUBSEQUENT REPORT OF ALTERING CASING.....	
NOTICE OF INTENTION TO RE-DRILL OR REPAIR WELL.....		SUBSEQUENT REPORT OF RE-DRILLING OR REPAIR.....	
NOTICE OF INTENTION TO SHOOT OR ACIDIZE.....		SUBSEQUENT REPORT OF ABANDONMENT.....	
NOTICE OF INTENTION TO PULL OR ALTER CASING.....		SUPPLEMENTARY WELL HISTORY.....	
NOTICE OF INTENTION TO ABANDON WELL.....			

(INDICATE ABOVE BY CHECK MARK NATURE OF REPORT, NOTICE, OR OTHER DATA)

February 17, 1958

Well No. 37 (PM) is located 800 ft. from N line and 840 ft. from E line of 20

NE Sec. 20 27N 5W N.M.P.M.
(1/4 Sec. and Sec. No.) (Twp.) (Range) (Meridian)

Blanco MV-Undesignated P. C. Rio Arriba New Mexico
(Field) (County or Subdivision) (State or Territory)

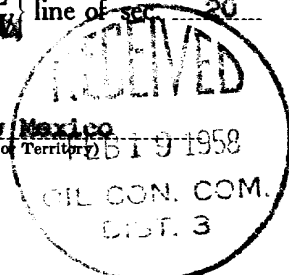

The elevation of the derrick floor above sea level is 6481 ft.

DETAILS OF WORK

(State names of and expected depths to objective sands; show sizes, weights, and lengths of proposed casings; indicate mudding jobs, cementing points, and all other important proposed work)

It is intended to drill a well with rotary tools, usually completing in the Pictured Cliffs formation and in the Mesa Verde formation. Mud circulation will be used thru the Pictured Cliffs and set intermediate casing. Gas circulation will be used thru the Mesa Verde and production liner will be set. Possible productive intervals will be perforated and fractured. Estimated Total Depth 5576'.

Casing Program:

- 10 3/4" at 170' with 150 sacks cement circulated to the surface.
- 7 5/8" at 3416' with 250 sacks cement.
- 5 1/2" liner at 5576' with 300 sacks cement.

The NE/4 of Section 20 is dedicated to the Pictured Cliffs formation.

The E/2 of Section 20 is dedicated to the Mesa Verde formation.

E/2: SF 079392

I understand that this plan of work must receive approval in writing by the Geological Survey before operations may be commenced.

Company El Paso Natural Gas Company

Address Box 997

Farmington, New Mexico

Original Signed D. C. Johnson

By _____

Title Petroleum Engineer

NEW MEXICO OIL CONSERVATION COMMISSION

Well Location and Average Dedication Plat

Section A.

Date **FEBRUARY 4, 1958**

Operator **EL PASO NATURAL GAS COMPANY** Lease **SAN JUAN 27-5 UNIT** SF **079392**
 Well No. **37 (PM)** Unit Letter **A** Section **20** Township **27-N** Range **5-W** NMPM
 Located **800** Feet From **NORTH** Line, **840** Feet From **EAST** Line
 County **RIO ARriba** G. L. Elevation **6481** Dedicated Average **320 & 160** Acres
 Name of Producing Formation **MESA VERDE & PICTURED CLIFF** Pool **MV - BLANCO, PC - WILDCAT**

1. Is the Operator the only owner in the dedicated acreage outlined on the plat below?
 Yes No
2. If the answer to question one is "no", have the interests of all the owners been consolidated by communitization agreement or otherwise? Yes No If answer is "yes", Type of Consolidation.
3. If the answer to question two is "no", list all the owners and their respective interests below.

Owner

Land Description



RECEIVED
 FEB 19 1958
 U. S. GEOLOGICAL SURVEY
 FARMINGTON, NEW MEXICO

Section B.

This is to certify that the information in Section A above is true and complete to the best of my knowledge and belief.

El Paso Natural Gas Company
 (Operator)
Original Signed D. C. Johnston
 (Representative)
Box 997
 (Address)
Farmington, New Mexico

Note: All boundaries must be 400 feet or less in length.

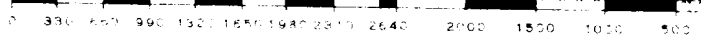
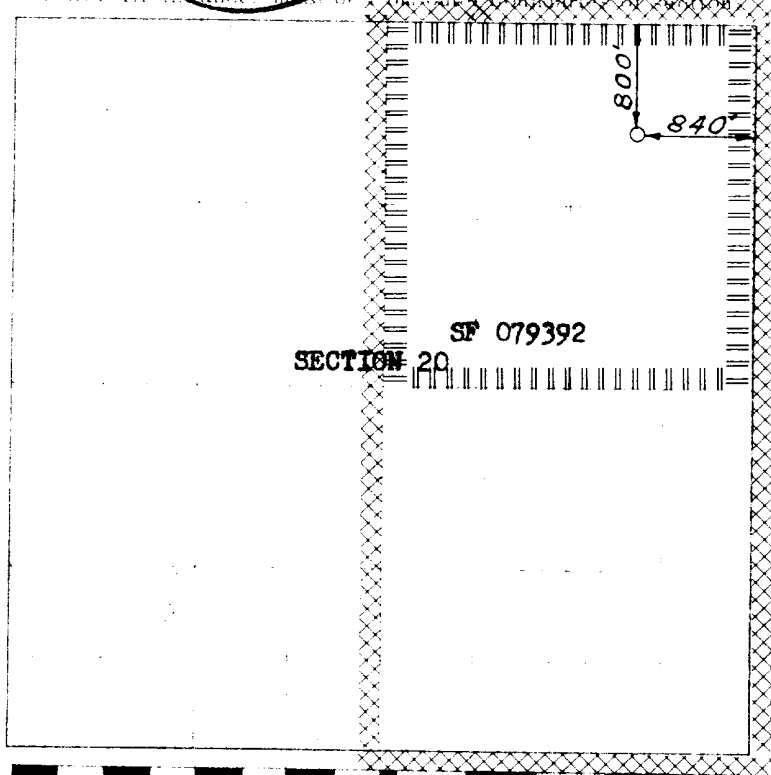

Scale 4 inches equal 1 mile

This is to certify that the above plat was prepared from field notes of actual survey made by me or under my supervision and that the same are true and correct to the best of my knowledge and belief.

(Seal)

Farmington, New Mexico

Date Surveyed **DECEMBER 26, 1957**
David O. Wilver
 Registered Professional Engineer and/or Land Surveyor