

(SUBMIT IN TRIPLICATE)

UNITED STATES  
DEPARTMENT OF THE INTERIOR  
GEOLOGICAL SURVEY

Land Office Santa Fe  
Lease No. 079365  
Unit San Juan 28-6 Unit  
14-08-001-1051

SUNDRY NOTICES AND REPORTS ON WELLS

NOTICE OF INTENTION TO DRILL.....	<input checked="" type="checkbox"/>	SUBSEQUENT REPORT OF WATER SHUT-OFF.....
NOTICE OF INTENTION TO CHANGE PLANS.....		SUBSEQUENT REPORT OF SHOOTING OR ACIDIZING.....
NOTICE OF INTENTION TO TEST WATER SHUT-OFF.....		SUBSEQUENT REPORT OF ALTERING CASING.....
NOTICE OF INTENTION TO RE-DRILL OR REPAIR WELL.....		SUBSEQUENT REPORT OF RE-DRILLING OR REPAIR.....
NOTICE OF INTENTION TO SHOOT OR ACIDIZE.....		SUBSEQUENT REPORT OF ABANDONMENT.....
NOTICE OF INTENTION TO PULL OR ALTER CASING.....		SUPPLEMENTARY WELL HISTORY.....
NOTICE OF INTENTION TO ABANDON WELL.....		

(INDICATE ABOVE BY CHECK MARK NATURE OF REPORT, NOTICE, OR OTHER DATA)

March 19, 1958

Well No. 83 is located 920 ft. from 1000 line and 1650 ft. from E line of sec. 14

SE Sec. 14 27N 6W N.M.P.M.  
( $\frac{1}{4}$  Sec. and Sec. No.) (Twp.) (Range) (Meridian)  
South Blanco Ext. Rio Arriba New Mexico  
(Field) (County or Subdivision) (State or Territory)

The elevation of the derrick floor above sea level is 6616 ft.

DETAILS OF WORK

(State names of and expected depths to objective sands; show sizes, weights, and lengths of proposed casings; indicate mudding jobs, cementing points, and all other important proposed work)

It is intended to drill a well thru the Pictured Cliff formation using rotary tools and to perforate and water fracture possible producing zones. Est. T.D. 3572' Casing Program:

8 5/8" at 120' with 125 sacks regular cement circulated to surface.  
5 1/2" at 3572' with 75 sacks regular cement, 75 sacks Pozmix.

The SE/4 of Section 14 is dedicated to this well.

SE/4: S.F. 079365

I understand that this plan of work must receive approval in writing by the Geological Survey before operations may be commenced.

Company El Paso Natural Gas Company

Address Box 997

Farmington, New Mexico

By Original Signed D. C. Johnston

Title Petroleum Engineer



## NEW MEXICO OIL CONSERVATION COMMISSION

Well Location and Acreage Declaration

Section A.

Date **MARCH 14, 1958**

Operator **EL PASO NATURAL GAS COMPANY** Lease **SAN JUAN 28-6 UNIT** SF **079365**  
 Well No. **83** Unit Letter **Q** Section **14** Township **27-N** Range **6-W** NADPM  
 Located **990** Feet From **SOUTH** Line, **1650** Foot From **EAST** Line  
 County **RIO ARriba** G. L. Elevation **6606** Dedicated Acreage **160** Acres  
 Name of Producing Formation **PICTURED CLIFF** Pool **SOUTH BLANCO P.C. EXTENSION**

1. Is the Operator the only owner in the dedicated acreage outlined on the plat below?

Yes ☒ No ☐2. If the answer to question one is "no", have the interests of all the owners been noted and have they agreed to the agreement or otherwise? Yes ☐ No ☐ If answer is "no", give of all interests.

3. If the answer to question two is "no", list all the owners and their respective interest below:

Owner

Interest Description

**RECEIVED**  
**MAR 19 1958**  
**U. S. GEOLOGICAL SURVEY**  
**FARMINGTON, NEW MEXICO**

Section B.

Note: All distances must be from corner boundaries of section.

This is to certify that the information  
 in Section A above is true and complete  
 to the best of my knowledge and belief.

**El Paso Natural Gas Company**

(Operator)

**Original Signed D. C. Johnston**

(Representative)

**Box 991**

(Address)

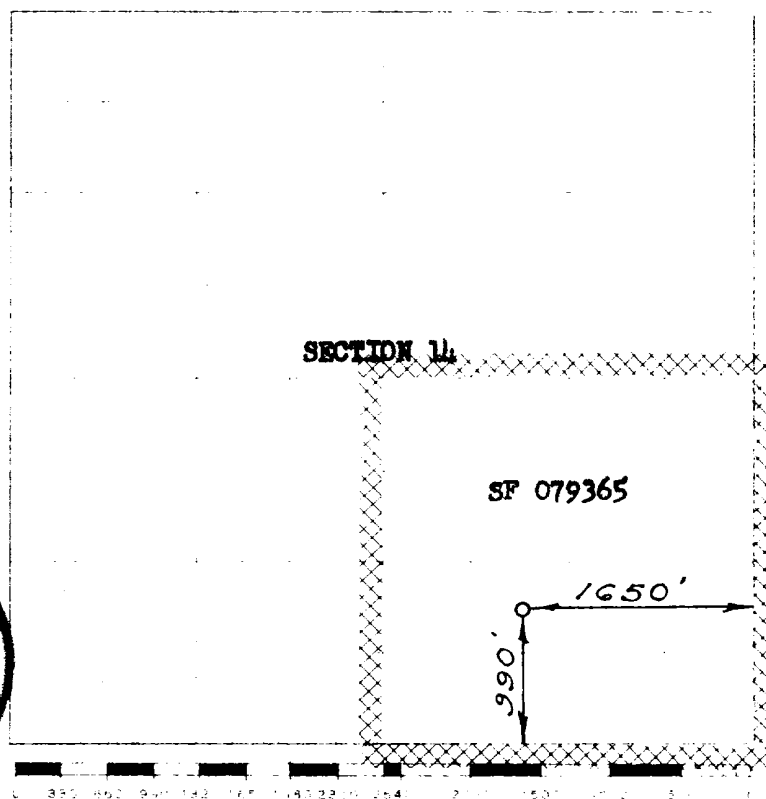
**Farmington, New Mexico**

Scale 4 inches equal 1 mile

This is to certify that the above plat was prepared from a plat of the land survey made by me or under my supervision, and that the same is true and correct to the best of my knowledge and belief.

(Seal)

Date

**FEBRUARY 25, 1958**

*David Q. Wilson*  
 District Engineer

Farmington, New Mexico