

P. O. Box 945
Farmington, New Mexico

July 31, 1956

El Paso Natural Gas Company
Box 977
Farmington, New Mexico

RE: Santa Fe 079052

Gentlemen:

Receipt is acknowledged of your "Notice of Intention to Drill" dated July 30, 1956 covering your well No. 81 Rincon Unit in SW $\frac{1}{4}$ sec. 17, T. 27 N., R. 6 W., N. M. P. M., Rio Arriba County, New Mexico, Blanco pool.

Your proposed work is hereby approved subject to compliance with the provisions of the "Oil and Gas Operating Regulations" revised May 25, 1942, a copy of which will be sent to you on request, and subject to the following conditions:

1. Drilling operations so authorized are subject to the attached sheet for general conditions of approval.
2. Furnish copies of all logs.

Very truly yours,

(Orig. Sgd.) P. T. McGrath

P. T. McGrath
District Engineer

P.T.McGrath:al



COPY TO O. G. C.

(SUBMIT IN TRIPLICATE)

UNITED STATES
DEPARTMENT OF THE INTERIOR
GEOLOGICAL SURVEY

Land Office Santa Fe
Lease No. 079052
Unit Lincoln Unit

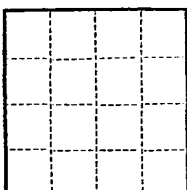

SUNDRY NOTICES AND REPORTS ON WELLS

NOTICE OF INTENTION TO DRILL	<input checked="" type="checkbox"/>	SUBSEQUENT REPORT OF WATER SHUT-OFF	
NOTICE OF INTENTION TO CHANGE PLANS		SUBSEQUENT REPORT OF SHOOTING OR ACIDIZING	
NOTICE OF INTENTION TO TEST WATER SHUT-OFF		SUBSEQUENT REPORT OF ALTERING CASING	
NOTICE OF INTENTION TO RE-DRILL OR REPAIR WELL		SUBSEQUENT REPORT OF RE-DRILLING OR REPAIR	
NOTICE OF INTENTION TO SHOOT OR ACIDIZE		SUBSEQUENT REPORT OF ABANDONMENT	
NOTICE OF INTENTION TO PULL OR ALTER CASING		SUPPLEMENTARY WELL HISTORY	
NOTICE OF INTENTION TO ABANDON WELL			

(INDICATE ABOVE BY CHECK MARK NATURE OF REPORT, NOTICE, OR OTHER DATA)

July 30, 1956

Well No. 81 is located 1360 ft. from S line and 1948 ft. from W line of sec. 17
SW Section 17 27N 6W 100W
 (1/4 Sec. and Sec. No.) (Twp.) (Range) (Meridian)
Blanco Rio Arriba New Mexico
 (Field) (County or Subdivision) (State or Territory)

The elevation of the derrick floor above sea level is 6298 ft.

DETAILS OF WORK

(State names of and expected depths to objective sands; show sizes, weights, and lengths of proposed casings; indicate mudding jobs, cementing points, and all other important proposed work)

It is intended to drill a well with rotary tools thru the Mesa Verde formation. Mud circulation will be used thru the Pictured Cliffs and set intermediate casing. Gas circulation will be used thru the Mesa Verde and production casing will be set. Possible productive intervals will be perforated and fractured. Estimated T.B. 5345'.

Casing Program:

10 3/4" at 170' with 125 sacks cement circulated to the surface
 7 5/8" at 2970' with 250 sacks cement.
 5 1/2" at 5345' with 150 sacks cement.

The S/2 of Section 17 is dedicated to this well.
 SF 079052 (SW/4, N/2SE, SESE), NW 013654 (NENE).

I understand that this plan of work must receive approval in writing by the Geological Survey before operations may be commenced.

Company El Paso Natural Gas Company

Address Box 997

Farmington, New Mexico

By F. W. Boyd

Petroleum Engineer

Title _____



NEW MEXICO
OIL CONSERVATION COMMISSION

Form C-128

WELL LOCATION AND/OR GAS PRORATION PLAT

DATE JUNE 22, 1956

OPERATOR EL PASO NATURAL GAS COMPANY LEASE RINCON UNIT SF 079052

WELL NO. 81 SECTION 17 TOWNSHIP 27-N RANGE 6-W NMPM

CORNER 1360 FEET FROM SOUTH LINE 1948 FEET FROM WEST LINE

RIO ARRIBA COUNTY, NEW MEXICO G.L. ELEVATION 6288

NAME OF LAND INTEREST MESA VERDE COLOR BLANCO DEDICATED ACREAGE 320 ACRES
(1882 PLAT)

Note: All distances must be from outer boundaries of section.

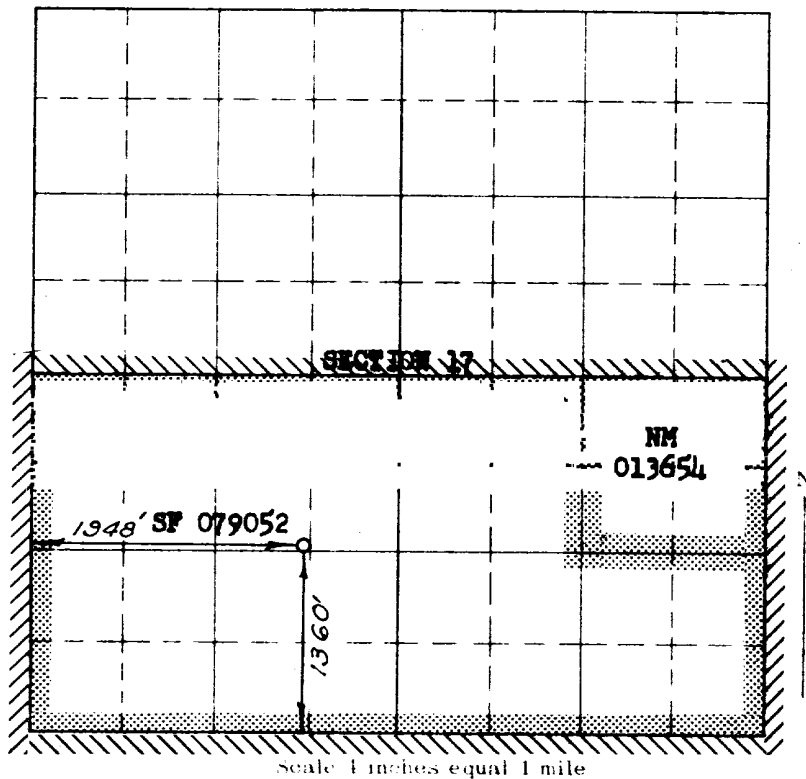

RECEIVED
JUL 31 1956
U. S. GEOLOGICAL SURVEY
FARMINGTON, NEW MEXICO

NOTE

This section of
form is to be used
for gas wells only

This is to certify that the above plat was prepared from
field notes of actual surveys made by me or under my
supervision and that the same are true and correct to the
best of my knowledge and belief.

Date Surveyed MAY 14, 1956

C. O. Walker
Registered Professional Engineer and/or Land Surveyor

(Seal)

Farmington, New Mexico

1. Is this well a Dual Comp.

Yes _____ No X

2. If the answer to Question 1
is yes, are there any other dually
completed wells within the
dedicated acreage.

Yes _____ No _____

Name Ed Boyd

Position Petroleum Engineer

Representing El Paso Natural Gas Co.

Address Box 997, Farmington, N.M.

EL PASO NATURAL GAS COMPANY
OPEN FLOW TEST DATA

DATE September 18, 1956

Operator El Paso Natural Gas Company		Lease Rincon Unit # 81	
Location 1360'S, 1948'W, Sec. 17-27-6		County Rio Arriba	State New Mexico
Formation Mesa Verde		Pool Blanco	
Casing: Diameter 5½	Set At: Feet 5340	Tubing: Diameter 2	Set At: Feet 5251
Pay Zone: From 4570	To 5196	Total Depth: 5345	
Stimulation Method Sand Water Frac		Flow Through Casing	Flow Through Tubing X

Choke Size, Inches .750		Choke Constant: C 14.1605	
Shut-In Pressure, Casing, PSIG 1107	12 = PSIA 1119	Days Shut-In 8	Shut-In Pressure, Tubing, PSIG 1061
Flowing Pressure: P, PSIG 235	12 = PSIA 247	Working Pressure: Pw, PSIG 744	12 = PSIA 756
Temperature: T, F 78	F .75	Fov (From Tables) 1.023	Gravity .684

CHOKE VOLUME: $Q = C \times P_r \times F_v \times F_g \times F_{ov}$

$$Q = 14.1605 \times 247 \times .9831 \times .9393 \times 1.023 = 3304 \text{ MCF/D}$$

OPEN FLOW: $Aof = Q \left(\frac{P_c^2}{P_r^2 - P_w^2} \right)^n$

$$Aof = \left(\frac{1,252,161}{680,625} \right)^n (1.8397)^{.75} \times 3304 = 1.579 \times 3304$$

$$Aof = 5217 \text{ MCF/D}$$

TESTED BY: **K. C. McBride**

WITNESSED BY: _____

L. D. Galloway
L. D. Galloway



OIL CONSERVATION COMMISSION
AZTEC DISTRICT OFFICE

No. Copies Received 3

DISTRIBUTION

	NO. COPIES	
Operator		
Santa Fe	1	
Protraction Office		
State Land Office		
U. S. G. S.	1	
Transporter		
File	1	✓