

NEW MEXICO OIL CONSERVATION COMMISSION  
Santa Fe, New Mexico

Form C-101  
Revised (12/1/55)

NOTICE OF INTENTION TO DRILL

Notice must be given to the District Office of the Oil Conservation Commission and approval obtained before drilling or recompletion begins. If changes in the proposed plan are considered advisable, a copy of this notice showing such changes will be returned to the sender. Submit this notice in QUINTUPPLICATE. One copy will be returned following approval. See additional instructions in Rules and Regulations of the Commission. If State Land submit 6 Copies Attach Form C- 128 in triplicate to first 3 copies of form C-101

Farmington, New Mexico

(Place)

June 14, 1957

(Date)

OIL CONSERVATION COMMISSION  
SANTA FE, NEW MEXICO

Gentlemen:

You are hereby notified that it is our intention to commence the Drilling of a well to be known as

El Paso Natural Gas Company

(Company or Operator)

San Juan 27-4 Unit

(Lease)

Well No. 14 (MD)

in L

(Unit)

located 1600 feet from the South line and 990 feet from the

West

line of Section 18, T. 27N, R. 4W, NMPM.

(GIVE LOCATION FROM SECTION LINE) Blanco M.V. - Dakota Wildcat, Rio Arriba County

If State Land the Oil and Gas Lease is No.

E. W. Green et ux

If patented land the owner is.

Address.

We propose to drill well with drilling equipment as follows: Rotary tools through

Dakota formation using gas circulation

The status of plugging bond is. Statewide

Drilling Contractor Great Western Drilling Co. Rig No. 36

We intend to complete this well in the Mesa Verde and Dakota

formation at an approximate depth of 7865 feet.

CASING PROGRAM

We propose to use the following strings of Casing and to cement them as indicated:

| Size of Hole | Size of Casing | Weight per Foot | New or Second Hand | Depth | Sacks Cement |
|--------------|----------------|-----------------|--------------------|-------|--------------|
| 15"          | 10-3/4"        | 32.75           | New                | 170'  | 150          |
| 9-7/8"       | 7-5/8"         | 26.40           | New                | 5850  | 100          |
| 6-3/4"       | 5-1/2"         | 15.50           | New                | 7685  | 300          |

If changes in the above plans become advisable we will notify you immediately.

ADDITIONAL INFORMATION (If recompletion give full details of proposed plan of work.)

All possible productive zones in the Mesa Verde and Dakota formations will be perforated and water fractured.

The W/2 of Section 18 is dedicated to the Mesa Verde.

All of Section 18 is dedicated to the Dakota.

SF 080669 (N/2; S/2SE); Fee - E. W. Green et ux Sincerely yours, (SW/4); Fee-J.P. Esquivel et al

Approved  
Except as follows:

El Paso Natural Gas Co.  
(Company or Operator)

By

Position

Petroleum Engineer

Send Communications regarding well to

Name

E. J. Coel

Address

Box 997, Farmington, New Mexico

OIL CONSERVATION COMMISSION

By

Well Location and Acreage Dedication Plat

Section A.

Date JUNE 7, 1957

Operator EL PASO NATURAL GAS COMPANY Lease SAN JUAN 27-4 UNIT FEE  
 Well No. 14 MD Unit Letter L Section 10 Township 27 N Range 4 W NMPM  
 Located 1600 Feet From SOUTH Line, 990 Feet From WEST Line  
 County RIO ARRIEA G. L. Elevation 6609 Dedicated Acreage 321.12 ~~641.12~~ Acres  
 Name of Producing Formation MESA VERDE - DAKOTA Pool BLANCO-MV WILDCAT-DAKOTA

1. Is the Operator the only owner in the dedicated acreage outlined on the plat below?  
 Yes ☒ No ☐
2. If the answer to question one is "no", have the interests of all the owners been consolidated by communitization agreement or otherwise? Yes ☐ No ☐ If answer is "yes" specify of Consolidation
3. If the answer to question two is "no", list all the owners and their respective interests

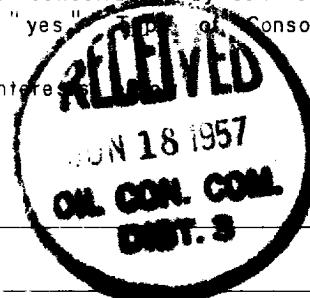
OwnerLand Description

Section B

This is to certify that the information in Section A above is true and complete to the best of my knowledge and belief.

El Paso Natural Gas Co.

(Operator)

*[Signature]*

(Representative)

Box 997

Address

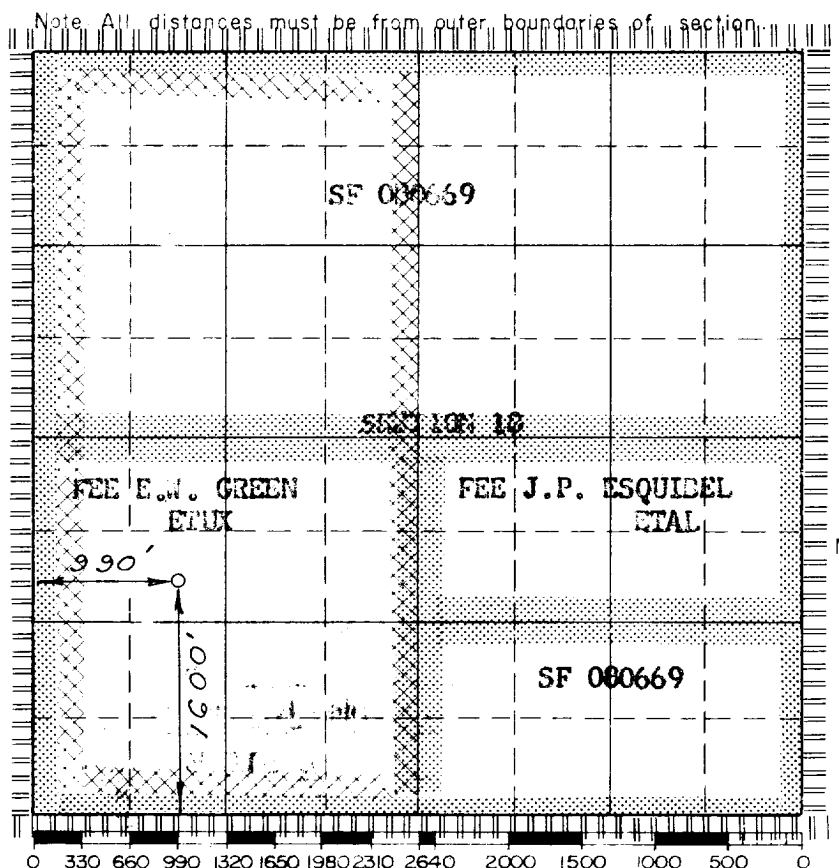
Farmington, New Mexico

Scale 4 inches equal 1 mile

This is to certify that the above plat was prepared from field notes of actual surveys made by me or under my supervision and that the same are true and correct to the best of my knowledge and belief.

Date Surveyed

JUN 7, 1957

(Seal)

Farmington, New Mexico

Registered Professional Engineer and/or Land Surveyor

|                                    |                          |  |
|------------------------------------|--------------------------|--|
| <b>OIL CONSERVATION COMMISSION</b> |                          |  |
| <b>AZTEC DISTRICT OFFICE</b>       |                          |  |
| No. Copies Received <u>6</u>       |                          |  |
| <b>DISTRIBUTION</b>                |                          |  |
|                                    | <b>NO.<br/>FURNISHED</b> |  |
| Operator                           | <u>2</u>                 |  |
| Santa Fe                           | <u>1</u>                 |  |
| Proration Office                   |                          |  |
| State Land Office                  |                          |  |
| U. S. G. S.                        | <u>2</u>                 |  |
| Transporter                        |                          |  |
| File                               | <u>1</u>                 |  |
|                                    |                          |  |