

UNITED STATES
DEPARTMENT OF THE INTERIOR
BUREAU OF LAND MANAGEMENT

Sundry Notices and Reports on Wells

1. Type of Well
GAS

2. Name of Operator

**BURLINGTON
RESOURCES**

OIL & GAS COMPANY

3. Address & Phone No. of Operator

PO Box 4289, Farmington, NM 87499 (505) 326-9700

4. Location of Well, Footage, Sec., T, R, M

1850' FNL, 1070' FWL, Sec. 14, T-27-N, R-5-W, NMPM
E

5. Lease Number
SF-079492C

6. If Indian, All. or
Tribe Name

7. Unit Agreement Name

San Juan 27-5 Unit

8. Well Name & Number

San Juan 27-5 U #98

9. API Well No.

30-039-07064

10. Field and Pool

Blanco MV/Basin DK

11. County and State

Rio Arriba Co, NM

12. CHECK APPROPRIATE BOX TO INDICATE NATURE OF NOTICE, REPORT, OTHER DATA

Type of Submission

Type of Action

☒ Notice of Intent

☐ Abandonment

☐ Change of Plans

☐ Subsequent Report

☒ Recompletion

☐ New Construction

☐ Final Abandonment

☐ Plugging Back

☐ Non-Routine Fracturing

☐ Casing Repair

☐ Water Shut off

☐ Altering Casing

☐ Conversion to Injection

☐ Other -

13. Describe Proposed or Completed Operations

It is intended to recomplate the subject well in the Mesaverde formation according to the attached procedure and wellbore diagram. The well will then be down hole commingled. A down hole commingle order will be applied for.

RECEIVED
MAR 24 1997

OIL & GAS DIV
BUREAU

14. I hereby certify that the foregoing is true and correct.

Signed *James J. Spauld* (JASPU) Title Regulatory Administrator Date 3/14/97

(This space for Federal or State Office use)

APPROVED BY *AS/Deane W. Spencer*

Title _____

Date

MAR 20 1997

CONDITION OF APPROVAL, if any:

42

NMOCB

District I
PO Box 1980, Hobbs, NM 88241-1980
District II
PO Drawer DD, Artesia, NM 88211-0719
District III
1000 Rio Brazos Rd., Aztec, NM 87410
District IV
PO Box 2088, Santa Fe, NM 87504-2088

State of New Mexico
Energy, Minerals & Natural Resources Department

OIL CONSERVATION DIVISION
PO Box 2088
Santa Fe, NM 87504-2088

Form C-102
Revised February 21, 1994
Instructions on back
Submit to Appropriate District Office
State Lease - 4 Copies
Fee Lease - 3 Copies

☐ AMENDED REPORT

WELL LOCATION AND ACREAGE DEDICATION PLAT

API Number 30-039-07064		Pool Code 72319/71599	Pool Name Blanco Mesaverde/Basin Dakota
Property Code 7454	Property Name San Juan 27-5 Unit		Well Number 98
OGRID No. 14538	Operator Name BURLINGTON RESOURCES OIL & GAS COMPANY		Elevation

¹⁰ Surface Location

UL or lot no.	Section	Township	Range	Lot Ida	Feet from the	North/South line	Feet from the	East/West line	County
E	14	27-N	5-W		1850	North	1070	West	R.A.

¹¹ Bottom Hole Location If Different From Surface

UL or lot no.	Section	Township	Range	Lot Ida	Feet from the	North/South line	Feet from the	East/West line	County

¹² Dedicated Acres
MV-W/320
DK-W/320

¹³ Joint or Infill

¹⁴ Consolidation Code

¹⁵ Order No.

NO ALLOWABLE WILL BE ASSIGNED TO THIS COMPLETION UNTIL ALL INTERESTS HAVE BEEN CONSOLIDATED
OR A NON-STANDARD UNIT HAS BEEN APPROVED BY THE DIVISION

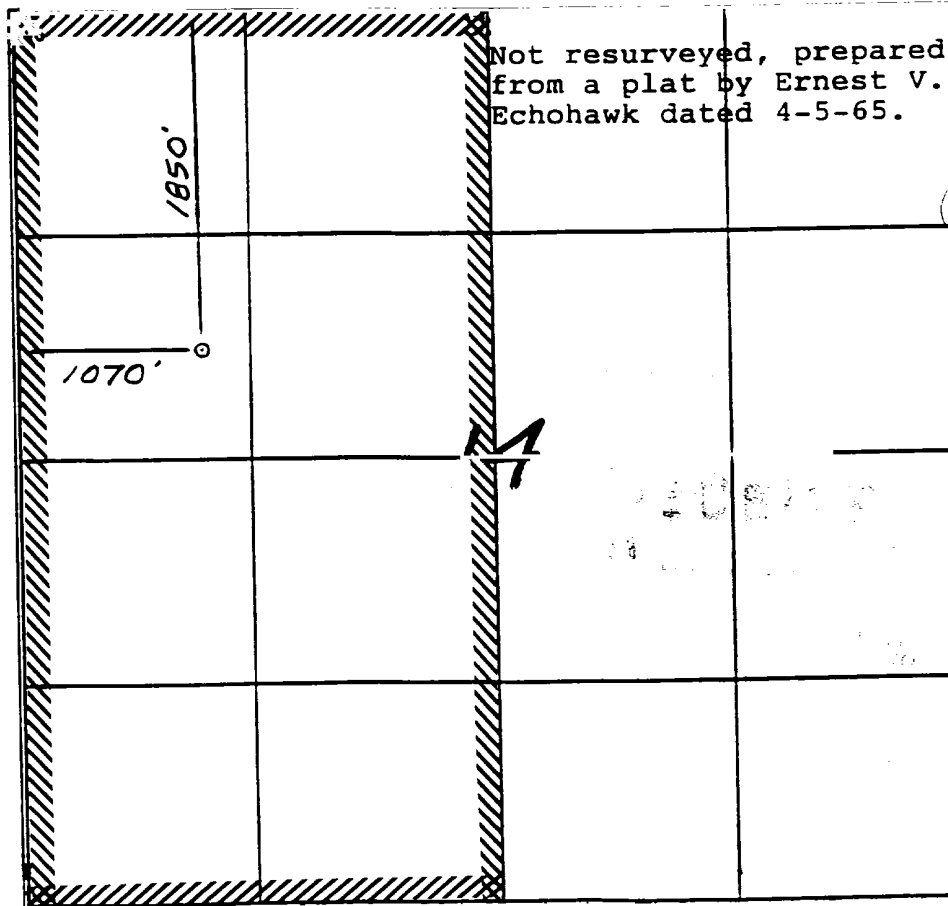

¹⁷ OPERATOR CERTIFICATION

I hereby certify that the information contained herein is true and complete to the best of my knowledge and belief

Peggy Bradfield
Signature
Peggy Bradfield
Printed Name
Regulatory Administrator
Title
Date

¹⁸ SURVEYOR CERTIFICATION

I hereby certify that the well location shown on this plat was plotted from field notes of actual surveys made by me or under my supervision, and that the same is true and correct to the best of my belief.

2/10/97

Date of Survey
Signature and Seal of Professional Surveyor
NEALE C. EDWARDS
NEW MEXICO
6857
REGISTERED PROFESSIONAL SURVEYOR
Certificate Number

BURLINGTON RESOURCES

San Juan 27-5 Unit #98

Blanco Mesaverde R/C & Commingle w/ Dakota
Unit E, Section 14, T27N, R5W
Rio Arriba County, New Mexico
Lat: 36° 34' 32" Long: 107° 19' 57"

-
- Comply with all BLM, NMOCD, & MOI rules & regulations.
 - **Always Hold Safety Meetings.** Place fire and safety equipment in strategic locations.
 - Use DRILL GAS if possible over AIR.
 - 250' of 2-3/8" 4.7#, EUE, J-55 workstring (1 jt needed for prod. tbg) & (6) 3-1/8" drill collars (if necessary)
 - 2 joints of 2-7/8" J-55 or N-80 tubing and 4-1/2" full bore packer.
 - 10 frac tanks to be spotted and filled with 2% KCl water (includes 1 rig tank).
 - Ensure CIBP's are T-Lok, if stacked plugs are run.
-

This well is part of the 1997 MV PUD Commingle program. The well is currently completed in the Dakota with a production rate of 155 MCFD/ <1 BOPD. Cumulative Dakota production is 1,546 MMCF and 9.3 MBO. The Mesaverde interval will be added and the zones will be commingled upon completion of the well.

1. MIRU. Record and report SI pressures on tubing, casing, & bradenhead. Lay blowdown line. Blow down casing & tubing. Kill well w/ 2% KCl down tubing. ND WH, Replace any failed valves or seals on wellhead. NU BOP.
2. TOOH & strap 250 jts of 2-3/8" (J-55, EUE, 4.7#) tubing @ 7865'. Visually inspect tubing, note and report any scale in tubing. Lay down bad joints. Tubing may be used for cleanout and rerun for production string if there is no scale or other problems.
3. Note: DV tool @ 5949' (take notice when running scraper across this interval). PU 3-7/8" bit, 4-1/2" csg scraper, six (6) 3-1/8" drill collars (if necessary) and TIH w/ 2-3/8" tbg. PU and strap additional 2-3/8", 4.7#, J-55, EUE workstring. Clean out w/ gas to PBD @ 7937'. TOOH.
4. RU wireline. If tubing had appreciable scale when pulled from hole in Step 2., run 4-1/2" 10.5# WL gauge ring to 6010'. RIH and set a 4-1/2" CIBP @ 6000'.
5. Load hole w/ 2% KCL water. RU wireline. Hold 1000 psi on casing and run GR/CBL from 5999' to 200' above TOC. Note: Estimated top perforation @ 5069'. RD wireline.
6. PU a 4-1/2" pkr on 2 jts of 2-3/8" tubing and set @ 60'. Pressure test casing and CIBP to 3000 psi (**62% of 4800 psi burst**). Hold for 10 minutes. If PT does not hold, TIH and search for leaks. Locate leak(s). TOOH. Engineering will provide squeeze design if necessary.
7. TIH w/ 2-3/8" workstring open-ended blowing hole dry in stages to 5950' (50' above CIBP). Spot 500 gallons of 15% HCL with 2/1000 gal inhibitor and 1/1000 surfactant. TOOH
8. RU wireline under packoff. Perforate underbalanced Lower Menefee and Point Lookout @ the following depths with 3-1/8" HSC guns, 1 and 2 SPF @ 120° phasing, 12 gram charges (Owen HSC-3125 306T) and 0.29" diameter holes:

2 SPF @ 120° 5907, 5892, 5822, 5815, 5808, 5786, 5752

7 Intervals - 14 Holes

1 SPF

5735, 5722, 5714, 5702, 5688, 5676, 5668, 5656, 5604, 5600,
5578, 5554, 5544, 5532, 5518, 5496, 5492, 5488, 5482

19 Intervals - 19 Holes

Total - 26 Intervals - 33 Holes

9. Change rams to 2-7/8". PU 4-1/2" PKR on 2 jts of 2-7/8", J-55 or N-80 tubing/fracstring.
10. RU stimulation company. Pressure test surface lines to 4000 psi. **Maximum STP = 3000 psi.** Hold 500 psi on annulus behind packer and monitor during the job. Also monitor the 7-5/8" by 4-1/2" annulus. Fracture stimulate the Point Lookout & Lower Menefee w/ Arizona sand in a 25# XL gel. When rate and pressure stabilize during pad shut down and obtain ISIP. When one-half of flush volume is gone, slow rate by 50% to determine if fluid will be on a vacuum. Adjust flush volume accordingly.

If well has pressure when stimulation is complete, stimulation company is to monitor pressures for 30 minutes after shutdown. Flowback well if necessary to release packer. Flowback should continue for as long as necessary to release pkr (not to exceed 3-4 BPM). When well dies, release packer and stand back.

11. RU wireline. If necessary, run 4-1/2" 10.5# WL gauge ring to 5470'. RIH and set a 4-1/2" CIBP @ 5460'.
12. Change to 2-3/8" rams. Load hole w/ 2% KCL water. PU 4-1/2" pkr on 2 jts of 2-3/8" tubing. Pressure test casing and CIBP to 3000 psi (62% of 4800 psi burst). Hold for 10 minutes. Release pressure and stand back packer.
13. TIH open ended w/ 2-3/8" workstring. Blow down with gas going in hole. Blow hole dry @ 5440'. Spot 400 gallons of 15% HCL with 2/1000 gal inhibitor and 1/1000 surfactant. TOOH.
14. RU wireline under packoff. Underbalance perforate the Cliffhouse and Menefee @ the following depths with 3-1/8" HSC guns, 1 and 2 SPF @ 120° phasing, 12 gram charges (Owen HSC-3125 306T) and 0.29" diameter holes:

2 SPF @ 120° 5439, 5423, 5412, 5395, 5362, 5356, 5333, 5311 8 Intervals - 16 Holes

**1 SPF 5302, 5287, 5278, 5274, 5260, 5248, 5242, 5229, 5208, 5203,
5199, 5186, 5179, 5148, 5115, 5108, 5104, 5084, 5069**

19 Intervals - 19 Holes

Total - 27 Intervals - 35 Holes

15. Change out rams to 2-7/8". PU 4-1/2" pkr on 2 jts of 2-7/8", J-55 or N-80 tubing/fracstring.
16. RU stimulation company. Pressure test surface lines to 4000 psi. **Maximum STP = 3000 psi.** Hold 500 psi on annulus behind packer and monitor during the job. Also monitor the 7-5/8" by 4-1/2" annulus. Fracture stimulate the Cliffhouse/Menefee w/ Arizona sand in a 25# XL gel. When rate and pressure stabilize during pad shut down and obtain ISIP. When one-half of flush volume is gone, slow rate by 50% to determine if fluid will be on a vacuum. Adjust flush volume accordingly.
17. If well has pressure when stimulation is complete, flow back well immediately to pit. **Flowback rate not to exceed 4 BPM - choke flowback line with 1/4" to 1/2" positive choke.** Frac company is to monitor flowback pressures for 30 minutes after shutdown. Flowback should continue for as long as necessary to release PKR.
18. When well dies, release pkr & stand back. Change out rams to 2-3/8".
19. PU 3-7/8" bit and collars (if necessary) on 2-3/8" workstring and TIH. Clean out to CIBP @ 5460'. If well cleans and dries up quickly obtain pitot gauge. Obtain 15, 30, 45 & 60 minute pitot gauges.

20. Drill CIBP @ 5460'. Clean out to CIBP @ 6000'. Clean up well to obtain an accurate pitot gauge. Obtain 15, 30, 45 & 60 minute MV pitot gauges. Pitot gauges are required by the NMOCD for commingling approval.
21. Drill CIBP @ 6000'. Clean out to PBTD @ 7937'. Obtain commingled 15, 30, 45 & 60 minute pitot gauges. Pitot gauges are required by the NMOCD for commingling approval. When well is clean TOOH.
22. Run production tubing as follows: expendable check, one joint 2-3/8" tubing, standard SN, and remaining 2-3/8" tubing plus 1 additional joint (+/- 31'). Broach tubing while running in hole. Land tubing @ +/-7896' or approximately 31' deeper than the original tubing depth.
23. ND BOP, NU WH. Pump off expendable check and flow well up tubing. Run swab to SN to ensure tubing is clear. RD & release rig to next location.

Approved:

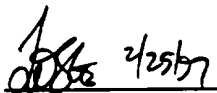
Regional Engineer

Approved:

Drilling Superintendent

Recommended Vendors:

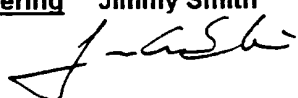
Stimulation	Rig Dependent	Cased Hole Services	Rig Dependent
<u>Engineering</u>	Jimmy Smith 	326-9713-(W) 324-2420-(P) 327-3061-(H)	Sean Woolverton 326-9837- (W) 326-8931- (P) 326-4525- (H)

JAS



PERTINENT DATA SHEET
SAN JUAN 27-5 UNIT #98

<u>Location:</u>	1850' FNL, 1070' FWL Unit E, Section 14, T27N, R5W Rio Arriba County, New Mexico	<u>Elevation:</u>	6679' RDB
		<u>LAT:</u>	36° 34' 32"
		<u>LONG:</u>	107° 19' 57"
<u>Field:</u>	Basin Dakota/Blanco Mesaverde	<u>DP#:</u>	51536A - DK 35747A - MV
<u>TD:</u>	7970'	<u>GWI:</u>	55.02% - DK
<u>PBTD:</u>	7937'	<u>NRI:</u>	46.03% - DK
<u>Spud Date:</u>	05/25/65	<u>GWI:</u>	67.46% - MV
<u>Completion Date:</u>	06/20/65	<u>NRI:</u>	56.91% - MV

Casing Record:

<u>Hole Size</u>	<u>Casing Size</u>	<u>Weight & Grade</u>	<u>Depth Set</u>	<u>Sxs Cmt</u>	<u>Cement Top</u>
13-3/4"	10-3/4"	32.75#	208'	250	surface
9-7/8"	7-5/8"	26.4#, N-80	1630'		
		29.7#, N-80	1630-3666'	1100	1800' (calc)
6-3/4"	4-1/2"	10.5#	7970'	525 (2 stages)	3000' (calc)
		DV Tool @ 5949'			

Tubing Record:

<u>Tubing Size</u>	<u>Weight & Grade</u>	<u>Depth Set</u>	<u>BHA</u>
2-3/8"	4.7#, J-55	7865'	Baker Model 'B' Nipple @ 7825'

Formation Tops:

Pictured Cliffs	3500'	Menefee	5314'	Gallup	6885'
Upp. Cliffhouse	5050'	Pt. Lookout	5650'	Greenhorn	7596'
Mass. Cliffhouse	5175'	Mancos	5825'	Dakota	7804'

Logging Record:

Electric and Gamma Ray Neutron

Stimulation:

Perfs: 7811-19', 7863-69', 7884-90', 7908-14', w/2 SPF
Treated w/600 gal acid, 27,640 gal water, & 16,500# sand

Perfs: 7692-7710' w/3 SPF, Treated w/500 gal acid, 37,070 gal water, & 30,000# sand

Workover History:

None

Production History:

Latest Deliverability	155 MCFD	<1 BOPD
Initial Deliverability	133 MCFD	ISIP: 2256
Cums:	1546 MMCF	9.3 MBO

Transporter:

Oil/Condensate: Giant Gas: Williams

San Juan 27-5 Unit #98
 Blanco Mesaverde/Basin Dakota
 Unit E, Section 14, T27N, R5W
 Rio Arriba County, NM
 Elevation: 6679' RDB
 LAT: 36° 34' 32" / LONG: 107° 19' 57"
 date spud: 05-25-65

