

NEW MEXICO
OIL CONSERVATION COMMISSION

Form C-128

Well Location and/or Gas Proration Plat

Date September 19, 1956

Operator Pacific Northwest Pipeline Corporation Lease Hearville Indian

Well No. Indian, #7 Section 16 Township 27 North Range 3 West NMPM

Located 1386 Feet From North Line, 1236 Feet From East Line,

Rio Arriba County, New Mexico. G. L. Elevation 7078, Ungraded

Name of Producing Formation Mesa Verde Pool Blanco Dedicated Acreage 320

(Note: All distances must be from outer boundaries of Section)

329.90

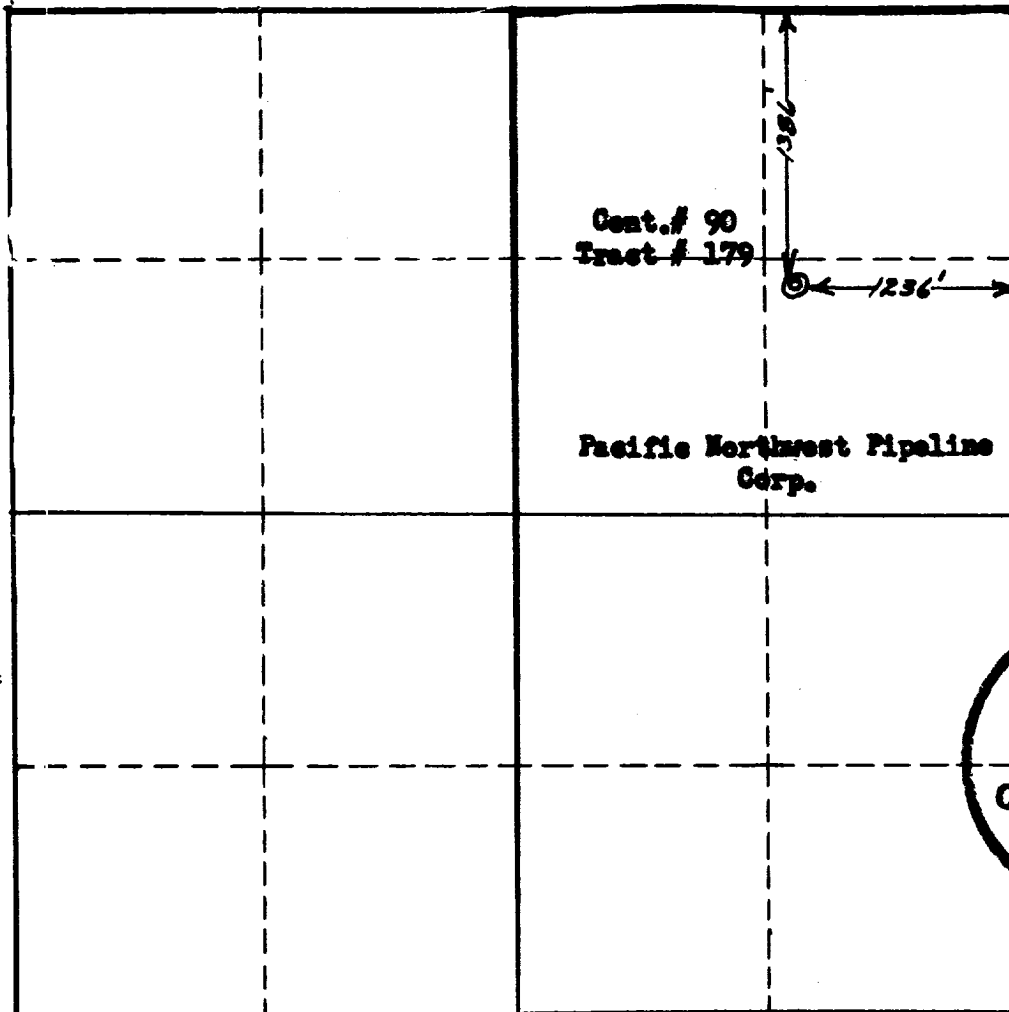

NOTE

This section of form is to be used for gas wells only.

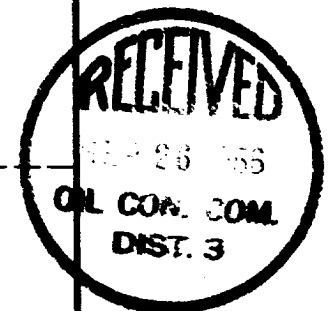

SCALE: 1"=1000'

1. Is this Well a Dual Comp. ? Yes x No .
2. If the answer to Question 1 is yes, are there any other dually completed wells within the dedicated acreage ? Yes No x.

Name J. H. Dugan / Col. m. s.
Position District Engineer
Representing Pacific Northwest Pipeline Corp.
Address 405 1/2 W. Broadway, Farmington, New Mex.

This is to certify that the above plat was prepared from field notes of actual surveys made by me or under my supervision and that the same are true and correct to the best of my knowledge and belief.

Date Surveyed

Registered Professional Engineer and/or Land Surveyor

15.70

40.84

169.90

110.00

221.90