

(SUBMIT IN TRIPLICATE)

UNITED STATES  
DEPARTMENT OF THE INTERIOR  
GEOLOGICAL SURVEY

Land Office Santa Fe  
Lease No. 080671-A  
Unit San Juan 27-4 Unit  
14-08-001-1054

SUNDRY NOTICES AND REPORTS ON WELLS

NOTICE OF INTENTION TO DRILL.....	<input checked="" type="checkbox"/>	SUBSEQUENT REPORT OF WATER SHUT-OFF.....	
NOTICE OF INTENTION TO CHANGE PLANS.....		SUBSEQUENT REPORT OF SHOOTING OR ACIDIZING.....	
NOTICE OF INTENTION TO TEST WATER SHUT-OFF.....		SUBSEQUENT REPORT OF ALTERING CASING.....	
NOTICE OF INTENTION TO RE-DRILL OR REPAIR WELL.....		SUBSEQUENT REPORT OF RE-DRILLING OR REPAIR.....	
NOTICE OF INTENTION TO SHOOT OR ACIDIZE.....		SUBSEQUENT REPORT OF ABANDONMENT.....	
NOTICE OF INTENTION TO PULL OR ALTER CASING.....		SUPPLEMENTARY WELL HISTORY.....	
NOTICE OF INTENTION TO ABANDON WELL.....			

(INDICATE ABOVE BY CHECK MARK NATURE OF REPORT, NOTICE, OR OTHER DATA)

May 1, 1961

Well No. 23 is located 990 ft. from XX [S] line and 1150 ft. from XX [W] line of sec. 11

S.W. Section 11 27-N 4-W N.M.P.M.  
(1/4 Sec. and Sec. No.) (Twp.) (Range) (Meridian)

Blanco Mesa Verde Rio Arriba New Mexico  
(Field) (County or Subdivision) (State or Territory)

The elevation of the Ground level ~~surface~~ above sea level is 6901 ft.

DETAILS OF WORK

(State names of and expected depths to objective sands; show sizes, weights, and lengths of proposed casings; indicate mudlogging jobs, cementing points, and all other important proposed work)

It is intended to drill a well with rotary tools thru the Mesa Verde formation. Mud circulation will be used thru the Pictured Cliffs and set intermediate casing. Gas circulation will be used thru the Mesa Verde & production casing will be set. Possible productive intervals will be perforated and fractured. Est. T.D. 6120'.

Casing Program:

- 9 5/8" set at 160' with 180 sacks cement circulated to surface.
- 7" at 3960' with 350 sacks cement - 150% to circulate.
- 2 7/8" at 6120' with 240 sacks cement - 200% to cover 600' above Cliff House top.

The W/2 of Section 11 is dedicated to this well.

I understand that this plan of work must receive approval in writing by the Geological Survey before operations may be commenced.

Company El Paso Natural Gas Company

Address Box 990

Farmington, New Mexico

By Original Signed D W. Mahan

Title Petroleum Engineer

## Well Location and Acreage Dedication Plat

Section A.

Date **April 18, 1961**Operator **EL PASO NATURAL GAS COMPANY**Lease **SAN JUAN 27-4 UNIT SF 080671-A**Well No. **28** Unit Letter **M** Section **11**Located **990** Feet From **SOUTH** Line **1150**County **RIO ARRIBA** G. L. Elevation **6881**Name of Producing Formation **MESA VERDE**Township **27-N** Range **4-W** NMPMFoot From **WEST** LineDesignated Acreage **320** AcresPool **BLANCO MESA VERDE**

1. Is the Operator the only owner in the dedicated acreage outlined on the plat below?

Yes ☒ No

2. If the answer to question one is "no", have the interests of all the owners been consolidated by communitization agreement or otherwise? Yes No If answer is "yes", Type of Consolidation.

3. If the answer to question two is "no", list all the owners and their respective interests below:

Owner

Land Description



Section B.

Note: All distances must be from outer boundaries of section.

This is to certify that the information in Section A above is true and complete to the best of my knowledge and belief.

**El Paso Natural Gas Company**

(Operator)

Original Signed by **W. Meehan**

(Representative)

**Box 990**

(Address)

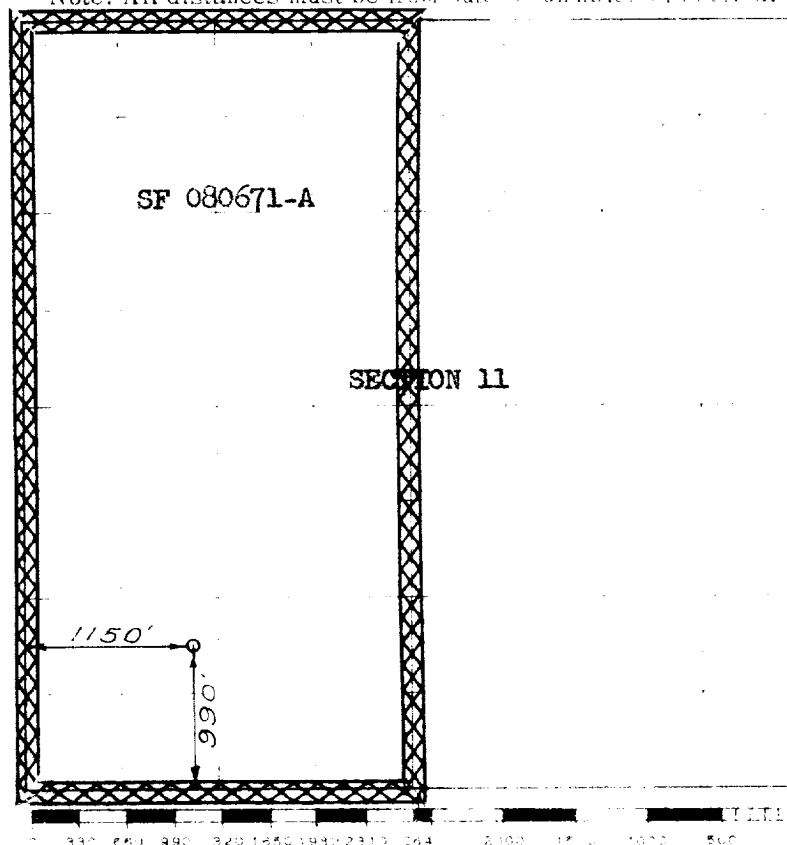
**Farmington, New Mexico**

Scale 1 inch = equal 1 mile

This is to certify that the above plat was prepared from field notes of actual surveys made by me or under my supervision and that the same are true and correct to the best of my knowledge and belief.

(Seal)

Date Surveyed

**April 11, 1961**

Farmington, New Mexico

*David O. Kilmer*  
Registered Professional Engineer and/or Land Surveyor