

(SUBMIT IN TRIPLICATE)

UNITED STATES  
DEPARTMENT OF THE INTERIOR  
GEOLOGICAL SURVEY

Land Office San Juan

Lease No. 079391

Unit Box San Juan 27-5 Unit

14-08-001-950

SUNDRY NOTICES AND REPORTS ON WELLS

NOTICE OF INTENTION TO DRILL.....	<input checked="" type="checkbox"/>	SUBSEQUENT REPORT OF WATER SHUT-OFF.....
NOTICE OF INTENTION TO CHANGE PLANS.....		SUBSEQUENT REPORT OF SHOOTING OR ACIDIZING.....
NOTICE OF INTENTION TO TEST WATER SHUT-OFF.....		SUBSEQUENT REPORT OF ALTERING CASING.....
NOTICE OF INTENTION TO RE-DRILL OR REPAIR WELL.....		SUBSEQUENT REPORT OF RE-DRILLING OR REPAIR.....
NOTICE OF INTENTION TO SHOOT OR ACIDIZE.....		SUBSEQUENT REPORT OF ABANDONMENT.....
NOTICE OF INTENTION TO PULL OR ALTER CASING.....		SUPPLEMENTARY WELL HISTORY.....
NOTICE OF INTENTION TO ABANDON WELL.....		

(INDICATE ABOVE BY CHECK MARK NATURE OF REPORT, NOTICE, OR OTHER DATA)

February 20, 1959

Well No. 46 (IM) is located 2000 ft. from S line and 0 ft. from W line of sec. 7

SW Sec. 7 SW N.M.P.M.  
( $\frac{1}{4}$  Sec. and Sec. No.) (Twp.) (Range) (Meridian)

El Paso & Co. El Paso P. Co. Mkt. Rio Arriba N.M.  
(Field) (County or Subdivision) (State or Territory)

The elevation of the derrick floor above sea level is 6534 ft.

DETAILS OF WORK

(State names of and expected depths to objective sands; show sizes, weights, and lengths of proposed casings; indicate mudding jobs, cementing points, and all other important proposed work)

It is intended to drill & dual complete a well in the Pictured Cliffs formation & Mesa Verde formation. Mud circulation will be used thru the Pictured Cliffs formation & set intermediate casing. Gas circulation will be used thru the Mesa Verde & a production liner will be set. Possible productive intervals will be perforated & fractured. Estimated Total Depth 5683'.

Casing Program:

10 3/4" at 170' with 125 sacks cement circulated to the surface.

7 5/8" at 3490' with 250 sacks cement.

5 1/2" liner at 5683' with 300 sacks cement.

The W/2 of Section 7 is dedicated to the Mesa Verde

The SW/4 of Section 7 is dedicated to the Pictured Cliffs.

W/2: SW 079391

I understand that this plan of work must receive approval in writing by the Geological Survey before operations may be commenced.

Company El Paso Natural Gas Company

Address Box 997

Farmington, New Mexico

By ORIGINAL SIGNED J.J. TILLERSON

Title Petroleum Engineer



## NEW MEXICO OIL CONSERVATION COMMISSION

## Well Location and Acreage Dedication Plat

Section A.

Date **FEBRUARY 16, 1959**Operator **EL PASO NATURAL GAS COMPANY**Lease **SAN JUAN 27-5 UNIT**SF **079391**Well No. **46 (PM)** Unit Letter **M** Section **7**Township **27-N** Range **5-W** NMPMLocated **1090** Feet From **SOUTH** Line **890**Foot From **WEST** LineCounty **RIO ARriba** G. L. Elevation **6524**Dedicated Acreage **322.04 & 160.91** AcresName of Producing Formation **MESA VERDE & PICTURED CLIFF**Pool **BLANCO MV, SO. BLANCO PC EXT.**

1. Is the Operator the only owner in the dedicated acreage outlined on the plat below?

Yes ☒ No

2. If the answer to question one is "no", have the interests of all the owners been ascertained by communication agreement or otherwise? Yes No If answer is "yes", Type of Consolidation

3. If the answer to question two is "no", list all the owners and their respective interests below.

Owner



FEB 26 1959

Section B.

This is to certify that the information in Section A above is true and complete to the best of my knowledge and belief.

**El Paso Natural Gas Company**ORIGINAL SIGNED **J.J. TILLERSON**

(Representative)

**Box 997**

(Address)

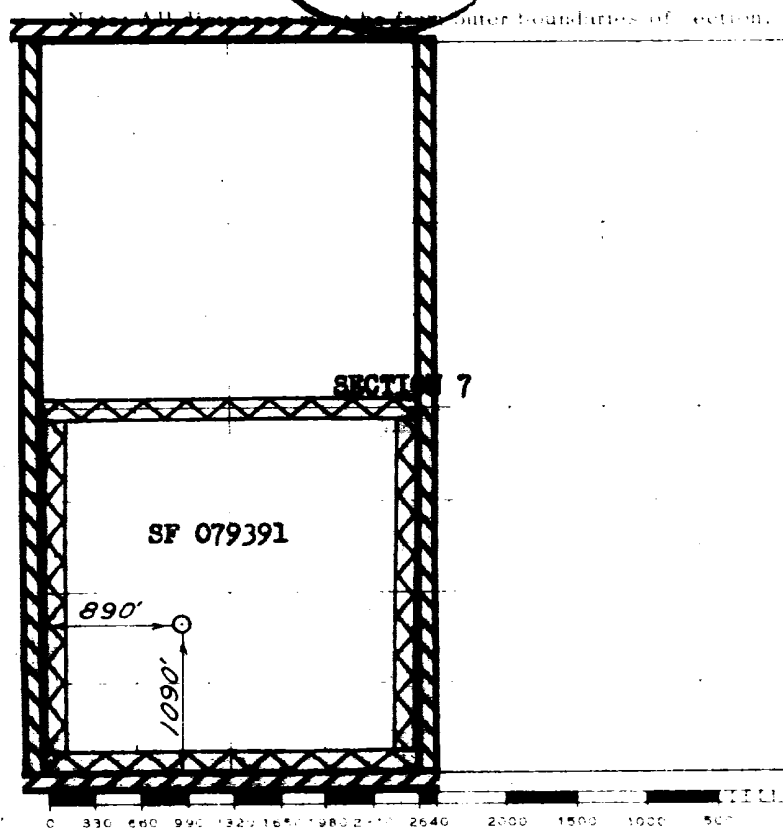
**Farmington, New Mexico**

Scale 4 inches equal 1 mile

This is to certify that the above plat was prepared from field notes of actual surveys made by me or under my supervision and that the same are true and correct to the best of my knowledge and belief.

(Seal)

Farmington, New Mexico

Date Surveyed **FEBRUARY 11, 1959**

*David O. Tillerson*  
Registered Professional Engineer and/or Land Surveyor