

(SUBMIT IN TRIPLICATE)

UNITED STATES
DEPARTMENT OF THE INTERIOR
GEOLOGICAL SURVEY

Land Office Santa Fe
Lease No. 079363
Unit San Juan 28-6 Unit
14-06-001-1051

SUNDRY NOTICES AND REPORTS ON WELLS

NOTICE OF INTENTION TO DRILL.....	<input checked="" type="checkbox"/>	SUBSEQUENT REPORT OF WATER SHUT-OFF.....	
NOTICE OF INTENTION TO CHANGE PLANS.....		SUBSEQUENT REPORT OF SHOOTING OR ACIDIZING.....	
NOTICE OF INTENTION TO TEST WATER SHUT-OFF.....		SUBSEQUENT REPORT OF ALTERING CASING.....	
NOTICE OF INTENTION TO RE-DRILL OR REPAIR WELL.....		SUBSEQUENT REPORT OF RE-DRILLING OR REPAIR.....	
NOTICE OF INTENTION TO SHOOT OR ACIDIZE.....		SUBSEQUENT REPORT OF ABANDONMENT.....	
NOTICE OF INTENTION TO PULL OR ALTER CASING.....		SUPPLEMENTARY WELL HISTORY.....	
NOTICE OF INTENTION TO ABANDON WELL.....			

(INDICATE ABOVE BY CHECK MARK NATURE OF REPORT, NOTICE, OR OTHER DATA)

March 3, 1958

Well No. 60 (H) is located 1650 ft. from N line and 1750 ft. from E line of sec. 12

NE Sec. 12
(1/4 Sec. and Sec. No.)

27N
(Twp.)

6W
(Range)

N.M.P.M.
(Meridian)

Blanco N. V.
(Name)

Rio Arriba
(County or Subdivision)

New Mexico
(State or Territory)

Undesignated i. e.

The elevation of the derrick floor above sea level is 6433 ft.

DETAILS OF WORK

(State names of and expected depths to objective sands; show sizes, weights, and lengths of proposed casings; indicate mudding jobs, cementing points, and all other important proposed work)

It is intended to drill & dual complete a well in the Pictured Cliffs formation & Mesa Verde formation. Mud circulation will be used thru the Pictured Cliffs formation & set intermediate casing. Gas circulation will be used thru the Mesa Verde & a production liner will be set. Possible productive intervals will be perforated & fractured. Estimated Total Depth 5583'.

Casing Program:

10 3/4" at 170' with 125 sacks cement circulated to the surface.

7 5/8" at 3360' with 250 sacks cement.

5 1/2" liner at 5583' with 300 sacks cement.

The E/2 of Section 12 is dedicated to the Mesa Verde.

The NE/4 of Section 12 is dedicated to the Pictured Cliffs.

E/2: SF 079363

I understand that this plan of work must receive approval in writing by the Geological Survey before operations may be commenced.

Company El Paso Natural Gas Company

Address Box 991

Farmington, New Mexico

By Original Signed D. C. Johnson

Title Petroleum Engineer

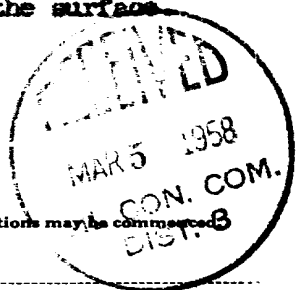

NEW MEXICO OIL CONSERVATION COMMISSION

Well Location and Acreage Definition Plat

Section A.

Date **FEBRUARY 25, 1958**

Operator **EL PASO NATURAL GAS COMPANY** Lease **SAN JUAN 28-6 UNIT** SF **079363**
 Well No. **80 (PM)** Unit Letter **Q** Section **12** Township **27-N** Range **6-W** NMPM
 Located **1650** Feet From **NORTH** Line **1750** Feet From **EAST** Line
 County **RIO ARriba** G. L. Elevation **6423** Demanded Acreage **320 & 160** Acres
 Name of Producing Formation **MESA VERDE & PICTURED CLIFF** Pool **MV - BLANCO, PC - WILDCAT**

1. Is the Operator the only owner in the demarcated acreage outlined on the plat below?
 Yes ☒ No ☐
 2. If the answer to question one is "no", have the interests of all the owners been consolidated by communitization agreement or otherwise? Yes ☐ No ☐ If answer is "yes", Type of Consolidation:

3. If the answer to question two is "no", list all the owners and their respective interests below:

Owner

Land Description

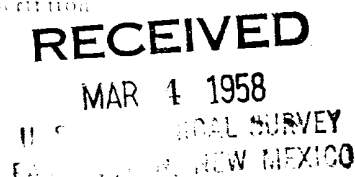
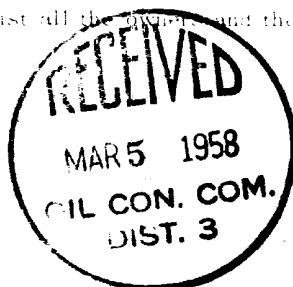

Section B.

Note: All distances must be

This is to certify that the information in Section A above is true and complete to the best of my knowledge and belief.

El Paso Natural Gas Company
 Operator

Original Signed D. C. Johnson
 (Representative)

Box 997 Address

Farmington, New Mexico

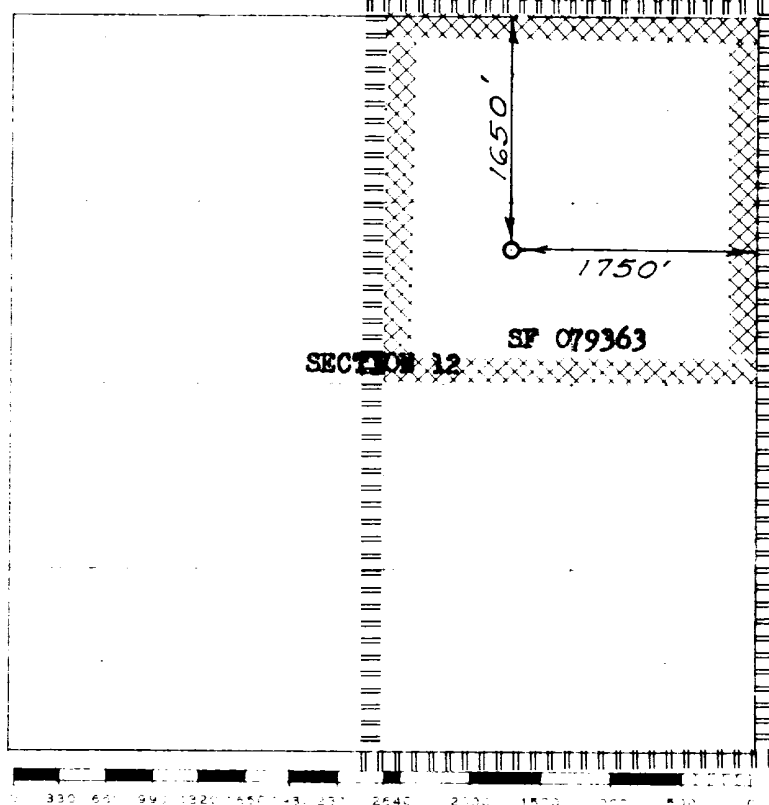

Scale: 1 inch = 1 mile

This is to certify that the above plat was prepared from field notes of actual surveys made by me or under my supervision and that the same are true and correct to the best of my knowledge and belief.

(Seal)

Date Surveyed **JANUARY 31, 1958**

Farmington, New Mexico

David O. Kilmer
 Registered Professional Engineer and/or Land Surveyor