

(SUBMIT IN TRIPlicate)

UNITED STATES
DEPARTMENT OF THE INTERIOR
GEOLOGICAL SURVEY

Land Office **Santa Fe**
Lease No. **079391**
Unit **San Juan 27-5 Unit**

RECEIVED

MAY 28 1962

SUNDRY NOTICES AND REPORTS ON WELLS

| U. S. GEOLOGICAL SURVEY FARMINGTON, NEW MEXICO | |
|---|--|
| NOTICE OF INTENTION TO DRILL | XX SUBSEQUENT REPORT OF WATER |
| NOTICE OF INTENTION TO CHANGE PLANS | SUBSEQUENT REPORT OF SHOOTING OR ACIDIZING |
| NOTICE OF INTENTION TO TEST WATER SHUT OFF | SUBSEQUENT REPORT OF ALTERING CASING |
| NOTICE OF INTENTION TO RE-DRILL OR REPAIR WELL | SUBSEQUENT REPORT OF RE-DRILLING OR REPAIR |
| NOTICE OF INTENTION TO SHOOT OR ACIDIZE | SUBSEQUENT REPORT OF ABANDONMENT |
| NOTICE OF INTENTION TO PULL OR ALTER CASING | SUPPLEMENTARY WELL HISTORY |
| NOTICE OF INTENTION TO ABANDON WELL | |

INDICATE ABOVE BY CHECK MARK NATURE OF REPORT, NOTICE OR OTHER DATA

May 25,

19 62

Well No. 69(MD) is located 1090 ft from ~~XXX~~ line and 990 ft from ~~XX~~ line of sec. 7

NE/4 Section 7 27-N 5-W N.M.P.M.

Blanco Mesa Verde &
Basin Dakota

Rio Arriba

New Mexico

The elevation of the derrick floor above sea level is 6639 ft.

DETAILS OF WORK

(State names of and expected depths of the various casing, cement, weights, and logs, and if present casings; indicate mudding, tubs, cement, and other important or unusual work.)

It is intended to mud drill a well with rotary tools to 7979', and set a combination 4 1/2" x 5 1/2" production string. All possible Mesa Verde & Dakota producing zones will be perforated and fractured. The well will then be dually completed.

Casing Program:

9 5/8" @ 280' w/200 sacks cement circulated to surface.
5 1/2" x 4 1/2" @ 7979' with 2 and 3 stages collars. 2nd stage collar 50' - 100' below base of Mesa Verde. 3rd stage collar 50' - 100' below base of Pictured Cliffs. Cemented 1st stage w/145 sks. to cover 100' above top of Greenhorn. 2nd stage w/210 sks. to cover 100' above top of Cliff House. 3rd stage w/200 sks. to cover Ojo Alamo.

The E/2 of Section 7 is dedicated to this well.

I understand that this plan of work must receive approval in writing by the geologist in charge of operations before operations may be commenced.

Company **El Paso Natural Gas Company**

Address **Box 990**

Farmington, New Mexico

and **R. W. Meehan**
Petroleum Engineer

7D 7979

NEW MEXICO OIL CONSERVATION COMMISSION

Well Location and Acreage Dedication Plat

Section A.

Date **MAY 17, 1962**

Operator **EL PASO NATURAL GAS COMPANY** Lease **SAN JUAN 27-5 UNIT** SF079391
Well No. **69 (MD)** Unit Letter **A** Section **7** Township **27-N** Range **5-W** NMPM
Located **1090** Feet From **NORTH** Line, **990** Feet From **EAST** Line
County **RIO ARriba** G. L. Elevation **6629** Dedicated Acreage **320 & 320** Acres
Name of Producing Formation **MESA VERDE & DAKOTA** Pool **BLANCO MV & BASIN DAKOTA**

1. Is the Operator the only owner in the dedicated acreage outlined on the plat below?

Yes ☒ No ☐

2. If the answer to question one is "no", have the interests of all the owners been consolidated by communization agreement or otherwise? Yes ☐ No ☐ If answer is "yes", Type of Consolidation.

3. If the answer to question two is "no", list all the owners and their respective interests below:

Owner

Land Description

Section B.

This is to certify that the information in Section A above is true and complete to the best of my knowledge and belief.

El Paso Natural Gas Company

(Operator)
Original Signed **D. W. Meehan**

(Representative)

Box 990

(Address)

Farmington, New Mexico

Note: All distances must be from outer boundaries of section.

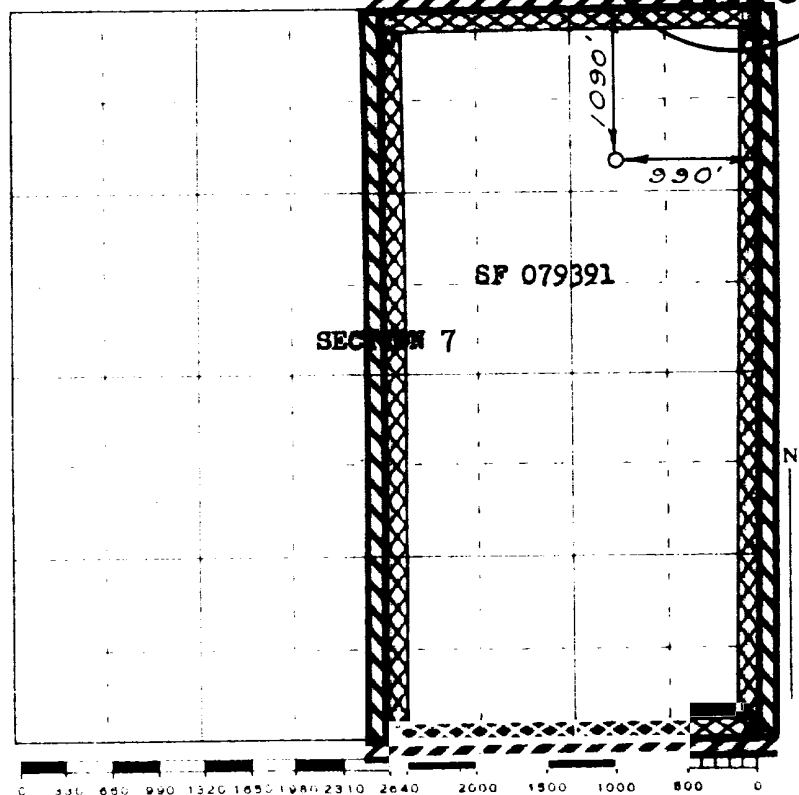

Scale 4 inches equal 1 mile

NOTE:

This plat reissued to show corrected location.

5 17 62

This is to certify that the above plat was prepared from field notes of actual surveys made by me or under my supervision and that the same are true and correct to the best of my knowledge and belief.

(Seal)

Date Surveyed **MAY 2, 1962**

David O. Kilmer
Registered Professional Engineer and/or Land Surveyor

Farmington, New Mexico

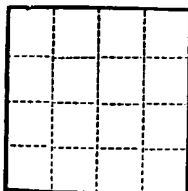

(SUBMIT IN TRIPLICATE)

UNITED STATES
DEPARTMENT OF THE INTERIOR
GEOLOGICAL SURVEY

Land Office Santa Fe
Lease No. 079391
Unit San Juan 27-5

SUNDRY NOTICES AND REPORTS ON WELLS

| | | | |
|--|--|--|-------------------------------------|
| NOTICE OF INTENTION TO DRILL | | SUBSEQUENT REPORT OF WATER SHUT-OFF | <input checked="" type="checkbox"/> |
| NOTICE OF INTENTION TO CHANGE PLANS | | SUBSEQUENT REPORT OF SHOOTING OR ACIDIZING | |
| NOTICE OF INTENTION TO TEST WATER SHUT-OFF | | SUBSEQUENT REPORT OF ALTERING CASING | |
| NOTICE OF INTENTION TO RE-DRILL OR REPAIR WELL | | SUBSEQUENT REPORT OF RE-DRILLING OR REPAIR | |
| NOTICE OF INTENTION TO SHOOT OR ACIDIZE | | SUBSEQUENT REPORT OF ABANDONMENT | |
| NOTICE OF INTENTION TO PULL OR ALTER CASING | | SUPPLEMENTARY WELL HISTORY | |
| NOTICE OF INTENTION TO ABANDON WELL | | | |

(INDICATE ABOVE BY CHECK MARK NATURE OF REPORT, NOTICE, OR OTHER DATA)

June 5, 1962

Well No. 69(MD) is located 1090 ft. from S line and 990 ft. from E line of sec. 7

NE Section 7
($\frac{1}{4}$ Sec. and Sec. No.)

27-N
(Twp.)

5-W
(Range)

N.M.P.M.
(Meridian)

Blanco Mesa Verde & Basin Dakota

Rio Arriba
(County or Subdivision)

New Mexico
(State or Territory)

The elevation of the derrick floor above sea level is 6639 ft.

DETAILS OF WORK

(State names of and expected depths to objective sands; show sizes, weights, and lengths of proposed casings; indicate mudding jobs, cementing points, and all other important proposed work)

Spud date 5-28-62.

On 5-28-62 T.D. 295'. Ran 9 joints 9 5/8" 36# J-55 (281') at 293'. Cemented w/200 sacks regular w/1/4 cu. ft. Strata-Crete "6"/sk., 2# HA-5. Circulated to surface. Held 600#/30 minutes.



I understand that this plan of work must receive approval in writing by the Geological Survey before operations may be commenced.

Company El Paso Natural Gas Company

Address Box 990

Farmington, New Mexico

By Original Signed D. W. Meehan

Title Petroleum Engineer