

District I
PO Box 1980, Hobbs, NM 88241 1980
District II
PO Drawer DD, Artesia, NM 88211-0719
District III
1000 Rio Brazos Rd., Aztec, NM 87410
District IV
PO Box 2088, Santa Fe, NM 87504-2088

State of New Mexico
Energy, Minerals & Natural Resources Department

OIL CONSERVATION DIVISION
PO Box 2088
Santa Fe, NM 87504-2088

Form C-101
Revised February 10, 1994
Instructions on back
Submit to Appropriate District Office
State Lease - 6 Copies
Fee Lease - 5 Copies

☐ AMENDED REPORT

APPLICATION FOR PERMIT TO DRILL, RE-ENTER, DEEPEN, PLUGBACK, OR ADD A ZONE

Operator Name and Address: Conoco Inc 10 Desta Dr. Ste. 100W Midland, Tx. 79705-4500		OGRID No. 005073
Property Code 016608	Property Name San Juan 28-7 Unit	API Number 30-039-07180
		Well No. 130

Surface Location

UL or lot no.	Section	Township	Range	Lot Idn	Feet from the	North/South line	Feet from the	East/West line	County
L	2	27N	7W		1668'	South	800'	West	Rio Arriba

s Proposed Bottom Hole Location If Different From Surface

UL or lot no	Section	Township	Range	Lot Idn	Feet from the	North/South line	Feet from the	East/West line	County
Proposed Pool 1 Blanco Mesaverde					Proposed Pool 2 Basin Dakota				

Work Type Code A 16 Multiple Yes-Downhole Commingle w/Dakota	Well Type Code M 17 Proposed Depth 7309'	Cable Rotary R 18 Formation	Lease type Code S (E 290-33) 19 Contractor	Ground Level Elevation 6165' 20 Spud Date
--	---	-----------------------------------	--	---

21 Proposed Casing and Cement Program

Hole Size	Casing Size	Casing weight/foot	Setting Depth	Sacks of Cement	Estimated TOC
Same as original					

Describe the proposed program. If this application is to DEEPEN or PLUG BACK give the data on the present productive zone and proposed new productive zone. Describe the blowout prevention program, if any. Use additional sheets if necessary.

It is proposed to recomplete this well to the Mesaverde using the attached procedure..

23 I hereby certify that the information given above is true and complete to the best of my knowledge and belief.

Signature:

Kay Maddox

Printed name:

Kay Maddox

Title:

Regulatory Agent - Conoco, Inc

Date:

February 4, 1999

Phone:

(915) 686-5798

OIL CONSERVATION DIVISION

Approved by:

Ernie B...

Title:

DEPUTY OIL & GAS INSPECTOR, DIST. #3

Approval Date:

FEB 16 1999

Expiration Date:

FEB 16 2000

Conditions of Approval:

Attached

**San Juan 28-7 Unit # 130
Mesaverde Recompletion & DHC
API # 30-039-07180**

Please Refer questions to the following people:

Geologic/Logging:	Tom Johnson	(915) 686-6111
Engineering/Procedural:	Randy Herring Pager	(915) 686-6541 800-999-6710 I.D.# 991-7826
Fracturing:	Jim Russell: Pager Mobile	(505) 327-6222 (505) 324-1867 (505) 330-0005
Completion:	Greg Vick: Pager Mobile	(505) 324-5819 (505) 324-2601 (505) 320-4609
	Gilbert Hughes Pager Mobile	(505) 324-5812 (505) 327-8753 (505) 320-4785
	Lino Hernandez: Pager Mobile	(505) 324-5816 (505) 326-8198 (505) 320-6739

Other #'s

BLM:	(505) 599-8900	NMOCD:	(505) 334-6178
One Call:	1-800-321-2537		

Midland Continuous Fax: (915) 686-6112

EMERGENCY NUMBERS:

Aztec Fire & Police:	911	Air Care:	911 or 1-800-452-9990
NM State Police	325-7547	SJ County Sheriff:	334-6107

**San Juan 28-7 Unit # 130
Mesaverde Recompletion & DHC
API # 30-039-07180**

February 2, 1999

Summary of Work Recommended

- Isolate DK zone from MV
- Run CBL across MV (Cmt Sqz if TOC is below 4350')
- Log MV using TDT/GR
- Perf & Stimulate MV Interval (expect 3 stages, May require frac string)
- Remove Isolation Plugs
- Return well to Production as MV/DK DHC

Well Data:

AFE # **51-61-8954** **Downhole Commingle:** **DHC-????**

Location: 1668' FSL & 800' FWL, Sec. 2, T27N-R7W
Rio Arriba County, New Mexico

Elevations: KB: 6175'
GL: 6165'
PBTD: 7253'
TD: 7309'

Casing: 10 3/4", 32.75 #/ft, set @ 2298'
1 stage: 232 sxs. TOC @ Surface (circ)

4-1/2", 10.5 & 11.6 #/ft, set @ 7309'
 11.6 #/ft 14 jts from 0' to 460'
 10.5 #/ft 178 jts from 460' to 5,729'
 11.6 #/ft 35 jts from 5,729' to 7,309'

	Cmt'd w/ 3-stages & 725 sxs		
1 st Stage:		300 sxs	TOC @ 6290 (TS)
2 nd Stage:	DV @ 5299'	195 sxs	TOC @ 4450' (TS)
3 rd Stage:	DV @ 2909'	230 sxs	TOC @ 2000' (TS)

Size	Wt	Drift	Capacity	Burst
10 ¾"	32.75	10.0036"	13.05 ft/bbl	1820 psi
4 ½"	11.6	3.875"	1.532 ft/bbl	5350 psi
4 ½"	10.5	3.927"	1.493 ft/bbl	4790 psi
2 3/8"	4.7	1.901"	258 ft/bbl	5600 psi

Tubing: 2 3/8" 4.7 3/ft @ 7120' Replaced w/ new "A" tubing, June 1998

Perforations: DK: (7044'- 7220') 7000'- 7225'
7044'-48', 64'-68',
7159'-71', 91'-95',
7214'-20'

San Juan 28-7 Unit # 130
Mesaverde Recompletion & DHC
API # 30-039-07180

1. **Hold tailgate safety meetings prior to rigging up, each morning, and whenever necessary.**
2. Test Anchors, MIRU Workover Unit. If necessary, kill well with a minimum of 1 % KCl. NU BOP. POOH w/ 2 3/8" production string.
3. RU wireline unit & set 4 1/2" Fast-Drill plug over the Dakota +/- 5800'
4. RU Logging tools. Run GR/CBL from 5300' to 4300' to determine TOC. Run GR/TDT/CCL from 5350' to 4350'. Fax log into Midland @ (915) 686-6112 continuous log fax or (915) 686-5508 single page fax. Contact Randy Herring (915) 686-6541 or Tom Johnson (915) 686-6111 just prior to sending Fax to ensure machine is ready to receive. **Note: Cmt squeeze if TOC is below 4350'. Contact BLM for approval prior to initiating squeeze work**

Note: If Squeeze work is required adjust procedure to utilize a frac string.

1st Stage

5. Perforate the Lower MV (Point Lookout) across the following intervals using a 3 1/8" Select Fire gun w/ 11 gm charges. Correlate to CCL from TDT log:

Perforations to be determined from TDT Log. (Estimate 30 holes)
6. RU Acidizing equipment. Test lines to 4000 psi Break down perms using 500 gallons 15% HCl and 50% excess 1.1 sg balls (45) spaced equally throughout the job. Run as high a rate as possible without exceeding max pressure. **DO NOT EXCEED 3500 psi**
7. Retrieve balls and check for hits. If # hits less than 80% (24), re-acidize using the above procedure. Prep to frac.
8. Frac per attached procedure. Leave frac equipment on location. RIH and set w/ Fast-drill plug above Point Lookout (Depth to be determined from TDT log).

2nd Stage

9. Perforate the Menefee across the following intervals using a 3 1/8" Select Fire gun w/ 11 gm charges. Correlate to CCL from TDT log:

Perforations to be determined from TDT Log. (Estimate 30 holes)
10. RU Acidizing equipment. Test lines to 4000 psi Break down perms using 500 gallons 15% HCl and 50% excess 1.1 sg balls (45) spaced equally throughout the job. Run as high a rate as possible without exceeding max pressure. **DO NOT EXCEED 3500 psi**

**San Juan 28-7 Unit # 130
Mesaverde Recompletion & DHC
API # 30-039-07180**

11. Retrieve balls and check for hits. If # hits less than 80% (24), re-acidize using the above procedure. Prep to frac.
12. Frac per attached procedure. Leave frac equipment on location. RIH and set w/ Fast-drill plug above Point lookout (Depth to be determined from TDT log).

3rd Stage

13. Perforate the Cliffhouse across the following intervals using a 3 1/8" Select Fire gun w/ 11 gm charges. Correlate to CCL from TDT log:

Perforations to be determined from TDT Log. (Estimate 30 holes)
14. RU Acidizing equipment. Test lines to 4000 psi Break down perms using 500 gallons 15% HCl and 50% excess 1.1 sg balls (45) spaced equally throughout the job. Run as high a rate as possible without exceeding max pressure. **DO NOT EXCEED 3500 psi**
15. Retrieve balls and check for hits. If # hits less than 80% (24), re-acidize using the above procedure. Prep to frac.
16. Frac per attached procedure. Clean Location and release frac equipment.
17. Rig up compressors and power swivel. RIH w/ bit & collars on tbg. CO & DO Mesaverde bridge plugs to 5800'. Jet well w/ gas until well will flow on its own. Drywatch as necessary.
18. Test Mesaverde and obtain a stabilized flow rate for allocation purposes.
19. RU compressors and drill out bridge plug @ 5800' w/ gas. Clean out well to PBTD (7267'). Jet well w/ gas until well will flow on its own. Drywatch as necessary.
20. PU & RIH w/ 2 3/8" production string. Land SN at +/- 7120'. ND BOP and NU wellhead.
21. Record and notify necessary personnel for regulatory and gas allocation purposes.
22. RDMO workover unit and clean location.
23. Place well on production
24. Thank You.

Prepared By: _____
Randy B. Herring,
Sr. Production Engineer

District I
PO Box 1980, Hobbs, NM 88241-1980

District II
PO Drawer DD, Artesia, NM 88211-0719

District III
1000 Rio Brazos Rd. Aztec, NM 87410

District IV
PO Box 2088, Santa Fe, NM 87504-2088

State of New Mexico
Energy, Minerals & Natural Resources Department

OIL CONSERVATION DIVISION
PO Box 2088
Santa Fe, NM 87504-2088

Form C-102

Revised February 21, 1994

instructions on back

Submit to Appropriate District Office

State Lease - 4 Copies

Fee Lease - 3 Copies

☐ AMENDED REPORT

WELL LOCATION AND ACREAGE DEDICATION PLAT

API Number 30-039-07180		2 Pool Code 72319	3 Pool Name Blanco Mesaverde
4 Property Code 016608	5 Property Name San Juan 28-7 Unit		6 Well Number # 130
7 OGRID No. 005073	8 Operator Name Conoco Inc., 10 Desta Drive, Ste. 100W, Midland, TX 79705-4500		9 Elevation 6165'

10 Surface Location

UL or Ord No L	Section 2	Township 27N	Range 7W	Lot Idn	Feet from the 1668'	North/South line South	Feet from the 800'	East/West line West	County Rio Arriba
-------------------	--------------	-----------------	-------------	---------	------------------------	---------------------------	-----------------------	------------------------	----------------------

11 Bottom Hole Location If Different From Surface

UL or Ord No	Section	Township	Range	Lot Idn	Feet from the	North/South line	Feet from the	East/West line	County
--------------	---------	----------	-------	---------	---------------	------------------	---------------	----------------	--------

12 Dedicated Acres 328.318.96	13 Joint or Infill	14 Consolidation Code	15 Order No. R-10987-A
----------------------------------	--------------------	-----------------------	---------------------------

NO ALLOWABLE WILL BE ASSIGNED TO THIS COMPLETION UNTIL ALL INTERESTS HAVE BEEN CONSOLIDATED
OR A NON-STANDARD UNIT HAS BEEN APPROVED BY THE DIVISION

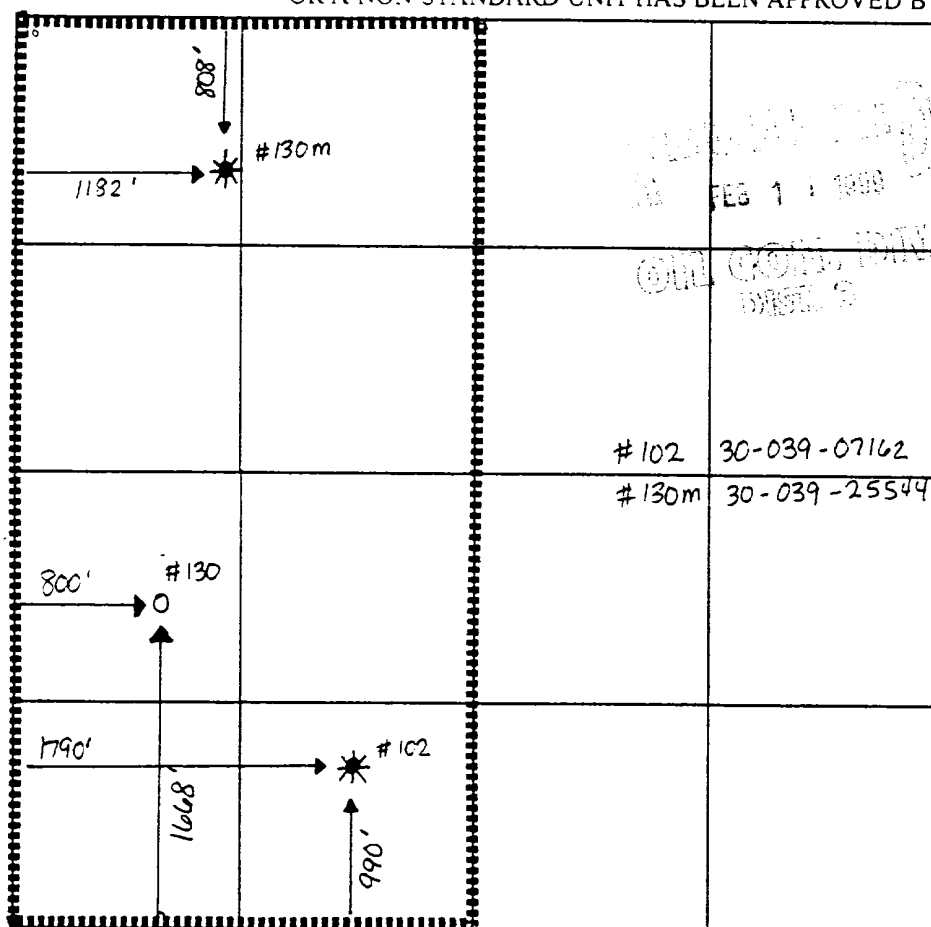

17 OPERATOR CERTIFICATION

I hereby certify that the information contained herein is true and complete to the best of my knowledge and belief.

Signature

Kay Maddox

Printed Name

Regulatory Agent

Title

February 4, 1999

Date

18 SURVEYOR CERTIFICATION

I hereby certify that the well location shown on this plat was plotted from field notes of actual surveys made by me or under my supervision, and that the same is true and correct to the best of my belief.

Date of Survey

Signature and Seal of Professional Surveyor:

Certificate Number

OK @