

UNITED STATES  
DEPARTMENT OF THE INTERIOR  
GEOLOGICAL SURVEY

30-039-20457  
5. LEASE DESIGNATION AND SERIAL NO.  
SF 079392

APPLICATION FOR PERMIT TO DRILL, DEEPEN, OR PLUG BACK

1a. TYPE OF WORK  
DRILL ☒ DEEPEN ☐ PLUG BACK ☐

b. TYPE OF WELL  
OIL WELL ☐ GAS WELL ☒ OTHER ☐  
SINGLE ZONE ☒ MULTIPLE ZONE ☐

2. NAME OF OPERATOR  
El Paso Natural Gas Company

3. ADDRESS OF OPERATOR  
PO Box 990, Farmington, NM 87401

4. LOCATION OF WELL (Report location clearly and in accordance with any State requirements.)  
At surface 790'N, 1190'E

At proposed prod. zone

14. DISTANCE IN MILES AND DIRECTION FROM NEAREST TOWN OR POST OFFICE\*

6. IF INDIAN, ALLOTTEE OR TRIBAL NAME

7. UNIT AGREEMENT NAME

San Juan 27-5 Unit

8. FARM OR LEASE NAME

San Juan 27-5 Unit

9. WELL NO.

140

10. FIELD AND POOL, OR WILDCAT

Basin Dakota

11. SEC., T., R., M., OR BLK.  
AND SURVEY OR AREA

Sec. 29, T-27-N, R-5-W  
NMPM

12. COUNTY OR PARISH

13. STATE

Rio Arriba New Mexico

15. DISTANCE FROM PROPOSED\*  
LOCATION TO NEAREST  
PROPERTY OR LEASE LINE, FT.  
(Also to nearest drlg. unit line, if any)

16. NO. OF ACRES IN LEASE

17. NO. OF ACRES ASSIGNED  
TO THIS WELL

18. DISTANCE FROM PROPOSED LOCATION\*  
TO NEAREST WELL, DRILLING, COMPLETED,  
OR APPLIED FOR, ON THIS LEASE, FT.

19. PROPOSED DEPTH

20. ROTARY OR CABLE TOOLS

21. ELEVATIONS (Show whether DF, RT, GR, etc.)

6458'GL

22. APPROX. DATE WORK WILL START\*

23. PROPOSED CASING AND CEMENTING PROGRAM

SIZE OF HOLE	SIZE OF CASING	WEIGHT PER FOOT	SETTING DEPTH	QUANTITY OF CEMENT
13 3/4"	9 5/8"	32.3#	200'	225 cu. ft. to circulate
8 3/4"	7"	20.0#	3500'	220 cu. ft. to cover Ojo Alamo
6 1/4"	4 1/2"	10.5 & 11.6#	7660'	640 cu. ft. to fill to 3500'

Selectively perforate and sandwater fracture the Dakota formation.

The E/2 of Section 29 is dedicated to this well.



IN ABOVE SPACE DESCRIBE PROPOSED PROGRAM: If proposal is to deepen or plug back, give data on present productive zone and proposed new productive zone. If proposal is to drill or deepen directionally, give pertinent data on subsurface locations and measured and true vertical depths. Give blowout preventer program, if any.

SIGNED Original signed by  
Carl E. Ashthrews TITLE Petroleum Engineer DATE December 15, 1971

(This space for Federal or State office use)

PERMIT NO. APPROVAL DATE

APPROVED BY 26 TITLE DATE

CONDITIONS OF APPROVAL, IF ANY:

\*See Instructions On Reverse Side

NEW MICO OIL CONSERVATION COMMISSION  
WELL LOCATION AND ACREAGE DEDICATION PLAT

Form C-102  
Supersedes C-128  
Effective 1-1-65

All distances must be from the outer boundaries of the Section.

Operator <b>EL PASO NATURAL GAS COMPANY</b>		Lease <b>SAN JUAN 27-5 UNIT (SF-079392)</b>		Well No. <b>140</b>
Unit Letter <b>A</b>	Section <b>29</b>	Township <b>27-N</b>	Range <b>5-W</b>	County <b>RIO ARriba</b>
Actual Portage Location of Well: <b>790</b> feet from the <b>NORTH</b> line and <b>1190</b> feet from the <b>EAST</b> line.				
Ground Level Elev. <b>6158</b>	Producing Formation <b>DAKOTA</b>	Pool <b>BASIN DAKOTA</b>	Delivered to Acceptor <b>295.88</b> Acres	

1. Outline the acreage dedicated to the subject well by colored pencil or hachure marks on the plat below.
2. If more than one lease is dedicated to the well, outline each and identify the ownership thereof (both as to working interest and royalty).
3. If more than one lease of different ownership is dedicated to the well, have the interests of all owners been consolidated by communitization, unitization, force-pooling, etc?

☒ Yes ☐ No If answer is "yes," type of consolidation Unitization

If answer is "no," list the owners and tract descriptions which have actually been consolidated. (Use reverse side of this form if necessary.)

No allowable will be assigned to the well until all interests have been consolidated (by communitization, unitization, forced-pooling, or otherwise) or until a non-standard unit, eliminating such interests, has been approved by the Commission.

**NOTE: THIS PLAT IS REISSUED TO SHOW CORRECTED ACREAGE DEDICATION 12-30-71**

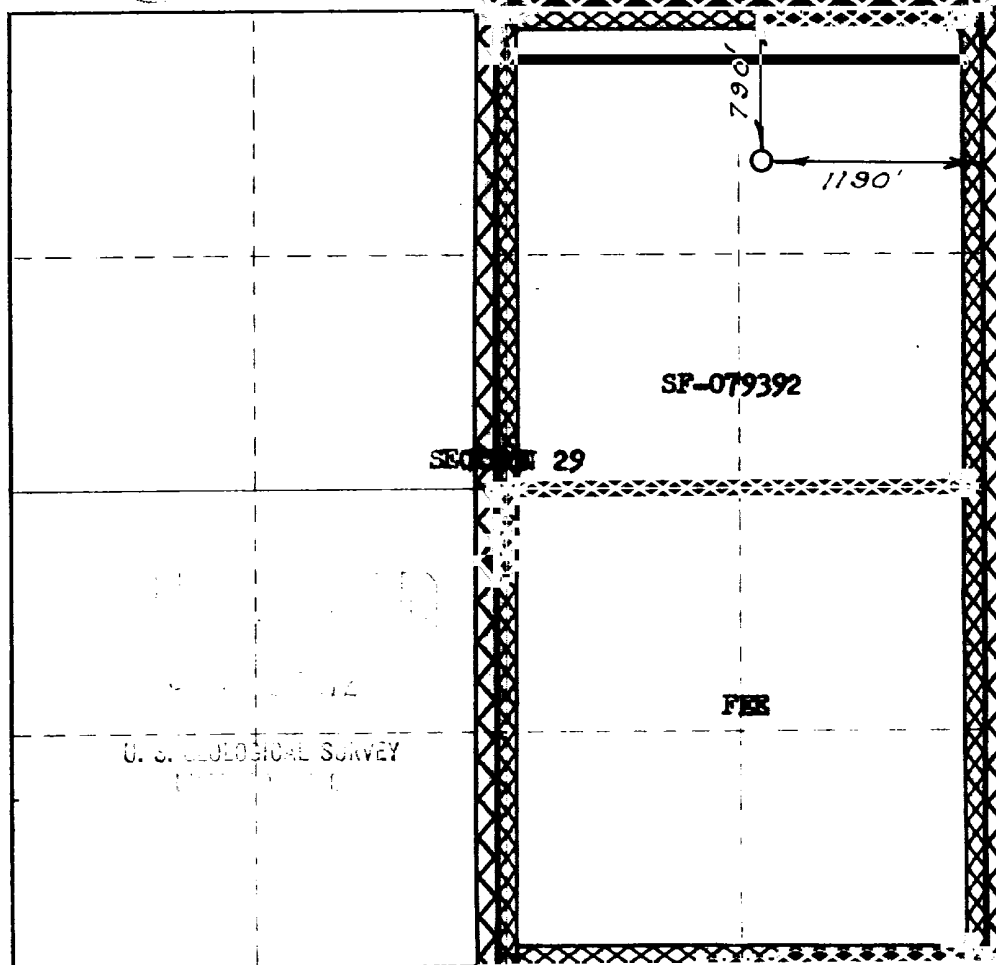

**RECEIVED**  
JAN 4 1972  
I hereby certify that the information contained here is true and correct to the best of my knowledge and belief.  
Original Signed W. D. Dawson

Name  
**Petroleum Engineer**  
Position  
**El Paso Natural Gas Co.**  
Date  
**December 30, 1971**

I hereby certify that the well location shown on this plat was plotted from field notes of actual surveys made by me or under my supervision, and that the same is true and correct to the best of my knowledge and belief.

DECEMBER 31, 1958

*David Wilson*  
1760

*AK*

STATE OF NEW MEXICO  
OIL CONSERVATION COMMISSION  
1000 Rio Brazos Road  
Aztec, New Mexico 87410

April 13, 1972

El Paso Natural Gas Company  
PO Box 1492  
El Paso, Texas 79999

Attention: Mr. Charles Higgins

SUBJECT: NON - STANDARD GAS PROPORTION UNIT CONSISTING OF 295.88 ACRES  
IN THE Basin Dakota GAS POOL DESCRIBED AS

FOLLOWS:

TOWNSHIP 27 NORTH, RANGE 5 WEST, NMPM  
SECTION: 29

By authority granted me by Rule 5 (B) of Order No. R-1670, as amended,  
the above- described acreage has been approved as a non-standard gas  
proportion unit to be dedicated to the San Juan 27-5 Unit  
Well No. 140, located 790/N; 1190/E of said  
SECTION 29.

  
\_\_\_\_\_  
District Supervisor  
District #3

cc: Oil Conservation Commission  
Santa Fe, New Mexico