

NO. OF COPIES RECEIVED	6
DISTRIBUTION	
SANTA FE	1
FILE	1
U.S.G.S.	2
LAND OFFICE	1
OPERATOR	1

# NEW MEXICO OIL CONSERVATION COMMISSION

Form C-101  
Revised 1-1-65 30-039-20477

APPLICATION FOR PERMIT TO DRILL, DEEPEN, OR PLUG BACK			
1a. Type of Work		7. Unit Agreement Name	
b. Type of Well DRILL <input checked="" type="checkbox"/> DEEPEN <input type="checkbox"/> PLUG BACK <input type="checkbox"/> OIL WELL <input type="checkbox"/> GAS WELL <input checked="" type="checkbox"/> OTHER <input type="checkbox"/> SINGLE ZONE <input checked="" type="checkbox"/> MULTIPLE ZONE <input type="checkbox"/>		San Juan 28-6 Unit	
2. Name of Operator		8. Farm or Lease Name	
El Paso Natural Gas Company		San Juan 28-6 Unit	
3. Address of Operator		9. Well No.	
PO Box 990, Farmington, NM 87401		169	
4. Location of Well UNIT LETTER M LOCATED 1180 FEET FROM THE South LINE AND 1150 FEET FROM THE West LINE OF SEC. 2 TWP. 27N RGE. 6W NMPM		10. Field and Pool, or Wildcat	
		Basin Dakota	
		12. County	
		Rio Arriba	
		19. Proposed Depth	
		7920'	
		19A. Formation	
		Dakota	
		20. Rotary or C.T.	
		Rotary	
21. Elevations (Show whether DF, RT, etc.)		21A. Kind & Status Plug. Bond	
6485'GL		statewide	
		21B. Drilling Contractor	
		22. Approx. Date Work will start	

23.

## PROPOSED CASING AND CEMENT PROGRAM

SIZE OF HOLE	SIZE OF CASING	WEIGHT PER FOOT	SETTING DEPTH	SACKS OF CEMENT	EST. TOP
13 3/4"	9 5/8"	32.3#	200'	225 cu. ft.	to circulate
8 3/4"	7"	20.0#	3500'	210 cu. ft.	cover Ojo Alamo
6 1/4"	4 1/2"	10.5#&11.6#	7670'	645 cu. ft.	fill to 3500'

Selectively perforate and sandwater fracture the Dakota formation.

The S/2 of Section 2 is dedicated to this well.

APPROVAL VALID  
FOR 90 DAYS UNLESS  
DRILLING COMMENCED,

EXPIRES 6-20-72

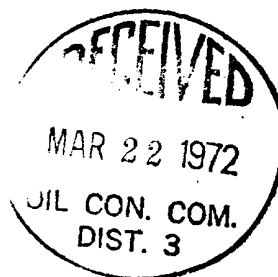

IN ABOVE SPACE DESCRIBE PROPOSED PROGRAM: IF PROPOSAL IS TO DEEPEN OR PLUG BACK, GIVE DATA ON PRESENT PRODUCTIVE ZONE AND PROPOSED NEW PRODUCTIVE ZONE. GIVE BLOWOUT PREVENTER PROGRAM, IF ANY.

I hereby certify that the information above is true and complete to the best of my knowledge and belief.

Signed Original Signed F. H. WOOD Title Petroleum Engineer Date March 21, 1972

(This space for State Use)

APPROVED BY Mary C. Ames TITLE SUPERVISOR DIST. #3 DATE MAR 22 1972

CONDITIONS OF APPROVAL, IF ANY:

NEW MEXICO OIL CONSERVATION COMMISSION  
WELL LOCATION AND ACREAGE DEDICATION PLAT

Supplies for Wells  
Producing Oil

EL PASO NATURAL GAS COMPANY

SAN JUAN 28-6 UNIT

(E-290-28)

169

1

2

27-N

6-W

RIO ARRIBA

1180

SOUTH

1150

WEST

6485

DAKOTA

BASIN DAKOTA

320.00

1. Outline the acreage dedicated to the subject well by colored pencil or machine marks on the plat.
2. If more than one lease is dedicated to the well, outline each and identify the ownership thereof and its working interest and royalty.
3. If more than one lease of different ownership is dedicated to the well, have the interests of all owners been consolidated by communitization, unitization, forced pooling, etc?

**X** Yes ☐ No ☐ If answer is "Yes" type of consolidation

**Unitization**

If answer is "No" list the owners and tract descriptions which have actually been consolidated. (Use reverse side of this form if necessary.)

No allowable will be assigned to the well until all interests have been consolidated by communitization, unitization, forced pooling, or otherwise so that a non-standard unit, eliminating such interests, has been approved by the Commission.

CERTIFICATION

I hereby certify that the information contained hereon is true and complete to the best of my knowledge and belief.

Original Signed F. H. WOOD

**Petroleum Engineer**

**El Paso Natural Gas Co.**

**March 21, 1972**

I hereby certify that the information contained hereon is true and complete to the best of my knowledge and belief.

**MARCH 8, 1972**

*David W. Kuen*  
1760

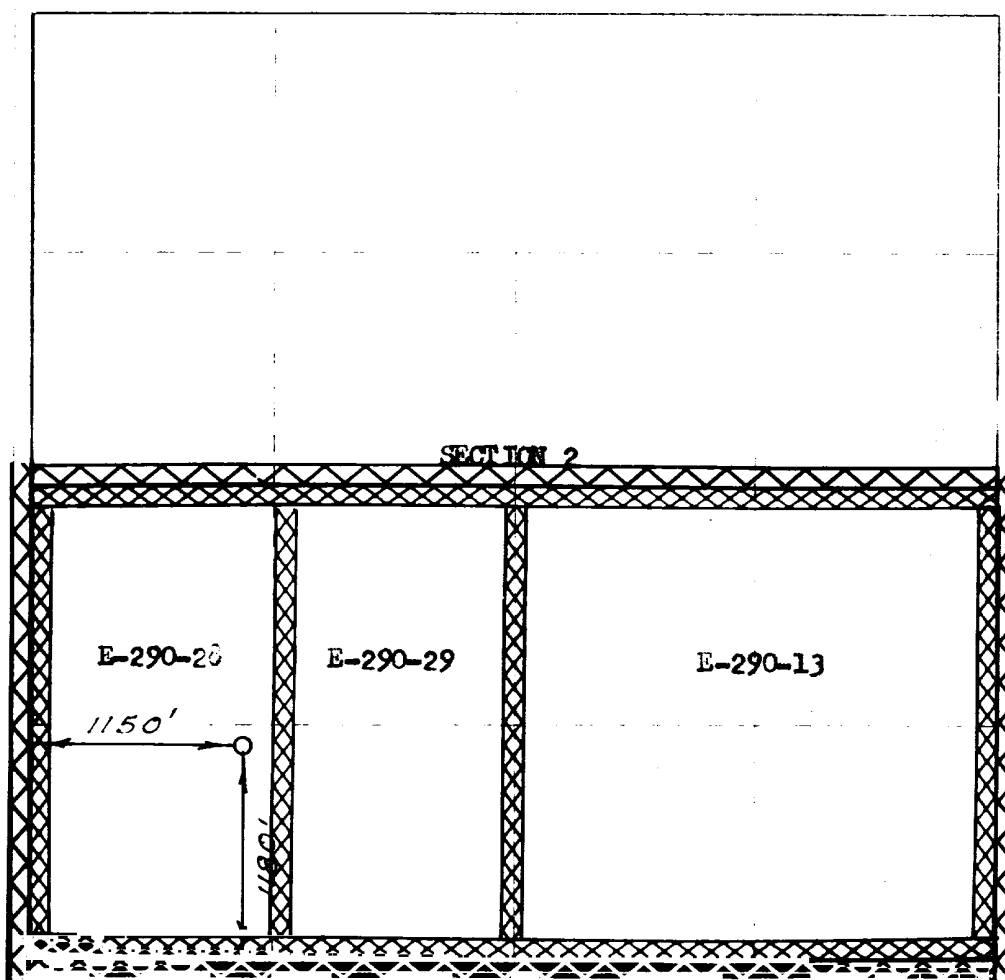

NO. OF COPIES RECEIVED	3
DISTRIBUTION	
SANTA FE	1
FILE	1
U.S.G.S.	
LAND OFFICE	
OPERATOR	1

# NEW MEXICO OIL CONSERVATION COMMISSION

Form C-103  
Supersedes Old  
C-102 and C-103  
Effective 1-1-65

5a. Indicate Type of Lease	
State <input checked="" type="checkbox"/>	Fee <input type="checkbox"/>
5. State Oil & Gas Lease No.	
E-290-28	
7. Unit Agreement Name	
San Juan 28-6 Unit	
8. Farm or Lease Name	
San Juan 28-6 Unit	
9. Well No.	
169	
10. Field and Pool, or Wildcat	
Basin Dakota	
12. County	
Rio Arriba	

**SUNDY NOTICES AND REPORTS ON WELLS**  
(DO NOT USE THIS FORM FOR PROPOSALS TO DRILL OR TO DEEPEN OR PLUG BACK TO A DIFFERENT RESERVOIR. USE "APPLICATION FOR PERMIT -" (FORM C-101) FOR SUCH PROPOSALS.)

1. OIL WELL <input type="checkbox"/> GAS WELL <input checked="" type="checkbox"/> OTHER-	7. Unit Agreement Name
2. Name of Operator	San Juan 28-6 Unit
El Paso Natural Gas Company	8. Farm or Lease Name
3. Address of Operator	San Juan 28-6 Unit
PO Box 990, Farmington, NM 87401	9. Well No.
4. Location of Well	169
UNIT LETTER <u>M</u> , <u>1180</u> FEET FROM THE <u>South</u> LINE AND <u>1150</u> FEET FROM	10. Field and Pool, or Wildcat
THE <u>West</u> LINE, SECTION <u>2</u> TOWNSHIP <u>27N</u> RANGE <u>6W</u> NMPM.	Basin Dakota
15. Elevation (Show whether DF, RT, GR, etc.)	12. County
6485'GL	Rio Arriba

16. Check Appropriate Box To Indicate Nature of Notice, Report or Other Data

NOTICE OF INTENTION TO:		SUBSEQUENT REPORT OF:	
PERFORM REMEDIAL WORK <input type="checkbox"/>	PLUG AND ABANDON <input type="checkbox"/>	REMEDIAL WORK <input type="checkbox"/>	ALTERING CASING <input type="checkbox"/>
TEMPORARILY ABANDON <input type="checkbox"/>	CHANGE PLANS <input type="checkbox"/>	COMMENCE DRILLING OPNS. <input checked="" type="checkbox"/>	PLUG AND ABANDONMENT <input type="checkbox"/>
PULL OR ALTER CASING <input type="checkbox"/>	OTHER <input type="checkbox"/>	CASING TEST AND CEMENT JOBS <input checked="" type="checkbox"/>	OTHER <input type="checkbox"/>

17. Describe Proposed or Completed Operations (Clearly state all pertinent details, and give pertinent dates, including estimated date of starting any proposed work) SEE RULE 1103.

5-2-72

Spud well. Drilled surface hole. Ran 6 joints 9 5/8", 32.3#, HS surface casing; 189' set at 202. Cemented with 225 cu.ft. cement. Circulated to surface. WOC 12 hours, held 600#/30 minutes.



18. I hereby certify that the information above is true and complete to the best of my knowledge and belief.

SIGNED <u>EH Arnold</u>	TITLE <u>Petroleum Engineer</u>	DATE <u>May 3, 1972</u>
Original Signed by <u>Emery C. Arnold</u>	TITLE <u>SUPERVISOR DIST. #3</u>	DATE <u>MAY 5 1972</u>
APPROVED BY _____	TITLE _____	DATE _____
CONDITIONS OF APPROVAL, IF ANY:		