

Denny A. Frost
DEPUTY OIL & GAS INSPECTOR

DEC 29 1997

Approved

Meter Number: 87454

Location Name: San Juan 28 - 7 Unit 165

Location: TN-27 RG-07

SC-16 UL-A

1- State

NMOCD Zone: OUTSIDE

Hazard Ranking Score: 00

RECEIVED
APR 14 1997

OIL CON. DIV.
DIST. 3

**RATIONALE FOR RISK-BASED CLOSURE OF PRODUCTION PITS
LOCATED OUTSIDE OF THE VULNERABLE ZONE
IN THE SAN JUAN BASIN**

This production pit location was ranked according to the criteria in the New Mexico Oil Conservation Division's Unlined Surface Impoundment Closure Guidelines and received a ranking score of zero. The estimated depth to groundwater is greater than 100-feet beneath ground surface (bgs), the pit is not in a well head protection area, and there are no surface water bodies within 1,000 horizontal feet of the pit location.

The primary source, discharge to the pit has been removed. There has been no discharge to the pits for at least 4 years and the pits have been closed for at least one year.

Each pit was backfilled with clean soil and graded in a manner to divert precipitation away from the excavated area. Minimal infiltration of rainfall is expected. Any rainfall that does infiltrate the ground surface must migrate through clean backfill before reaching the residual hydrocarbons.

There is no source material at the ground surface, so direct contact of hydrocarbons with livestock and the populous is not likely.

In general, outside of the vulnerable area and alluvial valleys, bedrock material is generally encountered within 20 feet of the ground surface. Bedrock material in the San Juan Basin consists of interbedded sandstones, shales and clays. According to Freeze and Cherry, 1979, the hydraulic conductivity of the bedrock material are as follows:

Sandstone	10^{-9} to 10^{-13} cm/sec
Shale	10^{-12} to 10^{-16} cm/sec
Clay	10^{-12} to 10^{-15} cm/sec

Based on this information, the residual hydrocarbons should not migrate to groundwater.

Natural process (bioremediation) are degrading the residual hydrocarbon to carbon dioxide and water and will continue until the source is gone, therefore minimizing any impact to the environment.

Based on the above information, it is highly unlikely that any source material will impact groundwater or ever find an exposure pathway to affect human health and therefore El Paso Field Services Company (EPFS) requests closure of this pit location.

FIELD PIT SITE ASSESSMENT FORM

GENERAL	<p>Meter: <u>87454</u> Location: <u>San Juan 28-7 Unit 165</u></p> <p>Operator #: <u>0203</u> Operator Name: <u>Amoco</u> P/L District: <u>Blanco</u></p> <p>Coordinates: Letter: <u>A</u> Section <u>16</u> Township: <u>27</u> Range: <u>7</u></p> <p>Or Latitude _____ Longitude _____</p> <p>Pit Type: Dehydrator <input checked="" type="checkbox"/> Location Drip: _____ Line Drip: _____ Other: _____</p> <p>Site Assessment Date: <u>5/3/95</u> Area: <u>03</u> Run: <u>52</u></p>
SITE ASSESSMENT	<p>NMOCD Zone: (From NMOCD Maps)</p> <p style="margin-left: 150px;">Inside <input type="checkbox"/> (1)</p> <p style="margin-left: 150px;">Outside <input checked="" type="checkbox"/> (2)</p> <p>Land Type:</p> <p style="margin-left: 150px;">BLM <input type="checkbox"/> (1)</p> <p style="margin-left: 150px;">State <input checked="" type="checkbox"/> (2)</p> <p style="margin-left: 150px;">Fee <input type="checkbox"/> (3)</p> <p style="margin-left: 150px;">Indian _____</p> <p>Depth to Groundwater</p> <p>Less Than 50 Feet (20 points) <input type="checkbox"/> (1)</p> <p>50 Ft to 99 Ft (10 points) <input type="checkbox"/> (2)</p> <p>Greater Than 100 Ft (0 points) <input checked="" type="checkbox"/> (3)</p> <p>Wellhead Protection Area :</p> <p>Is it less than 1000 ft from wells, springs, or other sources of fresh water extraction? , or ; Is it less than 200 ft from a private domestic water source? <input type="checkbox"/> (1) YES (20 points) <input checked="" type="checkbox"/> (2) NO (0 points)</p> <p>Horizontal Distance to Surface Water Body</p> <p>Less Than 200 Ft (20 points) <input type="checkbox"/> (1)</p> <p>200 Ft to 1000 Ft (10 points) <input type="checkbox"/> (2)</p> <p>Greater Than 1000 Ft (0 points) <input checked="" type="checkbox"/> (3)</p> <p>Name of Surface Water Body _____</p> <p>(Surface Water Body : Perennial Rivers, Major Wash, Streams, Creeks, Irrigation Canals, Ditches, Lakes, Ponds)</p> <p>Distance to Nearest Ephemeral Stream <input type="checkbox"/> (1) < 100' (Navajo Pits Only)</p> <p style="margin-left: 150px;"><input type="checkbox"/> (2) > 100'</p> <p>TOTAL HAZARD RANKING SCORE: <u>0</u> POINTS</p>
REMARKS	<p>Remarks : <u>Redline Book: Outside</u> <u>Vulnerable Zone Top: Outside</u></p> <p><u>2 pits. Close. Product in pit</u></p> <p style="text-align: right;"><u>PUSH-IN</u></p>

ORIGINAL PIT LOCATION

ORIGINAL PIT LOCATION

Original Pit : a) Degrees from North 92° Footage from Wellhead 48'
b) Length : 31' Width : 30' Depth : 5'

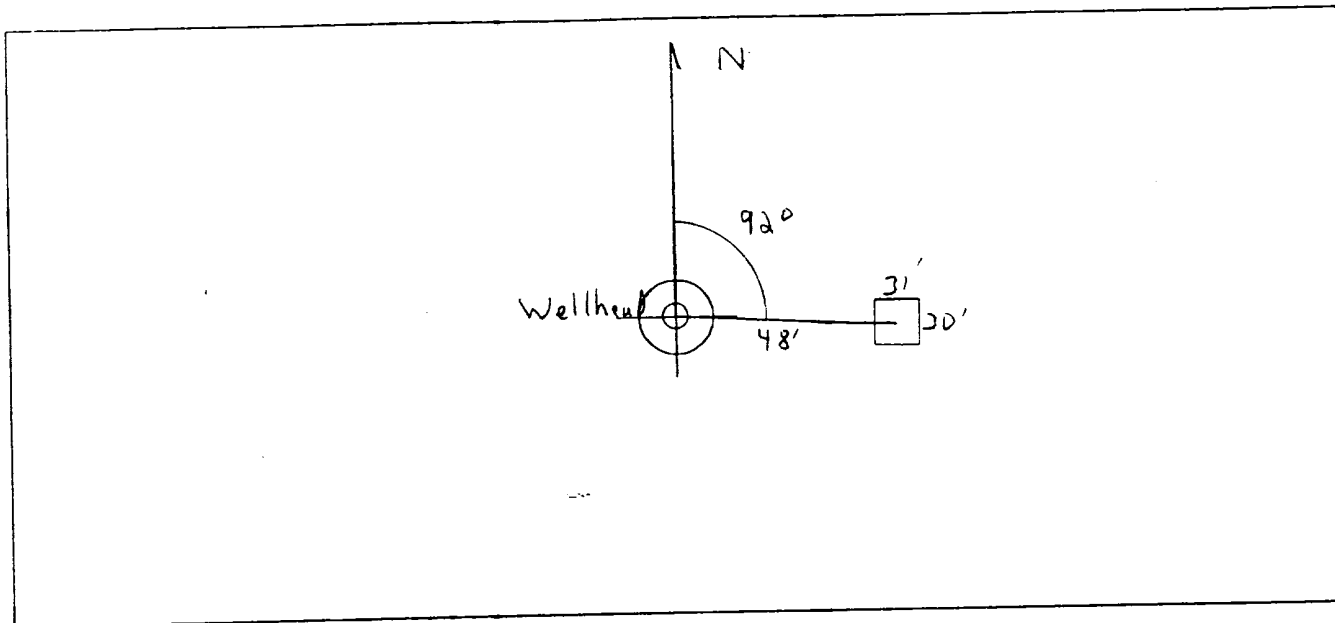

REMARKS

Remarks :

Pictures @ "5:15" hr 21-22

Completed By:

Cory Chase
Signature

5/3/95
Date

FIELD PIT REMEDIATION/CLOSURE FORM

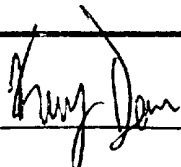
GENERAL	Meter: <u>87454</u> Location: <u>San Juan 28-7 Unit #165</u> Coordinates: Letter: <u>A</u> Section <u>16</u> Township: <u>27</u> Range: <u>7</u> Or Latitude _____ Longitude _____ Date Started : <u>6/5/95</u> Run: <u>03</u> <u>52</u>
FIELD OBSERVATIONS	Sample Number(s): <u>KD 453</u> Sample Depth: <u>7'</u> Feet Final PID Reading <u>295 ppm</u> PID Reading Depth <u>7'</u> Feet <div style="text-align: center;">Yes No</div> Groundwater Encountered <input type="checkbox"/> <input checked="" type="checkbox"/> Approximate Depth _____ Feet
CLOSURE	Remediation Method : <div style="display: flex; justify-content: space-between;"> <div> Excavation Onsite Bioremediation Backfill Pit Without Excavation </div> <div style="text-align: right;"> <input type="checkbox"/> Approx. Cubic Yards <u>0</u> <input type="checkbox"/> <input checked="" type="checkbox"/> </div> </div> Soil Disposition: <div style="display: flex; justify-content: space-between;"> <div> Envirotech <input type="checkbox"/> Other Facility <input type="checkbox"/> </div> <div style="text-align: right;"> <input type="checkbox"/> Tierra Name: _____ </div> </div> Pit Closure Date: <u>6/5/95</u> Pit Closed By: <u>PEI</u>
REMARKS	Remarks : <u>Pit had approximately 1' of oil + water in it. Dug Test Hole to 7' it hit sandstone, took pid sample, closed pit.</u>
	Signature of Specialist: <u></u>



FIELD SERVICES LABORATORY
ANALYTICAL REPORT

PIT CLOSURE PROJECT - Soil Samples Outside the GWV Zone

SAMPLE IDENTIFICATION

	Field ID	Lab ID
SAMPLE NUMBER:	KD 453	946873
MTR CODE SITE NAME:	87454	N/A
SAMPLE DATE TIME (Hrs):	6-5-95	1315
SAMPLED BY:	N/A	
DATE OF TPH EXT. ANAL.:		
DATE OF BTEX EXT. ANAL.:		
TYPE DESCRIPTION:	UG	grey sand + clay

REMARKS:

RESULTS

PARAMETER	RESULT	UNITS	QUALIFIERS			
			DF	Q	M(g)	V(ml)
TPH (418.1)	14700	MG/KG			0.46	28
HEADSPACE PID	295	PPM				
PERCENT SOLIDS	83.7	%				

-- TPH is by EPA Method 418.1 --

Narrative:

DF = Dilution Factor Used

Approved By:

Date:

6/28/95

Test Method for
Oil and Grease and Petroleum Hydrocarbons
in Water and Soil

Perkin-Elmer Model 1600 FT-IR
Analysis Report

ILLEGIBLE

75/06/07 14:51

Sample identification
246873

Initial mass of sample, g
0.460

Volume of sample after extraction, ml
25.000

Petroleum hydrocarbons, ppm
16672.736

Net absorbance of hydrocarbons (2930 cm⁻¹)
0.474

Y: Petroleum hydrocarbons spectrum

14:51

