

UNITED STATES  
DEPARTMENT OF THE INTERIOR  
GEOLOGICAL SURVEY

## APPLICATION FOR PERMIT TO DRILL, DEEPEN, OR PLUG BACK

1a. TYPE OF WORK DRILL <input checked="" type="checkbox"/> DEEPEN <input type="checkbox"/> PLUG BACK <input type="checkbox"/>			5. LEASE DESIGNATION AND SERIAL NO. SF 079393	
b. TYPE OF WELL OIL WELL <input type="checkbox"/> GAS WELL <input checked="" type="checkbox"/> OTHER <input type="checkbox"/>			6. IF INDIAN, ALLOTTEE OR TRIBE NAME	
2. NAME OF OPERATOR El Paso Natural Gas Company			7. UNIT AGREEMENT NAME San Juan 27-5 Unit	
3. ADDRESS OF OPERATOR P. O. Box 990, Farmington, New Mexico			8. FARM OR LEASE NAME San Juan 27-5 Unit	
4. LOCATION OF WELL (Report location clearly and in accordance with any State requirements.) At surface 1840' FSL, 1550' FEL At proposed prod. zone			9. WELL NO. 149	
14. DISTANCE IN MILES AND DIRECTION FROM NEAREST TOWN OR POST OFFICE*			10. FIELD AND POOL, OR WILDCAT Tapacito P. C. Ext. ✓	
15. DISTANCE FROM PROPOSED* LOCATION TO NEAREST PROPERTY OR LEASE LINE, FT. (Also to nearest griz. unit line, if any)			11. SEC., T., R., M., OR B.L.K. AND SURVEY OR AREA Sec. 6, T-27-N, R-5-W N.M.P.M.	
16. NO. OF ACRES IN LEASE			12. COUNTY OR PARISH Rio Arriba	
17. NO. OF ACRES ASSIGNED TO THIS WELL 160.00 / 160 ✓			13. STATE New Mexico	
18. DISTANCE FROM PROPOSED LOCATION* TO NEAREST WELL, DRILLING, COMPLETED, OR APPLIED FOR, ON THIS LEASE, FT.			20. ROTARY OR CABLE TOOLS Rotary	
19. PROPOSED DEPTH 3480'			22. APPROX. DATE WORK WILL START*	
21. ELEVATIONS (Show whether DF, RT, GR, etc.) 6558' CL				

PROPOSED CASING AND CEMENTING PROGRAM				
SIZE OF HOLE	SIZE OF CASING	WEIGHT PER FOOT	SETTING DEPTH	QUANTITY OF CEMENT
12 1/4"	8 5/8"	24#	120'	109 cu. ft. to circ. to surf.
6 3/4"	2 7/8"	6.4#	3480	245 cu. ft. to cover Ojo Alamo

Selectively perforate and sand-water fracture the Pictured Cliffs formation

The SE/4 of Section 6 is dedicated to this well.



IN ABOVE SPACE DESCRIBE PROPOSED PROGRAM: If proposal is to deepen or plug back, give data on present productive zone and proposed new productive zone. If proposal is to drill or deepen directionally, give pertinent data on subsurface locations and measured and true vertical depths. Give blowout preventer program, if any.

24. SIGNED [Signature] TITLE Petroleum Engineer DATE April 13, 1973  
(This space for Federal or State office use)

PERMIT NO. \_\_\_\_\_ APPROVAL DATE \_\_\_\_\_

APPROVED BY [Signature] TITLE \_\_\_\_\_ DATE \_\_\_\_\_  
CONDITIONS OF APPROVAL, IF ANY:

NEW MEXICO OIL CONSERVATION COMMISSION  
WELL LOCATION AND ACREAGE DEDICATION PLAT

Supersedees C-128  
Form type 1-6-67

All distances must be from the corner or corners of the section.

EL PASO NATURAL GAS COMPANY		SAN JUAN 27-5 UNIT		(SF-079393)	149
0	6	27-N	5-W	RIO ARriba	
1840	SOUTH		1550	EAST	
6558	PICTURED CLIFFS		TAPACITO PICTURED CLIFFS EXT.		160.00

- Outline the acreage dedicated to the subject well by colored pencil or hatchure marks on the plat below.
- If more than one lease is dedicated to the well, outline each and identify the ownership thereof (whether a working interest and royalty).
- If more than one lease of different ownership is dedicated to the well, have the interests of all owners been consolidated by communitization, unitization, force-pooling, etc?

☒ Yes ☐ No If answer is "yes" type of consolidation Unitization

If answer is "no" list the owners and tract descriptions which have actually been consolidated (Use reverse side of this form if necessary.)

No allowable will be assigned to the well until all interests have been consolidated by communitization, unitization, forced-pooling, or otherwise or until a non-standard unit, eliminating such interests, has been approved by the Commission.

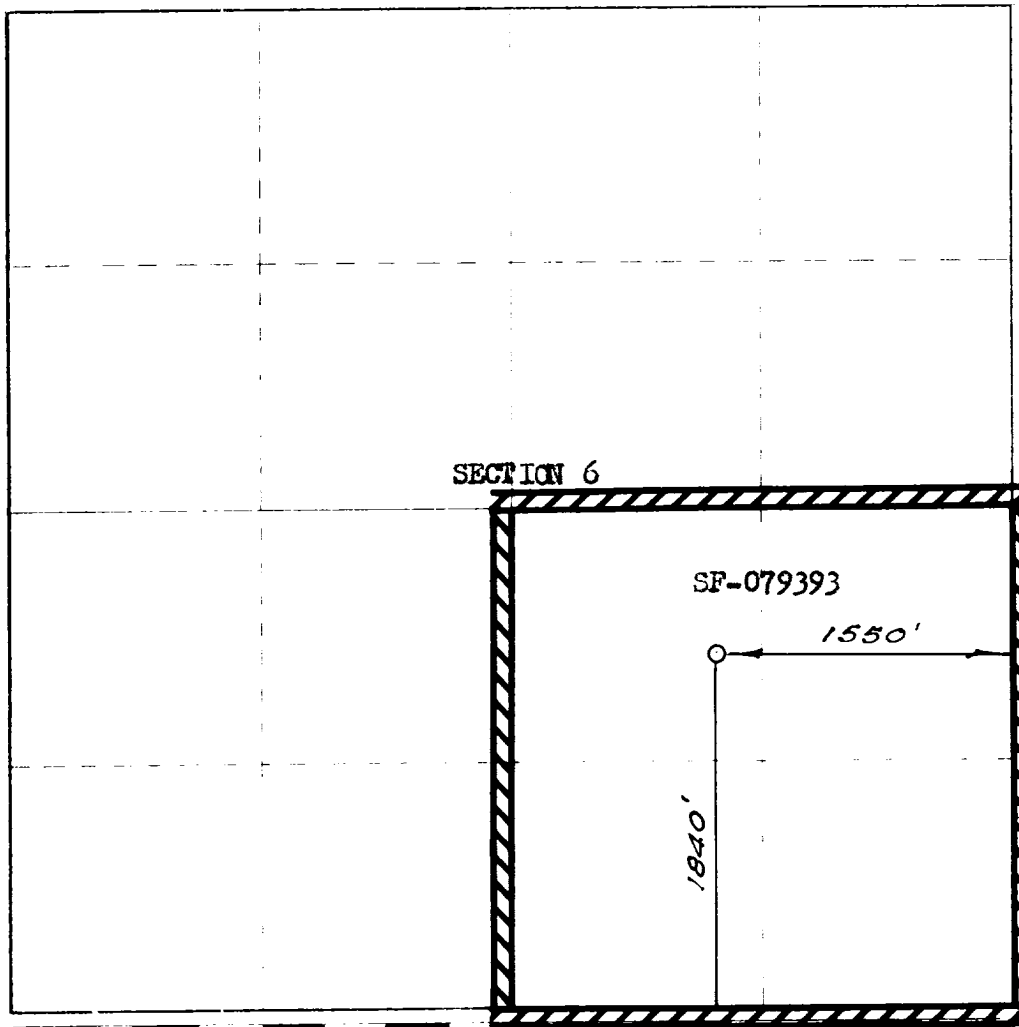

CERTIFICATION

I hereby certify that the information contained herein is true and complete to the best of my knowledge and belief.

Original Signed F. H. WOOD

Petroleum Engineer

El Paso Natural Gas

April 13, 1973

I hereby certify that the well location and acreage is as indicated on this plat and that the same is true to the best of my knowledge and belief.

FEBRUARY 14, 1973

*David Wilson*  
1760

UNITED STATES  
DEPARTMENT OF THE INTERIOR  
GEOLOGICAL SURVEY

SUBMIT IN TRIPLICATE\*  
(Other instructions on re-  
verse side)

Form approved.  
Budget Bureau No. 42-R1424.

5. LEASE DESIGNATION AND SERIAL NO.

SF 079393

6. IF INDIAN, ALLOTTEE OR TRIBE NAME

7. UNIT AGREEMENT NAME

San Juan 27-5 Unit

8. FARM OR LEASE NAME

San Juan 27-5 Unit

9. WELL NO.

149

10. FIELD AND POOL, OR WILDCAT

Tapacito Pictured Cliffs Ext.

11. SEC., T., R., M., OR BLK. AND  
SURVEY OR AREA

Sec. 6, T-27-N, R-5-W

NMPM

12. COUNTY OR PARISH 13. STATE

Rio Arriba

New Mexico

1. OIL WELL ☐ GAS WELL ☒ OTHER

2. NAME OF OPERATOR

El Paso Natural Gas Company

3. ADDRESS OF OPERATOR

PO Box 990, Farmington, NM 87401

4. LOCATION OF WELL (Report location clearly and in accordance with any State requirements.\*  
See also space 17 below.)

At surface 1840'S, 1550'E

14. PERMIT NO.

15. ELEVATIONS (Show whether DF, RT, GR, etc.)

6558'GL

16. Check Appropriate Box To Indicate Nature of Notice, Report, or Other Data

NOTICE OF INTENTION TO:

TEST WATER SHUT-OFF

FRACTURE TREATMENT

SHOOT OR ACIDIZE

REPAIR WELL

(Other)

PULL OR ALTER CASING

MULTIPLE COMPLETE

ABANDON\*

CHANGE PLANS

WATER SHUT-OFF

FRACTURE TREATMENT

SHOOTING OR ACIDIZING

(Other)

(NOTE: Report results of multiple completion on Well  
Completion or Recompletion Report and Log form.)

SUBSEQUENT REPORT OF:

REPAIRING WELL

ALTERING CASING

ABANDONMENT\*

17. DESCRIBE PROPOSED OR COMPLETED OPERATIONS (Clearly state all pertinent details, and give pertinent dates, including estimated date of starting any proposed work. If well is directionally drilled, give subsurface locations and measured and true vertical depths for all markers and zones pertinent to this work.)\*

5-1-73 Spudded well. Drilled surface hole.

5-2-73 Ran 4 joints 8 5/8", 24#, K-55 surface casing, 124' set at 124'. Cemented with 106 cu. ft. cement, circulated to surface. WOC 12 hours.



18. I hereby certify that the foregoing is true and correct

SIGNED

*[Signature]*

TITLE Petroleum Engineer

DATE May 3, 1973

(This space for Federal or State office use)

APPROVED BY

TITLE

DATE

CONDITIONS OF APPROVAL, IF ANY:

LOCATION AND EQUIPMENT LAY-OUT

San Juan 27-5 Unit # 149

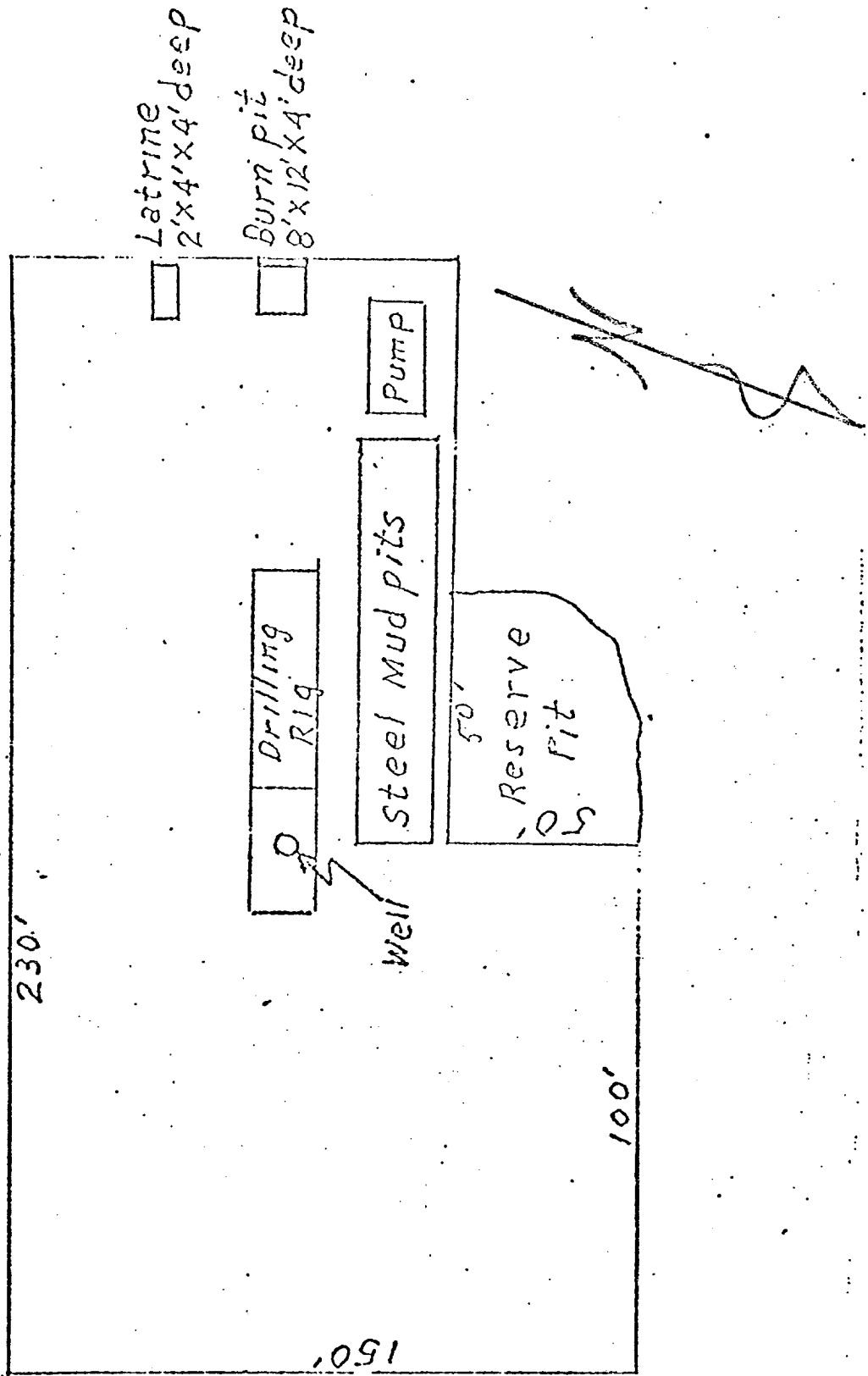

EXISTING AND PROPOSED ROADS AND PIPELINE RIGHTS-OF-WAY

San Juan 27-5 Unit # 149

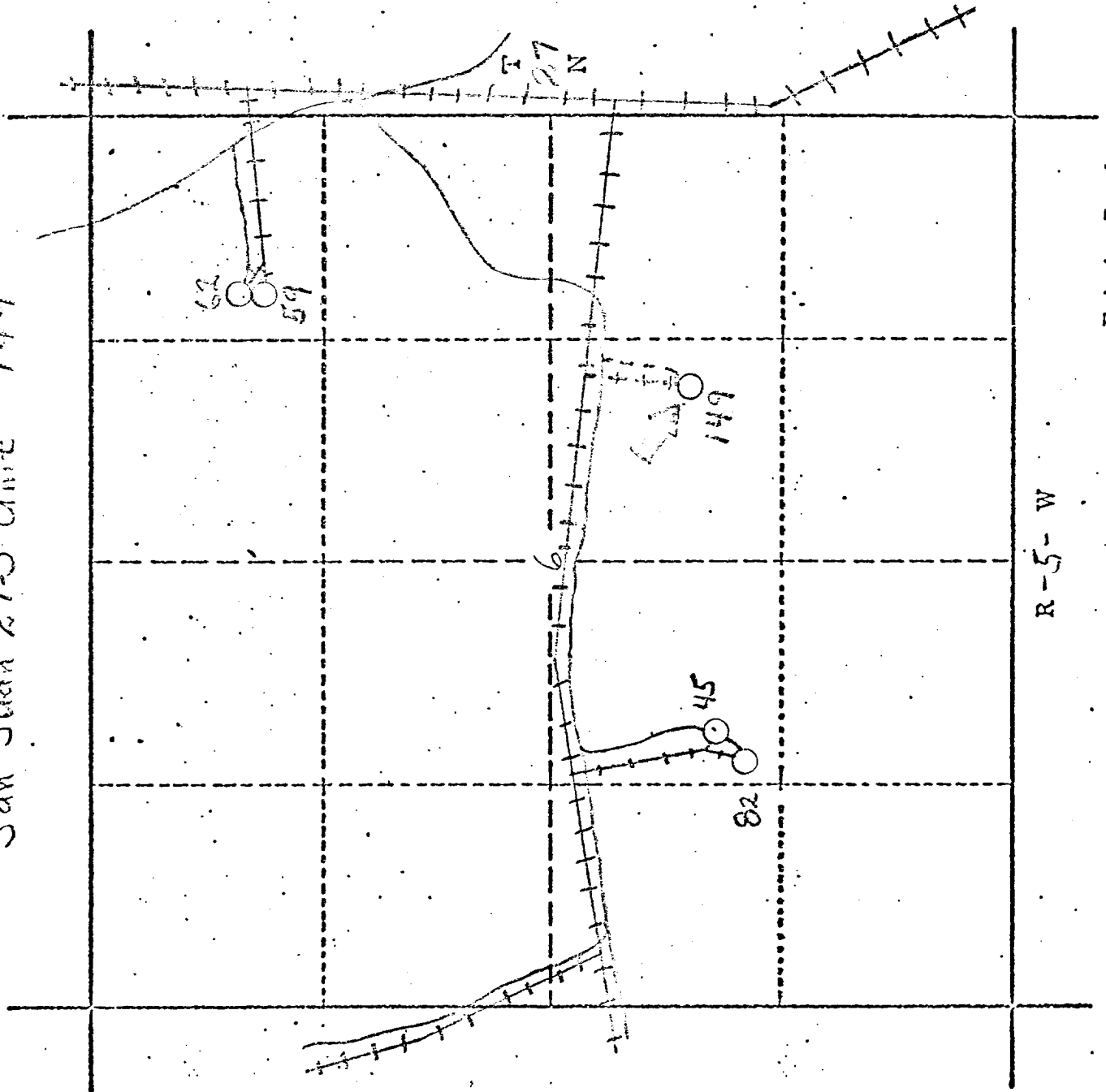

Existing Road  
Proposed Road  
Existing Right-of-Way