

30-039-20620

UNITED STATES
DEPARTMENT OF THE INTERIOR
GEOLOGICAL SURVEY

APPLICATION FOR PERMIT TO DRILL, DEEPEN, OR PLUG BACK

1. TYPE OF WORK DRILL <input checked="" type="checkbox"/> DEEPEN <input type="checkbox"/> PLUG BACK <input type="checkbox"/>			5. LEASE DESIGNATION AND SERIAL NO. SF 079391		
b. TYPE OF WELL OIL WELL <input type="checkbox"/> GAS WELL <input checked="" type="checkbox"/> OTHER <input type="checkbox"/>			6. IF INDIAN, ALLOTTEE OR TRIBE NAME		
SINGLM ZONE <input checked="" type="checkbox"/> MULTIPLE ZONE <input type="checkbox"/>			7. UNIT AGREEMENT NAME San Juan 27-5 Unit		
2. NAME OF OPERATOR El Paso Natural Gas Company			8. FARM OR LEASE NAME San Juan 27-5 Unit		
3. ADDRESS OF OPERATOR PO Box 990, Farmington, New Mexico 87401			9. WELL NO. 150		
4. LOCATION OF WELL (Report location clearly and in accordance with any State requirements.)* At surface 1725'N, 1170'W At proposed prod. zone			10. FIELD AND POOL, OR WILDCAT Tapacito Pictured Cliffs		
14. DISTANCE IN MILES AND DIRECTION FROM NEAREST TOWN OR POST OFFICE*			11. SEC., T., R., M., OR BLK. AND SURVEY OR AREA Sec. 8, T-27-N, R-5-W NMPM		
15. DISTANCE FROM PROPOSED* LOCATION TO NEAREST PROPERTY OR LEASE LINE, FT. (Also to nearest drilg. unit line, if any)			12. COUNTY OR PARISH 13. STATE Rio Arriba New Mexico		
16. NO. OF ACRES IN LEASE			17. NO. OF ACRES ASSIGNED TO THIS WELL 160.00		
18. DISTANCE FROM PROPOSED LOCATION* TO NEAREST WELL, DRILLING, COMPLETED, OR APPLIED FOR, ON THIS LEASE, FT.			20. ROTARY OR CABLE TOOLS Rotary		
19. PROPOSED DEPTH 3540'			21. ELEVATIONS (Show whether DF, RT, GR, etc.) 6619'GR		
22. APPROX. DATE WORK WILL START*					

23. PROPOSED CASING AND CEMENTING PROGRAM

SIZE OF HOLE	SIZE OF CASING	WEIGHT PER FOOT	SETTING DEPTH	QUANTITY OF CEMENT
12 1/4"	8 5/8"	24#	120'	110 cu. ft. to circulate
6 3/4"	2 7/8"	6.4#	3540'	252 cu. ft. to cover Ojo Alamo

Selectively perforate and sandwater fracture the Pictured Cliffs formation.

The NW/4 of Section 8 is dedicated to this well.

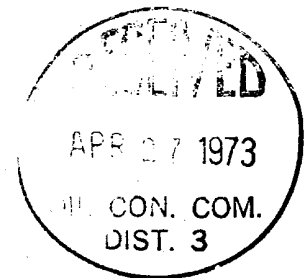

IN ABOVE SPACE DESCRIBE PROPOSED PROGRAM: If proposal is to deepen or plug back, give data on present productive zone and proposed new productive zone. If proposal is to drill or deepen directionally, give pertinent data on subsurface locations and measured and true vertical depths. Give blowout preventer program, if any.

24. SIGNED F.H. Wood TITLE Petroleum Engineer DATE April 25, 1973

(This space for Federal or State office use)

PERMIT NO. _____ APPROVAL DATE _____
APPROVED BY _____ TITLE _____ DATE _____

CONDITIONS OF APPROVAL, IF ANY:

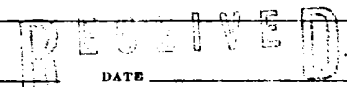

APR 26 1973

*See Instructions On Reverse Side

U.S. GEOLOGICAL SURVEY
WASHINGTON, D.C.

NEW MEXICO OIL CONSERVATION COMMISSION
WELL LOCATION AND ACREAGE DEDICATION PLAT

Form O-12
Supersedes C-12B
Effective 1-1-68

All distances must be from the center line of the Section.

EL PASO NATURAL GAS COMPANY		SAN JUAN 27-5 UNIT (SF-079391)		150
E	8	27-N	5-W	RIO ARRIBA
1725	NORTH	1170	WEST	
-6619	PICTURED CLIFFS	TAPACITO PICTURED CLIFFS	160.00	

1. Outline the acreage dedicated to the subject well by colored pencil or hachure marks on the plat.
2. If more than one lease is dedicated to the well, outline each and identify the ownership thereof (including interest and royalty).
3. If more than one lease of different ownership is dedicated to the well, have the interests of all owners been consolidated by communitization, unitization, force-pooling, etc?



Yes No If answer is "yes," type of consolidation: Unitization

If answer is "no," list the owners and tract descriptions which have actually been consolidated. (Use reverse side of this form if necessary.)

No allowable will be assigned to the well until all interests have been consolidated (by communitization, unitization, force-pooling, or otherwise) or until a non-standard unit, eliminating such interests, has been approved by the Commission.

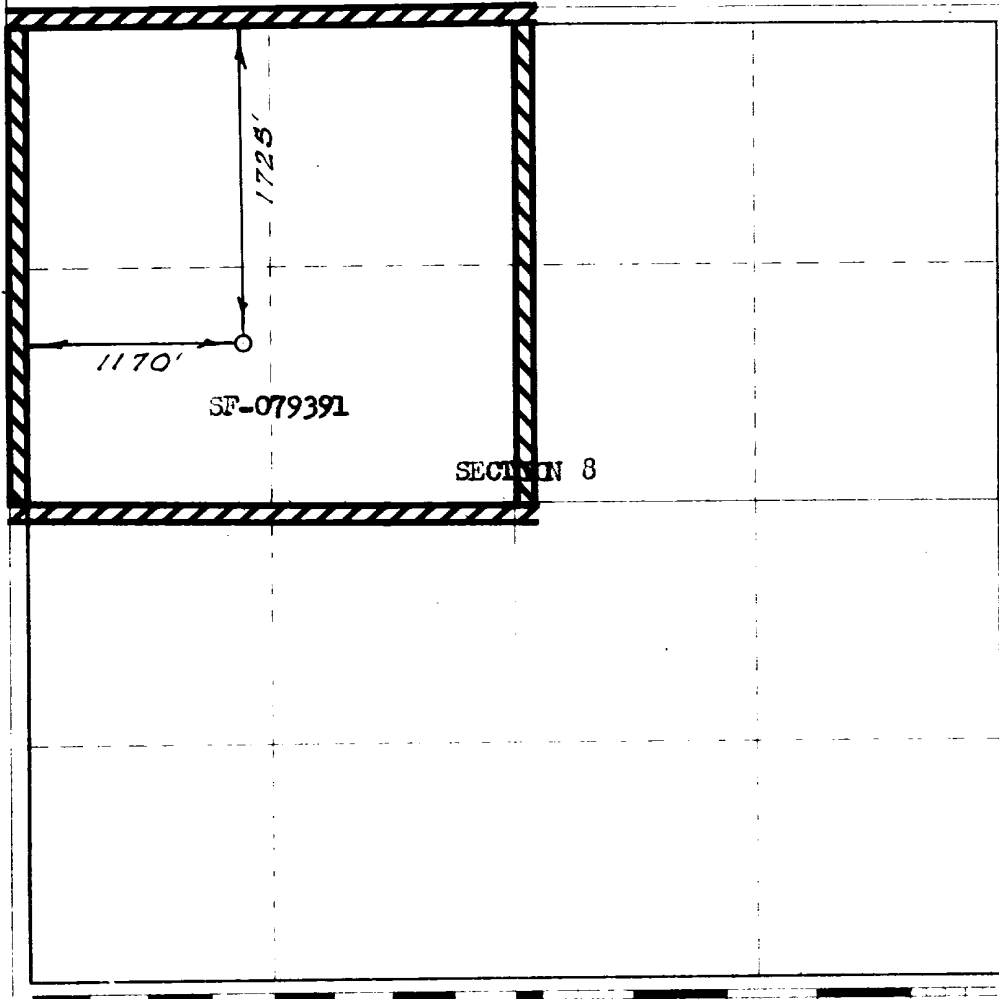

CERTIFICATION

I hereby certify that the information contained herein is true and complete to the best of my knowledge and belief.

Original Signed F. H. WOOD
 Petroleum Engineer
 El Paso Natural Gas Co.
 April 25, 1973

I hereby certify that the well location shown on this plat was plotted from field notes of actual surveys made by me or under my supervision, and that the same is true and correct to the best of my knowledge and belief.

FEBRUARY 15, 1973

David Wilson
1760

LOCATION AND EQUIPMENT LAY-OUT

SAN JUAN 27-S Unit No. 150

[Handwritten signature]

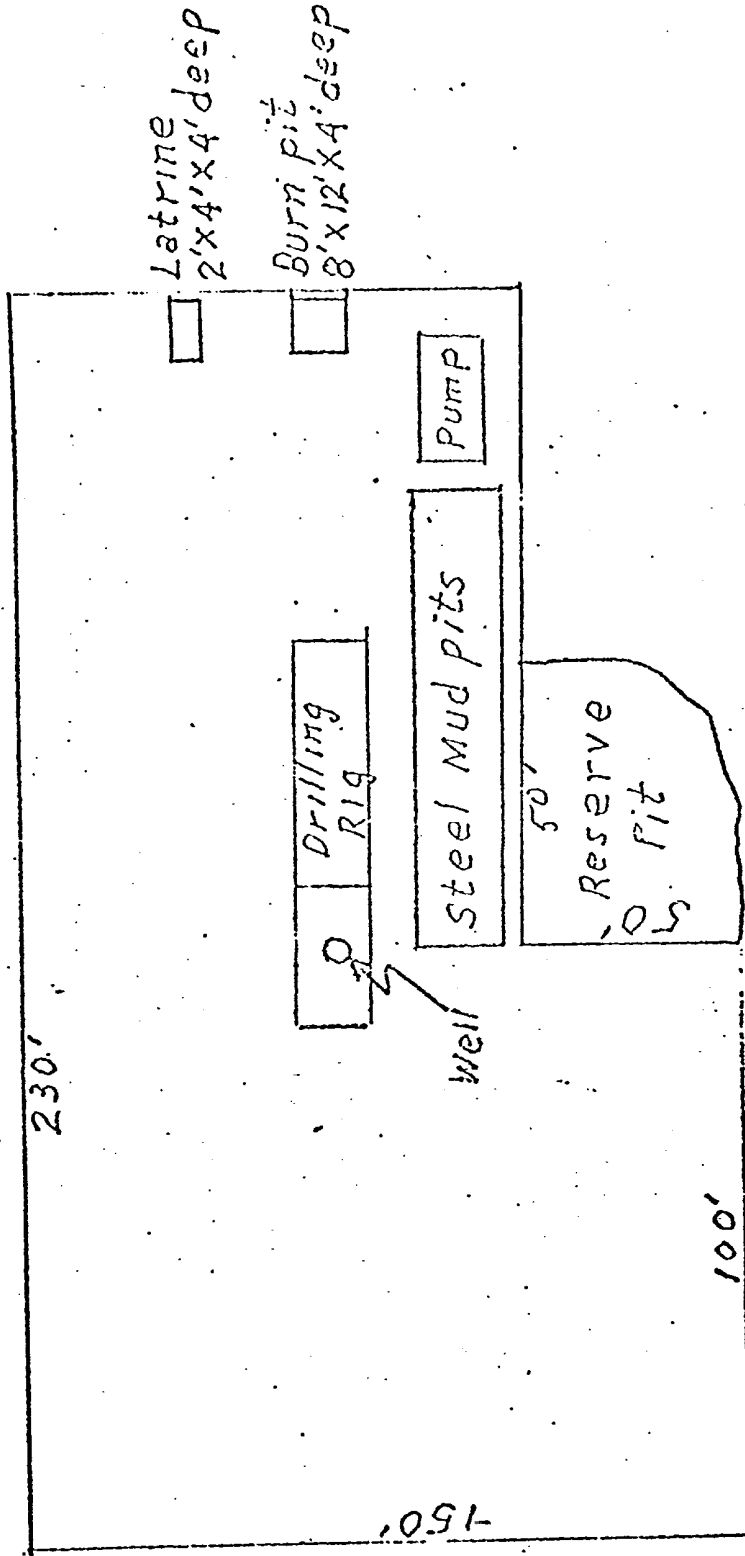

EXISTING AND PROPOSED ROADS AND PIPELINE RIGHTS-OF-WAY

SAN JUAN 27-5 UNIT No. 150

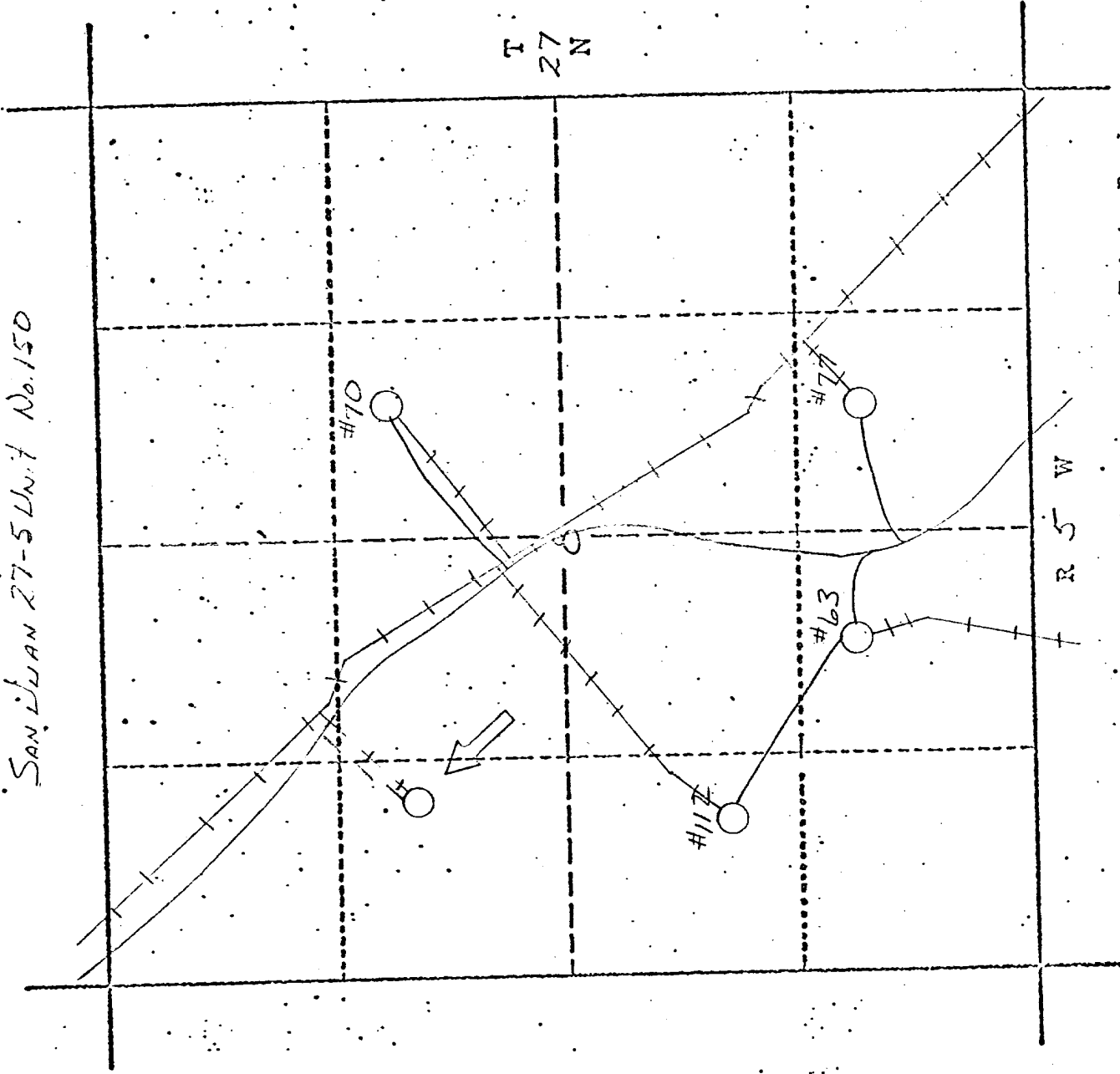

Existing Road
Proposed Road
Existing Right-of-Way
Proposed Right-of-Way