

UNITED STATES
DEPARTMENT OF THE INTERIOR
GEOLOGICAL SURVEY

30-039-20623

APPLICATION FOR PERMIT TO DRILL, DEEPEN, OR PLUG BACK

1a. TYPE OF WORK DRILL <input checked="" type="checkbox"/> DEEPEN <input type="checkbox"/> PLUG BACK <input type="checkbox"/>			5. LEASE DESIGNATION AND SERIAL NO. SF 079403
b. TYPE OF WELL OIL <input type="checkbox"/> GAS <input checked="" type="checkbox"/> OTHER <input type="checkbox"/> SINGLE ZONE <input checked="" type="checkbox"/> MULTIPLE ZONE <input type="checkbox"/>			6. IF INDIAN, ALLOTTEE OR TRIBE NAME
2. NAME OF OPERATOR El Paso Natural Gas Company			7. UNIT AGREEMENT NAME San Juan 27-5 Unit
3. ADDRESS OF OPERATOR PO Box 990, Farmington, NM 87401			8. FARM OR LEASE NAME San Juan 27-5 Unit
4. LOCATION OF WELL (Report location clearly and in accordance with any State requirements.)* At surface 1550'N, 800'W At proposed prod. zone			9. WELL NO. 155
14. DISTANCE IN MILES AND DIRECTION FROM NEAREST TOWN OR POST OFFICE*			10. FIELD AND POOL, OR WILDCAT Tapacito Pictured Cliffs
15. DISTANCE FROM PROPOSED* LOCATION TO NEAREST PROPERTY OR LEASE LINE, FT. (Also to nearest drill, salt line, if any)			11. SEC., T., R., M., OR BLM. AND SURVEY OR AREA Sec. 22, T-27-N, R-5-W
16. NO. OF ACRES IN LEASE			12. COUNTY OR PARISH Rio Arriba
17. NO. OF ACRES ASSIGNED TO THIS WELL			13. STATE New Mexico
18. DISTANCE FROM PROPOSED* LOCATION TO NEAREST WELL, INCLUDING, COMPLETED, OR APPLIED FOR, ON THIS LEASE, FT.			160.00
19. PROPOSED DEPTH 3275'			20. ROTARY OR CABLE TOOLS Rotary
21. DRILLATIONS (SHOW WEIGHT OF DR., RT., GR., ETC.) 6539'GR			22. APPROX. DATE WORK WILL START*

PROPOSED CASING AND CEMENTING PROGRAM

SIZE OF HOLE	SIZE OF CASING	WEIGHT PER FOOT	SETTING DEPTH	QUANTITY OF CEMENT
12 1/4"	8 5/8"	24.0#	120'	110 cu. ft. to circulate
6 3/4"	2 7/8"	6.4#	3275'	220 cu. ft. to cover Ojd Alamo

Selectively perforate and sandwater fracture the Pictured Cliffs formation.

The NW/4 of Section 22 is dedicated to this well.



IN ABOVE SPACE DESCRIBE PROPOSED PROGRAM: If proposal is to deepen or plug back, give data on present productive zone and proposed new productive zone. If proposal is to drill or deepen directionally, give pertinent data on subsurface locations and measured and true vertical depths. Give blowout preventer program, if any.

24. SIGNED [Signature] TITLE Petroleum Engineer DATE April 27, 1973

(This space for Federal or State office use)

PERMIT NO. _____ APPROVAL DATE _____

APPROVED BY [Signature] TITLE _____ DATE _____

CONDITIONS OF APPROVAL, IF ANY:

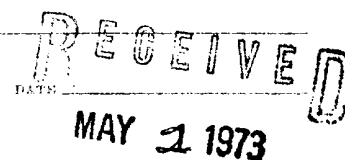

*See Instructions On Reverse Side

U. S. GEOLOGICAL SURVEY
SANDRIDGE, COLO.

NEW MEXICO OIL CONSERVATION COMMISSION
WELL LOCATION AND ACREAGE DEDICATION PLAT

Form C-102
Supersedes C-128
Effective 1-1-65

All distances must be from the outer boundaries of the Section.

Operator EL PASO NATURAL GAS COMPANY			Lease SAN JUAN 27-5 UNIT (SF-079403)		Well No. 155
Section E	Range 22	Township 27-N	Range 5-W	County RIO ARriba	
Actual Location of Well: 1550 feet from the NORTH line, 800 feet from the WEST line.					
Section 6539	Picture of Location PICTURED CLIFFS		Foot TAPACITO PICTURED CLIFFS		Section 160.00

1. Outline the acreage dedicated to the subject well by colored pencil or hatchure marks on the plat below.
2. If more than one lease is dedicated to the well, outline each and identify the ownership thereof (whether to the interest and royalty).
3. If more than one lease of different ownership is dedicated to the well, have the interests of all owners been consolidated by communitization, unitization, force-pooling, etc?

☒ Yes ☐ No If answer is "yes," type of consolidation Unitization **ST. 3**

If answer is "no," list the owners and tract descriptions which have actually been consolidated. (Use reverse side of this form if necessary.)

No allowable will be assigned to the well until all interests have been consolidated (by communitization, unitization, forced-pooling, or otherwise) or until a non-standard unit, eliminating such interests, has been approved by the Commission.

CERTIFICATION

I hereby certify that the information contained herein is true and complete to the best of my knowledge and belief.

Original Signed **F. H. WOOD**

Petroleum Engineer

El Paso Natural Gas Co.

April 27, 1973

I hereby certify that the well location shown on this plat was plotted from field notes of actual surveys made by me or under my supervision, and that the same is true and correct to the best of my knowledge and belief.

FEBRUARY 20, 1973

David Wilson
1760

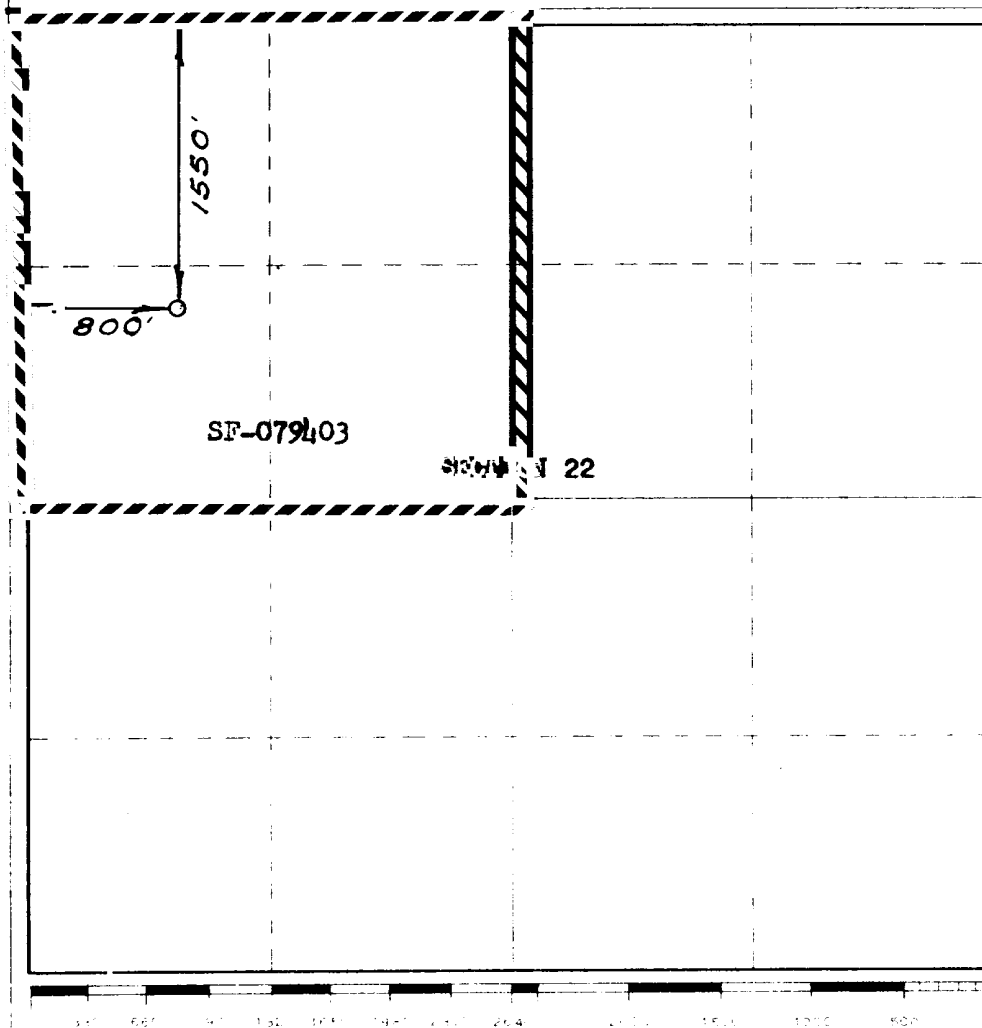

LOCATION AND EQUIPMENT LAY-OUT

SAN JUAN 27-5 UNIT No. 155

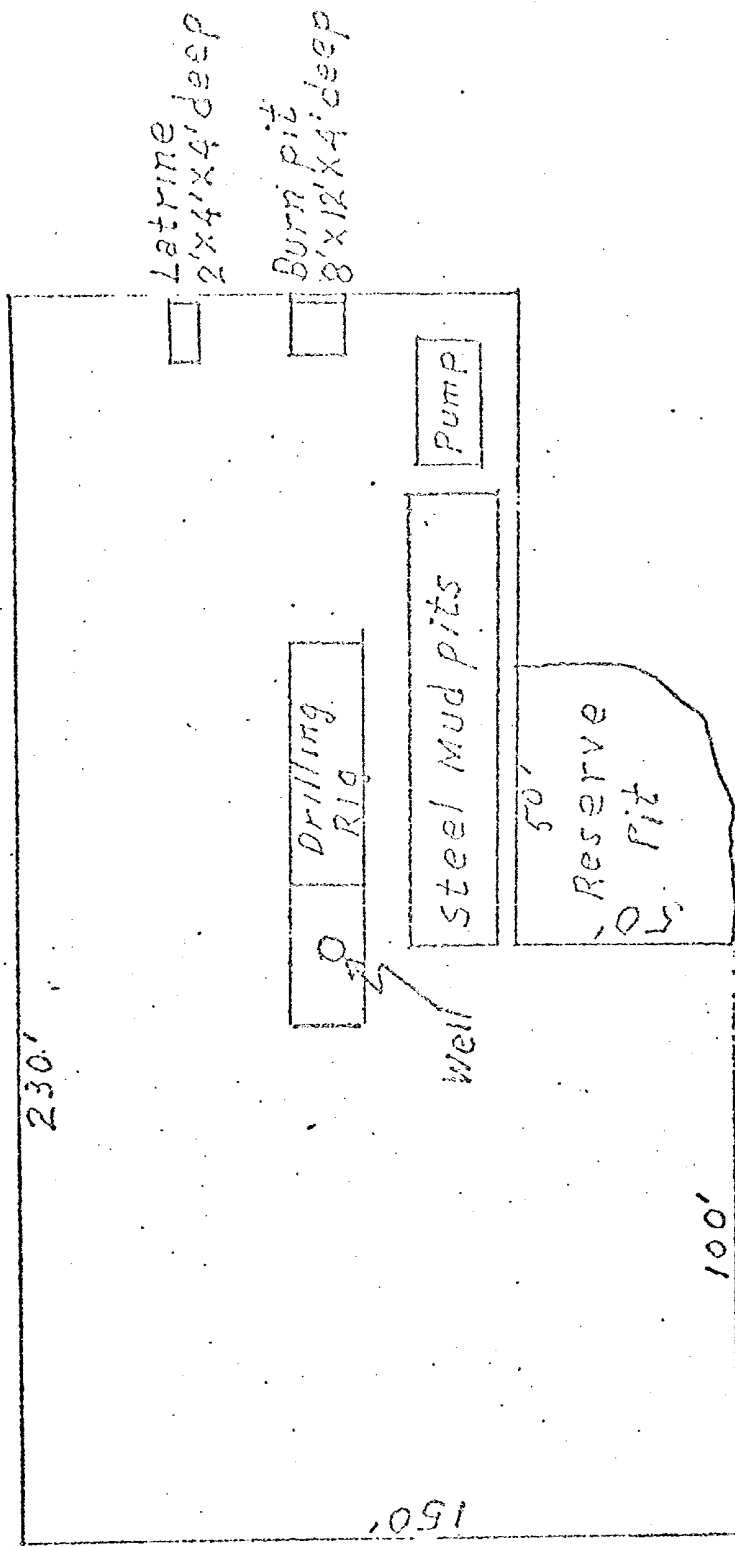

RECEIVED

MAY 2 1973

U. S. GEOLOGICAL SURVEY
DURANGO, COLO.

EXISTING AND PROPOSED ROADS AND PIPELINE RIGHTS-OF-WAY

SAN JUAN 27-5 Unit No. 155

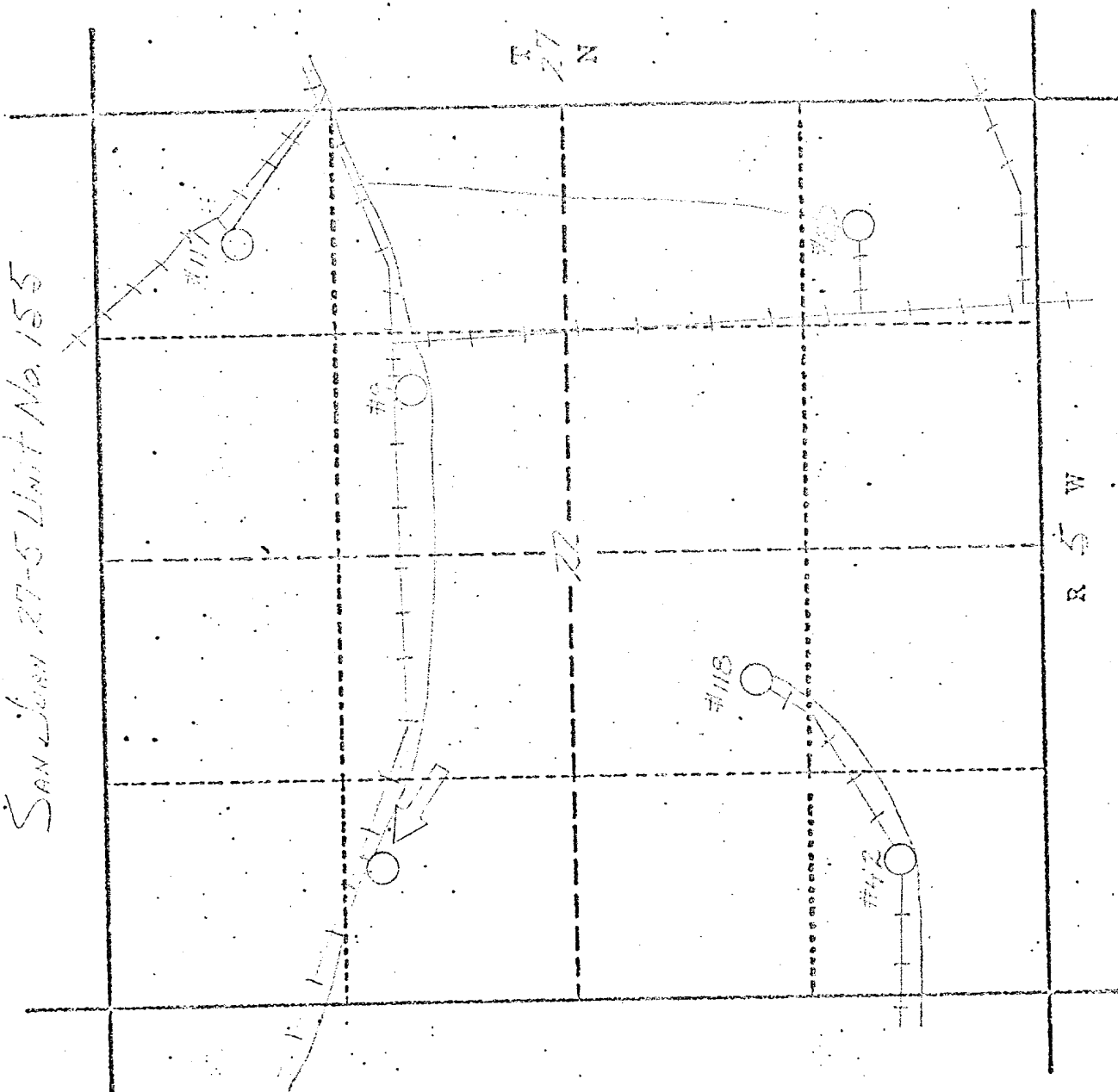

Existing Road
Proposed Road
Existing Right-of-Way
Proposed Right-of-Way

MAY 2 1973

U. S. GEOLOGICAL SURVEY
DURANGO, COLO.