

NO. OF COPIES RECEIVED	6
DISTRIBUTION	
SANTA FE	1
FILE	1
U.S.G.J.	2
LAND OFFICE	1
OPERATOR	1

NEW MEXICO OIL CONSERVATION COMMISSION

30-039-20660

Form C-101
Revised 1-4-65

5A. Indicate Type of Lease STATE <input checked="" type="checkbox"/> FEDERAL <input type="checkbox"/>
5. State Oil & Gas Lease No. E-290-3
7. Unit Agreement Name San Juan 27-5 Unit
8. Farm or Lease Name San Juan 27-5 Unit
9. Well No. 167
10. Field and Pool, or Wildcat Basin Dakota
12. County Rio Arriba
19. Proposed Depth 7664'
19A. Formation Dakota
20. Rotary or C.T. Rotary
21. Elevations (Show whether DF, RT, etc.) 6554'GR
21A. Kind & Status Plug. Bond statewide
21B. Drilling Contractor
22. Approx. Date Work will start

APPLICATION FOR PERMIT TO DRILL, DEEPEN, OR PLUG BACK					
1a. Type of Work DRILL <input checked="" type="checkbox"/> DEEPEN <input type="checkbox"/> PLUG BACK <input type="checkbox"/>					
b. Type of Well OIL WELL <input type="checkbox"/> GAS WELL <input checked="" type="checkbox"/> OTHER <input type="checkbox"/> SINGLE ZONE <input checked="" type="checkbox"/> MULTIPLE ZONE <input type="checkbox"/>					
2. Name of Operator El Paso Natural Gas Company					
3. Address of Operator PO Box 990, Farmington, NM 87401					
4. Location of Well UNIT LETTER L LOCATED 1460 FEET FROM THE South LINE AND 990 FEET FROM THE West LINE OF SEC. 32 TWP. 27N RGE. 5W NMPM					
23. PROPOSED CASING AND CEMENT PROGRAM					
SIZE OF HOLE	SIZE OF CASING	WEIGHT PER FOOT	SETTING DEPTH	SACKS OF CEMENT	EST. TOP
13 3/4"	9 5/8"	32.3#	200'	220 cu. ft.	circ. to surface
8 3/4"	7"	20#	3506'	195 cu. ft.	cover Ojo Alamo
6 1/4"	4 1/2"	10.5#&11.6#	7664'	624 cu. ft.	fill to int. casing

Selectively perforate and sandwater fracture the Dakota formation.

The E/2 of Section 32 is dedicated to this well.

APPROVAL VALID
FOR 90 DAYS UNLESS
DRILLING COMMENCED,

EXPIRES 9-10-73



IN ABOVE SPACE DESCRIBE PROPOSED PROGRAM: IF PROPOSAL IS TO DEEPEN OR PLUG BACK, GIVE DATA ON PRESENT PRODUCTIVE ZONE AND PROPOSED NEW PRODUCTIVE ZONE. GIVE BLOWOUT PREVENTER PROGRAM, IF ANY.

I hereby certify that the information above is true and complete to the best of my knowledge and belief.

Signed A. G. Suarez Title Drilling Clerk Date June 12, 1973

(This space for State Use)

APPROVED BY Ernest Chavez TITLE SUPERVISOR DIST. #3 DATE JUN 12 1973

CONDITIONS OF APPROVAL, IF ANY:

NEW MEXICO OIL CONSERVATION COMMISSION
WELL LOCATION AND ACREAGE DEDICATION PLAT

Form O-128
Supersedes O-128
Effective 1-1-67

All distances must be from the outer boundaries of the Section.

EL PASO NATURAL GAS COMPANY		SAN JUAN 27-5 UNIT (E-290-3)		Well No. 167
Section 32	County RIO ARriba	Is more 5-W		
1:60	SOUTH	990	WEST	
6554	DAKOTA	BASIN DAKOTA	320.00	

1. Outline the acreage dedicated to the subject well by colored pencil or hatchure marks on the plat below.
2. If more than one lease is dedicated to the well, outline each and identify the ownership thereof (both working interest and royalty).
3. If more than one lease of different ownership is dedicated to the well, have the interests of all owners been consolidated by communitization, unitization, force-pooling, etc?

☒ Yes ☐ No If answer is "yes," type of consolidation Unitization **OIL CON. COM. DIST. 3**

If answer is "no," list the owners and tract descriptions which have actually been consolidated, (Use reverse side of this form if necessary.)

No allowable will be assigned to the well until all interests have been consolidated (by communitization, unitization, forced-pooling, or otherwise) or until a non-standard unit, eliminating such interests, has been approved by the Commission.

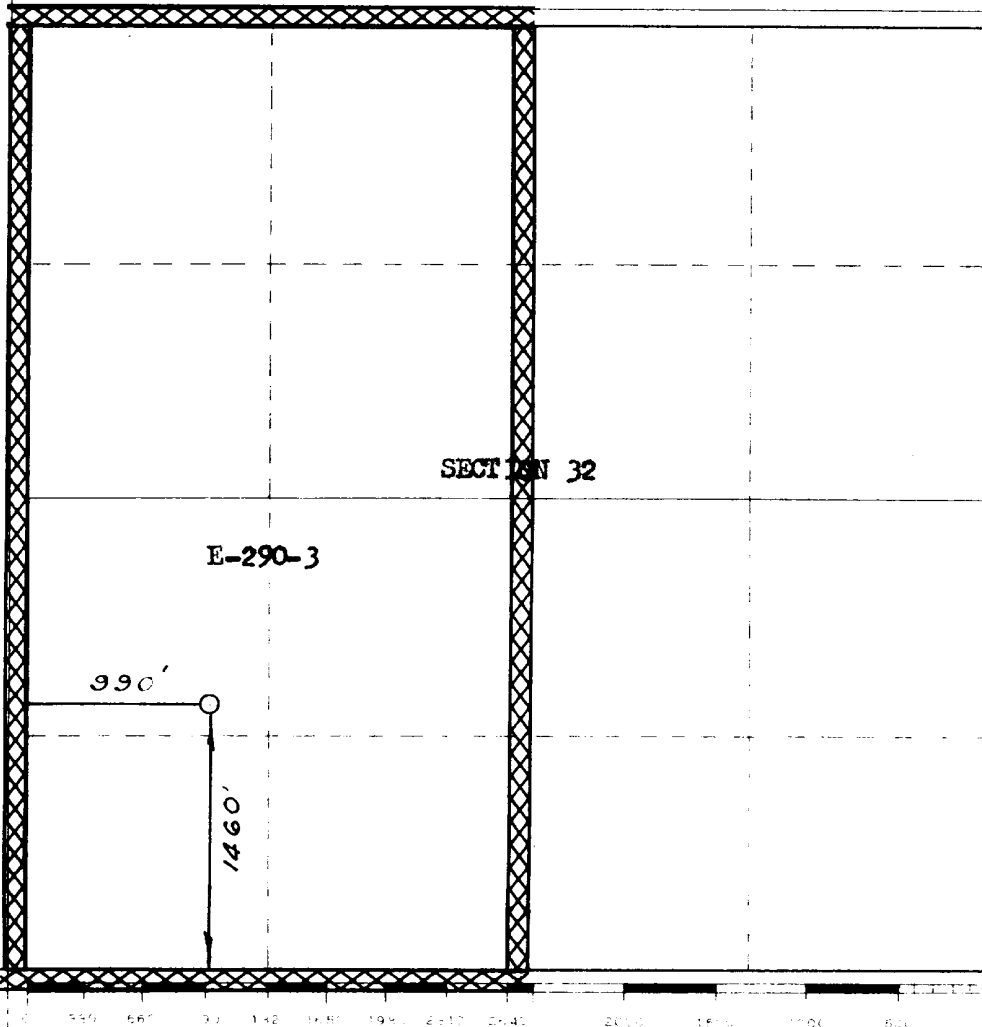

CERTIFICATION

I hereby certify that the information contained herein is true and complete to the best of my knowledge and belief.

Original Signed by
D. G. Brisco

Drilling Clerk

El Paso Natural Gas Co.

June 12, 1973

I hereby certify that the well location shown on this plat was plotted from field notes of actual surveys made by me or under my supervision, and that the same is true and correct to the best of my knowledge and belief.

APRIL 24, 1973

[Signature]
1760