

NO. OF COPIES RECEIVED	5
DISTRIBUTION	
SANTA FE	1
FILE	1
U.S.G.S.	2
LAND OFFICE	
OPERATOR	1

NEW MEXICO OIL CONSERVATION COMMISSION

Form C-101
Revised 1-1-65

30-039-20669

5A. Indicate Type of Lease STATE <input type="checkbox"/> FEE <input checked="" type="checkbox"/>
5. State Oil & Gas Lease No.
7. Unit Agreement Name San Juan 28-6 Unit
8. Farm or Lease Name San Juan 28-6 Unit
9. Well No. 179
10. Field and Pool, or Wildcat Basin Dakota
12. County Rio Arriba
19. Proposed Depth 7604'
19A. Formation Dakota
20. Rotary or C.T. Rotary
21. Elevations (Show whether DF, RT, etc.) 6419'GR
21A. Kind & Status Plug. Bond statewide
21B. Drilling Contractor
22. Approx. Date Work will start

APPLICATION FOR PERMIT TO DRILL, DEEPEN, OR PLUG BACK

1a. Type of Work DRILL <input checked="" type="checkbox"/> DEEPEN <input type="checkbox"/> PLUG BACK <input type="checkbox"/>	7. Unit Agreement Name San Juan 28-6 Unit
b. Type of Well OIL WELL <input type="checkbox"/> GAS WELL <input checked="" type="checkbox"/> OTHER <input type="checkbox"/>	8. Farm or Lease Name San Juan 28-6 Unit
2. Name of Operator El Paso Natural Gas Company	9. Well No. 179
3. Address of Operator PO Box 990, Farmington, NM 87401	10. Field and Pool, or Wildcat Basin Dakota
4. Location of Well UNIT LETTER N LOCATED 1180 FEET FROM THE South LINE AND 1500 FEET FROM THE West LINE OF SEC. 13 TWP. 27N RGE. 6W NMPM	12. County Rio Arriba
19. Proposed Depth 7604'	19A. Formation Dakota
20. Rotary or C.T. Rotary	
21. Elevations (Show whether DF, RT, etc.) 6419'GR	21A. Kind & Status Plug. Bond statewide
21B. Drilling Contractor	22. Approx. Date Work will start

23.

PROPOSED CASING AND CEMENT PROGRAM

SIZE OF HOLE	SIZE OF CASING	WEIGHT PER FOOT	SETTING DEPTH	SACKS OF CEMENT	EST. TOP
13 3/4"	9 5/8"	32.3#	200'	220 cu. ft.	circ. to surface
8 3/4"	7"	20#	3436'	225 cu. ft.	2421'
6 1/4"	4 1/2"	10.5# & 11.6#	7604'	640 cu. ft.	3436'

Selectively perforate and sandwater fracture the Dakota formation.

The W/2 of Section 13 is dedicated to this well.

APPROVAL VALID
FOR 90 DAYS UNLESS
DRILLING COMMENCED,

EXPIRES 9-11-73



IN ABOVE SPACE DESCRIBE PROPOSED PROGRAM: IF PROPOSAL IS TO DEEPEN OR PLUG BACK, GIVE DATA ON PRESENT PRODUCTIVE ZONE AND PROPOSED NEW PRODUCTIVE ZONE, GIVE BLOWOUT PREVENTER PROGRAM, IF ANY.

I hereby certify that the information above is true and complete to the best of my knowledge and belief.

Signed A. H. Baines Title Drilling Clerk Date June 13, 1973

(This space for State Use)

APPROVED BY AR Kendrick TITLE PETROLEUM ENGINEER DIST. NO. 3 DATE JUN 13 1973
CONDITIONS OF APPROVAL, IF ANY:

NEW MEXICO OIL CONSERVATION COMMISSION
WELL LOCATION AND ACREAGE DEDICATION PLAT

Form C-102
Supersedes C-128
Effective 1-1-65

All distances must be from the outer boundaries of the Section

Operator EL PASO NATURAL GAS COMPANY		Lease SAN JUAN 28-6 UNIT (FEE)		Well No. 179
Unit Letter N	Section 13	Township 27-N	Range 6-W	County RIO ARriba
Actual Footage Location of Well: 1180 feet from the SOUTH line and 1500 feet from the WEST line				
Ground Level Elev. 6419	Producing Formation DAKOTA	Pool BASIN DAKOTA ✓	Dedicated Acreage 320.00 ✓ Acres	

1. Outline the acreage dedicated to the subject well by colored pencil or hatchure marks on the plat below.
2. If more than one lease is dedicated to the well, outline each and identify the ownership thereof (both as to working interest and royalty).
3. If more than one lease of different ownership is dedicated to the well, have the interests of all owners been consolidated by communitization, unitization, force-pooling, etc?

☒ Yes ☐ No If answer is "yes," type of consolidation _____



Unitization

If answer is "no," list the owners and tract descriptions which have actually been consolidated. (Use reverse side of this form if necessary.) _____

No allowable will be assigned to the well until all interests have been consolidated (by communitization, unitization, forced-pooling, or otherwise) or until a non-standard unit, eliminating such interests, has been approved by the Commission.

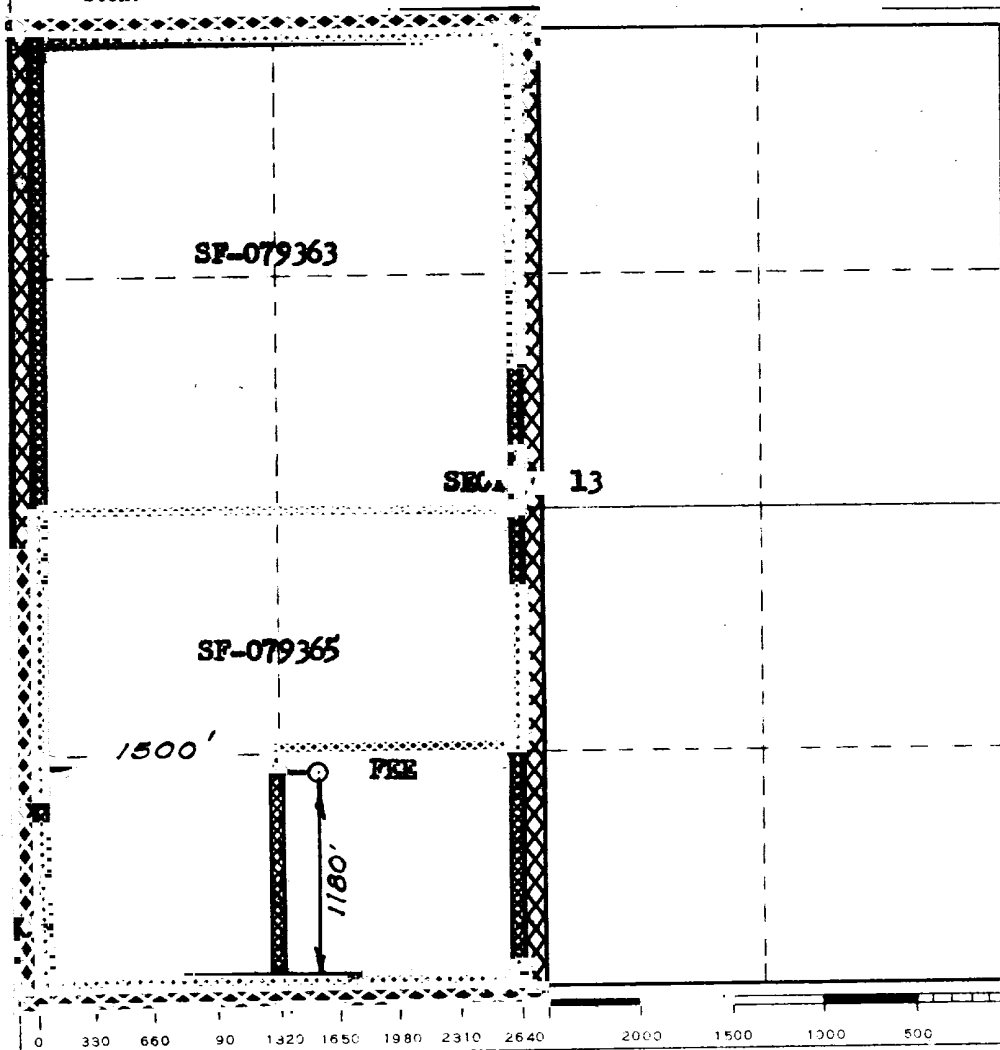

CERTIFICATION

I hereby certify that the information contained herein is true and complete to the best of my knowledge and belief.

D. G. Brisco

Name _____

Drilling Clerk

Position _____

El Paso Natural Gas Co.

Company _____

June 13, 1973

Date _____

I hereby certify that the well location shown on this plat was plotted from field notes of actual surveys made by me or under my supervision, and that the same is true and correct to the best of my knowledge and belief.

Date Surveyed _____

APRIL 13, 1973

Registered Professional Engineer and/or Land Surveyor

Paul Wilson

Certificate No. **1760**