

DISTRICT I

P.O. Box 1980, Hobbs, NM 88241-1980

DISTRICT II

811 South First St., Artesia, NM 88210-2835

DISTRICT III

1000 Rio Brazos Rd, Aztec, NM 87410-1693

State of New Mexico
Energy, Minerals and Natural Resources Department

OIL CONSERVATION DIVISION

2040 S. Pacheco
Santa Fe, New Mexico 87505-6429

Form C-107-A
New 3-12-96

APPROVAL PROCESS :

Administrative Hearing

EXISTING WELLBORE

YES NO

APPLICATION FOR DOWNHOLE COMMINGLING

Burlington Resources Oil & Gas Company

PO Box 4289, Farmington, NM 87499

Operator

Address

San Juan 27-4 Unit

69

34-27N-04W

Rio Arriba

Lease

Well No.

Unit Ltr. - Sec - Twp - Rge

County

Spacing Unit Lease Types: (check 1 or more)

OGRID NO. 14538

Property Code 7452

API NO. 30-039-2072300

Federal x

State

(and/or) Fee

The following facts are submitted in support of downhole commingling:	Upper Zone	Intermediate Zone	Lower Zone
1. Pool Name and Pool Code	Blanco Mesaverde - 72319		Basin Dakota - 71599
2. Top and Bottom of Pay Section (Perforations)	will be supplied upon completion		will be supplied upon completion
3. Type of production (Oil or Gas)	Gas		Gas
4. Method of Production (Flowing or Artificial Lift)	Flowing		Flowing
5. Bottomhole Pressure Oil Zones - Artificial Lift: Estimated Current Gas & Oil - Flowing: Measured Current All Gas Zones: Estimated or Measured Original	(Current) a. 630 psi (see attachment)	a.	a. 1326 psi (see attachment)
	(Original) b. 1375 psi (see attachment)	b.	b. 2919 psi (see attachment)
6. Oil Gravity (API) or Gas BTU Content	BTU 1156		BTU 1247
7. Producing or Shut-In?	shut in		shut in
Production Marginal? (yes or no)	No		Yes
* If Shut-In and oil/gas/water rates of last production	Date: n/a Rates:	Date: Rates:	Date: n/a Rates:
* If Producing, give data and oil/gas/water water of recent test (within 60 days)	Date: n/a Rates:	Date: Rates:	Date: n/a Rates:

RECEIVED
APR - 5 1999
OIL CON. DIV.
DIST. 3

District I
 PO Box 1980, Hobbs, NM 88241-1980
 District II
 PO Drawer DD, Artesia, NM 88211-0719
 District III
 1000 Rio Brazos Rd., Aztec, NM 87410
 District IV
 PO Box 2088, Santa Fe, NM 87504-2088

State of New Mexico
 Energy, Minerals & Natural Resources Department

OIL CONSERVATION DIVISION
 PO Box 2088
 Santa Fe, NM 87504-2088

Form C
 Revised February 21, 1988
 Instructions on
 Submit to Appropriate District Office
 State Lease - 4 C
 Fee Lease - 3 C

AMENDED REPORT

WELL LOCATION AND ACREAGE DEDICATION PLAT

API Number 30-039-20723		Pool Code 72319/71599	Pool Name Blanco Mesaverde/Basin Dakota
Property Code 7452	Property Name San Juan 27-4 Unit		Well Number 69
OGRID No. 14538	Operator Name Burlington Resources Oil & Gas Company		Elevation 7168 GR

10 Surface Location

UL or lot no.	Section	Township	Range	Lot Idn	Feet from the	North/South line	Feet from the	East/West line	County
E	34	27N	4W		1500	North	835	West	RA

11 Bottom Hole Location If Different From Surface

UL or lot no.	Section	Township	Range	Lot Idn	Feet from the	North/South line	Feet from the	East/West line	County

12 Dedicated Acres MV-W/320 DK-W/320	13 Joint or Infill	14 Consolidation Code	15 Order No.
--	--------------------	-----------------------	--------------

NO ALLOWABLE WILL BE ASSIGNED TO THIS COMPLETION UNTIL ALL INTERESTS HAVE BEEN CONSOLIDATED OR A NON-STANDARD UNIT HAS BEEN APPROVED BY THE DIVISION

16 1500' 835' RECEIVED APR - 5 1999 OIL CON. DIV. DIST. 3	17 OPERATOR CERTIFICATION I hereby certify that the information contained hereon is true and complete to the best of my knowledge and belief.	
	Signature Peggy Bradfield Printed Name Regulatory Administrator Title	
	Date	
18 SURVEYOR CERTIFICATION I hereby certify that the well location shown on this plat was plotted from field notes of actual surveys made or under my supervision, and that the same is true and correct to the best of my belief.		Date of Survey Signature and Seal of Professional Surveyer:
		Certificate Number

BURLINGTON RESOURCES OIL AND GAS COMPANY

San Juan 27-4 Unit #69

OFFSET OPERATOR/OWNER PLAT

Mesaverde/Dakota Formations

Commingled well

Township 27 North, Range 4 West

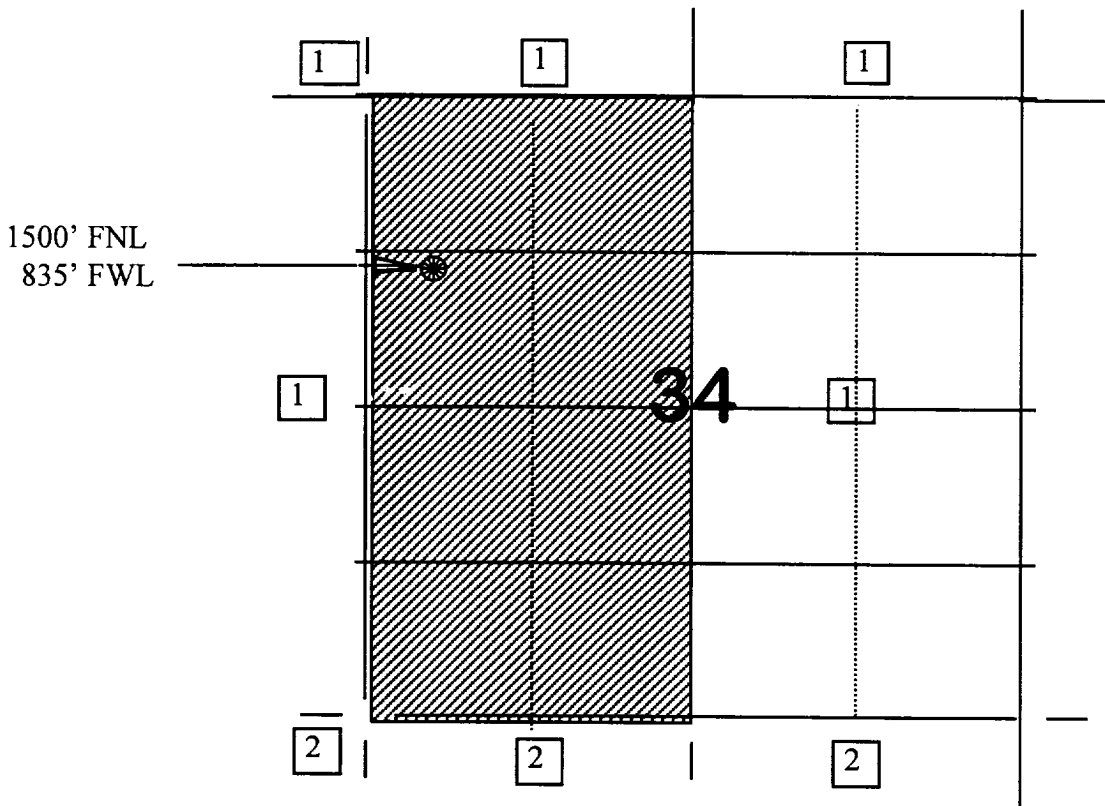

1) Burlington Resources

2) Amoco Production Company
C/O Don Duhrkopf
501 West Lake Park Blvd.
Houston, TX 77079-2696

San Juan 27-4 Unit # 69

Expected Production

Mesaverde Formation

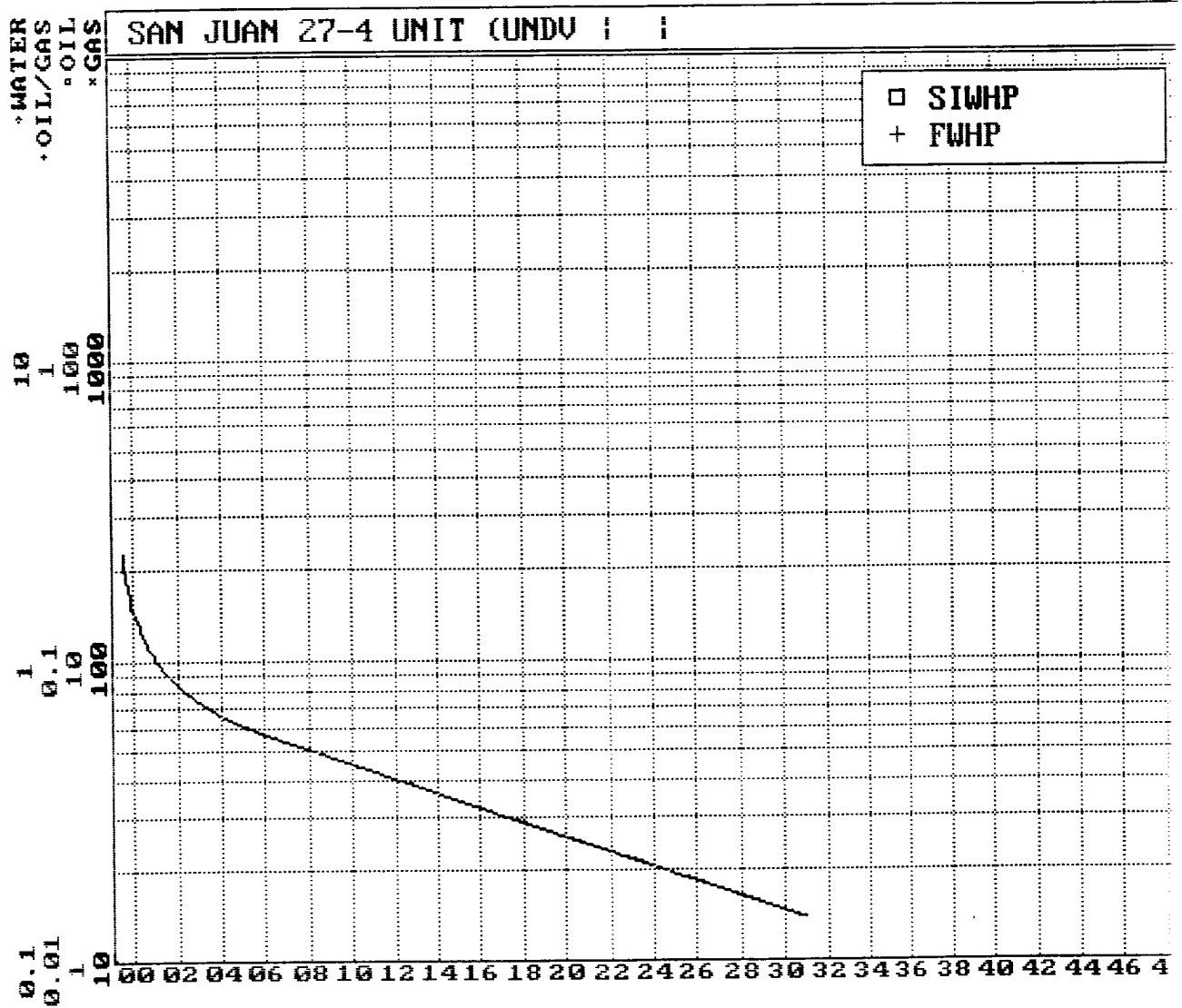

San Juan 27-4 Unit # 69

Actual Production

Dakota Formation

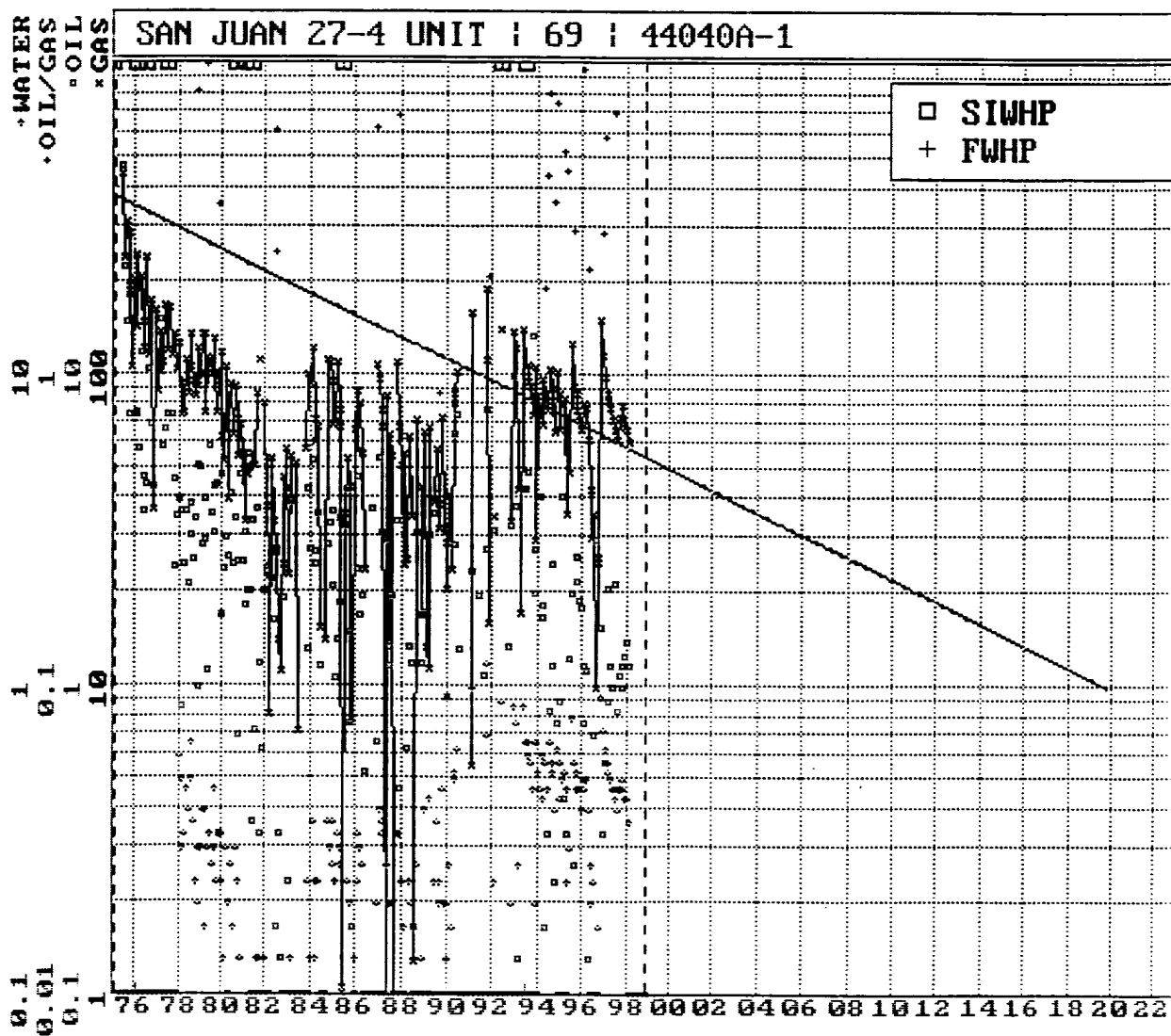

San Juan 27-4 Unit #69

Bottom Hole Pressures
Flowing and Static BHP
Cullender and Smith Method
Version 1.0 3/13/94

Mesaverde	Dakota																																																
<u>MV-Current</u>	<u>DK-Current</u>																																																
<table style="width: 100%; border-collapse: collapse;"> <tr><td style="width: 80%;">GAS GRAVITY</td><td style="text-align: right; border-bottom: 1px solid black;">0.675</td></tr> <tr><td>COND. OR MISC. (C/M)</td><td style="text-align: right; border-bottom: 1px solid black;">C</td></tr> <tr><td>%N2</td><td style="text-align: right; border-bottom: 1px solid black;">0.34</td></tr> <tr><td>%CO2</td><td style="text-align: right; border-bottom: 1px solid black;">0.8</td></tr> <tr><td>%H2S</td><td style="text-align: right; border-bottom: 1px solid black;">0</td></tr> <tr><td>DIAMETER (IN)</td><td style="text-align: right; border-bottom: 1px solid black;">1.5</td></tr> <tr><td>DEPTH (FT)</td><td style="text-align: right; border-bottom: 1px solid black;">8372</td></tr> <tr><td>SURFACE TEMPERATURE (DEG F)</td><td style="text-align: right; border-bottom: 1px solid black;">60</td></tr> <tr><td>BOTTOMHOLE TEMPERATURE (DEG F)</td><td style="text-align: right; border-bottom: 1px solid black;">137</td></tr> <tr><td>FLOWRATE (MCFPD)</td><td style="text-align: right; border-bottom: 1px solid black;">0</td></tr> <tr><td>SURFACE PRESSURE (PSIA)</td><td style="text-align: right; border-bottom: 1px solid black;">512</td></tr> <tr><td>BOTTOMHOLE PRESSURE (PSIA)</td><td style="text-align: right; border: 1px solid black;">630.4</td></tr> </table>	GAS GRAVITY	0.675	COND. OR MISC. (C/M)	C	%N2	0.34	%CO2	0.8	%H2S	0	DIAMETER (IN)	1.5	DEPTH (FT)	8372	SURFACE TEMPERATURE (DEG F)	60	BOTTOMHOLE TEMPERATURE (DEG F)	137	FLOWRATE (MCFPD)	0	SURFACE PRESSURE (PSIA)	512	BOTTOMHOLE PRESSURE (PSIA)	630.4	<table style="width: 100%; border-collapse: collapse;"> <tr><td style="width: 80%;">GAS GRAVITY</td><td style="text-align: right; border-bottom: 1px solid black;">0.736</td></tr> <tr><td>COND. OR MISC. (C/M)</td><td style="text-align: right; border-bottom: 1px solid black;">C</td></tr> <tr><td>%N2</td><td style="text-align: right; border-bottom: 1px solid black;">0.33</td></tr> <tr><td>%CO2</td><td style="text-align: right; border-bottom: 1px solid black;">0.89</td></tr> <tr><td>%H2S</td><td style="text-align: right; border-bottom: 1px solid black;">0</td></tr> <tr><td>DIAMETER (IN)</td><td style="text-align: right; border-bottom: 1px solid black;">1.5</td></tr> <tr><td>DEPTH (FT)</td><td style="text-align: right; border-bottom: 1px solid black;">8372</td></tr> <tr><td>SURFACE TEMPERATURE (DEG F)</td><td style="text-align: right; border-bottom: 1px solid black;">60</td></tr> <tr><td>BOTTOMHOLE TEMPERATURE (DEG F)</td><td style="text-align: right; border-bottom: 1px solid black;">198</td></tr> <tr><td>FLOWRATE (MCFPD)</td><td style="text-align: right; border-bottom: 1px solid black;">0</td></tr> <tr><td>SURFACE PRESSURE (PSIA)</td><td style="text-align: right; border-bottom: 1px solid black;">1047</td></tr> <tr><td>BOTTOMHOLE PRESSURE (PSIA)</td><td style="text-align: right; border: 1px solid black;">1325.7</td></tr> </table>	GAS GRAVITY	0.736	COND. OR MISC. (C/M)	C	%N2	0.33	%CO2	0.89	%H2S	0	DIAMETER (IN)	1.5	DEPTH (FT)	8372	SURFACE TEMPERATURE (DEG F)	60	BOTTOMHOLE TEMPERATURE (DEG F)	198	FLOWRATE (MCFPD)	0	SURFACE PRESSURE (PSIA)	1047	BOTTOMHOLE PRESSURE (PSIA)	1325.7
GAS GRAVITY	0.675																																																
COND. OR MISC. (C/M)	C																																																
%N2	0.34																																																
%CO2	0.8																																																
%H2S	0																																																
DIAMETER (IN)	1.5																																																
DEPTH (FT)	8372																																																
SURFACE TEMPERATURE (DEG F)	60																																																
BOTTOMHOLE TEMPERATURE (DEG F)	137																																																
FLOWRATE (MCFPD)	0																																																
SURFACE PRESSURE (PSIA)	512																																																
BOTTOMHOLE PRESSURE (PSIA)	630.4																																																
GAS GRAVITY	0.736																																																
COND. OR MISC. (C/M)	C																																																
%N2	0.33																																																
%CO2	0.89																																																
%H2S	0																																																
DIAMETER (IN)	1.5																																																
DEPTH (FT)	8372																																																
SURFACE TEMPERATURE (DEG F)	60																																																
BOTTOMHOLE TEMPERATURE (DEG F)	198																																																
FLOWRATE (MCFPD)	0																																																
SURFACE PRESSURE (PSIA)	1047																																																
BOTTOMHOLE PRESSURE (PSIA)	1325.7																																																
<u>MV-Original</u>	<u>DK-Original</u>																																																
<table style="width: 100%; border-collapse: collapse;"> <tr><td style="width: 80%;">GAS GRAVITY</td><td style="text-align: right; border-bottom: 1px solid black;">0.675</td></tr> <tr><td>COND. OR MISC. (C/M)</td><td style="text-align: right; border-bottom: 1px solid black;">C</td></tr> <tr><td>%N2</td><td style="text-align: right; border-bottom: 1px solid black;">0.34</td></tr> <tr><td>%CO2</td><td style="text-align: right; border-bottom: 1px solid black;">0.8</td></tr> <tr><td>%H2S</td><td style="text-align: right; border-bottom: 1px solid black;">0</td></tr> <tr><td>DIAMETER (IN)</td><td style="text-align: right; border-bottom: 1px solid black;">1.5</td></tr> <tr><td>DEPTH (FT)</td><td style="text-align: right; border-bottom: 1px solid black;">8372</td></tr> <tr><td>SURFACE TEMPERATURE (DEG F)</td><td style="text-align: right; border-bottom: 1px solid black;">60</td></tr> <tr><td>BOTTOMHOLE TEMPERATURE (DEG F)</td><td style="text-align: right; border-bottom: 1px solid black;">137</td></tr> <tr><td>FLOWRATE (MCFPD)</td><td style="text-align: right; border-bottom: 1px solid black;">0</td></tr> <tr><td>SURFACE PRESSURE (PSIA)</td><td style="text-align: right; border-bottom: 1px solid black;">1093</td></tr> <tr><td>BOTTOMHOLE PRESSURE (PSIA)</td><td style="text-align: right; border: 1px solid black;">1375.3</td></tr> </table>	GAS GRAVITY	0.675	COND. OR MISC. (C/M)	C	%N2	0.34	%CO2	0.8	%H2S	0	DIAMETER (IN)	1.5	DEPTH (FT)	8372	SURFACE TEMPERATURE (DEG F)	60	BOTTOMHOLE TEMPERATURE (DEG F)	137	FLOWRATE (MCFPD)	0	SURFACE PRESSURE (PSIA)	1093	BOTTOMHOLE PRESSURE (PSIA)	1375.3	<table style="width: 100%; border-collapse: collapse;"> <tr><td style="width: 80%;">GAS GRAVITY</td><td style="text-align: right; border-bottom: 1px solid black;">0.736</td></tr> <tr><td>COND. OR MISC. (C/M)</td><td style="text-align: right; border-bottom: 1px solid black;">C</td></tr> <tr><td>%N2</td><td style="text-align: right; border-bottom: 1px solid black;">0.33</td></tr> <tr><td>%CO2</td><td style="text-align: right; border-bottom: 1px solid black;">0.89</td></tr> <tr><td>%H2S</td><td style="text-align: right; border-bottom: 1px solid black;">0</td></tr> <tr><td>DIAMETER (IN)</td><td style="text-align: right; border-bottom: 1px solid black;">1.5</td></tr> <tr><td>DEPTH (FT)</td><td style="text-align: right; border-bottom: 1px solid black;">8372</td></tr> <tr><td>SURFACE TEMPERATURE (DEG F)</td><td style="text-align: right; border-bottom: 1px solid black;">60</td></tr> <tr><td>BOTTOMHOLE TEMPERATURE (DEG F)</td><td style="text-align: right; border-bottom: 1px solid black;">198</td></tr> <tr><td>FLOWRATE (MCFPD)</td><td style="text-align: right; border-bottom: 1px solid black;">0</td></tr> <tr><td>SURFACE PRESSURE (PSIA)</td><td style="text-align: right; border-bottom: 1px solid black;">2264</td></tr> <tr><td>BOTTOMHOLE PRESSURE (PSIA)</td><td style="text-align: right; border: 1px solid black;">2918.8</td></tr> </table>	GAS GRAVITY	0.736	COND. OR MISC. (C/M)	C	%N2	0.33	%CO2	0.89	%H2S	0	DIAMETER (IN)	1.5	DEPTH (FT)	8372	SURFACE TEMPERATURE (DEG F)	60	BOTTOMHOLE TEMPERATURE (DEG F)	198	FLOWRATE (MCFPD)	0	SURFACE PRESSURE (PSIA)	2264	BOTTOMHOLE PRESSURE (PSIA)	2918.8
GAS GRAVITY	0.675																																																
COND. OR MISC. (C/M)	C																																																
%N2	0.34																																																
%CO2	0.8																																																
%H2S	0																																																
DIAMETER (IN)	1.5																																																
DEPTH (FT)	8372																																																
SURFACE TEMPERATURE (DEG F)	60																																																
BOTTOMHOLE TEMPERATURE (DEG F)	137																																																
FLOWRATE (MCFPD)	0																																																
SURFACE PRESSURE (PSIA)	1093																																																
BOTTOMHOLE PRESSURE (PSIA)	1375.3																																																
GAS GRAVITY	0.736																																																
COND. OR MISC. (C/M)	C																																																
%N2	0.33																																																
%CO2	0.89																																																
%H2S	0																																																
DIAMETER (IN)	1.5																																																
DEPTH (FT)	8372																																																
SURFACE TEMPERATURE (DEG F)	60																																																
BOTTOMHOLE TEMPERATURE (DEG F)	198																																																
FLOWRATE (MCFPD)	0																																																
SURFACE PRESSURE (PSIA)	2264																																																
BOTTOMHOLE PRESSURE (PSIA)	2918.8																																																

Page No.: 1
Print Time: Wed Mar 03 16:53:43 1999
Property ID: 1186
Property Name: SAN JUAN 27-4 UNIT | 132A | 54069A-1
Table Name: Q:\PUBLIC\GENTITY\GDPNOS\TEST.DBF

--DATE-- ---CUM_GAS-- M SIWHP
Mcf Psi

08/02/85	0	1093.0
05/05/86	60194	736.0
07/29/87	249642	572.0
10/16/88	398191	562.0
11/15/89	434727	736.0
07/24/91	566653	585.0
08/20/91	577221	573.0
08/02/93	719246	512.0

San Juan 27-4 Unit # 69

Mesaverde Offset

Page No.: 9

Print Time: Wed Mar 03 16:28:17 1999

Property ID: 1279

Property Name: SAN JUAN 27-4 UNIT | 69 | 44040A-1

Table Name: Q:\PUBLIC\GENTITY\GDPNOS\TEST.DBF

--DATE-- ---CUM GAS-- M SIWHP
Mcf Psi

11/16/73	0	2264.0
01/23/76	58278	1032.0
06/25/76	85714	913.0
07/06/77	139433	832.0
09/02/80	254379	731.0
06/01/81	267161	691.0
06/04/85	331951	973.0
05/28/92	426194	1009.0
06/15/93	448515	1047.0

San Juan 27-4 Unit # 69

Existing Dakota

DR

**BURLINGTON
RESOURCES**

SAN JUAN DIVISION
3535 East 30th Street: (87402-8801)
P.O. BOX 4289
Farmington, New Mexico 87499-4289

**BURLINGTON
RESOURCES**

SAN JUAN DIVISION
3535 East 30th Street: (87402-8801)
P.O. BOX 4289
Farmington, New Mexico 87499-4289

Cinco General Partnership
PO Box 451
Albuquerque, NM 87103-0451

x

Bedrock Limited Partners
PO Box 36480
Albuquerque, NM 87176

**BURLINGTON
RESOURCES**

SAN JUAN DIVISION
3535 East 30th Street: (87402-8801)
P.O. BOX 4289
Farmington, New Mexico 87499-4289

**BURLINGTON
RESOURCES**

SAN JUAN DIVISION
3535 East 30th Street: (87402-8801)
P.O. BOX 4289
Farmington, New Mexico 87499-4289

Tempe LTD Partnership
c/o F.E. & M. K. Harrington
652 Fearington Post
Pittsboro, NC 27312

x

Harco LTD Partnership
PO Box 216
Roswell, NM 88202

**BURLINGTON
RESOURCES**

SAN JUAN DIVISION
3535 East 30th Street: (87402-8801)
P.O. BOX 4289
Farmington, New Mexico 87499-4289

**BURLINGTON
RESOURCES**

SAN JUAN DIVISION
3535 East 30th Street: (87402-8801)
P.O. BOX 4289
Farmington, New Mexico 87499-4289

James V. Harrington
PO Box 13535
Albuquerque, NM 87192

x

Mary Jone Chappell
PO Box 1865
Corrales, NM 87048