

UNITED STATES  
DEPARTMENT OF THE INTERIOR  
BUREAU OF LAND MANAGEMENT

FORM APPROVED  
Budget Bureau No. 1004-0135  
Expires March 31, 1993

5. Lease Designation and Serial No.  
**SF 078972**

6. If Indian, Allottee or Tribe Name

7. If Unit or C.A. Agreement Designation

8. Well Name and No.  
**San Juan 28-7 Unit # 181**

9. API Well No.  
**30-039-20775**

10. Field and Pool, or Exploratory Area  
**Blanco Mesaverde**

11. County or Parish, State  
**Rio Arriba, NM**

**SUNDRY NOTICES AND REPORTS ON WELLS**

Do not use this form for proposals to drill or to deepen or reentry to a different reservoir.  
Use "APPLICATION FOR PERMIT—" for such proposals

**SUBMIT IN TRIPLICATE**

RECEIVED  
MAR - 2 1999  
OIL CON. DIV.  
DIST. 3

1. Type of Well

☐ Oil Well ☒ Gas Well ☐ Other

2. Name of Operator

**CONOCO INC.**

3. Address and Telephone No.

**10 DESTA DR. STE. 100W, MIDLAND, TX. 79705-4500 (915) 686-5424**

4. Location of Well (Footage Sec., T. R. M. or Survey Description)

**Section 3. T-27-N, R-7-W (M)  
1180' FSL & 820' FWL**

**CHECK APPROPRIATE BOX(s) TO INDICATE NATURE OF NOTICE, REPORT, OR OTHER DATA**

TYPE OF SUBMISSION	TYPE OF ACTION	
<input checked="" type="checkbox"/> Notice of Intent	<input type="checkbox"/> Abandonment	<input type="checkbox"/> Change of Plans
<input type="checkbox"/> Subsequent Repon	<input checked="" type="checkbox"/> Recompletion	<input type="checkbox"/> New Construction
<input type="checkbox"/> Final Abandonment Notice	<input type="checkbox"/> Plugging Back	<input type="checkbox"/> Non-Routine Fracturing
	<input type="checkbox"/> Casing Repair	<input type="checkbox"/> Water Shut-Off
	<input type="checkbox"/> Altering Casing	<input type="checkbox"/> Conversion to Injection
	<input type="checkbox"/> Other	<input type="checkbox"/> Dispose Water

(Note: Report results of multiple completion on Well Completion or Recompletion Report and Log form.)

13. Describe Proposed or Completed Operations (Clearly state all pertinent details, and give pertinent dates, including estimated date of starting any proposed work. If well is directionally drilled give subsurface locations and measured and true vertical depths for all markers and zones pertinent to this work.)\*

It has been proposed to recomplete this well to the Mesaverde using the attached procedure.

14. I hereby certify that the foregoing is true and correct

Signed

*Kay Maddox*

Title

**Kay Maddox**

**Regulatory Agent**

Date

**February 10, 1999**

(This space for Federal or State office use)

Approved by

**/s/ Duane W. Spencer**

Title

**Team Lead, Petroleum Management**

Date

**FEB 4 6 1999**

Conditions of approval if any.

BLM(6), NMOC(1), SHEAR, PONCA, COST ASST, FILE ROOM

Title 18 U.S.C. Section 1001, makes it a crime for any person knowingly and willfully to make to any department or agency of the United States any false, fictitious or fraudulent statements or representations as to any matter within its jurisdiction.

**See Instruction on Reverse Side**  
**EA of #104 MV NMOC**

**San Juan 28-7 Unit # 181  
Mesaverde Recompletion & DHC  
API # 30-039-20775**

February 10, 1999

**Summary of Work Recommended**

- Isolate DK zone from MV
- Run CBL across MV (Cmt Sqz if TOC is below 4950')
- Perf & Stimulate MV Interval (expect 2 stage frac)
- Remove Isolation Plugs
- Return well to Production as MV/DK DHC

**Well Data:**

**AFE #**                      **51-61-????**                      **Downhole Commingle:**                      **DHC-????**

**Location:**            1180' FSL & 820' FWL, Sec. 3, T27N-R7W  
Rio Arriba County, New Mexico

**Elevations:**                      KB:     6791'  
    GL:     6776'  
    PBSD: 7859'  
    TD:     7866'

**Casing:**                      **9 5/8", 36 #/ft, H-40, 7 jts set @ 241'**  
    1 stage:                                      225 cu ft/ 190 sxs.                      TOC @ Surface (circ)

**7", 20 #/ft, J-55, 88 jts set @ 3688'**  
    1 stage                                      269 cu ft/130 sxs                      TOC @ 2425' (TS)

**4-1/2", 10.5 & 11.6 #/ft, J-55, 204 jts set @ 7810'**  
    10.5 #/ft 208 jts from 0' to 6,699'  
    11.6 #/ft 36 jts from 6,699' to 7,866'  
  
    1 stage:                                      642 cu ft/256 sxs                      TOC @ 3400' (TS)

Size	Wt	Drift	Capacity	Burst
9 5/8"	36	10.0036"	13.05 ft/bbl	1820 psi
7"	20	6.331"	24.70 ft/bbl	3740 psi
4 1/2"	11.6	3.875"	1.532 ft/bbl	5350 psi
4 1/2"	10.5	3.927"	1.493 ft/bbl	4790 psi
2 3/8"	4.7	1.901"	258 ft/bbl	5600 psi

**Tubing:**                      **1.9" 2.9 #/ft, J-55, 237 jts @ 7827'**

**Perforations:** DK:    (7620'- 7828') 8 holes  
                                    7620', 46', 48',  
                                    7756', 58', 84',  
                                    7808', & 7828'

**San Juan 28-7 Unit # 181  
Mesaverde Recompletion & DHC  
API # 30-039-20775**

Please Refer questions to the following people:

Geologic/Logging:	<b>Tom Johnson</b>	<b>(915) 686-6111</b>
Engineering/Procedural:	<b>Randy Herring</b> Pager	<b>(915) 686-6541</b> 800-999-6710 I.D.# 991-7826
Fracturing:	<b>Jim Russell:</b> Pager Mobile	<b>(505) 327-6222</b> (505) 324-1867 (505) 330-0005
Completion:	<b>Greg Vick:</b> Pager Mobile	<b>(505) 324-5819</b> (505) 324-2601 (505) 320-4609
	<b>Gilbert Hughes</b> Pager Mobile	<b>(505) 324-5812</b> (505) 327-8753 (505) 320-4785
	<b>Lino Hernandez:</b> Pager Mobile	<b>(505) 324-5816</b> (505) 326-8198 (505) 320-6739

Other #'s

BLM:	(505) 599-8900	NMOCD:	(505) 334-6178
One Call:	1-800-321-2537		

Midland Continuous Fax: (915) 686-6112

**EMERGENCY NUMBERS:**

<b>Aztec Fire &amp; Police:</b>	<b>911</b>	<b>Air Care:</b>	<b>911 or 1-800-452-9990</b>
<b>NM State Police</b>	<b>325-7547</b>	<b>SJ County Sheriff:</b>	<b>334-6107</b>

**San Juan 28-7 Unit # 181  
Mesaverde Recompletion & DHC  
API # 30-039-20775**

1. **Hold tailgate safety meetings prior to rigging up, each morning, and whenever necessary.**
2. Test Anchors, MIRU Workover Unit. If necessary, kill well with a minimum of 1 % KCl. NU BOP. POOH & LD 1.9" production string.
3. RU Wireline unit and RIH w/ 4 1/2" Fas-Drill Bridge Plug. Set plug @ +/-5825'. Test plug to 4000 psi.

**1st Stage**

4. Perforate the Lower MV across the following intervals using a 3 1/8" Select Fire gun w/ 11 gm charges. Run GR strip & Correlate to attached log:  
  
5381', 84', 87', 93', 95', 99',  
5601', 04', 07', 10', 18', 23', 25', 27', 32', 34', 36', 70', 72', 80', 82', 91', 93', 99',  
5702', 05', 23', 25', 33', & 35'  
  
(Total 30 holes)
5. RU Acidizing equipment. Test lines to 4000 psi Break down perms using 500 gallons 15% HCl and 50% excess 1.1 sg balls (45) spaced equally throughout the job. Run as high a rate as possible without exceeding max pressure. **DO NOT EXCEED 4000 psi**
6. Retrieve balls and check for hits. If # hits less than 80% (24), re-acidize using the above procedure. Prep to frac.
7. Frac per attached procedure. Leave frac equipment on location. RIH and set w/ Fast-drill plug above Point Lookout. Set Plug @ +/- 5200'.

San Juan 28-7 Unit # 181  
Mesaverde Recompletion & DHC  
API # 30-039-20775

**2nd Stage**

8. Perforate the Menefee across the following intervals using a 3 1/8" Select Fire gun w/ 11 gm charges. Run GR strip & Correlate to attached log:

5028', 30', 32', 42', 44', 79', 81', 83', 85', 87', 89',  
5101', 03', 05', 13', 15', 17', 34', 36', & 38'.

Total 20 shots

9. RU Acidizing equipment. Test lines to 4000 psi Break down perfs using 500 gallons 15% HCl and 50% excess 1.1 sg balls (30) spaced equally throughout the job. Run as high a rate as possible without exceeding max pressure. **DO NOT EXCEED 4000 psi**
10. Retrieve balls and check for hits. If # hits less than 80% (16), re-acidize using the above procedure. Prep to frac.
11. Frac per attached procedure. Clean Location and release frac equipment.
12. Rig up compressors and power swivel. RIH w/ bit & collars on tbgs. CO & DO Mesaverde bridge plug to 5825'. Jet well w/ gas until well will flow on its own. Drywatch as necessary.
13. Test Mesaverde and obtain a stabilized flow rate for allocation purposes.
14. RU compressors and drill out bridge plug @ 5800' w/ gas. Clean out well to PBTD (7859'). Jet well w/ gas until well will flow on its own. Drywatch as necessary.

**San Juan 28-7 Unit # 181  
Mesaverde Recompletion & DHC  
API # 30-039-20775**

15. PU & RIH w/ 2 3/8" production string. Land SN at +/- 7700'. ND BOP and NU wellhead.
16. Record and notify necessary personnel for regulatory and gas allocation purposes.
17. RDMO workover unit and clean location.
18. Place well on production
19. Thank You.

Prepared By: \_\_\_\_\_  
Randy B. Herring,  
Sr. Production Engineer

District I  
PO Box 1980, Hobbs, NM 88241-1980

District II  
PO Drawer DD, Artesia, NM 88211-0719  
District III  
1000 Rio Brazos Rd. Aztec, NM 87410

District IV  
PO Box 2088, Santa Fe, NM 87504-2088

State of New Mexico  
Energy, Minerals & Natural Resources Department

OIL CONSERVATION DIVISION  
PO Box 2088  
Santa Fe, NM 87504-2088

Form C-102

Revised February 21, 1994

Instructions on back

Submit to Appropriate District Office

State Lease - 4 Copies

Fee Lease - 3 Copies

☐ AMENDED REPORT

WELL LOCATION AND ACREAGE DEDICATION PLAT

API Number 30-039-20775	2 Pool Code 72319	3 Pool Name Blanco Mesaverde
4 Property Code 016608	5 Property Name San Juan 28-7 Unit	6 Well Number # 181
7 OGRID No. 005073	8 Operator Name Conoco Inc., 10 Desta Drive, Ste. 100W, Midland, TX 79705-4500	9 Elevation 6776'

10 Surface Location

UL or lot no.	Section	Township	Range	Lot Idn	Feet from the	North/South line	Feet from the	East/West line	County
M	3	27N	7W		1180	South	820	West	Rio Arriba

11 Bottom Hole Location If Different From Surface

UL or lot no.	Section	Township	Range	Lot Idn	Feet from the	North/South line	Feet from the	East/West line	County

12 Dedicated Acres 320	13 Joint or Infill	14 Consolidation Code	15 Order No. R-10987 - A
---------------------------	--------------------	-----------------------	-----------------------------

NO ALLOWABLE WILL BE ASSIGNED TO THIS COMPLETION UNTIL ALL INTERESTS HAVE BEEN CONSOLIDATED  
OR A NON-STANDARD UNIT HAS BEEN APPROVED BY THE DIVISION

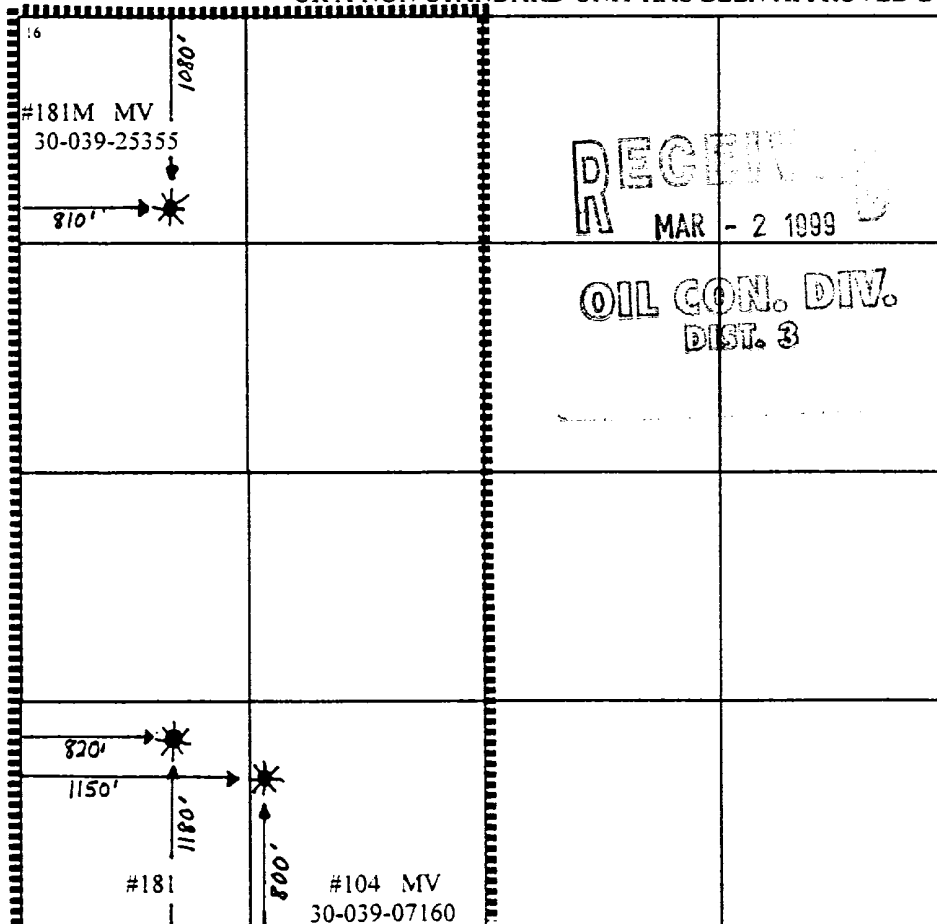

17 OPERATOR CERTIFICATION

I hereby certify that the information contained herein is true and complete to the best of my knowledge and belief

Signature

*Kay Maddox*

Kay Maddox

Printed Name

Regulatory Agent

Title

February 10, 1999

Date

18 SURVEYOR CERTIFICATION

I hereby certify that the well location shown on this plat was plotted from field notes of actual surveys made by me or under my supervision, and that the same is true and correct to the best of my belief.

Date of Survey

Signature and Seal of Professional Surveyor.

Certificate Number

FOR  
2A of 104 MV @