

NEW MEXICO OIL CONSERVATION COMMISSION

WELL LOCATION AND ACERAGE DEDICATION PLAT

All distances must be from the outer boundaries of the Section

Operator Lively Exploration Company			Lease Lively		Well No. 21
Unit Letter M	Section 31	Township 27 North	Range 7 West	County Rio Arriba	
Actual Footage Location of Well: <div style="display: flex; justify-content: space-between;"> 1190 feet from the South line and 900 feet from the West line </div>					
Ground Level Elev. 5993	Producing Formation Dakota	Pool Basin Dakota	Dedicated Acreage: 321.60 320 Acres		

1. Outline the acreage dedicated to the subject well by colored pencil or hatchure marks on the plat below.
2. If more than one lease is dedicated to the well, outline each and identify the ownership thereof (both as to working interest and royalty),
3. If more than one lease of different ownership is dedicated to the well, have the interests of all owners been consolidated by communitization, unitization, force-pooling, etc?

() Yes () No If answer is "yes," type of consolidation _____

If answer is "no," list the owners and tract descriptions which have actually consolidated. (Use reverse side of this form if necessary.) _____

No allowable will be assigned to the well until all interests have been consolidated (by communitization, unitization, forced-pooling, or otherwise) or until a non standard unit, eliminating such interests, has been approved by the Commission.

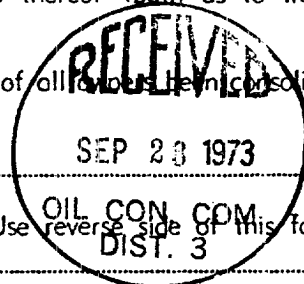

CERTIFICATION

I hereby certify that the information contained herein is true and complete to the best of my knowledge and belief.

Original signed by T. A. Dugan

Name
Thomas A. Dugan
 Position
Engineer
 Company
Lively Exploration Company
 Date
9-20-73

I hereby certify that the location shown on this plat was plotted from field notes of actual surveys made by me or under my supervision, and that the same is true and correct to the best of my knowledge and belief.

REGISTERED LAND SURVEYOR
STATE OF NEW MEXICO
Reg. No. 3602
 Date Surveyed
August 15, 1973
V. ECHOHAWK
 Registered Professional Engineer
 and/or Land Surveyor

E. V. Echohawk
 Certificate No. **3602**
E. V. Echohawk LS

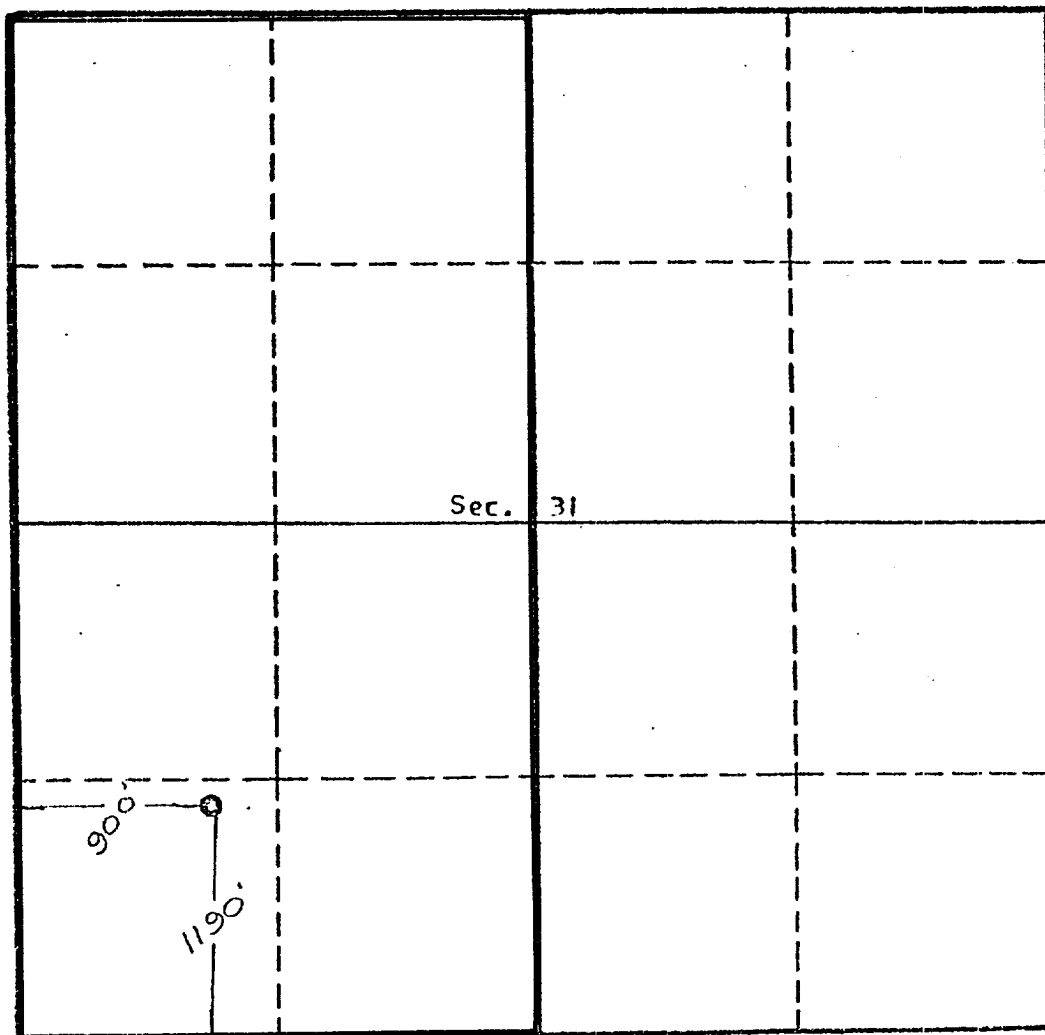

Scale, 1 inch = 1,000 feet