

Form 9-331C  
(May 1963)SUBMIT IN TRIPLICATE\*  
(Other instructions on  
reverse side)Form approved.  
Budget Bureau No. 42-R1425.  
~~30-237-20348~~

**Amended**

UNITED STATES  
DEPARTMENT OF THE INTERIOR  
GEOLOGICAL SURVEY

## APPLICATION FOR PERMIT TO DRILL, DEEPEN, OR PLUG BACK

## 1a. TYPE OF WORK

DRILL ☒DEEPEN ☐PLUG BACK ☐

## b. TYPE OF WELL

OIL  
WELL ☐GAS  
WELL ☒

OTHER

SINGLE  
ZONE ☐MULTIPLE  
ZONE ☐

## 2. NAME OF OPERATOR

Lively Exploration Company

## 3. ADDRESS OF OPERATOR

P. O. Box 234, Farmington, New Mexico 87401

## 4. LOCATION OF WELL (Report location clearly and in accordance with any State requirements.)\*

At surface

1460' FSL - 430' FWL

At proposed prod. zone

## 14. DISTANCE IN MILES AND DIRECTION FROM NEAREST TOWN OR POST OFFICE\*

20 miles southeast Blanco, New Mexico

## 15. DISTANCE FROM PROPOSED\*

LOCATION TO NEAREST

PROPERTY OR LEASE LINE, FT.

(Also to nearest drlg. unit line, if any)

900'

## 16. NO. OF ACRES IN LEASE

17. NO. OF ACRES ASSIGNED  
TO THIS WELL~~320~~ 321.60

## 18. DISTANCE FROM PROPOSED LOCATION\*

TO NEAREST WELL, DRILLING, COMPLETED,  
OR APPLIED FOR, ON THIS LEASE, FT.

300' approx

## 19. PROPOSED DEPTH

6525'

## 20. ROTARY OR CABLE TOOLS

Rotary

## 21. ELEVATIONS (Show whether DF, RT, GR, etc.)

5997' GR

## 22. APPROX. DATE WORK WILL START\*

1-15-74

## 23.

## PROPOSED CASING AND CEMENTING PROGRAM

SIZE OF HOLE	SIZE OF CASING	WEIGHT PER FOOT	SETTING DEPTH	QUANTITY OF CEMENT
12-1/4"	8-5/8"	24#	300'	200 sacks
7-7/8"	4-1/2"	10.5#	6525'	1300 cu. ft. in 2 stages

Drill well with mud to test Dakota formation, log well, run 4-1/2" casing, cement casing with 1300 cu. ft. cement in two stages (second stage will cover P.C. and M.V. with cement). Selectively perforate, sand-water frac with 60,000 lbs. sand, clean out after frac, run 1-1/4" tubing, and complete well.

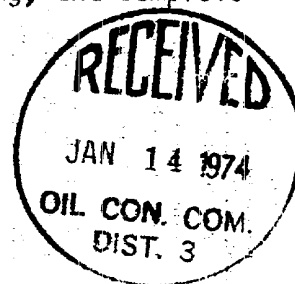

IN ABOVE SPACE DESCRIBE PROPOSED PROGRAM: If proposal is to deepen or plug back, give data on present productive zone and proposed new productive zone. If proposal is to drill or deepen directionally, give pertinent data on subsurface locations and measured and true vertical depths. Give blowout preventer program, if any.

## 24.

Original signed by T. A. Dugan

SIGNED

Thomas A. Dugan

TITLE

Engineer

DATE

1-9-74

(This space for Federal or State office use)

PERMIT NO.

APPROVAL DATE

APPROVED BY

TITLE

DATE

CONDITIONS OF APPROVAL, IF ANY:

Hold E-104 for USC

\*See Instructions On Reverse Side

# NEW MEXICO OIL CONSERVATION COMMISSION

## WELL LOCATION AND ACERAGE DEDICATION PLAT

All distances must be from the outer boundaries of the Section

Operator <b>Lively Exploration Company</b>			Lease <b>Lively</b>		Well No. <b>21</b>
Unit Letter <b>L</b>	Section <b>31</b>	Township <b>27 North</b>	Range <b>7 West</b>	County <b>Rio Arriba</b>	
Actual Footage Location of Well: <b>1460</b> feet from the <b>South</b> line and <b>430</b> feet from the <b>West</b> line					
Ground Level Elev. <b>5997</b>	Producing Formation <b>Dakota</b>		Pool <b>Basin Dakota</b>		Dedicated Acreage: <b>321.60-320</b> Acres

1. Outline the acreage dedicated to the subject well by colored pencil or hatchure marks on the plat below.
2. If more than one lease is dedicated to the well, outline each and identify the ownership thereof (both as to working interest and royalty),
3. If more than one lease of different ownership is dedicated to the well, have the interests of all owners been consolidated by communitization, unitization, force-pooling, etc?

( ) Yes ( ) No If answer is "yes," type of consolidation .....

If answer is "no," list the owners and tract descriptions which have actually consolidated. (Use reverse side of the form if necessary.) .....

No allowable will be assigned to the well until all interests have been consolidated (by communitization, unitization, forced-pooling, or otherwise) or until a non standard unit, eliminating such interests, has been approved by the Commission.



### CERTIFICATION

I hereby certify that the information contained herein is true and complete to the best of my knowledge and belief.

Original signed by T. A. Dugan

Name  
Thomas A. Dugan  
Position  
Engineer  
Company  
Lively Exploration Company  
Date  
1-9-74

I hereby certify that the well location shown on this plat was plotted from field notes of actual surveys made by me or under my supervision, and that the same is true and correct to the best of my knowledge and belief.

Date Surveyed  
December 13, 1973  
Registered Professional Engineer  
and/or Land Surveyor

E. V. Echolaw  
Certificate No. 3602  
**E. V. Echolaw LS**

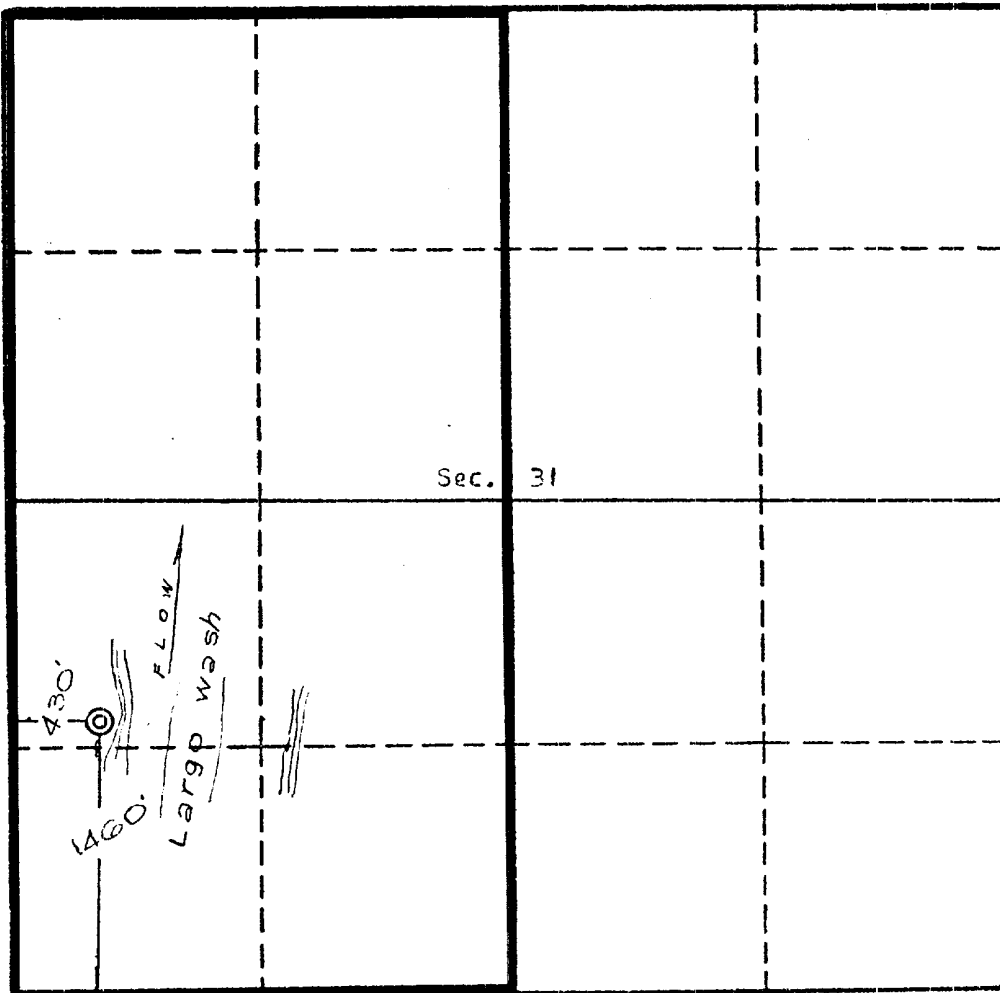

Scale, 1 inch = 1,000 feet