

# El Paso Natural Gas Company

El Paso, Texas 79901

April 22, 1974

ADDRESS REPLY TO:  
POST OFFICE BOX 800  
DARTMOUTH, NEW HAMPSHIRE 03740

Mr. Jerry Long  
U. S. Geological Survey  
Post Office Box 1809  
Durango, Colorado 81301

Re: Application for Permit to Drill  
San Juan 27-5 Unit #190  
NENE/4 Section 25, T-27-N, R-5-W  
Basin Dakota

Dear Mr. Long:

Details regarding existing roads, pipelines, wells, etc. relative to the above well location are included on the previously submitted base maps, "Field Road Map" and "Composite Map No. 1".

The proposed new well location, new roads and new pipeline are shown on the attached plat along with connecting existing roads and pipelines in the vicinity of the proposed new well.

Water for drilling and completion operations will be obtained from the following location: water hole located in Section 18, T-27-N, R-4 W.

Waste material will be disposed of by burial in the burn pit, latrine, or reserve pit as applicable. There will be no camp nor air strip associated with drilling this well. Upon completion or abandonment of this well, the location will be cleaned and leveled and a dry hole marker placed, if applicable.

Yours very truly,

*D. G. Brisco*

D. G. Brisco  
Drilling Clerk



APR 26 1974

W

UNITED STATES  
DEPARTMENT OF THE INTERIOR  
GEOLOGICAL SURVEY

30-039-20880

## APPLICATION FOR PERMIT TO DRILL, DEEPEN, OR PLUG BACK

1a. TYPE OF WORK DRILL <input checked="" type="checkbox"/> DEEPEN <input type="checkbox"/> PLUG BACK <input type="checkbox"/>		5. LEASE DESIGNATION AND SERIAL NO. SF 079492
b. TYPE OF WELL OIL <input type="checkbox"/> GAS <input checked="" type="checkbox"/> OTHER <input type="checkbox"/> SINGLE ZONE <input checked="" type="checkbox"/> MULTIPLE ZONE <input type="checkbox"/>		6. IF INDIAN, ALLOTTEE OR TRIBE NAME
2. NAME OF OPERATOR El Paso Natural Gas Company		7. PERMIT APPLICANT NAME San Juan 27-5 Unit
3. ADDRESS OF OPERATOR PO Box 990, Farmington, NM 87401		8. FARM OR LEASE NAME San Juan 27-5 Unit
4. LOCATION OF WELL (Report location clearly and in accordance with any State requirements.)* At surface 1180'N, 1080'E At proposed prod. zone		9. WELL NO. 190
14. DISTANCE IN MILES AND DIRECTION FROM NEAREST TOWN OR POST OFFICE*		10. FIELD AND POOL, OR WILDCAT Basin Dakota
15. DISTANCE FROM PROPOSED* LOCATION TO NEAREST PROPERTY OR LEASE LINE, FT. (Also to nearest drlg. unit line, if any)		11. SEC. T., R., N., OR BLK. AND SURVEY OR AREA Sec. 25, T-27-N, R-5-W NMPM
16. NO. OF ACRES IN LEASE		12. COUNTY OR PARISH Rio Arriba
17. NO. OF ACRES ASSIGNED TO THIS WELL 320 ✓		13. STATE NM
18. DISTANCE FROM PROPOSED LOCATION* TO NEAREST WELL, DRILLING, COMPLETED, OR APPLIED FOR, ON THIS LEASE, FT.		20. ROTARY OR CABLE TOOLS Rotary
19. PROPOSED DEPTH 7927'		22. APPROX. DATE WORK WILL START*
21. ELEVATIONS (Show whether DF, RT, GR, etc.) 6669'GL		

## 23. PROPOSED CASING AND CEMENTING PROGRAM

SIZE OF HOLE	SIZE OF CASING	WEIGHT PER FOOT	SETTING DEPTH	QUANTITY OF CEMENT
13 3/4"	9 5/8"	32.3#	200'	210 cu. ft. to circulate
8 3/4"	7"	20.0#	3894'	220 cu. ft. to cover Ojo Alamo
6 1/4"	4 1/2"	10.5#&11.6#	7927'	620 cu. ft. to fill to 3894'

Selectively perforate and sandwater fracture the Dakota formation.

Surface is patented and owner approval has been secured.

The E/2 of Section 25 is dedicated to this well.



IN ABOVE SPACE DESCRIBE PROPOSED PROGRAM: If proposal is to deepen or plug back, give data on present productive zone and proposed new productive zone. If proposal is to drill or deepen directionally, give pertinent data on subsurface locations and measured and true vertical depths. Give blowout preventer program, if any.

24. SIGNED M. G. Luisco TITLE Drilling Clerk DATE April 22, 1974  
(This space for Federal or State office use)

PERMIT NO. \_\_\_\_\_ APPROVAL DATE \_\_\_\_\_

APPROVED BY \_\_\_\_\_ TITLE \_\_\_\_\_ DATE \_\_\_\_\_  
CONDITIONS OF APPROVAL, IF ANY:

\*See Instructions On Reverse Side

NEW MEXICO OIL CONSERVATION COMMISSION  
WELL LOCATION AND ACREAGE DEDICATION PLAT

Form C-102  
Supersedes C-128  
Effective 1-1-65

All distances must be from the outer boundaries of the Section.

Operator <b>EL PASO NATURAL GAS COMPANY</b>		Lease <b>SAN JUAN 27-5 UNIT (SF-079492)</b>		Well No. <b>190</b>
Unit Letter <b>A</b>	Section <b>25</b>	Township <b>27-N</b>	Range <b>5-W</b>	County <b>RIO ARriba</b>
Actual Footage Location of Well: <b>1180</b> feet from the <b>NORTH</b> line and <b>1080</b> feet from the <b>EAST</b> line				
Ground Level Elev. <b>6669</b>	Producing Formation <b>DAKOTA</b>	Pool <b>BASIN DAKOTA</b>	Dedicated Acreage: <b>320.00</b> Acres	

1. Outline the acreage dedicated to the subject well by colored pencil or hatchure marks on the plat below.
2. If more than one lease is dedicated to the well, outline each and identify the ownership thereof (both as to working interest and royalty).
3. If more than one lease of different ownership is dedicated to the well, have the interests of all owners been consolidated by communitization, unitization, force-pooling, etc?

☒ Yes ☐ No If answer is "yes," type of consolidation Unitization

If answer is "no," list the owners and tract descriptions which have actually been consolidated. (Use reverse side of this form if necessary.)

No allowable will be assigned to the well until all interests have been consolidated (by communitization, unitization, forced-pooling, or otherwise) or until a non-standard unit, eliminating such interests, has been approved by the Commission.

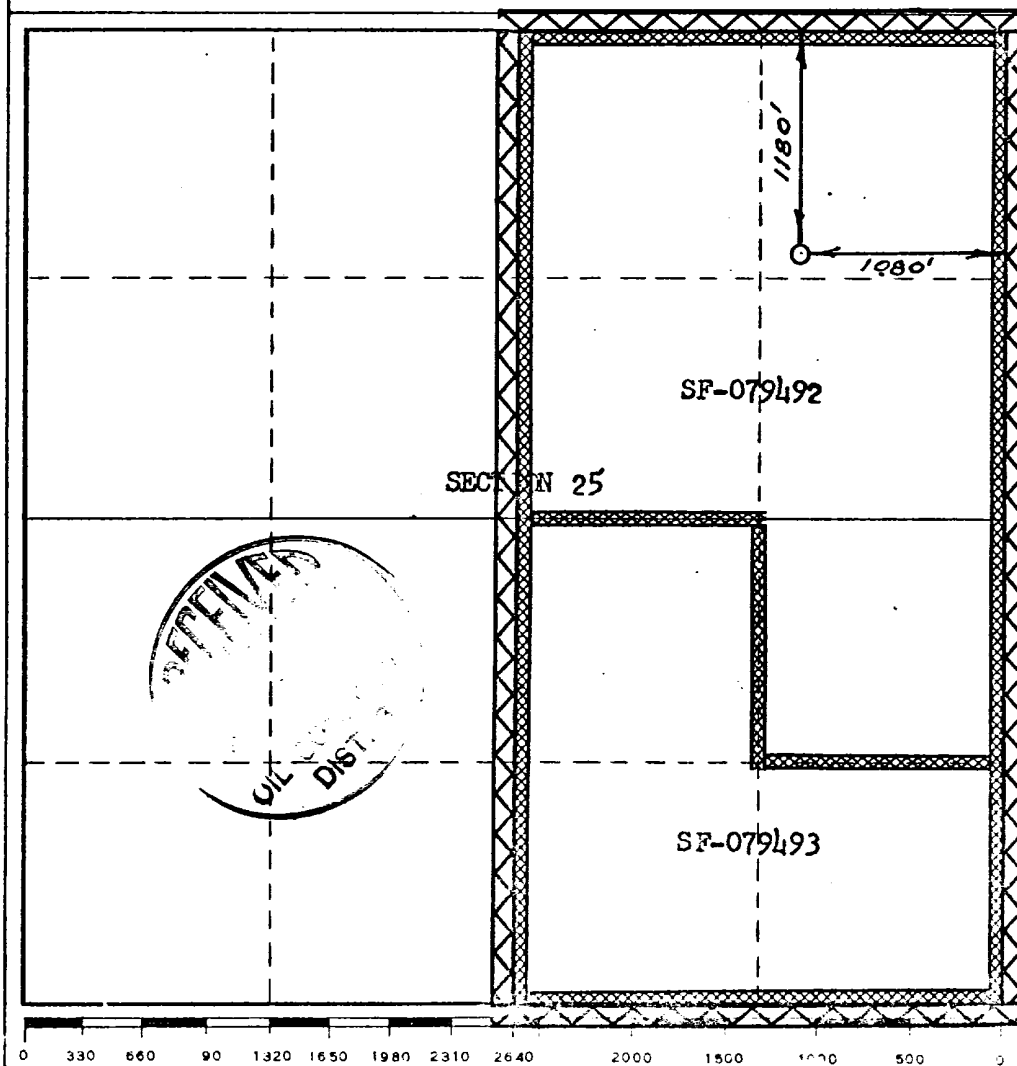

CERTIFICATION

I hereby certify that the information contained herein is true and complete to the best of my knowledge and belief.

Original Signed by  
**D. G. Brisco**

Name  
**Drilling Clerk**  
Position  
**El Paso Natural Gas Co.**  
Company  
**April 22, 1974**  
Date

I hereby certify that the well location shown on this plat was plotted from field notes of actual surveys made by me or under my supervision, and that the same is true and correct to the best of my knowledge and belief.

Date Surveyed  
**DECEMBER 27, 1973**

Registered Professional Engineer  
and/or Land Surveyor

*David C. Kilmer*  
Certificate No. **1760**